

Property Record Card



Parcel 04-21-29-509-0A00-0350

Property Address 110 CHERRY HILL CIR LONGWOOD, FL 32779

Parcel Location

Site View

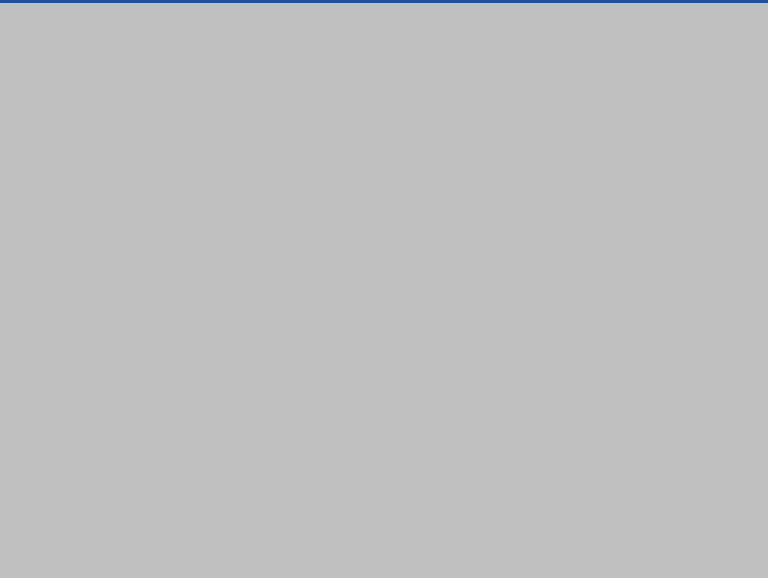

Parcel Information

Value Summary

Parcel	04-21-29-509-0A00-0350
Owner(s)	110 CHERRY HILL TRUST - Trust
Property Address	110 CHERRY HILL CIR LONGWOOD, FL 32779
Mailing	PO BOX 520385 LONGWOOD, FL 32752-0385
Subdivision Name	BRANTLEY HALL ESTATES
Tax District	01-COUNTY-TX DIST 1
DOR Use Code	0130-SINGLE FAMILY WATERFRONT
Exemptions	00-HOMESTEAD(2017)
AG Classification	No

	2024 Working Values	2023 Certified Values
Valuation Method	Cost/Market	Cost/Market
Number of Buildings	1	1
Depreciated Bldg Value	\$651,996	\$637,795
Depreciated EXFT Value	\$57,560	\$55,800
Land Value (Market)	\$406,400	\$406,400
Land Value Ag		
Just/Market Value	\$1,115,956	\$1,099,995
Portability Adj		
Save Our Homes Adj	\$252,745	\$261,926
Non-Hx 10% Cap (AMD 1)	\$0	\$0
P&G Adj	\$0	\$0
Assessed Value	\$863,211	\$838,069

2023 Certified Tax Summary

2023 Tax Amount w/o Exemptions **\$14,638.73** 2023 Tax Savings with Exemptions **\$4,016.66**
 2023 Tax Bill Amount **\$10,622.07**

* Does NOT INCLUDE Non Ad Valorem Assessments

Legal Description

BEG NW COR LOT 35 RUN N 84
 DEG 15 MIN E 33 FT S 18
 DEG 41 MIN 54 SEC E 129.52
 FT SWLY ON CURVE 54.95 FT
 N 51 DEG 29 MIN 20 SEC W
 60.92 FT N 71 DEG 3 MIN 42 SEC
 W 88.21 FT N 84 DEG 21 MIN 49
 SEC W TO LAKE NLY TO PT S 84 DEG 15
 MIN W OF BEG N 84 DEG 15 MIN E TO
 BEG BLK A
 BRANTLEY HALL ESTATES

Taxes

Taxing Authority	Assessment Value	Exempt Values	Taxable Value
ROAD DISTRICT	\$863,211	\$50,000	\$813,211
SJWM(Saint Johns Water Management)	\$863,211	\$50,000	\$813,211
FIRE	\$863,211	\$50,000	\$813,211
COUNTY GENERAL FUND	\$863,211	\$50,000	\$813,211
Schools	\$863,211	\$25,000	\$838,211

Sales

Description	Date	Book	Page	Amount	Qualified	Vac/Imp
WARRANTY DEED	01/01/2015	08417	0429	\$100	No	Improved
WARRANTY DEED	02/01/1997	03198	1908	\$425,000	Yes	Improved
WARRANTY DEED	02/01/1991	02360	0297	\$350,000	Yes	Improved
WARRANTY DEED	01/01/1976	01085	1543	\$12,500	No	Vacant
WARRANTY DEED	01/01/1973	00980	0443	\$12,500	Yes	Vacant

Land

Method	Frontage	Depth	Units	Units Price	Land Value
FRONT FOOT & DEPTH	60.00	200.00	0	\$4,500.00	\$270,000
FRONT FOOT & DEPTH	100.00	120.00	0	\$2,200.00	\$136,400

Building Information

#	Description	Year Built**	Bed	Bath	Fixtures	Base Area	Total SF	Living SF	Ext Wall	Adj Value	Repl Value	Description	Area
1	SINGLE FAMILY	1982/1990	4	3.0	12	2,711	5,566	3,989	CUSTOM WOOD/STUCCO /BRICK	\$651,996	\$764,805		

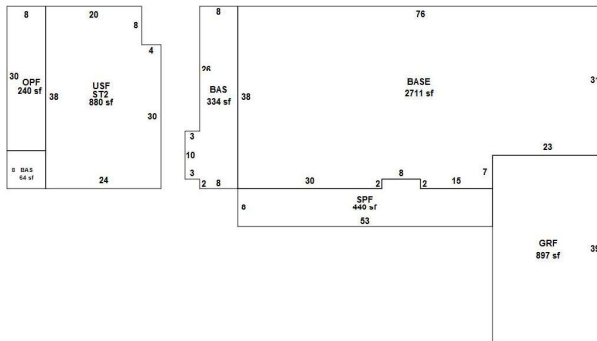

Description	Area
GARAGE FINISHED	897.00
SCREEN PORCH FINISHED	440.00
BASE	334.00
UPPER STORY FINISHED	880.00
OPEN PORCH FINISHED	240.00
BASE	64.00

Sketch by Apex Sketch

Building 1 - Page 1

** Year Built (Actual / Effective)

Type text here

Permits

Permit #	Description	Agency	Amount	CO Date	Permit Date
06618	REROOF 50 SQ FT	County	\$5,000		10/1/1996
05266	REROOF	County	\$5,000		6/7/2000
12134	REPLACE SECTION OF EXISTING SEAWALL DUE TO STORM DAMAGE	County	\$2,000		6/22/2005
12563	REROOF.	County	\$17,160		7/17/2018
04915	110 CHERRY HILL CIR: DOCK - BOATHOUSE-BOAT HOUSE AND SEAWALL [BRANTLEY HALL ESTATES]	County	\$64,000		7/24/2019

Extra Features

Description	Year Built	Units	Value	New Cost
BOAT DOCK 3	10/30/2020	1	\$14,080	\$16,000
FIREPLACE 2	10/01/1982	1	\$2,400	\$6,000
BOAT COVER 3	10/30/2020	1	\$14,080	\$16,000
POOL 2	10/01/1982	1	\$27,000	\$45,000

Zoning

Zoning	Zoning Description	Future Land Use	Future Land Use Description
R-1AA	Low Density Residential	LDR	Single Family-11700

Utility Information

Fire Station	Power	Phone(Analog)	Water Provider	Sewer Provider	Garbage Pickup	Recycle	Yard Waste	Hauler
16.00	DUKE	CENTURY LINK	SEMINOLE COUNTY UTILITIES	SEMINOLE COUNTY UTILITIES	MON/THU	THU	WED	Waste Management

Political Representation

Commissioner	US Congress	State House	State Senate	Voting Precinct
Dist 3 - Lee Constantine	Dist 7 - Cory Mills	Dist 39 - DOUG BANKSON	Dist 10 - Jason Brodeur	34

School Information

Elementary School District	Middle School District	High School District
Forest City	Teague	Lake Brantley

Copyright 2024 © Seminole County Property Appraiser