

SANFORD COMMERCE CENTER PD SEMINOLE COUNTY DEVELOPMENT ORDER

On August 11, 2026, Seminole County issued this Development Order which shall replace in its entirety the Orange Boulevard Property PD #25-20500006, issued June 23, 2025, as recorded in Seminole County Official Records Book 10847 Pages 1673-1678, relating to and touching concerning the following described property:

Legal Description

Lot 2, CBK DEVELOPMENT, according to the plat thereof, as recorded in Plat Book 91, Pages 21-24, of the Public Records of Seminole County, Florida

(The above-described legal description has been provided to Seminole County by the owner of the above-described property)

FINDINGS OF FACT

Property Owner: KBC Development, Inc.

Project Name: Sanford Commerce Center SSFLUMA & PD Major Amendment Rezone

Requested Development Approval: Consider a Small Scale Future Land Use Map Amendment from Commercial to Industrial and a Rezone from PD (Planned Development) to PD (Planned Development) for a proposed 144,000 square-foot commercial and industrial flex space warehouse development on approximately 17.23 acres, located on the south side of Orange Blvd, and approximately ½ mile east of Oregon St.

The Development Approval sought is consistent with the Seminole County Comprehensive Plan and will be developed consistent with and in compliance to applicable land development regulations and all other applicable regulations and ordinances.

The development conditions and commitments stated below will run with, follow and perpetually burden the above-described property.

Prepared by: Anne Marie (Annie) Sillaway, AICP
Principal Planner
1101 East First Street
Sanford, Florida 32771

NOW, THEREFORE, IT IS ORDERED AND AGREED THAT:

- (1) The subject application for development approval is **GRANTED**.
- (2) All development must fully comply with all of the codes and ordinances in effect in Seminole County at the time of issuance of permits including all impact fee ordinances.
- (3) The conditions upon this Development Order approval and the commitments made as to this development approval, all of which have been accepted by and agreed to by the owners of the property; replace in its entirety, the Orange Boulevard Property PD Development Order #25-20500006, issued June 23, 2025, as recorded in Seminole County Official Records Book 10847 Pages 1673-1678:
 - A. Development must comply with the Master Development Plan attached hereto as "Exhibit A".
 - B. Maximum Intensity Floor Area Ratio: 0.65
 - C. Maximum Building Height: thirty-five (35) feet
 - D. Perimeter building setbacks:
 - North: Twenty-five (25) feet
 - South: Ten (10) feet
 - East: Ten (10) feet
 - West: Sixty (60) feet – one (1) story building
 - 100' – two (2) story building
 - 150' – three (3) story buildingPerimeter Landscape Buffers*:
 - North: None
 - South: None
 - East: None
 - West: Twenty-five (25) foot wide landscape buffer with a three (3) foot high berm; landscape components shall provide an opacity rating of 0.5 opacity with 2.7 plant units per 100 linear feet using Plant Group B. Plantings shall be installed on top of the three (3) foot high berm to provide a buffer.*Additional criteria may be required at the time of the Final Development Plan.
 - E. Permitted Uses: Those uses permitted under C-1 (Retail Commercial), C-2 (General Commercial), C-3 (Heavy Commercial & Very Light Industrial), and M-1A (Very Light Industrial) districts, including the associated special

exception uses (as approved by the Board of Adjustment). The following uses shall be prohibited:

- a. Adult Entertainment Establishments
 - b. Alcoholic Beverage Establishments
 - c. Car Wash
 - d. Convenience Store
 - e. Commercial Kennels
 - f. Self Service Laundry
 - g. Automobile Wrecking Lots
 - h. Bottle and Distribution Plants
 - i. Incineration of Organic Materials
 - j. Junk and Receiving Yards
 - k. Laundry and Dry Cleaning Plants
 - l. Soap Manufacturing
 - m. Feed Mill Manufacturing
 - n. Concrete Block Plants
 - o. Redi-Mix Concrete Plants
 - p. Animal Processing
 - q. Sawmill
 - r. Wholesale Storage of Flammable Liquids or Gases
 - s. Sanitary Landfill
 - t. Solid Waste transfer
 - u. Storage and Recovery Stations
 - v. Truck Terminal
 - w. Retail Plant Nursery
 - x. Outdoor Recreation and Amusement Uses
 - y. Flea Market
 - z. Drive-in Theatres
 - aa. Multi-Family Housing
 - bb. Communication Towers
- F. Hours of Operation: Outdoor loading/unloading and outdoor work activities shall be limited to 7am – 9pm Monday – Friday.
- G. At the time of the Final Development Plan, additional conditions may be imposed to provide sound attenuation for the benefit of the residential development to the west. Noise mitigation measures may include, but are not limited to, the placement of loading docks and bay doors to face away from the western perimeter.
- H. At the time of Final Development Plan the Developer may be required to provide a letter of approval from the utility power provider if buildings or infrastructure are proposed to be located within the existing utility transmission easements.

- I. Outdoor storage areas shall be screened from view from any road or adjoining parcel outside of the development. Screening shall consist of walls or fences and shall be opaque to a height of at least eight (8) feet. Such areas shall be located a minimum of 150 feet from the west boundary of the subject property.
- J. The development shall provide a minimum of twenty-five (25) percent open space in accordance with the Seminole County Land Development Code.
- K. Dumpsters shall be screened so they are not visible from Orange Boulevard or nearby single-family properties.
- L. Retention ponds shall be designed such that they are not required to be fenced.
- M. The developer must provide a pedestrian circulation system giving access to all portions of the development as well as connecting to existing sidewalks outside of the development.
- N. All project signage must comply with the Land Development Code of Seminole County.
- O. All mechanical equipment, ground or roof mounted, shall be screened from off-site view.
- P. Parking of mobile CT-scan trucks or semi-tractor trailers shall be prohibited within 120 feet of the west property line. Where permitted, such vehicles shall be screened from off-site view.
- Q. All parking spaces shall be a minimum of 10 feet x 20 feet as required by the Land Development Code.
- R. Parking shall be provided at a ratio of two (2) parking spaces per 1,000 square feet of building for all development.
- S. The western buffer is required to be maintained by the property owner(s).
- T. Any development on the subject property shall be held to the Performance Standards of the SCLDC.
- U. The owner will be required to maintain the portion of the existing pre-cast wall located along the western boundary of Lot 2.
- V. The seventy (70) foot utility and access easement will be required to be vacated at the time of the Final Development Plan.
- W. In the case of a conflict between the written conditions A through V in this Development Order and the Master Development Plan attached as Exhibit (B), the terms of the written conditions A through V will apply.

(4) This Development Order touches and concerns the above-described property and the conditions, commitments and provisions of this Development Order will perpetually burden, run with and follow this property and be a servitude upon and binding upon this property unless released in whole or part by action of Seminole County by virtue of a document of equal dignity with this Order.

(5) The terms and provisions of this Order are not severable and in the event any portion of this Order is found to be invalid or illegal then the entire order will be null and void.

(6) In the case of a conflict between the written conditions in this Development Order and the attached Master Development Plan, the terms of the written conditions shall apply.

(7) All applicable state or federal permits must be obtained before commencement of the development authorized by this Development Order.

(8) Issuance of this Development Order does not in any way create any rights on the part of the Applicant or Property Owner to receive a permit from a state or federal agency, and does not create any liability on the part of Seminole County for issuance of the Development Order if the Applicant or Property Owner fails to obtain requisite approvals or fulfill the obligations imposed by a state or federal agency or undertakes actions that result in a violation of state or federal law.

(9) In approval of this Development Order by Seminole County, the property owner(s) understands that the County must receive a Final Development Plan within five (5) years of approval of the Master Development Plan, unless this time period is extended by the Seminole County Local Planning Agency / Planning and Zoning Commission. If substantial development has not begun within eight (8) years after approval of the Master Development Plan, the planned development will be subject to review by the Local Planning Agency / Planning and Zoning Commission and the Board of County Commissioners may move to rezone the subject property to a more appropriate zoning or extend the deadline for start of construction (see Sections 30.446 and 449, LDC).

(10) This Order becomes effective upon recording with the Seminole County Clerk of the Court. However, in no case will this Order be effective prior to the effective date of the associated comprehensive plan amendment enacted in association with Sanford Commerce Center PD (as referenced in Exhibit A), on August 11, 2026.

FILE NO.: PZ2026-06

DEVELOPMENT ORDER #

26-20500003

Done and Ordered on the date first written above.

**SEMINOLE COUNTY BOARD
OF COUNTY COMMISSIONERS**

By: _____
ANDRIA HERR, CHAIRMAN

EXHIBIT A Master Development Plan

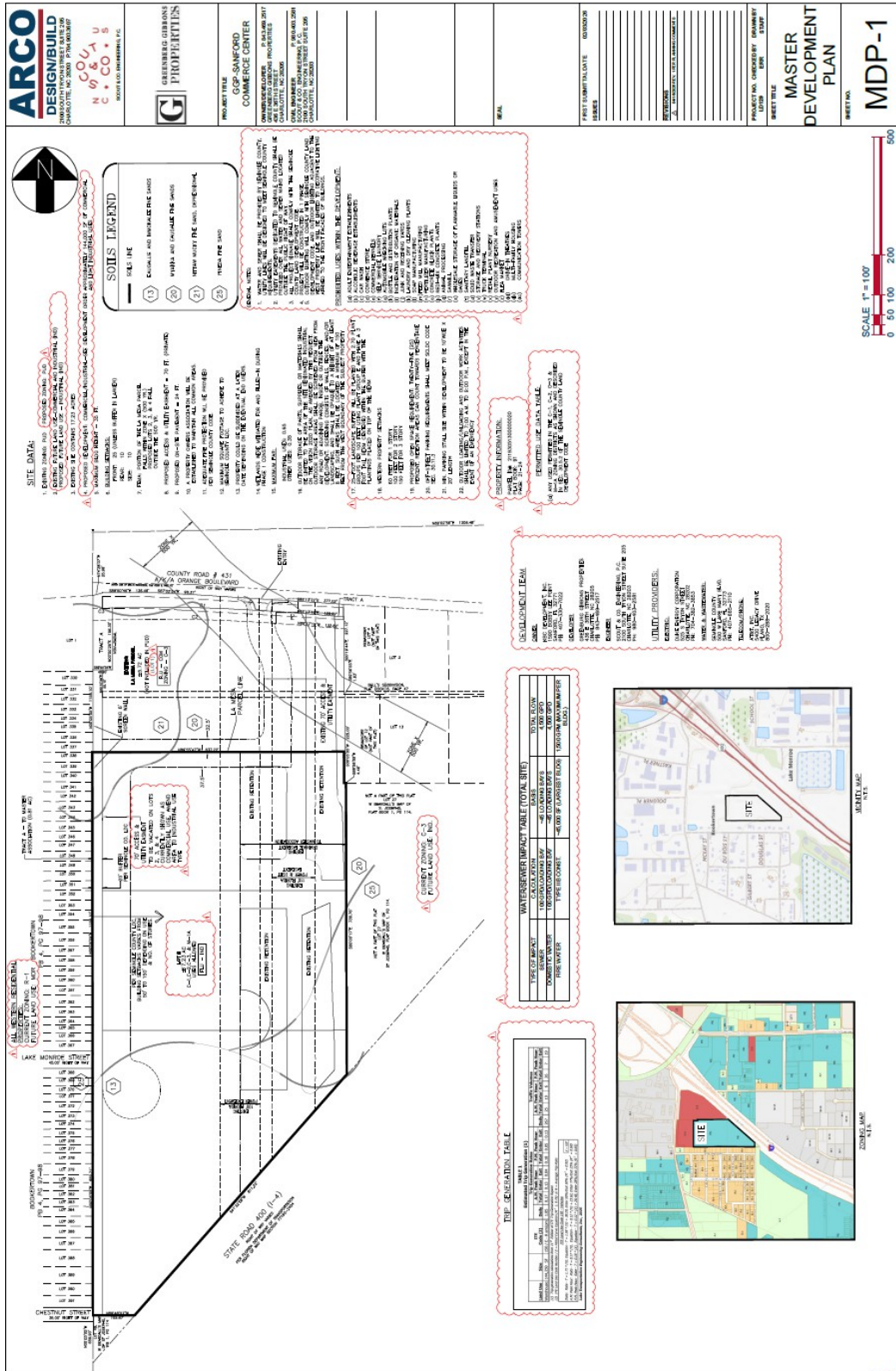

ARCO DESIGN/BUILD
 10000 W. STATE ROAD 600, SUITE 200
 DOWNSVILLE, MO 65029 P: 660.237.1000
C O U N T Y
M O & A U
 1000 W. STATE ROAD 600, SUITE 200
 DOWNSVILLE, MO 65029 P: 660.237.1000

GREENBERG GRASSANO PROPERTIES

PROJECT NAME: GGP-SANFORD COMMERCE CENTER

OWNER: GREENBERG GRASSANO PROPERTIES

PROJECT NO. UNIVERSITY DRIVE

SHEET NO. MDP-1

SITE DATA:

1. COUNTY: DOWNSVILLE, MO
2. COUNTY ROAD NO. 437
3. COUNTY ROAD NO. 600
4. COUNTY ROAD NO. 200
5. COUNTY ROAD NO. 100
6. COUNTY ROAD NO. 50
7. COUNTY ROAD NO. 25
8. COUNTY ROAD NO. 12.5
9. COUNTY ROAD NO. 6.25
10. COUNTY ROAD NO. 3.125
11. COUNTY ROAD NO. 1.5625
12. COUNTY ROAD NO. 0.78125
13. COUNTY ROAD NO. 0.390625
14. COUNTY ROAD NO. 0.1953125
15. COUNTY ROAD NO. 0.09765625
16. COUNTY ROAD NO. 0.048828125
17. COUNTY ROAD NO. 0.0244140625
18. COUNTY ROAD NO. 0.01220703125
19. COUNTY ROAD NO. 0.006103515625
20. COUNTY ROAD NO. 0.0030517578125
21. COUNTY ROAD NO. 0.00152587890625
22. COUNTY ROAD NO. 0.000762939453125
23. COUNTY ROAD NO. 0.0003814697265625
24. COUNTY ROAD NO. 0.00019073486328125
25. COUNTY ROAD NO. 0.000095367431640625
26. COUNTY ROAD NO. 0.0000476837158203125
27. COUNTY ROAD NO. 0.00002384185791015625
28. COUNTY ROAD NO. 0.000011920928955078125
29. COUNTY ROAD NO. 0.0000059604644775390625
30. COUNTY ROAD NO. 0.00000298023223876953125
31. COUNTY ROAD NO. 0.000001490116119384765625
32. COUNTY ROAD NO. 0.0000007450580596923828125
33. COUNTY ROAD NO. 0.00000037252902984619140625
34. COUNTY ROAD NO. 0.000000186264514923095703125
35. COUNTY ROAD NO. 0.0000000931322574615478515625
36. COUNTY ROAD NO. 0.00000004656612873077392578125
37. COUNTY ROAD NO. 0.000000023283064365386962890625
38. COUNTY ROAD NO. 0.0000000116415321826934814453125
39. COUNTY ROAD NO. 0.00000000582076609134674072265625
40. COUNTY ROAD NO. 0.000000002910383045673370361328125
41. COUNTY ROAD NO. 0.0000000014551915228366851806640625
42. COUNTY ROAD NO. 0.00000000072759576141834259033203125
43. COUNTY ROAD NO. 0.000000000363797880709171245166015625
44. COUNTY ROAD NO. 0.0000000001818989403545856225780078125
45. COUNTY ROAD NO. 0.00000000009094947017729281128900390625
46. COUNTY ROAD NO. 0.000000000045474735088646405644501953125
47. COUNTY ROAD NO. 0.0000000000227373675443232028222509765625
48. COUNTY ROAD NO. 0.00000000001136868377216160141112548828125
49. COUNTY ROAD NO. 0.00000000000568434188608007055562444140625
50. COUNTY ROAD NO. 0.0000000000028421709430400352778122201953125
51. COUNTY ROAD NO. 0.00000000000142108547152001763890611009765625
52. COUNTY ROAD NO. 0.00000000000071054273576000881945305548828125
53. COUNTY ROAD NO. 0.00000000000035527136788000440972727390140625
54. COUNTY ROAD NO. 0.0000000000001776356839400022048636369509765625
55. COUNTY ROAD NO. 0.00000000000008881784197000110243181847548828125
56. COUNTY ROAD NO. 0.0000000000000444089209850005512159092377390625
57. COUNTY ROAD NO. 0.00000000000002220446049250027560795461886953125
58. COUNTY ROAD NO. 0.000000000000011102230246250137803977309437765625
59. COUNTY ROAD NO. 0.0000000000000055511151231250689019866471887890625
60. COUNTY ROAD NO. 0.00000000000000277555756156253445099332359437765625
61. COUNTY ROAD NO. 0.0000000000000013877787807812517225496616617890625
62. COUNTY ROAD NO. 0.00000000000000069388939039062508612733308309437765625
63. COUNTY ROAD NO. 0.0000000000000003469446951953125043063665415471887890625
64. COUNTY ROAD NO. 0.00000000000000017347234759765625021531832707359437765625
65. COUNTY ROAD NO. 0.0000000000000000867361737988281250107659163367890625
66. COUNTY ROAD NO. 0.00000000000000004336808689941406250538295816839437765625
67. COUNTY ROAD NO. 0.00000000000000002168404344970703125026914790819437765625
68. COUNTY ROAD NO. 0.000000000000000010842021724853515625013457395097359437765625
69. COUNTY ROAD NO. 0.00000000000000000542101086242675781250067286954867890625
70. COUNTY ROAD NO. 0.000000000000000002710505431213378906250033643474339437765625
71. COUNTY ROAD NO. 0.00000000000000000135525271560668953125001682173716971887890625
72. COUNTY ROAD NO. 0.00000000000000000067762635780334476562500084108688439437765625
73. COUNTY ROAD NO. 0.00000000000000000033881317890167173281250004205434421887890625
74. COUNTY ROAD NO. 0.0000000000000000001694065894535358656250002102717109437765625
75. COUNTY ROAD NO. 0.00000000000000000008470329472676793281250001051355471887890625
76. COUNTY ROAD NO. 0.00000000000000000004235164736338396562500005256777359437765625
77. COUNTY ROAD NO. 0.0000000000000000000211758236816669828125000026283886971887890625
78. COUNTY ROAD NO. 0.00000000000000000001058791184083349140625000013141943437765625
79. COUNTY ROAD NO. 0.000000000000000000005293955920416745312500000657097171887890625
80. COUNTY ROAD NO. 0.0000000000000000000026469779602083726562500000328548589437765625
81. COUNTY ROAD NO. 0.0000000000000000000013234889801041863281250000016427429437765625
82. COUNTY ROAD NO. 0.000000000000000000000661744490052093164062500000821371471887890625
83. COUNTY ROAD NO. 0.00000000000000000000033087224502604658125000004106857359437765625
84. COUNTY ROAD NO. 0.0000000000000000000001654361225130232906250000020534286971887890625
85. COUNTY ROAD NO. 0.00000000000000000000008271806125651514531250000010267143437765625
86. COUNTY ROAD NO. 0.0000000000000000000000413590306282575726562500000513357171887890625
87. COUNTY ROAD NO. 0.000000000000000000000020679515314128789062500000256678589437765625
88. COUNTY ROAD NO. 0.000000000000000000000010339757657064394377656250000012833929437765625
89. COUNTY ROAD NO. 0.000000000000000000000005169878828532197188789062500000641696471887890625
90. COUNTY ROAD NO. 0.0000000000000000000000025849394142650989437765625000003208482359437765625
91. COUNTY ROAD NO. 0.000000000000000000000001292469707132754968971887890625000001604241171887890625
92. COUNTY ROAD NO. 0.000000000000000000000000646234853566377473437765625000000802120589437765625
93. COUNTY ROAD NO. 0.0000000000000000000000003231174267831887188789062500000040106029437765625
94. COUNTY ROAD NO. 0.00000000000000000000000016155871339159359377656250000002005301471887890625
95. COUNTY ROAD NO. 0.00000000000000000000000008077935695279679689718878906250000010026507359437765625
96. COUNTY ROAD NO. 0.00000000000000000000000004038967847639839843776562500000050132536971887890625
97. COUNTY ROAD NO. 0.000000000000000000000000020194839238199199218878906250000025066268437765625
98. COUNTY ROAD NO. 0.00000000000000000000000001009741961909959960937765625000001253313421887890625
99. COUNTY ROAD NO. 0.000000000000000000000000005048709809549799804689718878906250000062665671887890625
100. COUNTY ROAD NO. 0.0000000000000000000000000025243549047724899902343776562500000313328359437765625
101. COUNTY ROAD NO. 0.000000000000000000000000001262177452386244999517188789062500000156664171887890625
102. COUNTY ROAD NO. 0.00000000000000000000000000063108872619312249975894377656250000078332086971887890625
103. COUNTY ROAD NO. 0.0000000000000000000000000003155443630965612498794377656250000039166043437765625
104. COUNTY ROAD NO. 0.0000000000000000000000000001577721815482806249437765625000001958302171887890625
105. COUNTY ROAD NO. 0.00000000000000000000000000007888609077414031247188789062500000979151086971887890625
106. COUNTY ROAD NO. 0.000000000000000000000000000039443045387070156188789062500000489575543437765625
107. COUNTY ROAD NO. 0.000000000000000000000000000019721522693535078093776562500000244787771887890625
108. COUNTY ROAD NO. 0.000000000000000000000000000009860761346767539046897188789062500000122393886971887890625
109. COUNTY ROAD NO. 0.0000000000000000000000000000049303806733837695234377656250000061196943437765625
110. COUNTY ROAD NO. 0.000000000000000000000000000002465190336691884761718878906250000030598471887890625
111. COUNTY ROAD NO. 0.00000000000000000000000000000123259516833454238093776562500000152992359437765625
112. COUNTY ROAD NO. 0.0000000000000000000000000000006162975841672711904689718878906250000076496171887890625
113. COUNTY ROAD NO. 0.000000000000000000000000000000308148792083635595234377656250000038248086971887890625
114. COUNTY ROAD NO. 0.0000000000000000000000000000001540743960418177797689718878906250000019124043437765625
115. COUNTY ROAD NO. 0.0000000000000000000000000000000770371980209088898843776562500000956202171887890625
116. COUNTY ROAD NO. 0.000000000000000000000000000000038518599010454444943776562500000478101086971887890625
117. COUNTY ROAD NO. 0.00000000000000000000000000000001925929950522722247188789062500000239050543437765625
118. COUNTY ROAD NO. 0.000000000000000000000000000000009629649752613611238093776562500000119525271887890625
119. COUNTY ROAD NO. 0.000000000000000000000000000000004814824876306805619046897188789062500000597626359437765625
120. COUNTY ROAD NO. 0.00000000000000000000000000000000240741243815340280952343776562500000298813171887890625
121. COUNTY ROAD NO. 0.0000000000000000000000000000000012037062190767201404689718878906250000149406589437765625
122. COUNTY ROAD NO. 0.00000000000000000000000000000000060185310953836007023437765625000007470329437765625
123. COUNTY ROAD NO. 0.00000000000000000000000000000000030092655476918003511718878906250000373516471887890625
124. COUNTY ROAD NO. 0.000000000000000000000000000000000150463277384590017558943776562500001867582359437765625
125. COUNTY ROAD NO. 0.00000000000000000000000000000000007523163869229500877943776562500000933791171887890625
126. COUNTY ROAD NO. 0.0000000000000000000000000000000000376158193461475004389718878906250000466895589437765625
127. COUNTY ROAD NO. 0.0000000000000000000000000000000000188079096730737500219437765625000023344779437765625
128. COUNTY ROAD NO. 0.00000000000000000000000000000000000940395483653687501097188789062500001167238971887890625
129. COUNTY ROAD NO. 0.00000000000000000000000000000000000470197741826843750054859377656250000583619437765625
130. COUNTY ROAD NO. 0.000000000000000000000000000000000002350988709133425002742968971887890625000029180971887890625
131. COUNTY ROAD NO. 0.00000000000000000000000000000000000117549435456671250137148437765625000014590486971887890625
132. COUNTY ROAD NO. 0.00000000000000000000000000000000000587747177283356250685742188789062500007295243437765625
133. COUNTY ROAD NO. 0.00000000000000000000000000000000000293873588641678125034287109377656250000364762171887890625
134. COUNTY ROAD NO. 0.000000000000000000000000000000000001469367943208390625017143554689718878906250000182381086971887890625
135. COUNTY ROAD NO. 0.0000000000000000000000000000000000007346839716041953125085717773437765625000091190543437765625
136. COUNTY ROAD NO. 0.0000000000000000000000000000000000003673419858020976562504285888671887890625000045595271887890625
137. COUNTY ROAD NO. 0.0000000000000000000000000000000000001836709929010488281250214294377656250000227976359437765625
138. COUNTY ROAD NO. 0.00000000000000000000000000000000000009183549645052444140625010714718878906250000113988171887890625
139. COUNTY ROAD NO. 0.0000000000000000000000000000000000000459177482252622201937765625000056994086971887890625
140. COUNTY ROAD NO. 0.0000000000000000000000000000000000000229588741126311100937765625000028497043437765625
141. COUNTY ROAD NO. 0.000000000000000000000000000000000000011479437056315555046897188789062500001424852171887890625
142. COUNTY ROAD NO. 0.0000000000000000000000000000000000000057397185281577750234377656250000712426359437765625
143. COUNTY ROAD NO. 0.0000000000000000000000000000000000000028698592640788875011718878906250000356213171887890625
144. COUNTY ROAD NO. 0.000000000000000000000000000000000000001434929632039443750058510689718878906250000178106589437765625
145. COUNTY ROAD NO. 0.000000000000000000000000000000000000000717464816019721875029255343776562500008905329437765625
146. COUNTY ROAD NO. 0.00000000000000000000000000000000000000035873240800986093750146276689718878906250000445266471887890625
147. COUNTY ROAD NO. 0.00000000000000000000000000000000000000017936620400493046875007313843776562500002226332359437765625
148. COUNTY ROAD NO. 0.00896831020024652343750036569218878906250000111316589437765625
149. COUNTY ROAD NO. 0.004484155100123261718750182846093776562500005565829437765625
150. COUNTY ROAD NO. 0.002242077550061630875009142304689718878906250000278291471887890625
151. COUNTY ROAD NO. 0.0011210387750030816375004571115343776562500001391457359437765625
152. COUNTY ROAD NO. 0.0005605193875015408187500228555766897188789062500006957286971887890625
153. COUNTY ROAD NO. 0.0002802596937507704093750011427778843776562500003478643437765625
154. COUNTY ROAD NO. 0.00014012984687503852046875005713889218878906250000173932171887890625
155. COUNTY ROAD NO. 0.0070064923437501926023437500285694468971887890625000086966086971887890625
156. COUNTY ROAD NO. 0.000000000