

Property Record Card

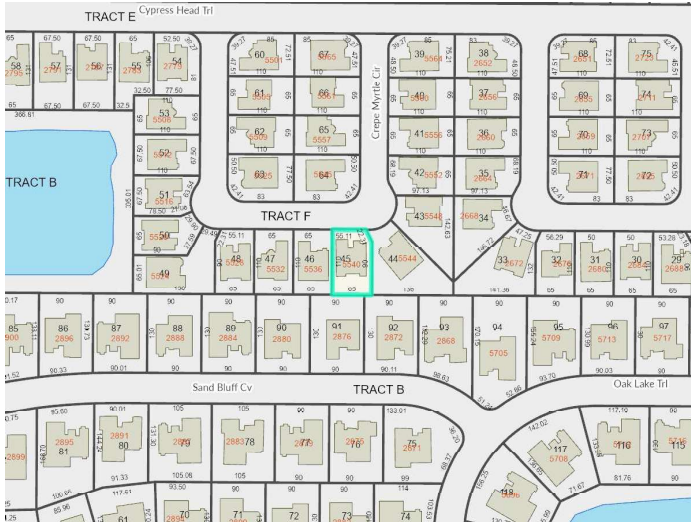

Parcel: 29-21-31-504-0000-0450
Property Address: 5540 CREPE MYRTLE CIR OVIEDO, FL 32765
Owners: SCHATTE, DANIEL M; SCHATTE, MEREDITH R
 2025 Market Value \$469,614 Assessed Value \$222,669 Taxable Value \$171,947
 2024 Tax Bill \$2,329.87 Tax Savings with Exemptions \$3,771.04
 The 4 Bed/3.5 Bath Single Family property is 2,064 SF and a lot size of 0.16 Acres

Parcel Location



Site View



Parcel Information

Parcel	29-21-31-504-0000-0450
Property Address	5540 CREPE MYRTLE CIR OVIEDO, FL 32765
Mailing Address	5540 CREPE MYRTLE CIR OVIEDO, FL 32765-7388
Subdivision	ALOMA WOODS PH 5
Tax District	01:County Tax District
DOR Use Code	01:Single Family
Exemptions	00-HOMESTEAD (2001)
AG Classification	No

Value Summary

	2025 Working Values	2024 Certified Values
Valuation Method	Cost/Market	Cost/Market
Number of Buildings	1	1
Depreciated Building Value	\$335,014	\$327,275
Depreciated Other Features	\$24,600	\$24,600
Land Value (Market)	\$110,000	\$110,000
Land Value Agriculture	\$0	\$0
Just/Market Value	\$469,614	\$461,875
Portability Adjustment	\$0	\$0
Save Our Homes Adjustment/Maximum Portability	\$246,945	\$245,481
Non-Hx 10% Cap (AMD 1)	\$0	\$0
P&G Adjustment	\$0	\$0
Assessed Value	\$222,669	\$216,394

2024 Certified Tax Summary

Tax Amount w/o Exemptions	\$6,100.91
Tax Bill Amount	\$2,329.87
Tax Savings with Exemptions	\$3,771.04

Note: Does NOT INCLUDE Non Ad Valorem Assessments

Owner(s)

Name - Ownership Type

SCHATTE, DANIEL M - Tenancy by Entirety
 SCHATTE, MEREDITH R - Tenancy by Entirety

Legal Description

LOT 45 ALOMA WOODS PH 5 PB 53 PGS 11
THRU 13

Taxes

Taxing Authority	Assessed	Exempt Amount	Taxable
COUNTY GENERAL FUND	\$222,669	\$50,722	\$171,947
Schools	\$222,669	\$25,000	\$197,669
FIRE	\$222,669	\$50,722	\$171,947
ROAD DISTRICT	\$222,669	\$50,722	\$171,947
SJWM(Saint Johns Water Management)	\$222,669	\$50,722	\$171,947

Sales

Deed Type	Date	Sale Amount	Book / Page	Sale Type	Qualified?
WARRANTY DEED	12/1/2000	\$177,000	03982/1384	Improved	Yes
SPECIAL WARRANTY DEED	6/1/1998	\$139,800	03471/0202	Improved	Yes
WARRANTY DEED	3/1/1998	\$140,000	03390/0922	Vacant	No

Land

Units	Rate	Assessed	Market
1 Lot	\$110,000/Lot	\$110,000	\$110,000

Building Information

#	1
Use	SINGLE FAMILY
Year Built*	1998
Bed	4
Bath	3.5
Fixtures	10
Base Area (ft ²)	2064
Total Area (ft ²)	2741
Constuction	CB/STUCCO FINISH
Replacement Cost	\$374,317
Assessed	\$335,014

* Year Built = Actual / Effective

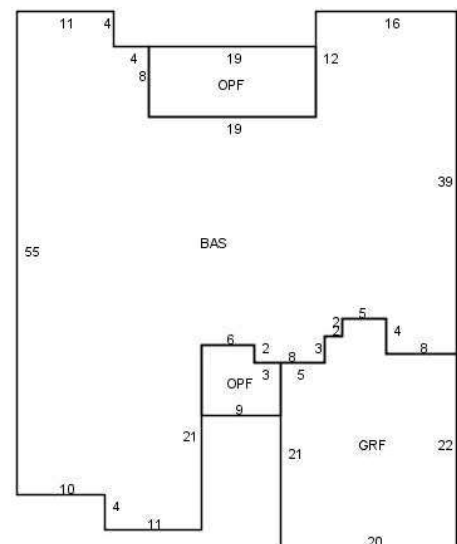

Building 1

Appendages

Description	Area (ft ²)
-------------	-------------------------

GARAGE FINISHED	459
OPEN PORCH FINISHED	66
OPEN PORCH FINISHED	152

Permits

Permit #	Description	Value	CO Date	Permit Date
07454	REPLACING 12 WINDOWS & 2 DOORS - ALL SIZE FOR SIZE	\$10,990		6/27/2016
06198	A/C CHANGE	\$6,146		6/10/2008
02497	POOL SCRIN ENCL	\$3,491		2/2/2005
09567	SWIMMING POOL	\$16,500		8/23/2004
01619		\$159,487	6/29/1998	3/1/1998

Extra Features

Description	Year Built	Units	Cost	Assessed
POOL 1	2005	1	\$35,000	\$21,000
SOLAR HEATER	2005	1	\$0	\$0
SCREEN ENCL 2	2005	1	\$9,000	\$3,600

Zoning

Zoning	R-1B
Description	Single Family-6700
Future Land Use	MDR
Description	Medium Density Residential

School Districts

Elementary	Evans
Middle	Tuskawilla
High	Lake Howell

Political Representation

Commissioner	District 1 - Bob Dallari
US Congress	District 7 - Cory Mills
State House	District 37 - Susan Plasencia
State Senate	District 10 - Jason Brodeur
Voting Precinct	Precinct 75

Utilities

Fire Station #	Station: 29 Zone: 291
Power Company	DUKE
Phone (Analog)	AT&T
Water	Seminole County Utilities
Sewage	Seminole County Utilities
Garbage Pickup	MON/THU
Recycle	MON
Yard Waste	WED
Hauler #	Waste Pro

Property Value History

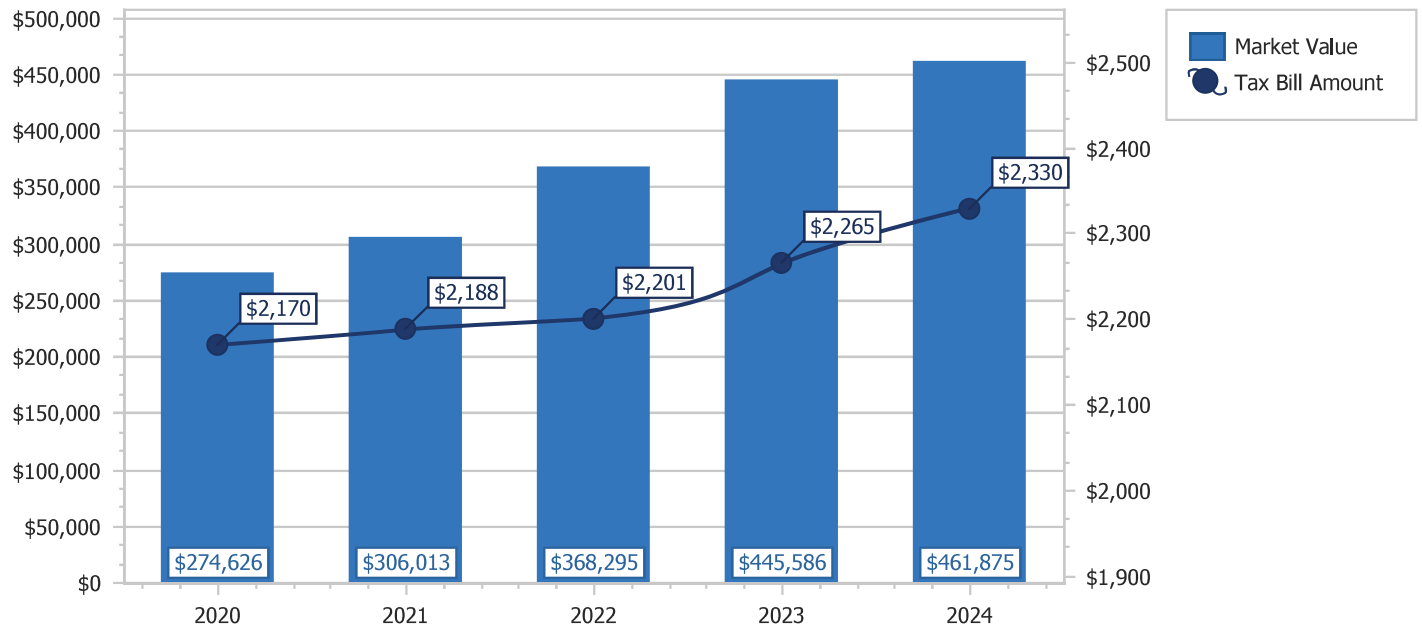

Copyright 2025 © Seminole County Property Appraiser