

Property Record Card



Parcel: **14-20-29-502-0000-0110**
 Property Address: **28 WINDSOR ISLE LONGWOOD, FL 32779**
 Owners: **POLITI, GIOVANNA; GOMEZ, FRANCISCO A**
 2025 Market Value \$665,915 Assessed Value \$350,540 Taxable Value \$299,818
 2024 Tax Bill \$3,971.32 Tax Savings with Exemptions \$2,536.65
 The 4 Bed/2.5 Bath Single Family Waterfront property is 2,327 SF and a lot size of 2.46 Acres

Parcel Location



Site View



Parcel Information

Parcel	14-20-29-502-0000-0110
Property Address	28 WINDSOR ISLE LONGWOOD, FL 32779
Mailing Address	28 WINDSOR ISLE DR LONGWOOD, FL 32779-9755
Subdivision	ISLE OF WINDSOR
Tax District	01:County Tax District
DOR Use Code	0130:Single Family Waterfront
Exemptions	00-HOMESTEAD (2019)
AG Classification	No

Value Summary

	2025 Working Values	2024 Certified Values
Valuation Method	Cost/Market	Cost/Market
Number of Buildings	1	1
Depreciated Building Value	\$249,180	\$280,749
Depreciated Other Features	\$36,735	\$36,943
Land Value (Market)	\$380,000	\$175,000
Land Value Agriculture	\$0	\$0
Just/Market Value	\$665,915	\$492,692
Portability Adjustment	\$0	\$0
Save Our Homes Adjustment/Maximum Portability	\$315,375	\$152,031
Non-Hx 10% Cap (AMD 1)	\$0	\$0
P&G Adjustment	\$0	\$0
Assessed Value	\$350,540	\$340,661

2024 Certified Tax Summary

Tax Amount w/o Exemptions	\$6,507.97
Tax Bill Amount	\$3,971.32
Tax Savings with Exemptions	\$2,536.65

Owner(s)

Name - Ownership Type

POLITI, GIOVANNA - Tenancy by Entirety
 GOMEZ, FRANCISCO A - Tenancy by Entirety

Note: Does NOT INCLUDE Non Ad Valorem Assessments

Legal Description

LOT 11 ISLE OF WINDSOR PB 15 PG 91

Taxes

Taxing Authority	Assessed	Exempt Amount	Taxable
COUNTY GENERAL FUND	\$350,540	\$50,722	\$299,818
Schools	\$350,540	\$25,000	\$325,540
FIRE	\$350,540	\$50,722	\$299,818
ROAD DISTRICT	\$350,540	\$50,722	\$299,818
SJWM(Saint Johns Water Management)	\$350,540	\$50,722	\$299,818

Sales

Deed Type	Date	Sale Amount	Book / Page	Sale Type	Qualified?
WARRANTY DEED	4/1/2018	\$419,900	09111/1088	Improved	Yes
WARRANTY DEED	4/1/2002	\$230,000	04394/0596	Improved	Yes
WARRANTY DEED	4/1/1981	\$134,500	01331/1024	Improved	Yes
WARRANTY DEED	10/1/1979	\$100,000	01249/1605	Improved	Yes

Land

Units	Rate	Assessed	Market
1 Lot	\$380,000/Lot	\$380,000	\$380,000

Building Information

#	1
Use	SINGLE FAMILY
Year Built*	1971/1990
Bed	4
Bath	2.5
Fixtures	9
Base Area (ft ²)	2207
Total Area (ft ²)	3524
Constuction	CB/STUCCO FINISH
Replacement Cost	\$294,887
Assessed	\$249,180

* Year Built = Actual / Effective

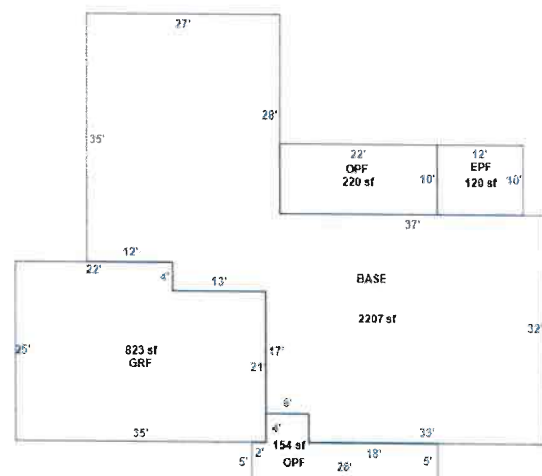

Building 1

Appendages	
Description	Area (ft ²)
ENCLOSED PORCH FINISHED	120
GARAGE FINISHED	823
OPEN PORCH FINISHED	220
OPEN PORCH FINISHED	154

Permits				
Permit #	Description	Value	CO Date	Permit Date
10117	WINDOW/DOOR REPLACEMENT	\$35,965		6/26/2018
02042	ELECTRICAL	\$1,500		2/5/2018
9917	REROOF	\$16,650		7/20/2017
00620	HEAT PUMP	\$4,900		1/18/2008
12163	REPLACE SCREEN POOL ENCLOSURE DAMAGED BY HURRICANE	\$13,000		10/13/2004
06202	FENCE/WALL	\$1,248		6/1/2002
09747	REROOF 40 SQ	\$5,500		10/1/2001

Extra Features					
Description	Year Built	Units	Cost	Assessed	
POOL 2	1971	1	\$45,000	\$27,000	
FIREPLACE 2	1971	1	\$6,000	\$2,400	
BOAT DOCK 1	2017	1	\$3,000	\$2,160	
PATIO 2	2002	1	\$3,500	\$1,575	
SCREEN ENCL 2	2005	1	\$9,000	\$3,600	
SHED - NO VALUE	1980	1	\$0	\$0	

Zoning	
Zoning	RC-1
Description	Country Homes-1Ac
Future Land Use	SE
Description	Suburban Estates

School Districts	
Elementary	Woodlands
Middle	Markham Woods
High	Lake Mary

Political Representation	
Commissioner	District 5 - Andria Herr
US Congress	District 7 - Cory Mills
State House	District 39 - Doug Bankson
State Senate	District 10 - Jason Brodeur
Voting Precinct	Precinct 32

Utilities	
Fire Station #	Station: 36 Zone: 363
Power Company	DUKE
Phone (Analog)	AT&T
Water	Seminole County Utilities
Sewage	Seminole County Utilities
Garbage Pickup	TUE/FRI
Recycle	FRI
Yard Waste	WED
Hauler #	Waste Pro

Property Value History

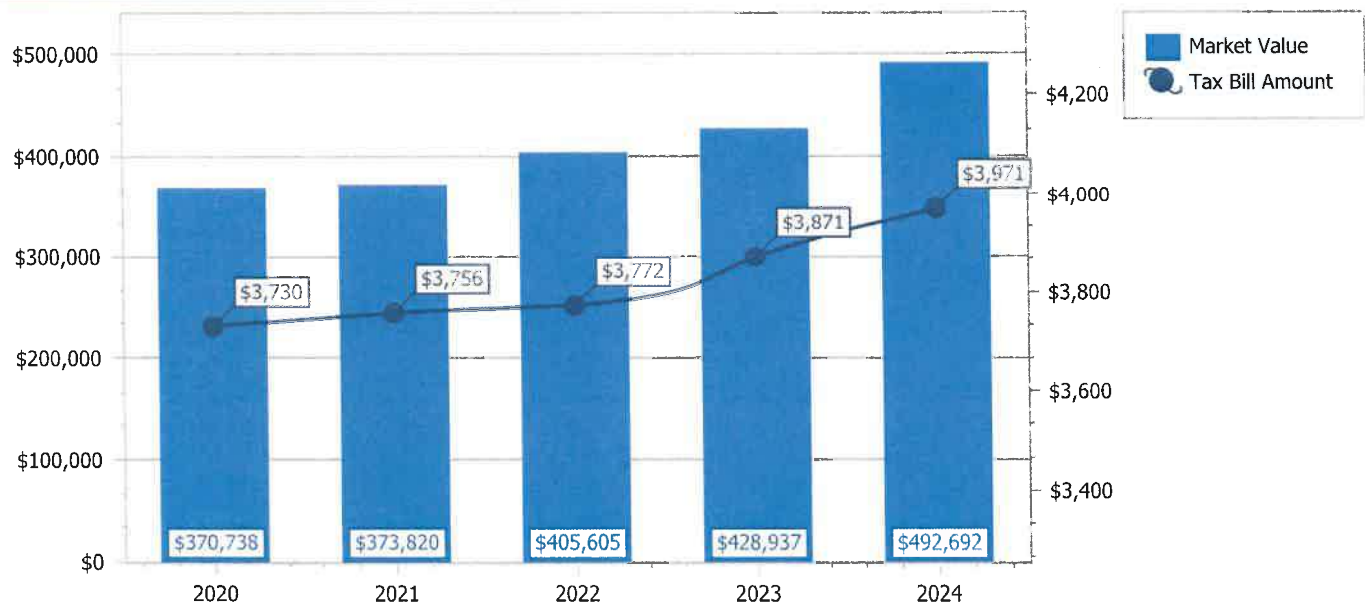

Copyright 2025 © Seminole County Property Appraiser