

CONTINUOUS HANDRAIL 1AW
FBC SECTION R311, INSTALL
34"-38" ABV. TREAD NOSING

BALUSTRADE HANDRAIL BRACKET AT
6'-6" O.C. MAX- SELECTED BY OTHERS
-SEE MANUFACT. RECOMMENDATIONS
FOR ATTACHMENT

SOLID 2X4 WOOD BLOCKING
AT EACH BRACKET

TYPICAL INTERIOR WALL
CONSTRUCTION

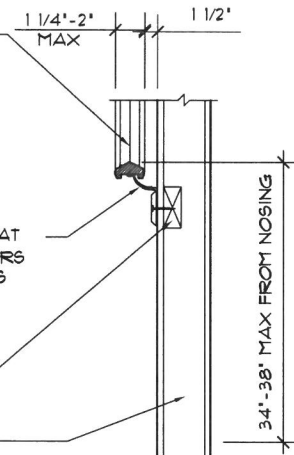

3
ST-1 TYP. HANDRAIL DET.

3/4" = 1'-0" (11X17) 1/2" = 1'-0" (22'X34')

NOTES:

STAIRWAY CONSTRUCTION TO CONFORM TO FBCR 2023, 8TH EDITION SECTION R311.1

MAX. HGT. OF RISER TO BE 7 1/2"; WITH THE GREATEST RISER HEIGHT NOT EXCEEDING THE SMALLEST BY MORE THAN 3/8".

MIN. DEPTH OF TREAD TO BE NO LESS THAN 10", WITH THE GREATEST TREAD DEPTH NOT EXCEEDING THE SMALLEST BY MORE THAN 3/8".

WINDER TREADS SHALL HAVE A TREAD DEPTH OF NO LESS THAN 10" MEASURED BETWEEN THE VERTICAL PLANES OF THE FOREMOST PROJECTION MEASURED AT THE WALK-LINE.

WINDER TREADS SHALL HAVE A TREAD DEPTH OF NO LESS THAN 6" AT ANY POINT WITHIN THE CLEAR WIDTH OF THE STAIR.

THE LARGEST WINDER TREAD DEPTH AT THE WALKLINE SHALL NOT EXCEED THE SMALLEST WINDER BY MORE THAN 3/8".

CONSISTENTLY SHAPED WINDERS AT THE WALKLINE SHALL BE ALLOWED WITHIN THE SAME FLIGHT OF STAIRS AS RECTANGULAR TREADS AND DO NOT NEED TO BE WITHIN 3/8" OF THE RECTANGULAR TREAD DEPTH.

HANDRAIL CIRCULAR CROSS SECTION DIA TO BE 1 1/2" - 2" OR TO PROVIDE EQUIVALENT GRASPABILITY.

34"-38" HANDRAIL HGT. MEASURED FROM THE SLOPED PLANE ADJOINING THE TREAD NOSING OR FINISH SURFACE OF RAMP SLOPE.

HEADROOM IN STAIRWAYS SHALL BE NOT LESS THAN 6'-8" MEASURED VERTICALLY FROM THE SLOPED LINE ADJOINING THE TREAD NOSING OR FROM THE FLOOR SURFACE OF THE LANDING OR PLATFORM ON THAT PORTION OF THE STAIRWAY.

R312.13 OPENING LIMITATIONS.
REQUIRED GUARDS SHALL NOT HAVE OPENINGS FROM THE WALKING SURFACE TO THE REQUIRED GUARD HEIGHT THAT ALLOW PASSAGE OF A SPHERE 4 INCHES (102 MM) IN DIAMETER.

EXCEPTIONS:

1. THE TRIANGULAR OPENINGS AT THE OPEN SIDE OF STAIR FORMED BY THE RISER, TREAD AND BOTTOM RAIL OF A GUARD, SHALL NOT ALLOW PASSAGE OF A SPHERE 6 INCHES (153 MM) IN DIAMETER.

2. GUARDS ON THE OPEN SIDE OF STAIRS SHALL NOT HAVE OPENINGS THAT ALLOW PASSAGE OF A SPHERE 4 1/2 INCHES (113 MM) IN DIAMETER.

1
ST-1 ELEVATION VIEW

SCALE: 1/2" = 1'-0"

MATERIAL LIST:

- POSTS: 6X6 PRESSURE TREATED SYP #1
- LANDING: 2X8 PRESSURE TREATED SYP #2
- RAILING: 2X6 PRESSURE TREATED SYP #2
- SPINDLES: 2X2 PRESSURE TREATED SYP #2
- STRINGERS: 2X12 PRESSURE TREATED SYP #2
- DECK: 1X6 COMPOSITE (INCLUDES POST & RAIL CAP)
- HARDWARE: ALL HARDWARE IS HOT DIPPED GALVANIZED

2
ST-1 PLAN VIEW

SCALE: 1/2" = 1'-0"

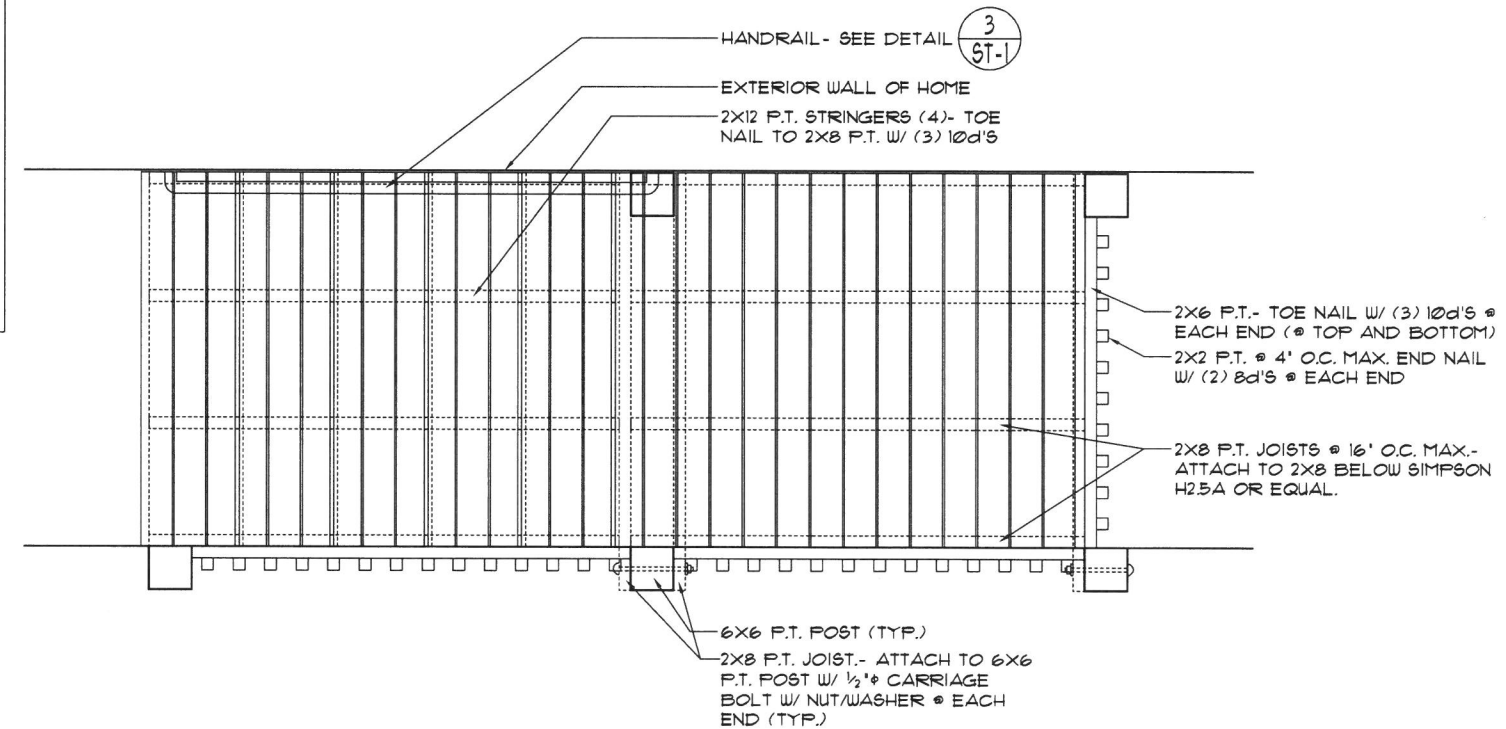
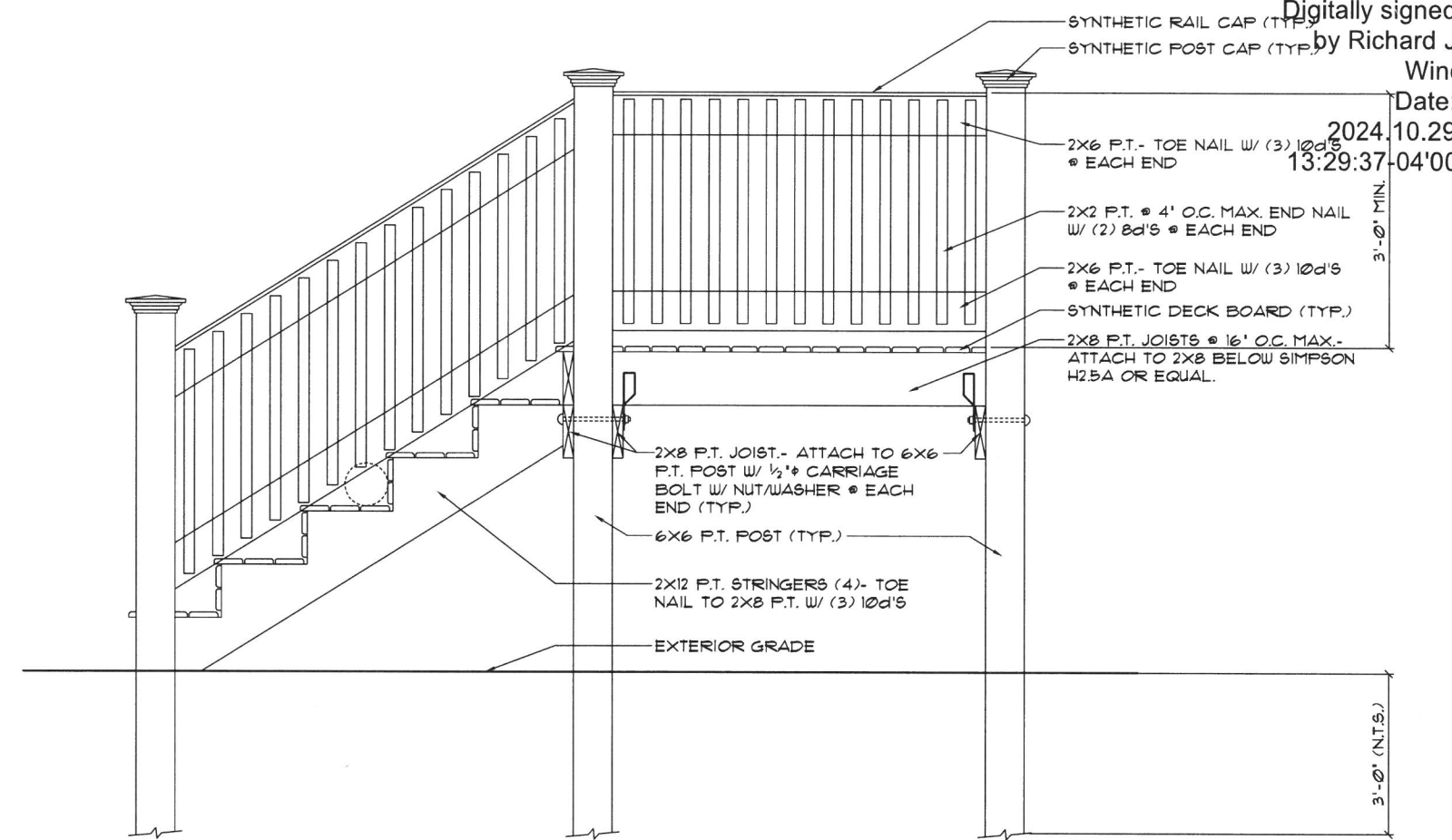

Digitally signed
by Richard J. Wind
Date: 2024.10.29
13:29:37-04'00



By: RICHARD J. WIND, R.A.
4301 WILAND RD. E-1
ORLANDO, FL 32811
PHONE: 407-830-1111
RJVWIND@GMAIL.COM



THIS DOCUMENT HAS BEEN ELECTRONICALLY SIGNED AND SEALED BY RICHARD J. WIND, R.A. ON THE DATE SHOWN ON THE TIME STAMP USING A DIGITAL SIGNATURE. PRINTED COPIES OF THIS DOCUMENT ARE NOT CONSIDERED SIGNED AND SEALED AND THE SIGNATURE MUST BE VERIFIED ON ANY ELECTRONIC COPY.

THIS DOCUMENT IS DESIGNED TO WITHSTAND 140 MPH WINDS PER THE FLORIDA RESIDENTIAL CODE 2020, 11th EDITION.

LOT SPECIFIC INFORMATION
RDC, Inc. hereby reserves its common law copyrights and other copyrights in these plans, ideas, and design. These plans, ideas and designs are not to be copied or changed in any manner or form whatsoever, nor are they to be assigned to any third party without first obtaining the express written permission from RDC, Inc.

3550 HOLIDAY AVE
NINIO RESIDENCE

DATE	11-11-22
SCALE AS NOTED	
DRAWN	RDC
JOB	3944
SHEET	
OF 34 SHEETS	