

# Property Record Card



**Parcel:** 08-21-29-501-0000-006A  
**Property Address:** 1021 NEW JERSEY AVE ALTAMONTE SPRINGS, FL 32714  
**Owners:** DONALD R LOOMIS JR REV TRUST  
 2026 Market Value \$494,841 Assessed Value \$289,117 Taxable Value \$237,706  
 2025 Tax Bill \$3,292.05 Tax Savings with Exemptions \$3,494.62  
 The 3 Bed/3.5 Bath Single Family property is 2,864 SF and a lot size of 0.42 Acres

## Parcel Location



## Site View



## Parcel Information

Parcel	08-21-29-501-0000-006A
Property Address	1021 NEW JERSEY AVE ALTAMONTE SPRINGS, FL 32714
Mailing Address	1021 NEW JERSEY AVE ALTAMONTE SPG, FL 32714-2606
Subdivision	LITTLE WASHINGTON ESTATES
Tax District	01:County Tax District
DOR Use Code	01:Single Family
Exemptions	00-HOMESTEAD (2017)
AG Classification	No

## Value Summary

	2026 Working Values	2025 Certified Values
Valuation Method	Cost/Market	Cost/Market
Number of Buildings	1	1
Depreciated Building Value	\$389,041	\$390,060
Depreciated Other Features	\$30,800	\$31,078
Land Value (Market)	\$75,000	\$75,000
Land Value Agriculture	\$0	\$0
Just/Market Value	\$494,841	\$496,138
Portability Adjustment	\$0	\$0
Save Our Homes Adjustment/Maximum Portability	\$205,724	\$214,622
Non-Hx 10% Cap (AMD 1)	\$0	\$0
P&G Adjustment	\$0	\$0
Assessed Value	\$289,117	\$281,516

## 2025 Certified Tax Summary

Tax Amount w/o Exemptions	\$6,786.67
Tax Bill Amount	\$3,292.05
Tax Savings with Exemptions	\$3,494.62

Note: Does NOT INCLUDE Non Ad Valorem Assessments

## Owner(s)

Name - Ownership Type

DONALD R LOOMIS JR REV TRUST

## Legal Description

NW 1/4 OF LOT 6  
LITTLE WASHINGTON ESTATES  
PB 8 PG 62

## Taxes

Taxing Authority	Assessed	Exempt Amount	Taxable
COUNTY GENERAL FUND	\$289,117	\$51,411	\$237,706
Schools	\$289,117	\$25,000	\$264,117
FIRE	\$289,117	\$51,411	\$237,706
ROAD DISTRICT	\$289,117	\$51,411	\$237,706
SJWM(Saint Johns Water Management)	\$289,117	\$51,411	\$237,706

## Sales

Deed Type	Date	Sale Amount	Book / Page	Sale Type	Qualified?
QUIT CLAIM DEED	2/1/2016	\$100	08637/0502	Improved	No
WARRANTY DEED	4/1/2013	\$20,000	08027/1505	Vacant	No

## Land

Units	Rate	Assessed	Market
1 Lot	\$75,000/Lot	\$75,000	\$75,000

## Building Information

#	1
Use	SINGLE FAMILY
Year Built*	2013
Bed	3
Bath	3.5
Fixtures	14
Base Area (ft <sup>2</sup> )	2864
Total Area (ft <sup>2</sup> )	4025
Constuction	CB/STUCCO FINISH
Replacement Cost	\$407,373
Assessed	\$389,041

\* Year Built = Actual / Effective

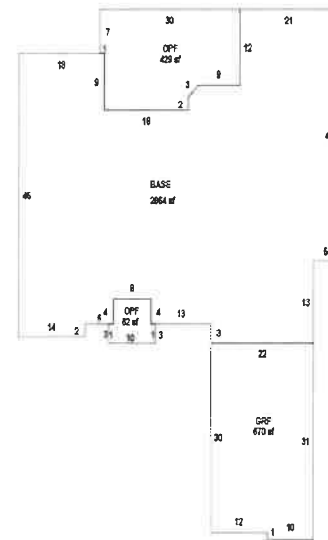

Building 1

## Appendages

Description	Area (ft <sup>2</sup> )
-------------	-------------------------

GARAGE FINISHED	670
OPEN PORCH FINISHED	429
OPEN PORCH FINISHED	62

Permits				
Permit #	Description	Value	CO Date	Permit Date
16013	1021 NEW JERSEY AVE: EZ MECHANICAL - RESIDENTIAL- [LITTLE WASHINGTON ESTATES]	\$6,973		10/23/2025
05565	VINYL FENCE	\$6,250		7/2/2013
05278	SCREEN ENCLOSURE	\$6,576		6/24/2013
02988	POOL	\$22,000		4/19/2013
01461	ELECTRICAL.	\$900		4/16/2013
08783	01/24/2013 04:48:37 PM Created by: Kim Permit Key 12012112708783 was added!	\$352,269	7/30/2013	11/27/2012

Extra Features				
Description	Year Built	Units	Cost	Assessed
POOL 1	2013	1	\$35,000	\$24,500
SCREEN ENCL 2	2013	1	\$9,000	\$6,300

Zoning	
Zoning	R-1A
Description	Single Family-9000
Future Land Use	LDR
Description	Low Density Residential

School Districts	
Elementary	Wekiva
Middle	Teague
High	Lake Brantley

Political Representation	
Commissioner	District 3 - Lee Constantine
US Congress	District 7 - Cory Mills
State House	District 39 - Doug Bankson
State Senate	District 10 - Jason Brodeur
Voting Precinct	Precinct 37

Utilities	
Fire Station #	Station: 13 Zone: 134
Power Company	DUKE
Phone (Analog)	CENTURY LINK
Water	Seminole County Utilities
Sewage	
Garbage Pickup	MON/THU
Recycle	THU
Yard Waste	WED
Hauler #	Waste Management

## Property Value History

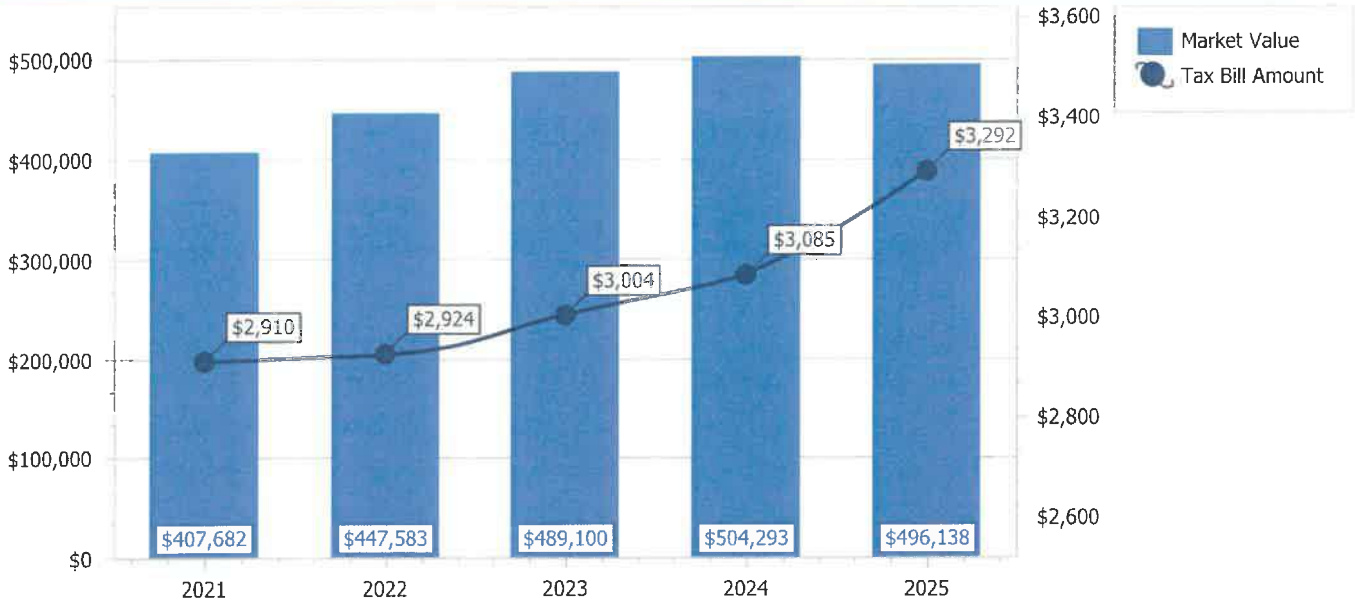

Copyright 2026 © Seminole County Property Appraiser