

THIS DOCUMENT, TOGETHER WITH THE CONCEPTS AND DESIGNS PRESENTED HEREIN, AS AN INSTRUMENT OF SERVICE, IS INTENDED ONLY FOR THE SPECIFIC PURPOSE AND CLIENT FOR WHICH IT WAS PREPARED. REUSE OF AND IMPROPER RELIANCE ON THIS DOCUMENT WITHOUT WRITTEN AUTHORIZATION AND ADAPTATION BY BOWMAN CONSULTING SHALL BE WITHOUT LIABILITY TO BOWMAN CONSULTING.

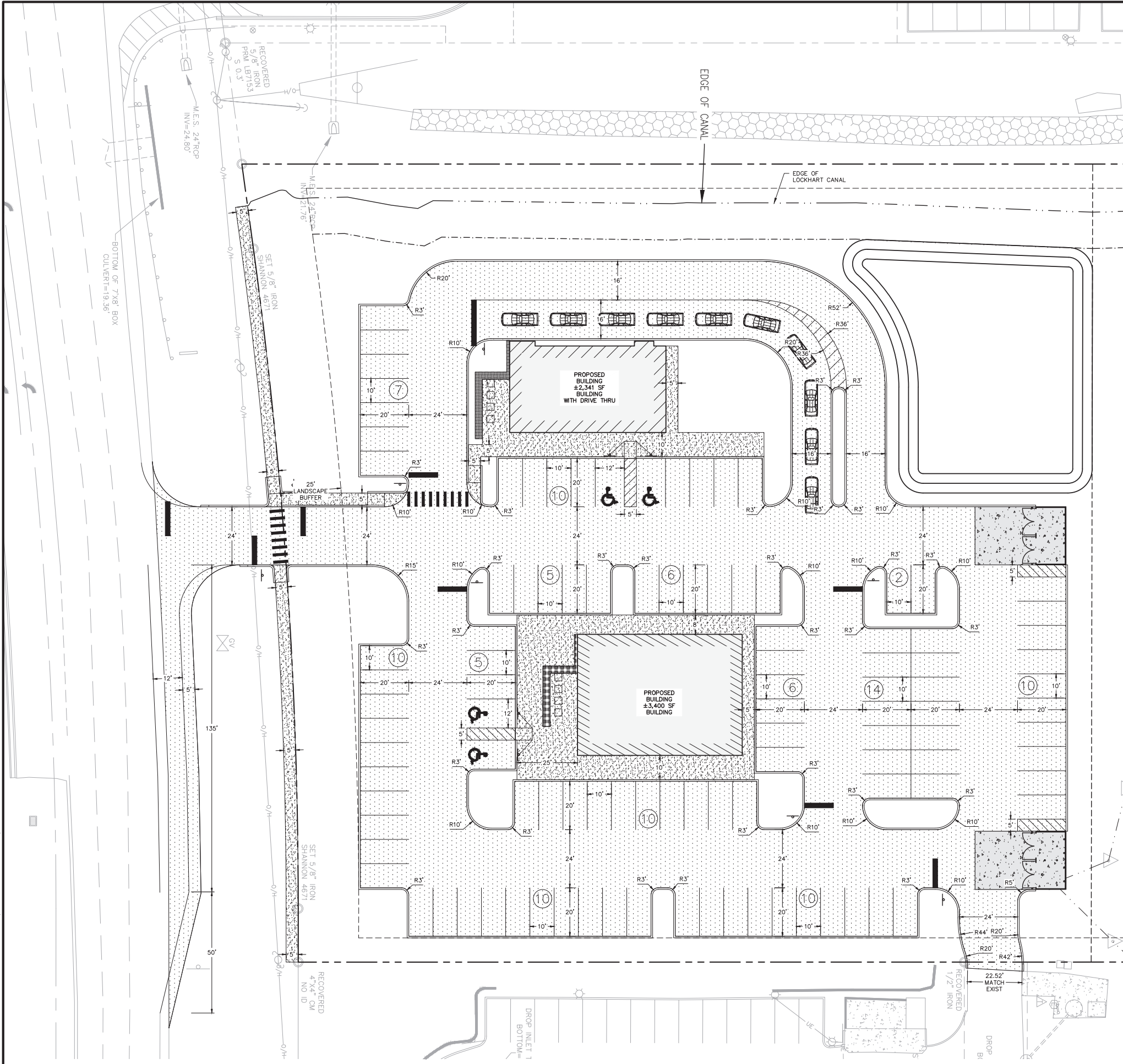

PROPOSED LEGEND

- PROPERTY LINE
- PROPOSED CURB
- STOP BAR
- SIGN
- PROPOSED PARKING SPACES
- ACCESSIBLE SPACES
- PARKING SPACE COUNT
- HEAVY DUTY CONCRETE PAVEMENT
- CONCRETE SIDEWALK
- STANDARD DUTY ASPHALT PAVEMENT

PROPOSED LEGEND

- PROPERTY LINE
- PROPOSED CURB
- STOP BAR
- SIGN
- PROPOSED PARKING SPACES
- ACCESSIBLE SPACES
- PARKING SPACE COUNT
- HEAVY DUTY CONCRETE PAVEMENT
- CONCRETE SIDEWALK
- STANDARD DUTY ASPHALT PAVEMENT

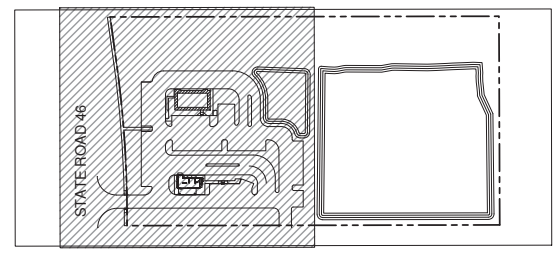

KEY MAP

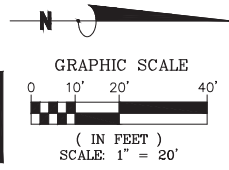

Andrew Peterson
This item has been digitally signed & sealed by Andrew J. Peterson, P.E. All other documents are not controlled signed & sealed and the signature may be copied on any electronic system.
05/02/2024
Andrew J. Peterson, P.E. State of Florida, License # 75493



Bowman Consulting Group, Ltd.
4450 W. Eau Gallie Blvd
Suite 144
Melbourne, FL 32934
Phone: (321) 255-5454
Fax: (321) 255-7751
www.bowmanconsulting.com
© Bowman Consulting Group, Ltd.

SITE PLAN
SANFORD COMMERCIAL DEVELOPMENT - PD REZONE
NE C/O HICKMAN DRIVE AND S.R. 46
SANFORD, FL 32771
 SEMINOLE COUNTY
 CITY OF SANFORD

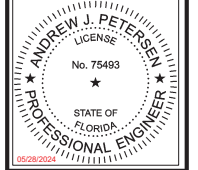

ANDREW J. PETERSEN
LICENSE NO. 75493
05/02/2024
PLAN STATUS

DATE	DESCRIPTION
ALW DESIGN	ELC DRAWN
	AJP CHKD
SCALE 1" = 20'	

JOB No. 011319-01-001
DATE 05/02/2024
011319-01-0-0P-001-07-C1.1-SITE.DWG

SHEET **C1.1**