

## Property Record Card



**Parcel** 26-20-29-503-0000-0060

**Property Address** 1201 POMELO CT LONGWOOD, FL 32779

## Parcel Location



## Site View



## Parcel Information

## Value Summary

Parcel	26-20-29-503-0000-0060		2023 Working Values	2022 Certified Values
Owner(s)	DUNN, JAMES F - Tenancy by Entirety DUNN, MARTHA E - Tenancy by Entirety	Valuation Method	Cost/Market	Cost/Market
Property Address	1201 POMELO CT LONGWOOD, FL 32779	Number of Buildings	1	1
Mailing	1201 POMELO CT LONGWOOD, FL 32779-2728	Depreciated Bldg Value	\$256,642	\$238,121
Subdivision Name	MANDARIN SEC 1	Depreciated EXFT Value	\$37,800	\$31,509
Tax District	01-COUNTY-TX DIST 1	Land Value (Market)	\$100,000	\$100,000
DOR Use Code	01-SINGLE FAMILY	Land Value Ag		
Exemptions	00-HOMESTEAD(2016)	Just/Market Value	\$394,442	\$369,630
AG Classification	No	Portability Adj		
		Save Our Homes Adj	\$125,499	\$108,520
		Amendment 1 Adj	\$0	\$0
		P&G Adj	\$0	\$0
2022 Certified Tax Summary		Assessed Value	\$268,943	\$261,110

## 2022 Certified Tax Summary

## 2022 Tax Amount without Exemptions

## 2022 Tax Bill Amount

**\$4,956.04**

**\$2,967.08**

## 2022 Tax Savings with Exemptions

**\$1,988.96**

\* Does NOT INCLUDE Non Ad Valorem Assessments

## Legal Description

LOT 6  
MANDARIN SEC 1  
PB 20 PGS 42 & 43

## Taxes

Taxing Authority	Assessment Value	Exempt Values	Taxable Value
ROAD DISTRICT	\$268,943	\$50,000	\$218,943
SJWM(Saint Johns Water Management)	\$268,943	\$50,000	\$218,943
FIRE	\$268,943	\$50,000	\$218,943
COUNTY GENERAL FUND	\$268,943	\$50,000	\$218,943
Schools	\$268,943	\$25,000	\$243,943

## Sales

Description	Date	Book	Page	Amount	Qualified	Vac/Imp
SPECIAL WARRANTY DEED	12/01/2014	08384	1352	\$267,000	Yes	Improved
CERTIFICATE OF TITLE	07/01/2014	08305	1405	\$100	No	Improved
WARRANTY DEED	07/01/2006	06367	1172	\$380,000	Yes	Improved
QUIT CLAIM DEED	04/01/2000	03869	1987	\$100	No	Improved
FINAL JUDGEMENT	02/01/2000	03809	1685	\$100	No	Improved
WARRANTY DEED	04/01/1994	02763	0766	\$134,400	No	Improved
QUIT CLAIM DEED	05/01/1990	02189	0510	\$100	No	Improved
WARRANTY DEED	10/01/1986	01788	0353	\$109,500	Yes	Improved
WARRANTY DEED	06/01/1983	01465	1541	\$104,800	Yes	Improved
WARRANTY DEED	01/01/1980	01263	1508	\$87,800	Yes	Improved

## Land

Method	Frontage	Depth	Units	Units Price	Land Value
LOT			1	\$100,000.00	\$100,000

## Building Information

#	Description	Year Built**	Bed	Bath	Fixtures	Base Area	Total SF	Living SF	Ext Wall	Adj Value	Repl Value	Appendages	
1	SINGLE FAMILY	1980	3	2.0	6	1,968	3,092	1,968	CB/STUCCO FINISH	\$256,642	\$329,028	Description	Area
												OPEN PORCH FINISHED	56.00
												GARAGE FINISHED	624.00
												OPEN PORCH UNFINISHED	444.00

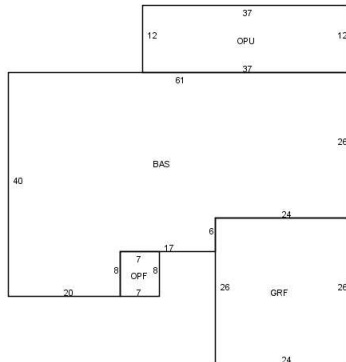

Building 1 - Page 1

**\*\* Year Built (Actual / Effective)**

## Permits

Permit #	Description	Agency	Amount	CO Date	Permit Date
03734	FOOTER & PATIO COVER ROOF	County	\$6,216	6/16/1994	5/1/1994
03977	DOME POOL ENCLOSURE	County	\$5,560		6/1/1994
08166	REPLACE WINDOWS	County	\$8,352		7/21/2003
16979	REROOF W/SHINGLES	County	\$17,000		9/14/2005
06798	CARPORT & FOOTINGS	County	\$8,600		6/1/2003
17494	REMOVE & REPLACE SCREEN POOL ENCLOSURE DUE TO HURRICANE DAMAGE	County	\$15,000		12/28/2004
15371	1201 POMELO CT: ELECTRIC SOLAR WIRING-single family residential [MANDARIN SEC 1] - VOIDED	County	\$51,839		8/23/2021

Extra Features				
Description	Year Built	Units	Value	New Cost
CARPORT 3	07/01/2003	1	\$2,400	\$6,000
FIREPLACE 2	07/01/1980	1	\$2,400	\$6,000
POOL 2	07/01/1987	1	\$27,000	\$45,000
SOLAR HEATER	07/01/2004	1	\$0	
SCREEN ENCL 3	07/01/2005	1	\$6,000	\$15,000

Zoning			
Zoning	Zoning Description	Future Land Use	Future Land Use Description
A-1	Suburban Estates	SE	Agricultural-1Ac

Utility Information								
Fire Station	Power	Phone(Analog)	Water Provider	Sewer Provider	Garbage Pickup	Recycle	Yard Waste	Hauler
36.00	DUKE	CENTURY LINK	SUNSHINE WATER SERVICES	SUNSHINE WATER SERVICES	TUE/FRI	TUE	WED	Waste Pro

Political Representation				
Commissioner	US Congress	State House	State Senate	Voting Precinct
Dist 5 - Andria Herr	Dist 7 - Stephanie Murphy	Dist 29 - Scott Plakon	Dist 9 - Jason Brodeur	32

School Information		
Elementary School District	Middle School District	High School District
Woodlands	Markham Woods	Lake Mary