

# Property Record Card



Parcel: 17-19-30-5VQ-0000-0560  
 Property Address: 1386 SWINTON CT SANFORD, FL 32771  
 Owners: BEHARA, GIREESH K; ANKAM, SWATHI  
 2025 Market Value \$482,320 Assessed Value \$434,320  
 2024 Tax Bill \$5,041.36 Tax Savings with Exemptions \$1,204.94  
 The 4 Bed/2.5 Bath Single Family property is 2,883 SF and a lot size of 0.11 Acres

## Parcel Location



## Site View



## Parcel Information

Parcel	17-19-30-5VQ-0000-0560
Property Address	1386 SWINTON CT SANFORD, FL 32771
Mailing Address	1386 SWINTON CT SANFORD, FL 32771-8653
Subdivision	ESTUARY AT ST JOHNS
Tax District	01:County Tax District
DOR Use Code	01:Single Family
Exemptions	00-HOMESTEAD (2022)
AG Classification	No

## Value Summary

	2025 Working Values	2024 Certified Values
Valuation Method	Cost/Market	Cost/Market
Number of Buildings	1	1
Depreciated Building Value	\$394,320	\$384,882
Depreciated Other Features	\$0	\$0
Land Value (Market)	\$88,000	\$88,000
Land Value Agriculture	\$0	\$0
Just/Market Value	\$482,320	\$472,882
Portability Adjustment	\$0	\$0
Save Our Homes Adjustment/Maximum Portability	\$48,000	\$51,212
Non-Hx 10% Cap (AMD 1)	\$0	\$0
P&G Adjustment	\$0	\$0
Assessed Value	\$434,320	\$421,670

## 2024 Certified Tax Summary

Tax Amount w/o Exemptions	\$6,246.30
Tax Bill Amount	\$5,041.36
Tax Savings with Exemptions	\$1,204.94

Note: Does NOT INCLUDE Non Ad Valorem Assessments

## Owner(s)

### Name - Ownership Type

BEHARA, GIREESH K - Tenancy by Entirety  
 ANKAM, SWATHI - Tenancy by Entirety

## Legal Description

LOT 56 ESTUARY AT ST JOHNS PLAT BOOK 85  
PAGES 15-17

## Taxes

Taxing Authority	Assessed	Exempt Amount	Taxable
COUNTY GENERAL FUND	\$434,320	\$50,000	\$384,320
Schools	\$434,320	\$25,000	\$409,320
FIRE	\$434,320	\$50,000	\$384,320
ROAD DISTRICT	\$434,320	\$50,000	\$384,320
SJWM(Saint Johns Water Management)	\$434,320	\$50,000	\$384,320

## Sales

Deed Type	Date	Sale Amount	Book / Page	Sale Type	Qualified?
WARRANTY DEED	1/14/2021	\$442,600	09817/0989	Improved	Yes

## Land

Units	Rate	Assessed	Market
1 Lot	\$88,000/Lot	\$88,000	\$88,000

## Building Information

#	1
Use	SINGLE FAMILY
Year Built*	2020
Bed	4
Bath	2.5
Fixtures	10
Base Area (ft <sup>2</sup> )	1233
Total Area (ft <sup>2</sup> )	3520
Constuction	CB/STUCCO FINISH
Replacement Cost	\$402,367
Assessed	\$394,320

\* Year Built = Actual / Effective

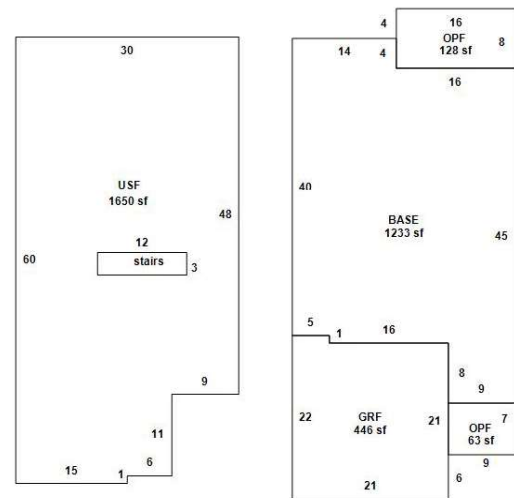

Building 1

## Appendages

Description	Area (ft <sup>2</sup> )
GARAGE FINISHED	446
OPEN PORCH FINISHED	128

OPEN PORCH FINISHED

63

UPPER STORY FINISHED

1650

## Permits

Permit #	Description	Value	CO Date	Permit Date
10450	1386 SWINTON CT: ELECTRIC SOLAR WIRING-Roof Mounted Solar PV Installation [ESTUARY AT ST JOHNS]	\$35,482		7/18/2023
01014	1386 SWINTON CT: PLUMBING - RESIDENTIAL- [ESTUARY AT ST JOHNS]	\$250		1/20/2021
12687	1386 SWINTON CT: SINGLE FAMILY DETACHED-NEW SFR [ESTUARY AT ST JOHNS]	\$381,488	12/30/2020	8/27/2020

## Extra Features

Description	Year Built	Units	Cost	Assessed
HOME-SOLAR POWER	2023	1	\$0	\$0

## Zoning

Zoning	PD
Description	Planned Development
Future Land Use	PD
Description	Planned Development

## School Districts

Elementary	Region 1
Middle	Sanford
High	Seminole

## Political Representation

Commissioner	District 5 - Andria Herr
US Congress	District 7 - Cory Mills
State House	District 36 - Rachel Plakon
State Senate	District 10 - Jason Brodeur
Voting Precinct	Precinct 1

## Utilities

Fire Station #	Station: 34 Zone: 341
Power Company	FPL
Phone (Analog)	AT&T
Water	Seminole County Utilities
Sewage	Seminole County Utilities
Garbage Pickup	MON/THU
Recycle	MON
Yard Waste	WED
Hauler #	Waste Pro

## Property Value History

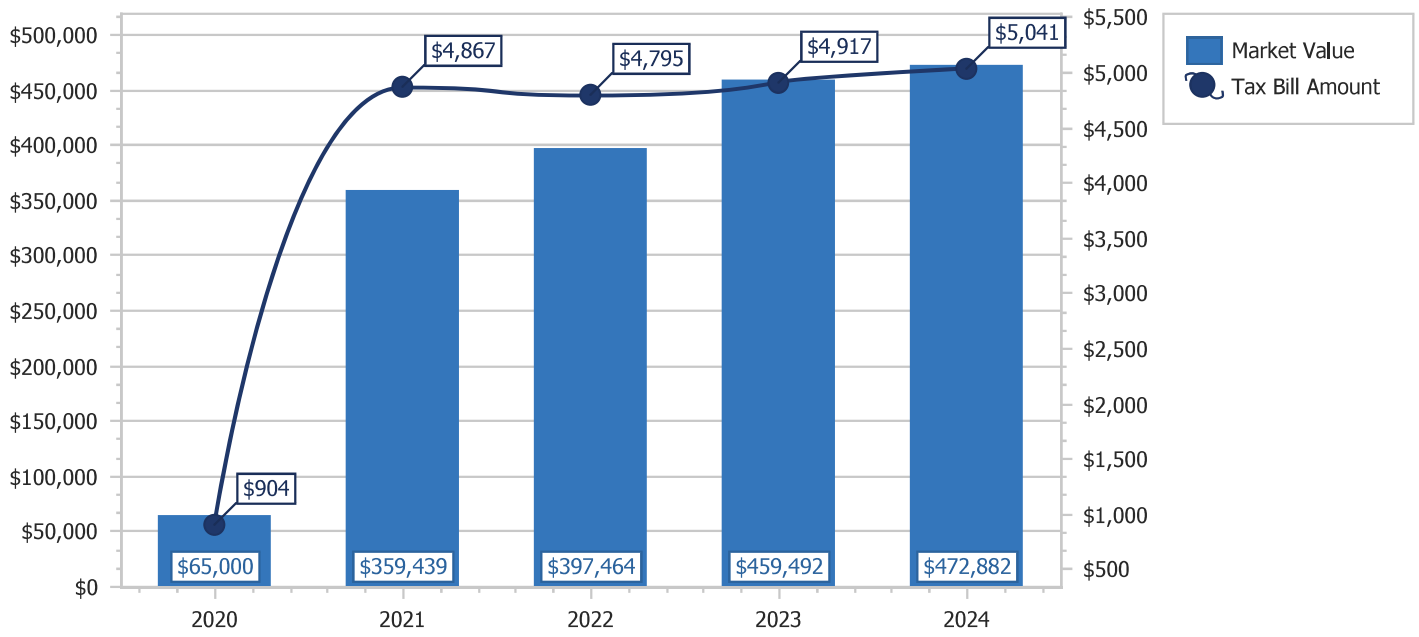

Copyright 2025 © Seminole County Property Appraiser