

CONTRACT PLANS COMPONENTS

- ROADWAY PLANS
- TEMPORARY TRAFFIC CONTROL PLANS
- SIGNING AND PAVEMENT MARKING PLANS
- SIGNALIZATION PLANS
- INTELLIGENT TRANSPORTATION SYSTEMS (ITS) PLANS
- LIGHTING PLANS
- LANDSCAPE OPPORTUNITY PLANS

A DETAILED INDEX APPEARS ON THE KEY SHEET OF EACH COMPONENT

INDEX OF ROADWAY PLANS

SHEET NO.	SHEET DESCRIPTION
1	KEY SHEET
2	SIGNATURE SHEET
3 - 9	DRAINAGE MAP
10 - 13	SUPPLEMENTAL DRAINAGE MAP
14 - 18	EXISTING DRAINAGE STRUCTURES
19 - 20	DRAINAGE BASINS
21 - 53	TYPICAL SECTION
54	TYPICAL SECTION DETAILS
CTL-1 - CTL-11	PROJECT CONTROL
55 - 67	ROADWAY PLAN AND PROFILES
68	CURVE DATA TABLE
69 - 102	DRAINAGE PLANS
103	MILLING PROFILE DETAIL
104 - 105	SUPERELEVATION TRANSITION DETAIL
106 - 122	POND DETAILS
123 - 130	DRAINAGE STRUCTURES
131 - 132	STORMWATER POLLUTION PREVENTION PLAN SHEET
133 - 166	EROSION CONTROL PLAN

STATE OF FLORIDA
DEPARTMENT OF TRANSPORTATION

CONTRACT PLANS

FINANCIAL PROJECT ID 417545-1-52-01
SEMINOLE COUNTY (77470)

STATE ROAD NO. 417

WIDEN SEMINOLE EXPRESSWAY FROM SOUTH OF ALOMA AVE. TO NORTH OF SR 434

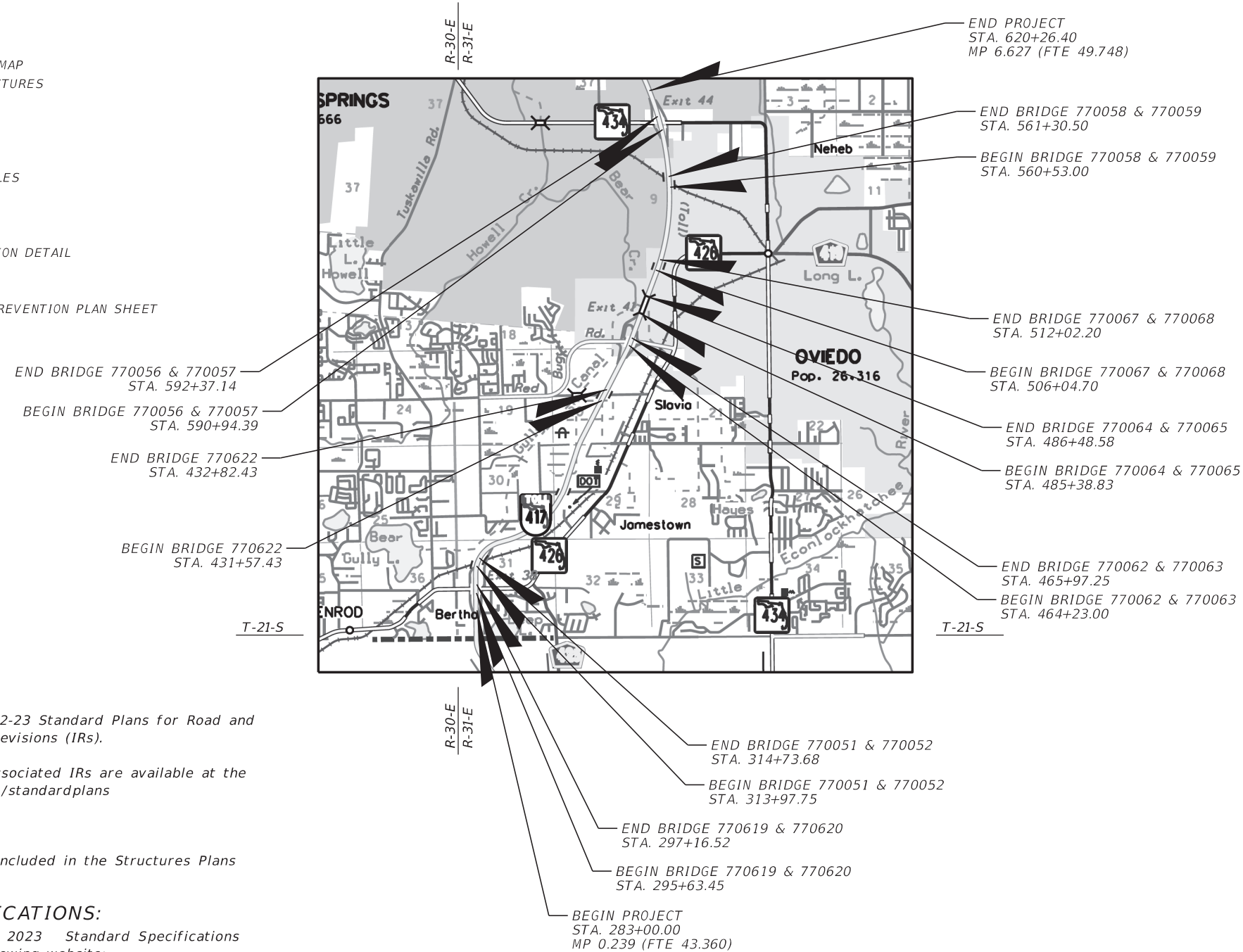
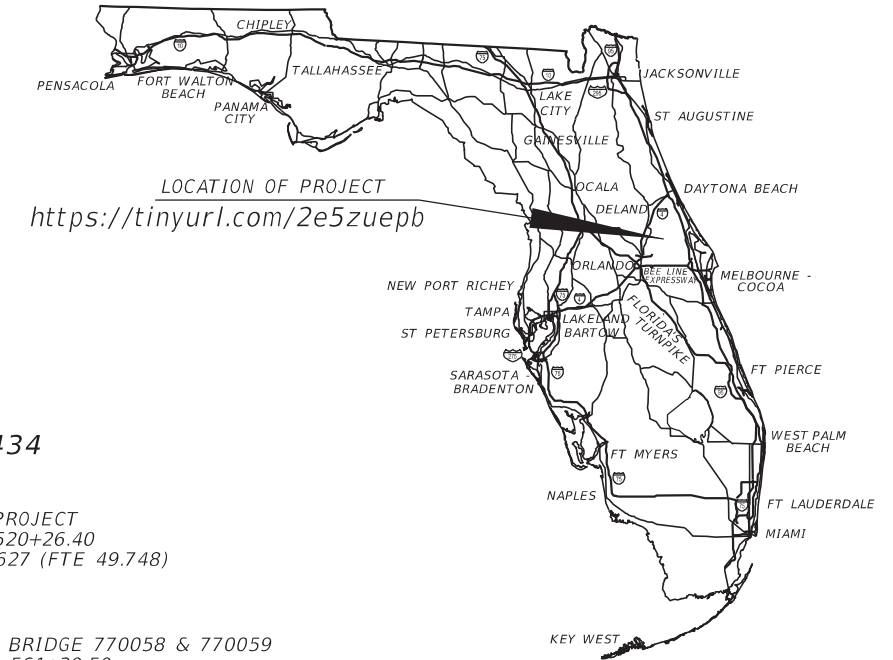

**ROADWAY PLANS
ENGINEER OF RECORD:**

JOHN J. KENTY, P.E.
P.E. LICENSE NUMBER 55442
H. W. LOCHNER, INC.
4350 W. CYPRESS STREET, SUITE 800
TAMPA, FL 33607
CONTRACT NO.: C0000
VENDOR NO.: 99-999999

FDOT PROJECT MANAGER:

STEPHANIE SHARP, P.E.

GEC PROJECT MANAGER:

CHRIS MILLS, P.E.

CONSTRUCTION CONTRACT NO.	FISCAL YEAR	SHEET NO.
TBD	23	1

3/28/2023 12:48:30 PM M:\WOODWARD C:\pwworking\lochnef-pw-01\dms21886\KEYSRD02.dgn

THE OFFICIAL RECORD OF THIS SHEET IS THE ELECTRONIC FILE DIGITALLY SIGNED AND SEALED UNDER RULE 61G15-23.004, F.A.C.

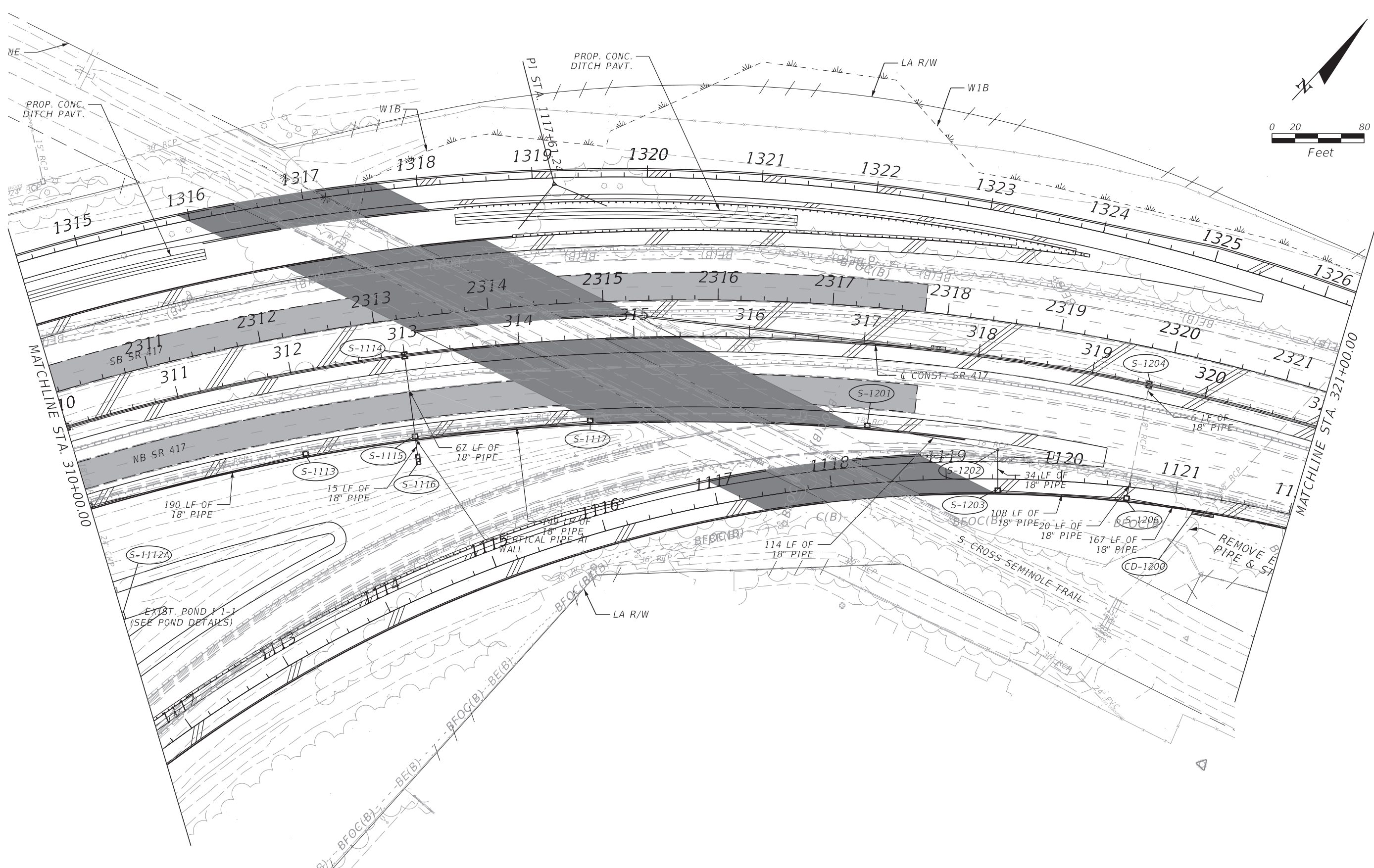

REVISIONS			
DATE	DESCRIPTION	DATE	DESCRIPTION

THOMAS E. SEGERS, JR., P.E.
 P.E. LICENSE NUMBER 23025
 H.W. LOCHNER, INC.
 4350 W. CYPRESS STREET - SUITE 800
 TAMPA, FL 33607

STATE OF FLORIDA DEPARTMENT OF TRANSPORTATION		
ROAD NO.	COUNTY	FINANCIAL PROJECT ID
417	SEMINOLE	417545-1-52-01

DRAINAGE PLANS (05)

SHEET NO.
73

NOTICE: THE OFFICIAL RECORD OF THIS SHEET IS THE ELECTRONIC FILE SIGNED AND SEALED UNDER RULE 61G15-23.004, F.A.C.

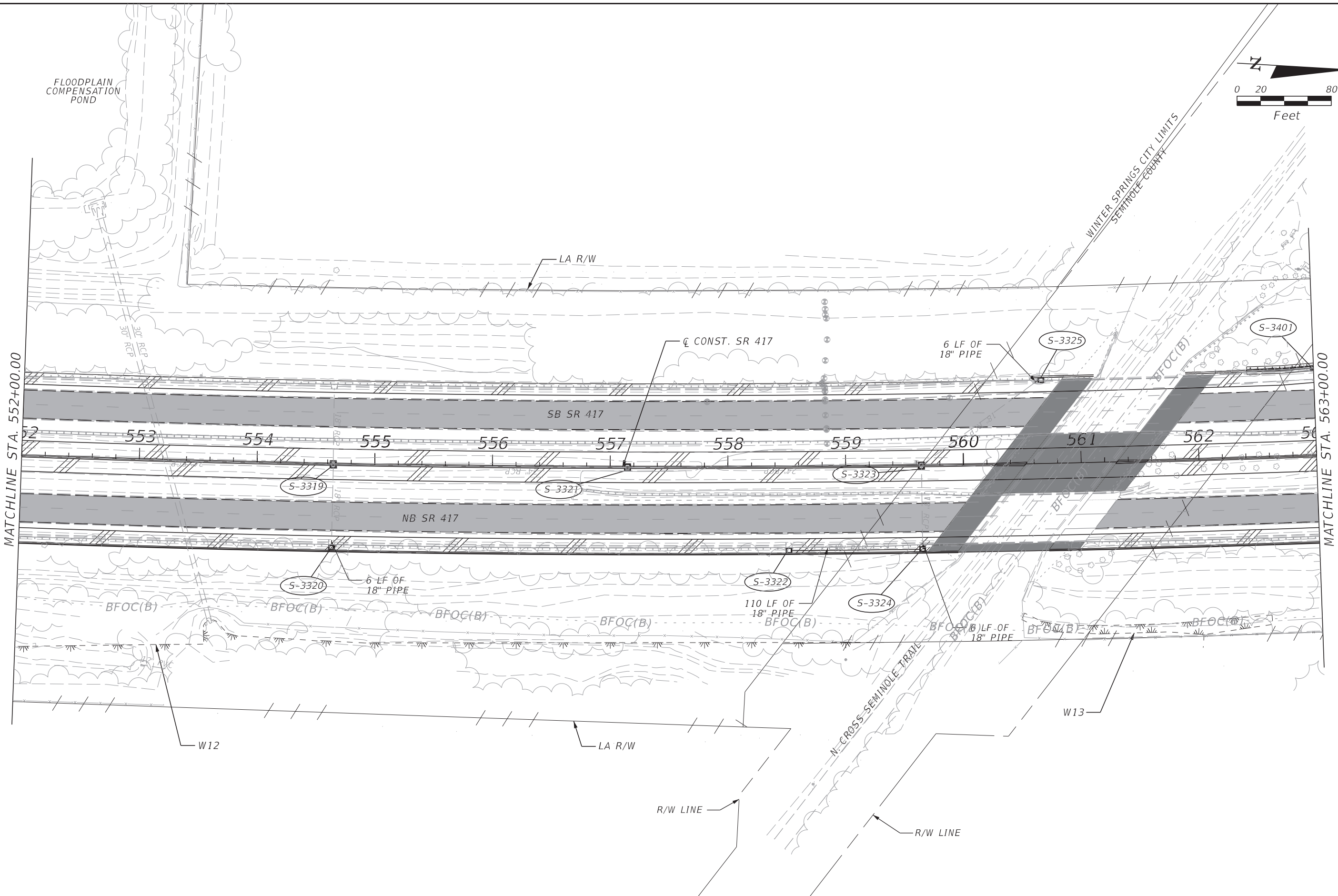
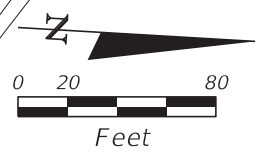

FLOODPLAIN
COMPENSATION
POND

MATCHLINE STA. 552+00.00

MATCHLINE STA. 563+00.00

WINTER SPRINGS CITY LIMITS
SEMINOLE COUNTY

N. CROSS-SEMINOLE TRAIL

REVISIONS				THOMAS E. SEGERS, JR., P.E. P.E. LICENSE NUMBER 23025 H.W. LOCHNER, INC. 4350 W. CYPRESS STREET - SUITE 800 TAMPA, FL 33607	STATE OF FLORIDA DEPARTMENT OF TRANSPORTATION			DRAINAGE PLANS (27) SHEET NO. 95
DATE	DESCRIPTION	DATE	DESCRIPTION		ROAD NO.	COUNTY	FINANCIAL PROJECT ID	
					417	SEMINOLE	417545-1-52-01	

NOTICE: THE OFFICIAL RECORD OF THIS SHEET IS THE ELECTRONIC FILE SIGNED AND SEALED UNDER RULE 61G15-23.004, F.A.C.

NOTE:
1. All existing signs south of Aloma Ave. are to remain unless otherwise noted.

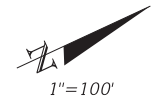



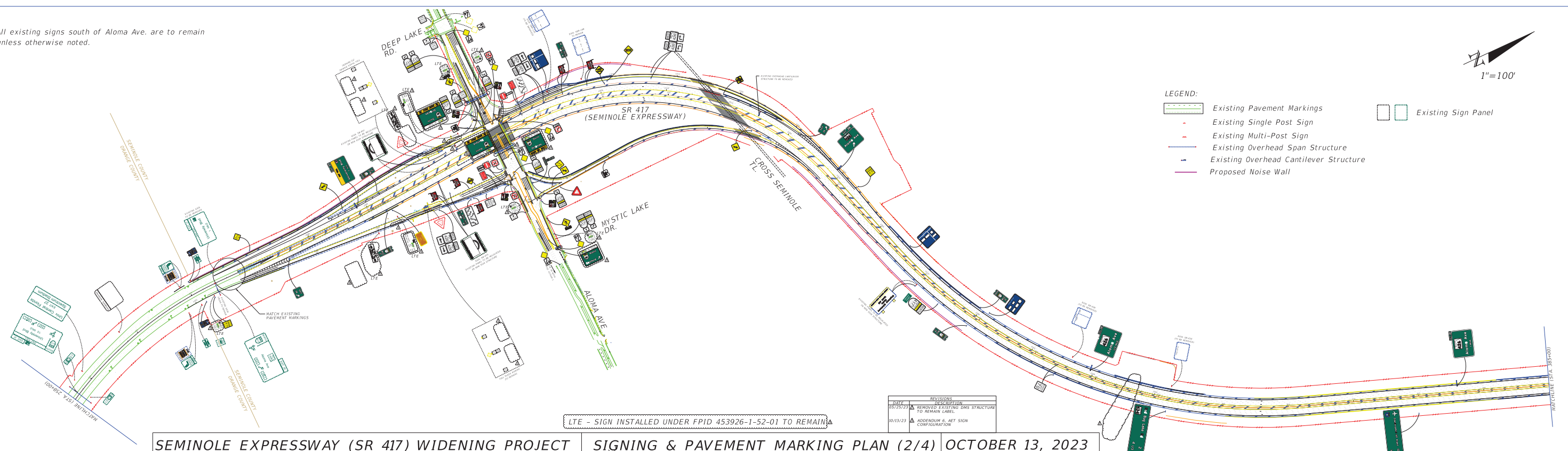





- LEGEND:
- Existing Pavement Markings
 - Existing Single Post Sign
 - Existing Multi-Post Sign
 - Existing Overhead Span Structure
 - Existing Overhead Cantilever Structure
 - Proposed Noise Wall
 - Existing Sign Panel



LTE - SIGN INSTALLED UNDER FPID 453926-1-52-01 TO REMAIN

DATE	REVISIONS
09/27/23	REMOVED EXISTING SMS STRUCTURE TO REMAIN LABEL
10/13/23	ADDED SIGN E-RET SIGN CONFIGURATION

SEMINOLE EXPRESSWAY (SR 417) WIDENING PROJECT | SIGNING & PAVEMENT MARKING PLAN (2/4) | OCTOBER 13, 2023



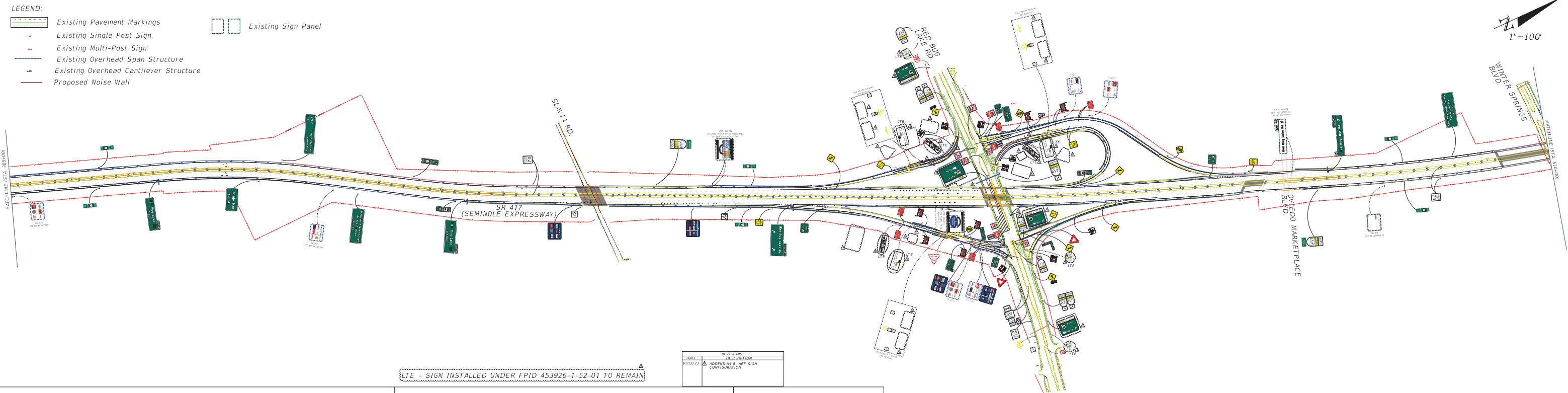
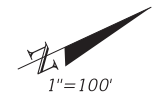



- LEGEND:**
-  Existing Pavement Markings
 -  Existing Single Post Sign
 -  Existing Multi-Post Sign
 -  Existing Overhead Span Structure
 -  Existing Overhead Cantilever Structure
 -  Proposed Noise Wall
 -  Existing Sign Panel
 -  Existing Sign Panel



LTE - SIGN INSTALLED UNDER FPID 453926-1-52-01 TO REMAIN

REVISIONS	
DATE	DESCRIPTION
10/13/23	ADDendum 6 - NET SIGN CONFIGURATION

NOTE:
1. All existing signs north of SR 417 proposed lane line tie in are to remain unless otherwise noted.

- LEGEND:
-  Existing Pavement Markings
 -  Existing Single Post Sign
 -  Existing Multi-Post Sign
 -  Existing Overhead Span Structure
 -  Existing Overhead Cantilever Structure
 -  Proposed Noise Wall
 -  Existing Sign Panel

1"=100'

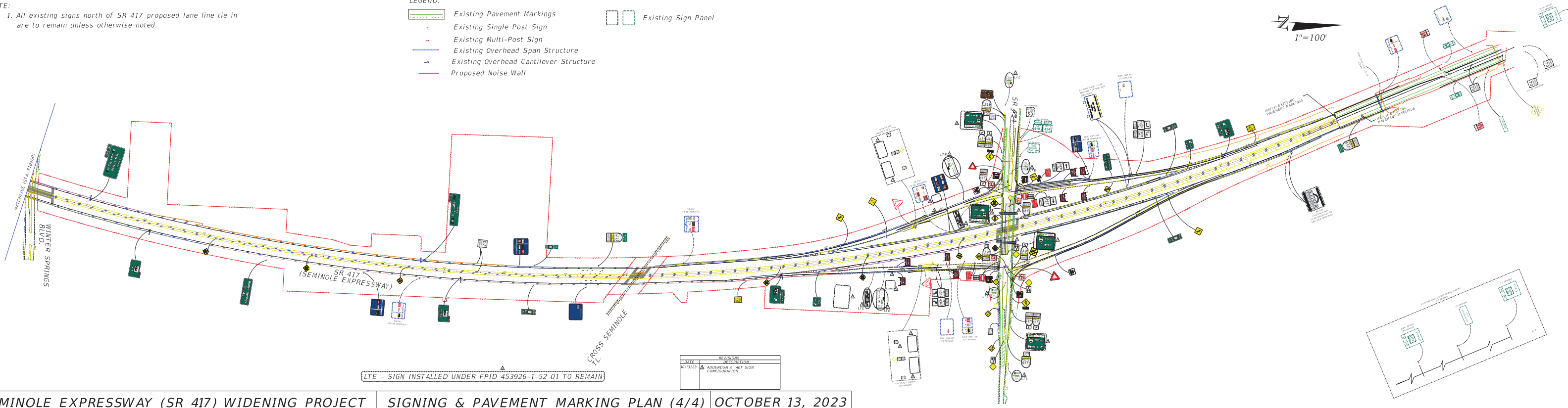

LTE - SIGN INSTALLED UNDER FPID 453926-1-52-01 TO REMAIN

DATE	REVISIONS
DESCRIPTION	
10/13/23	ADDENDUM 6 - JET SIGN CONFIGURATION