

EXHIBIT D



FLORIDA DEPARTMENT OF Environmental Protection

Central District Office
3319 Maguire Blvd.,
Suite 232 Orlando, Florida 32803
DEP_CD@floridadep.gov

Ron DeSantis
Governor

Jeanette Nuñez
Lt. Governor

Shawn Hamilton
Secretary

March 6, 2024

Gregory Luke
3066 Kingfisher Point
Chuluota, FL 32766
todd@brockmansite.com

File No. 445015-001 County Seminole

Dear Gregory Luke:

On February 7, 2024, we received your notice of intent to use a General Permit (GP), pursuant to Rule 62-330.427, Florida Administrative Code (F.A.C.) to remove the existing dock and construct a new 1261 square foot dock with a roof inside Lake Mills, a class III waterbody. This project is located at 3066 Kingfisher Point Chuluota, FL 32766 Section 27, Township 21 South, Range 32 East Seminole County.

Your intent to use a general permit has been reviewed by Department staff for three types of authorizations: (1) regulatory authorization, (2) proprietary authorization (related to state-owned submerged lands), and (3) federal authorization. The authority for review and the outcomes of the reviews are listed below. Please read each section carefully.

Your project did not qualify for the federal authorization; therefore, additional authorization must be obtained prior to commencement of the proposed activity. This letter does not relieve you from the responsibility of obtaining other federal, state, or local authorizations that may be required for the activity. Please refer to the specific section(s) dealing with that portion of the review below for advice on how to proceed.

If you change the project from what you submitted, the authorization(s) granted may no longer be valid at the time of commencement of the project. Please contact us prior to beginning your project if you wish to make any changes.

1. Regulatory Review – Approved

Based on the forms, drawings, and documents submitted with your notice, it appears that the project meets the requirements for the General Permit under Rule 62-330.427, F.A.C. Any activities performed under a general permit are subject to general conditions required in Rule 62-330.405, F.A.C. (attached), and the specific conditions of Rule 62-330.427, F.A.C. (attached).

Any deviations from these conditions may subject the permittee to enforcement action and possible penalties.

Please be advised that the construction phase of the GP must be completed within five years from the date the notice to use the GP was received by the Department. If you wish to continue this GP beyond the expiration date, you must notify the Department at least 30 days before its expiration.

Authority for review- Part IV of Chapter 373, F.S., Title 62, F.A.C. and in accordance with the operating agreements executed between the Department and the water management districts, as referenced in Chapter 62-113, F.A.C.

2. Proprietary Review – Granted

The Department acts as staff to the Board of Trustees of the Internal Improvement Trust Fund (Board of Trustees) and issues certain authorizations for the use of sovereign submerged lands. The Department has the authority to review activities on sovereign submerged lands under Chapter 253 of the Florida Statutes (F.S.) and 258, F.S. if located within an aquatic preserve, and Chapters 18-20 and 18-21 of the Florida Administrative Code.

The activity appears to be located on sovereign submerged lands owned by the Board of Trustees. The activity is not exempt from the need to obtain the applicable proprietary authorization. As staff to the Board of Trustees, the Department has reviewed the activity described above, and has determined that the activity qualifies for a letter of consent under Section 253.77, Florida Statutes, to construct and use the activity on the specified sovereign submerged lands, as long as the work performed is located within the boundaries as described herein and is consistent with the terms and conditions herein.

During the term of this Letter of Consent you shall maintain satisfactory evidence of sufficient upland interest as required by paragraph 18-21.004(3)(b), Florida Administrative Code. If such interest is terminated or the Board of Trustees determines that such interest did not exist on the date of issuance of this Letter of Consent, this Letter of Consent may be terminated by the Board of Trustees at its sole option. If the Board of Trustees terminates this Letter of Consent, you agree not to assert a claim or defense against the Board of Trustees arising out of this Letter of Consent.

Please be advised that any use of sovereign submerged lands without specific prior authorization from the Board of Trustees will be considered a violation of Chapter 253, Florida Statutes and may subject the affected upland riparian property owners to legal action as well as potential fines for the prior unauthorized use of sovereign land.

Authority for review - Chapter 253 F.S., and Chapter 18-21, F.A.C. and, and Section 62-330.075, F.A.C. as required.

3. Federal Review- SPGP Not Approved

Your proposed activity as outlined in your application and attached drawings does not qualify for Federal authorization pursuant to the State Programmatic General Permit VI-R1. **SEPARATE permit(s)** or authorization **will be required** from the U.S. Army Corps of Engineers. You must apply separately to the Corps using the Application for Department of the Army Permit (ENG 4345) or alternative as allowed by Corps regulations. More information on Corps permitting may be found online in the Jacksonville District Regulatory Division Sourcebook: (<https://www.saj.usace.army.mil/Missions/Regulatory/Source-Book/>).

Authority for review - an agreement with the USACOE entitled "Coordination Agreement Between the U. S. Army Corps of Engineers (Jacksonville District) and the Florida Department of Environmental Protection (or Duly Authorized Designee), State Programmatic General Permit", Section 10 of the Rivers and Harbor Act of 1899, and Section 404 of the Clean Water Act.

3.1. Water Quality Certification Granted With Conditions

This permit also constitutes a *granted with conditions* water quality certification under Section 401 of the Clean Water Act, 33 U.S.C. Section 1341. Pursuant to Rule 62-330.062, F.A.C. State Water Quality Certification is granted when an activity meets all the terms and conditions of a general permit under Rule 62-330.052, F.A.C., and the applicable Rules 62-330.401 through 62-330.635, F.A.C.

Additional Information

Please retain this general permit. The activities may be inspected by authorized state personnel in the future to ensure compliance with appropriate statutes and administrative codes. If the activities are not in compliance, you may be subject to penalties under Chapter 373, F.S., and Chapter 18-14, F.A.C.

NOTICE OF RIGHTS

This action is final and effective on the date filed with the Clerk of the Department unless a petition for an administrative hearing is timely filed under Sections 120.569 and 120.57, F.S., before the deadline for filing a petition. On the filing of a timely and sufficient petition, this action will not be final and effective until further order of the Department. Because the administrative hearing process is designed to formulate final agency action, the hearing process may result in a modification of the agency action or even denial of the application.

Petition for Administrative Hearing

A person whose substantial interests are affected by the Department's action may petition for an administrative proceeding (hearing) under Sections 120.569 and 120.57, F.S. Pursuant to Rules 28-106.201 and 28-106.301, F.A.C., a petition for an administrative hearing must contain the following information:

(a) The name and address of each agency affected and each agency's file or identification number, if known;

(b) The name, address, any e-mail address, any facsimile number, and telephone number of the petitioner, if the petitioner is not represented by an attorney or a qualified representative; the name, address, and telephone number of the petitioner's representative, if any, which shall be the address for service purposes during the course of the proceeding; and an explanation of how the petitioner's substantial interests will be affected by the agency determination;

(c) A statement of when and how the petitioner received notice of the agency decision;

(d) A statement of all disputed issues of material fact. If there are none, the petition must so indicate;

(e) A concise statement of the ultimate facts alleged, including the specific facts that the petitioner contends warrant reversal or modification of the agency's proposed action;

(f) A statement of the specific rules or statutes that the petitioner contends require reversal or modification of the agency's proposed action, including an explanation of how the alleged facts relate to the specific rules or statutes; and

(g) A statement of the relief sought by the petitioner, stating precisely the action that the petitioner wishes the agency to take with respect to the agency's proposed action.

The petition must be filed (received by the Clerk) in the Office of General Counsel of the Department at 3900 Commonwealth Boulevard, Mail Station 35, Tallahassee, Florida 32399-3000, or via electronic correspondence at Agency_Clerk@dep.state.fl.us. Also, a copy of the petition shall be mailed to the applicant at the address indicated above at the time of filing.

Time Period for Filing a Petition

In accordance with Rule 62-110.106(3), F.A.C., petitions for an administrative hearing by the applicant and persons entitled to written notice under Section 120.60(3), F.S., must be filed within 21 days of receipt of this written notice. Petitions filed by any persons other than the applicant, and other than those entitled to written notice under Section 120.60(3), F.S., must be filed within 21 days of publication of the notice or within 21 days of receipt of the written notice, whichever occurs first. You cannot justifiably rely on the finality of this decision unless notice of this decision and the right of substantially affected persons to challenge this decision has been duly published or otherwise provided to all persons substantially affected by the decision. While you are not required to publish notice of this action, you may elect to do so pursuant Rule 62-110.106(10)(a).

The failure to file a petition within the appropriate time period shall constitute a waiver of that person's right to request an administrative determination (hearing) under Sections 120.569 and 120.57, F.S., or to intervene in this proceeding and participate as a party to it. Any subsequent intervention (in a proceeding initiated by another party) will be only at the discretion of the presiding officer upon the filing of a motion in compliance with Rule 28-106.205, F.A.C. If you do not publish notice of this action, this waiver will not apply to persons who have not received written notice of this action.

Extension of Time

Under Rule 62-110.106(4), F.A.C., a person whose substantial interests are affected by the Department's action may also request an extension of time to file a petition for an administrative hearing. The Department may, for good cause shown, grant the request for an extension of time. Requests for extension of time must be filed with the Office of General Counsel of the Department at 3900 Commonwealth Boulevard, Mail Station 35, Tallahassee, Florida 32399-3000, or via electronic correspondence at Agency_Clerk@dep.state.fl.us, before the deadline for filing a petition for an administrative hearing. A timely request for extension of time shall toll the running of the time period for filing a petition until the request is acted upon.

Mediation

Mediation is not available in this proceeding.

FLAWAC Review

The applicant, or any party within the meaning of Section 373.114(1)(a) or 373.4275, F.S., may also seek appellate review of this order before the Land and Water Adjudicatory Commission under Section 373.114(1) or 373.4275, F.S. Requests for review before the Land and Water Adjudicatory Commission must be filed with the Secretary of the Commission and served on the Department within 20 days from the date when this order is filed with the Clerk of the Department.

Judicial Review

Once this decision becomes final, any party to this action has the right to seek judicial review pursuant to Section 120.68, F.S., by filing a Notice of Appeal pursuant to Florida Rules of Appellate Procedure 9.110 and 9.190 with the Clerk of the Department in the Office of General Counsel (Station #35, 3900 Commonwealth Boulevard, Tallahassee, Florida 32399-3000) and by

filing a copy of the Notice of Appeal accompanied by the applicable filing fees with the appropriate district court of appeal. The notice must be filed within 30 days from the date this action is filed with the Clerk of the Department.

EXECUTION AND CLERKING

Executed in Orange County, Florida.

STATE OF FLORIDA DEPARTMENT OF ENVIRONMENTAL PROTECTION



Jason Seyfert
Environmental Administrator
Permitting and Waste Cleanup Program

Enclosures:

General Permit for Docks and Piers Ch. 62-330.427, F.A.C.
General Conditions for All General Permits, Ch. 62-330.405, F.A.C.
Special Consent Conditions
Project drawings, 7 pages

CERTIFICATE OF SERVICE

The undersigned duly designated deputy clerk hereby certifies that this document and all attachments were sent on the filing date below to the following listed persons:

Kelvin Jauregui, FDEP, kelvin.jauregui@floridadep.gov
Seminole County, plandesk@semiolecountyfl.gov
Jason Seyfert, FDEP, Jason.Seyfert@FloridaDEP.gov
Alan Horn, Agent, alan@planworksfl.com

FILING AND ACKNOWLEDGMENT

FILED, on this date, pursuant to Section 120.52, F. S., with the designated Department Clerk, receipt of which is hereby acknowledged.



Clerk

March 6, 2024
Date

62-330.427 General Permit for Docks, Piers and Associated Structures.

(1) A general permit is granted to any person to construct, extend, or remove associated structures as described below:

(a) A private, single-family pier or dock with up to two boat lifts that, together with all existing structures on the shoreline of the property, does not exceed a total area of 2,000 square feet over surface waters. Such a structure:

1. Shall not accommodate the mooring of more than two vessels, either in the water or on a boat lift. Solely for purposes of this general permit, up to two personal watercraft as defined in section 327.02(33), F.S., may be moored in lieu of either or both allowable vessels of another type.

These limits shall not apply to the mooring, storage or other use of the dock or pier by:

a. Non-motor-powered vessels less than 16 feet in length that are stored on or under the dock or pier, or within an authorized mooring area; or

b. Personal watercraft, dinghies or similar small vessels that are stowed out of the water, upon a larger parent vessel that is moored at the dock in compliance with this general permit.

2. Shall be located such that all areas used for vessel mooring and navigational access already provide a minimum depth of two feet below the mean low water level for tidal waters, or two feet below the expected average low water depth for non-tidal waters as determined based on best available information for the water body at the project location; and

3. May include a roof over the vessel mooring areas, boat lifts, and terminal platform, or any portions thereof, subject to the applicable provisions of chapters 253 and 258, F.S., and the rules adopted thereunder. Portions of such roofs that overhang beyond the edge of decked portions of the pier or dock shall be included in the calculation of the total square footage of over-water structure allowed under paragraph (1)(a), above.

(b) A public fishing pier that does not exceed a total area of 2,000 square feet provided the structure is designed and built to discourage boat mooring by elevating the fishing pier to a minimum height of five feet above mean high water or ordinary high water, surrounding the pier with handrails, and installing and maintaining signs that state "No Boat Mooring Allowed."

(2) This general permit shall be subject to the following specific conditions:

(a) Construction or extension of the boat lift, boat mooring location, or terminal platform, shall not occur over submerged grassbeds, coral communities or wetlands. However, the access walkway portion of the pier may traverse these resources provided it is elevated a minimum of five feet above mean high water or ordinary high water, contains handrails that are maintained in such a manner as to prevent use of the access walkways for boat mooring or access, and does not exceed a width of six feet, or a width of four feet in Aquatic Preserves;

(b) There shall be no structures enclosed by walls, screens, or doors on any side;

(c) The dock or pier will not facilitate vessel rentals, charters, or serve any other commercial purpose;

(d) There shall be no fish cleaning facilities, boat repair facilities or equipment, or fueling facilities on the structures authorized by this general permit. In addition, no overboard discharges of trash, human or animal waste, or fuel shall occur from any structures authorized by this general permit;

(e) This general permit shall not authorize the construction or extension of more than one dock or pier per parcel of land or individual lot. For the purposes of this general permit, multi-family living complexes shall be treated as one parcel of property regardless of the legal division of ownership or control of the associated property; and

(f) Notwithstanding any other provisions of this

general permit, the design, construction and operation of the dock or pier and associated vessels shall not conflict with any manatee protection plan approved and adopted under section 379.2431(2)(t), F.S.

Rulemaking Authority 373.026(7), 373.043, 373.118(1), 373.406(5), 373.4131, 373.414(9), 373.418, 403.805(1) FS. Law Implemented 373.118(1), 373.406(5), 373.413, 373.4131, 373.414(9), 373.416, 373.418, 373.426, 403.814(1) FS. History—New 10-3-95, Formerly 62-341.427, Amended 10-1-13, 6-1-18.

62-330.405 General Conditions for All General Permits

The following general permit conditions are binding upon the permittee and are enforceable under chapter 373, F.S. These conditions do not apply to the general permit for stormwater management systems under section 403.814(12), F.S.

(1) The general permit is valid only for the specific activity indicated. Any deviation from the specified activity and the conditions for undertaking that activity shall constitute a violation of the permit and may subject the permittee to enforcement action and revocation of the permit under chapter 373, F.S.

(2) The general permit does not eliminate the necessity to obtain any required federal, state, local and special district authorizations prior to the start of any construction, alteration, operation, maintenance, removal or abandonment authorized by this permit; and it does not authorize any violation of any other applicable federal, state, local, or special district laws (including, but not limited to, those governing the "take" of listed species).

(3) The general permit does not convey to the permittee or create in the permittee any property right, or any interest in real property, nor does it authorize any entrance upon or activities on property which is not owned or controlled by the permittee, or convey any rights or privileges other than those specified in the general permit.

(4) The general permit does not relieve the permittee from liability and penalties when the permitted activity causes harm or injury to: human health or welfare; animal, plant or aquatic life; or property. It does not allow the permittee to cause pollution that violates state water quality standards.

(5) Section 253.77, F.S., provides that a person may not commence any excavation, construction, or other activity involving the use of state-owned or other lands of the state, the title to which is vested in the Board of Trustees of the Internal Improvement Trust Fund without obtaining the required consent, lease, easement, or other form of authorization authorizing the proposed use. Therefore, the permittee is responsible for obtaining any necessary authorizations from the Board of Trustees prior to commencing activity on state-owned lands.

(6) The authorization to conduct activities under a general permit may be modified, suspended or revoked in accordance with chapter 120, F.S., and section 373.429, F.S.

(7) The general permit is not transferable to a new third party. To be used by a different permittee, a new notice to use a general permit must be submitted in accordance with rule 62-330.402, F.A.C. Activities constructed in accordance with the terms and conditions of a general permit are automatically authorized to be operated and maintained by the permittee and subsequent owners in accordance with subsection 62-330.340(1), F.A.C. Any person holding the general permit, persons working under the general permit, and owners of land while work is conducted under the general permit shall remain liable for any corrective actions that may be required as a result of any permit violations prior to sale, conveyance, or other transfer of ownership or control of the permitted project, activity, or the real property at which the permitted project or activity is located.

(8) Upon reasonable notice to the permittee, Agency staff with proper identification shall have permission to enter, inspect, sample and test the permitted system to ensure conformity with the plans and specifications approved by the general permit.

(9) The permittee shall maintain any permitted project or activity in accordance with the plans submitted to the Agency and authorized in the general permit.

(10) A permittee's right to conduct a specific activity under the general permit is authorized

for a duration of five years.

(11) Activities shall be conducted in a manner that does not cause or contribute to violations of state water quality standards. Performance-based erosion and sediment control best management practices shall be implemented and maintained immediately prior to, during, and after construction as needed to stabilize all disturbed areas, including other measures specified in the permit to prevent adverse impacts to the water resources and adjacent lands. Erosion and sediment control measures shall be installed and maintained in accordance with the *State of Florida Erosion and Sediment Control Designer and Reviewer Manual (Florida Department of Environmental Protection and Florida Department of Transportation, June 2007)*, available at <https://www.flrules.org/Gateway/reference.asp?No=Ref-04227>, and the *Florida Stormwater Erosion and Sedimentation Control Inspector's Manual (Florida Department of Environmental Protection, Nonpoint Source Management Section, Tallahassee, Florida, July 2008)*, available at http://publicfiles.dep.state.fl.us/DEAR/Stormwater_Training_Docs/erosion-inspectors-manual.pdf.

(12) Unless otherwise specified in the general permit, temporary vehicular access within wetlands during construction shall be performed using vehicles generating minimum ground pressure to minimize rutting and other environmental impacts. Within forested wetlands, the permittee shall choose alignments that minimize the destruction of mature wetland trees to the greatest extent practicable. When needed to prevent rutting or soil compaction, access vehicles shall be operated on wooden, composite, metal, or other non-earthen construction mats. In all cases, access in wetlands shall comply with the following:

(a) Access within forested wetlands shall not include the cutting or clearing of any native wetland tree having a diameter four inches or greater at breast height;

(b) The maximum width of the construction access area shall be limited to 15 feet;

(c) All mats shall be removed as soon as practicable after equipment has completed passage through, or work has been completed, at any location along the alignment of the project, but in no case longer than seven days after equipment has completed work or passage through that location; and

(d) Areas disturbed for access shall be restored to natural grades immediately after the maintenance or repair is completed.

(13) Barges or other work vessels used to conduct in-water activities shall be operated in a manner that prevents unauthorized dredging, water quality violations, and damage to submerged aquatic communities.

(14) The construction, alteration, or use of the authorized project shall not adversely impede navigation or create a navigational hazard in the water body.

(15) Except where specifically authorized in the general permit, activities must not:

(a) Impound or obstruct existing water flow, cause adverse impacts to existing surface water storage and conveyance capabilities, or otherwise cause adverse water quantity or flooding impacts to receiving water and adjacent lands; or

(b) Cause an adverse impact to the maintenance of surface or ground water levels or surface water flows established pursuant to section 373.042, F.S., or a Works of the District established pursuant to section 373.086, F.S.

(16) If prehistoric or historic artifacts, such as pottery or ceramics, projectile points, stone tools, dugout canoes, metal implements, historic building materials, or any other physical remains that could be associated with Native American, early European, or American settlement are encountered at any time within the project site area, the permitted project shall cease all activities

involving subsurface disturbance in the vicinity of the discovery. The permittee or other designee shall contact the Florida Department of State, Division of Historical Resources, Compliance Review Section (DHR), at (850)245-6333, as well as the appropriate permitting agency office. Project activities shall not resume without verbal or written authorization from the Division of Historical Resources. If unmarked human remains are encountered, all work shall stop immediately and the proper authorities notified in accordance with section 872.05, F.S.

(17) The activity must be capable, based on generally accepted engineering and scientific principles, of being performed and of functioning as proposed, and must comply with any applicable District special basin and geographic area criteria.

(18) The permittee shall comply with the following when performing work within waters accessible to federally- or state-listed aquatic species, such as manatees, marine turtles, smalltooth sawfish, and Gulf sturgeon:

(a) All vessels associated with the project shall operate at "Idle Speed/No Wake" at all times while in the work area and where the draft of the vessels provides less than a four-foot clearance from the bottom. All vessels will follow routes of deep water whenever possible.

(b) All deployed siltation or turbidity barriers shall be properly secured, monitored, and maintained to prevent entanglement or entrapment of listed species.

(c) All in-water activities, including vessel operation, must be shut down if a listed species comes within 50 feet of the work area. Activities shall not resume until the animal(s) has moved beyond a 50-foot radius of the in-water work, or until 30 minutes elapses since the last sighting within 50 feet. Animals must not be herded away or harassed into leaving. All onsite project personnel are responsible for observing water-related activities for the presence of listed species.

(d) Any listed species that is killed or injured by work associated with activities performed shall be reported immediately to the Florida Fish and Wildlife Conservation Commission (FWC) Hotline at 1(888)404-3922 and ImperiledSpecies@myFWC.com.

(e) Whenever there is a spill or frac-out of drilling fluid into waters accessible to the above species during a directional drilling operation, the FWC shall be notified at ImperiledSpecies@myfwc.com with details of the event within 24 hours following detection of the spill or frac-out.

(19) The permittee shall hold and save the Agency harmless from any and all damages, claims, or liabilities which may arise by reason of the construction, alteration, operation, maintenance, removal, abandonment or use of any activity authorized by the general permit.

(20) The permittee shall immediately notify the Agency in writing of any submitted information that is discovered to be inaccurate.

Rulemaking Authority 373.026(7), 373.043, 373.118(1), 373.406(5), 373.4131, 373.414(9), 373.4145, 373.418, 403.805(1) FS. Law Implemented 373.044, 373.118(1), 373.129, 373.136, 373.406(5), 373.413, 373.4131, 373.414(9), 373.4145, 373.416, 373.422, 373.423, 373.429, 403.814(1) FS. History—New 10-3-95, Amended 10-1-07, Formerly 62-341.215, Amended 10-1-13, 6-1-18.

Special Consent Conditions

1. The applicant agrees to indemnify, defend and hold harmless the Board of Trustees and the State of Florida from all claims, actions, lawsuits and demands in any form arising out of the authorization to use sovereignty submerged lands or the applicant's use and construction of structures on sovereignty submerged lands. This duty to indemnify and hold harmless will include any and all liabilities that are associated with the structure or activity including special assessments or taxes that are now or in the future assessed against the structure or activity during the period of the authorization.
2. Failure by the Board of Trustees to enforce any violation of a provision of the authorization or waiver by the Board of Trustees of any provision of the authorization will not invalidate the provision not enforced or waived, nor will the failure to enforce or a waiver prevent the Board of Trustees from enforcing the unenforced or waived provision in the event of a violation of that provision.
3. Applicant binds itself and its successors and assigns to abide by the provisions and conditions set forth in the authorization. If the applicant or its successors or assigns fails or refuses to comply with the provisions and conditions of the authorization, the authorization may be terminated by the Board of Trustees after written notice to the applicant or its successors or assigns. Upon receipt of such notice, the applicant or its successors or assigns will have thirty (30) days in which to correct the violations. Failure to correct the violations within this period will result in the automatic revocation of this authorization.
4. All costs incurred by the Board of Trustees in enforcing the terms and conditions of the authorization will be paid by the applicant. Any notice required by law will be made by certified mail at the address shown on page one of the authorization. The applicant will notify the Board of Trustees in writing of any change of address at least ten days before the change becomes effective.
5. This authorization does not allow any activity prohibited in a conservation easement or restrictive covenant that prohibits the activity.

General Conditions for Authorizations for Activities on State-Owned Submerged Lands:

All authorizations granted by rule or in writing under rule 18-21.005, F.A.C., except those for geophysical testing, shall be subject to the general conditions as set forth in paragraphs (a) through (j) below. The general conditions shall be part of all authorizations under this chapter, shall be binding upon the grantee, and shall be enforceable under chapter 253 or 258, part II, F.S.

(a) Authorizations are valid only for the specified activity or use. Any unauthorized deviation from the specified activity or use and the conditions for undertaking that activity or use shall constitute a violation. Violation of the authorization shall result in suspension or revocation of the grantee's use of the sovereignty submerged land unless cured to the satisfaction of the Board.

(b) Authorizations convey no title to sovereignty submerged land or water column, nor do they constitute recognition or acknowledgment of any other person's title to such land or water.

(c) Authorizations may be modified, suspended or revoked in accordance with their terms or the remedies provided in sections 253.04 and 258.46, F.S., or chapter 18-14, F.A.C.

(d) Structures or activities shall be constructed and used to avoid or minimize adverse impacts to sovereignty submerged lands and resources.

(e) Construction, use, or operation of the structure or activity shall not adversely affect any species which is endangered, threatened or of special concern, as listed in rules 68A-27.003, 68A-27.004 and 68A-27.005, F.A.C.

(f) Structures or activities shall not unreasonably interfere with riparian rights. When a court of competent jurisdiction determines that riparian rights have been unlawfully affected, the structure or activity shall be modified in accordance with the court's decision.

(g) Structures or activities shall not create a navigational hazard.

(h) Activities shall not interfere with the public easement for traditional uses of the sandy beaches provided in section 161.141, F.S.

(i) Structures shall be maintained in a functional condition and shall be repaired or removed if they become dilapidated to such an extent that they are no longer functional. This shall not be construed to prohibit the repair or replacement subject to the provisions of rule 18-21.005, F.A.C., within one year, of a structure damaged in a discrete event such as a storm, flood, accident, or fire.

(j) Structures or activities shall be constructed, operated, and maintained solely for water dependent purposes, or for non-water dependent activities authorized under paragraph 18-21.004(1)(g), F.A.C., or any other applicable law.

Rulemaking Authority 253.03(7), 253.73 FS. Law Implemented 253.001, 253.03, 253.141, 253.0347, 253.665, 253.71, 253.68, 253.72, 253.74, 253.75, 253.77 FS. History—New 3-27-82, Amended 8-1-83, Formerly 16Q-21.04, 16Q-21.004, Amended 12-25-86, 1-25-87, 3-15-90, 8-18-92, 10-15-98, 12-11-01, 10-29-03, 12-16-03, 3-8-04, 10-27-05, 4-14-08, 9-1-09, 3-21-19.

ROOF DETAILS
 for
TODD LUKE DOCK
 at
3066 KINGFISHER POINT
CHULUOTA, FL

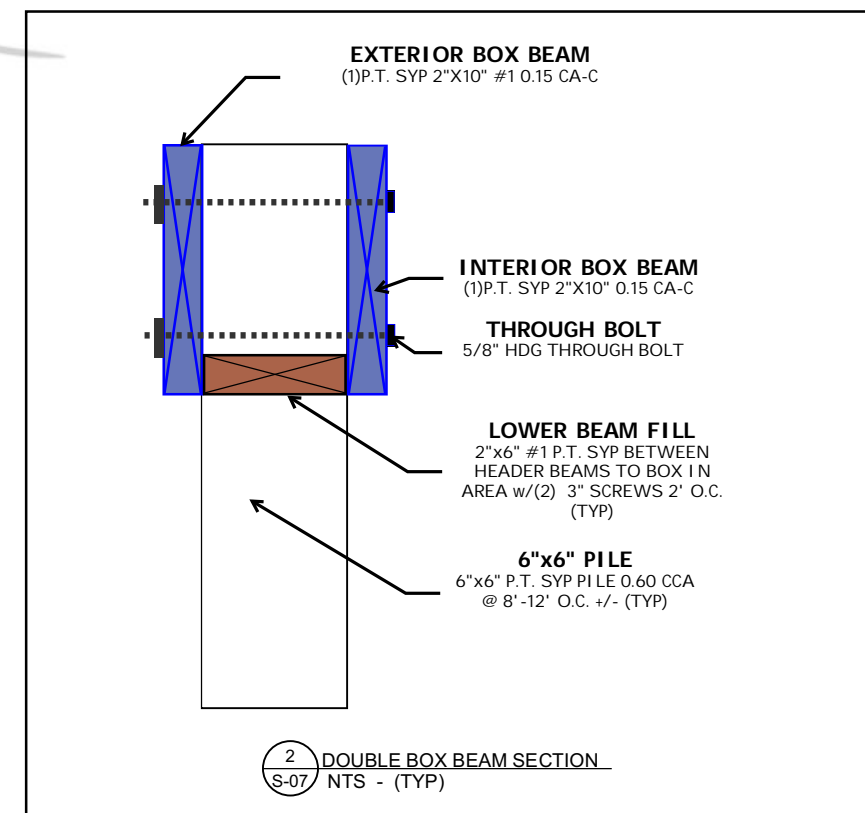
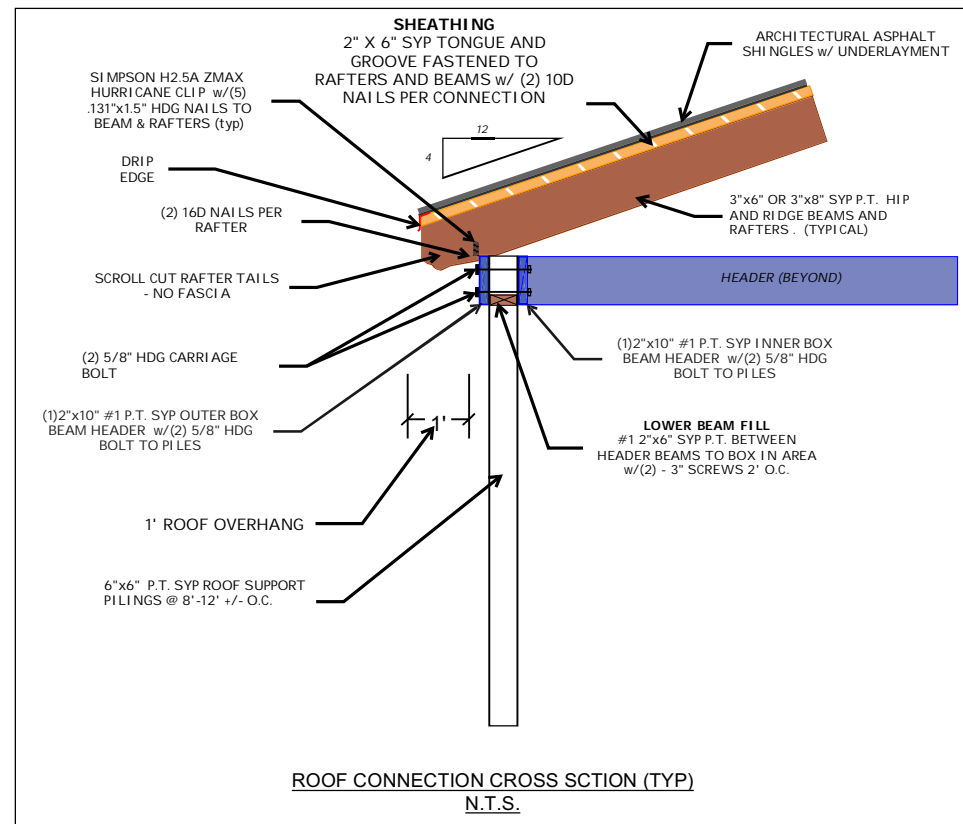

This item has been electronically signed and sealed by Jennifer L. Teliga, P.E. on the Time Stamp shown using digital signature. Printed copies of this document are not considered signed and sealed and the signature must be verified on any electronic copy.

ENGINEER:

JENNIFER L. TELIGA, P.E.
 P.E. # 64621
 2901 BLUESTEM LN.
 CLERMONT, FL 34714
 (321)662-7503

JOB: *Todd Luke Dock*

DATE: *1/25/2024*

VERSION: *2*

SCALE: *N.T.S*

DRAWN BY: *R.A.H.*

APPROVED BY:

SHEET NO.:
S-07





WALKWAY DETAILS
 for
 TODD LUKE DOCK
 at
 3066 KINGFISHER POINT
 CHULUOTA, FL

ENGINEER:

 JENNIFER L. TELIGA, P.E.
 P.E. # 64621
 2901 BLUESTEM LN.
 CLERMONT, FL 34714
 (321)662-7503

JOB: *Todd Luke Dock*
 DATE: 1/25/2024
 VERSION: 2
 SCALE: 1"=5'
 DRAWN BY: *R.A.H.*
 APPROVED BY:
SHEET NO.:
 S-01

LEGEND

-  = 6"x6" P.T. SYP 0.60 CCA PILE
-  = 2"x10" #2 P.T. SYP 0.40 ACQ OR 0.15 CA-C CROSS TIE
-  = 2"x8" #2 P.T. SYP 0.40 ACQ OR 0.15 CA-C JOIST
-  = 2"x6" #2 P.T. SYP 0.40 ACQ OR 0.15 CA-C KNEE BRACING
-  = 5/4"x6" WEARDECK REINFORCED POLYMERIC DECK BOARDS

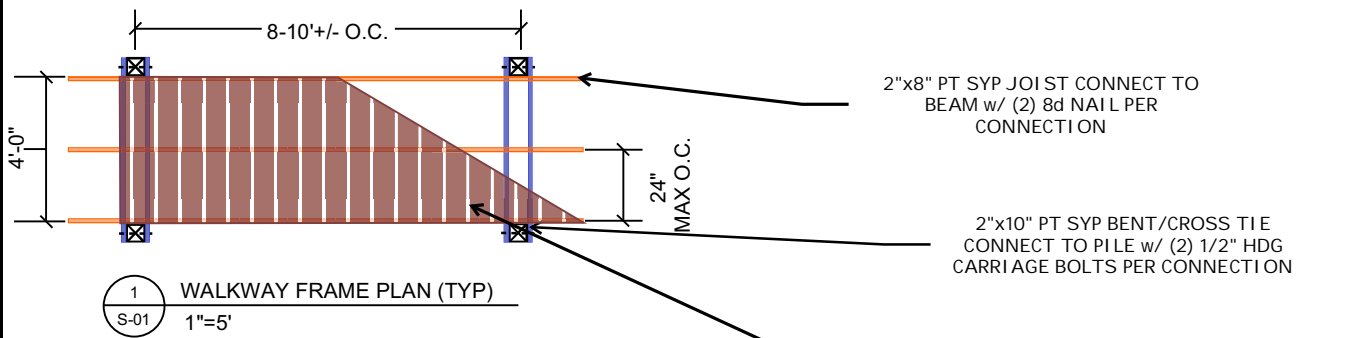

2"x8" PT SYP JOIST CONNECT TO BEAM w/ (2) 8d NAIL PER CONNECTION

2"x10" PT SYP BENT/CROSS TIE CONNECT TO PILE w/ (2) 1/2" HDG CARRIAGE BOLTS PER CONNECTION

5/4"x6" WEARDECK DECKING ATTACHED TO JOISTS w/ (2) 2.5" HDG DECK SCREWS PER CONNECTION

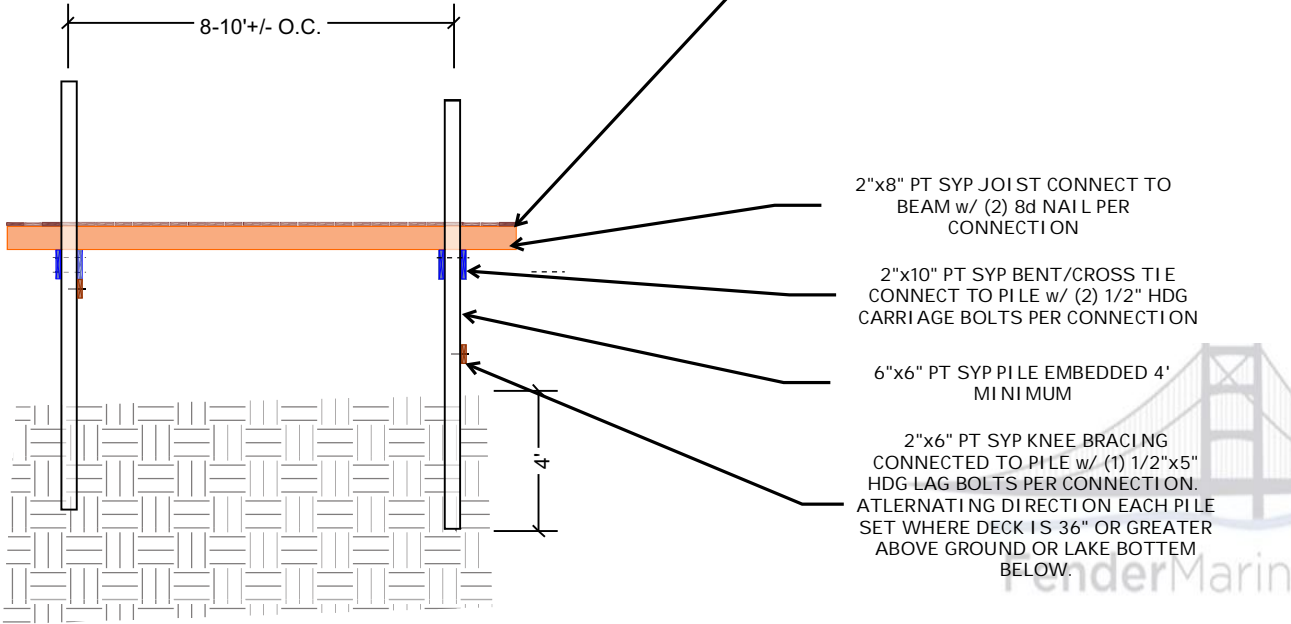

2"x8" PT SYP JOIST CONNECT TO BEAM w/ (2) 8d NAIL PER CONNECTION

2"x10" PT SYP BENT/CROSS TIE CONNECT TO PILE w/ (2) 1/2" HDG CARRIAGE BOLTS PER CONNECTION

6"x6" PT SYP PILE EMBEDDED 4' MINIMUM

2"x6" PT SYP KNEE BRACING CONNECTED TO PILE w/ (1) 1/2"x5" HDG LAG BOLTS PER CONNECTION. ALTERNATING DIRECTION ON EACH PILE SET WHERE DECK IS 36" OR GREATER ABOVE GROUND OR LAKE BOTTEM BELOW.

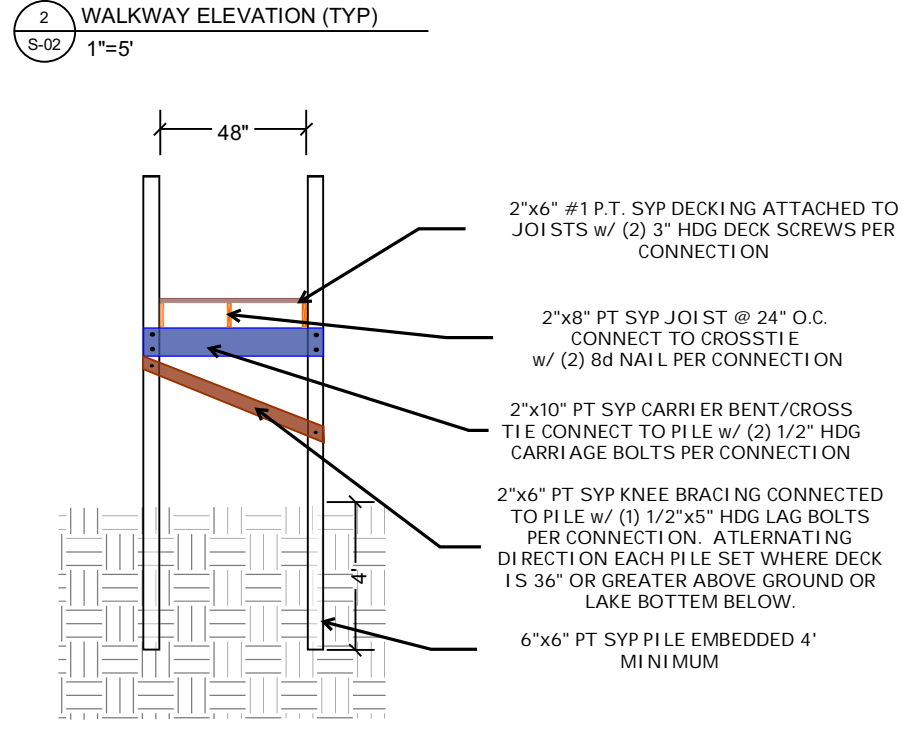

2"x6" #1 P.T. SYP DECKING ATTACHED TO JOISTS w/ (2) 3" HDG DECK SCREWS PER CONNECTION

2"x8" PT SYP JOIST @ 24" O.C. CONNECT TO CROSSTIE w/ (2) 8d NAIL PER CONNECTION

2"x10" PT SYP CARRIER BENT/CROSS TIE CONNECT TO PILE w/ (2) 1/2" HDG CARRIAGE BOLTS PER CONNECTION

2"x6" PT SYP KNEE BRACING CONNECTED TO PILE w/ (1) 1/2"x5" HDG LAG BOLTS PER CONNECTION. ALTERNATING DIRECTION ON EACH PILE SET WHERE DECK IS 36" OR GREATER ABOVE GROUND OR LAKE BOTTEM BELOW.

6"x6" PT SYP PILE EMBEDDED 4' MINIMUM

This item has been electronically signed and sealed by Jennifer L. Teliga, P.E. on the Time Stamp shown using digital signature. Printed copies of this document are not considered signed and sealed and the signature must be verified on any electronic copy.

LOCATION

DECKING TO STRINGER	2" x 5/4"	2.5" SCREWS
STRINGER CROSS TIE	2" x 8"	(2)12d TOE NAIL OR EQIV
BENT TO POST	2" x 10"	(2)5/8" CARRIAGE BOLT
KNEE BRACE TO PILE	2" x 6"	(1)1/2" HDG LAG BOLT

AWPA RETENTION REQUIREMENTS

APPLICATION USE CATEGORY	(PCF)
ABOVE GROUND	0.25 ACQ OR 0.10 CA-C
GROUND/FRESH WATER CONTACT	0.40 ACQ OR 0.15 CA-C
PERMANENT WOOD FOUNDATION	2.50 CCA
SALT WATER SPLASH	2.50 CCA
SALT WATER IMMERSION	2.50 CCA
LUMBER, TIMBERS AND PLYWOOD	-
STRUCTURAL POLES	0.60 CCA
FOUNDATIONS / FRESHWATER	0.60 CCA

GENERAL REQUIREMENTS

REPRODUCTIONS OF CONTRACT DRAWINGS BY CONTRACTOR IN LIEU OF PREPARATION OF SHOP DRAWINGS SIGNIFIES ACCEPTANCE OF INFORMATION SHOWN AS CORRECT AND OBLIGATES HIMSELF TO ANY EXPENSE, REAL OR IMPLIED, ARISING FROM THEIR USE. A CHANGE TO THE STRUCTURAL DRAWINGS DUE TO THE ACCEPTANCE OF ALTERNATES AND/OR SUBSTITUTES IS THE RESPONSIBILITY OF THE CONTRACTOR AND MUST BE SUBMITTED TO THE ENGINEER FOR APPROVAL. THE GENERAL CONTRACTOR AND EACH SUBCONTRACTOR SHALL VERIFY ALL EXISTING CONDITIONS PRIOR TO STAT OF ANY WORK. ALL INCONSISTENCIES SHALL BE REPORTED TO THE DESIGNER AND/OR STRUCTURAL ENGINEER, IF NEEDED, SHOULD CONTRACTOR CONSTRUCT THE PREMISES IN A FASHION NOT CONSISTENT WITH THE PLANS PREPARED BY THE DESIGNER AND/OR STRUCTURAL ENGINEER, THEN DESIGNER AND/OR STRUCTURAL ENGINEER SHALL BEAR NO RESPONSIBILITY OR LIABILITY FOR THE CONSTRUCTION OF PREMISES AND ACCURACY OF THE DRAWINGS.

APPLICABLE CODES AND STANDARDS

CONSTRUCTION SHALL CONFORM TO THE REQUIREMENTS OF THESE STRUCTURAL SPECIFICATIONS AND THE REQUIREMENTS CONTAINED IN THE FOLLOWING CODES AND STANDARDS. WHEN A DIFFERENCE EXISTS BETWEEN THESE SPECIFICATIONS AND ANY OTHER GOVERNING CODE, THE MORE STRINGENT SHALL CONTROL. ANY OTHER ITEMS NOT COVERED THEREIN SHALL BE COMMENSURATE WITH SOUND ENGINEERING AND STANDARD CONSTRUCTION PRACTICES

FLORIDA BUILDING CODE 2023, 8th EDITION

AMERICAN WOOD COUNCIL - NATIONAL DESIGN SPECIFICATIONS FOR WOOD CONSTRUCTION 2018 EDITION
 AMERICAN SOCIETY OF CIVIL ENGINEERS (ASCE 7-22) MINIMUM DESIGN LOADS FOR BUILDINGS AND OTHER STRUCTURES.

DESIGN LOADS

PURSUANT TO CHAPTER 1609 LL (-TABLE 1607, WL-SECTION 1609)
 ULTIMATE WIND: 150 MPH AT 3 SECOND GUST (30 PSF MINIMUM)
 RISK CATEGORY II (TABLE 1604-5)
 EXPOSURE CATEGORY "D" (FBC 1609.4.3 AND ASCE 7-10, SECTION 26.7.2)
 DECK LIVE LOAD: 100 PSF
 DEAD LOAD: 10 PSF
 COMPONENTS AND CLADDING DESIGN WIND PRESSURES: +38 PSF/-38PSF
 OPEN STRUCTURE WITH A ZERO PRESSURE COEFFICIENT

GENERAL NOTES

1. DETAILS SHOWN ON PLANS MAY BE FOR TYPICAL CONDITIONS. FOR CONDITIONS NOT SHOWN, PROVIDE DETAILS OF A SIMILAR NATURE.
2. DIMENSIONS SHOWN ON THESE PLANS SHALL BE VERIFIED BY THE CONTRACTOR OR BUILDER PRIOR TO CONSTRUCTION. THESE PLANS MAY NOT BE DRAWN TO SCALE. SCALING OF DRAWINGS IS STRONGLY DISCOURAGED. DIMENSIONED DRAWINGS TAKE PRECEDENCE OVER SCALED. IF CONFLICTS EXIST IN THE DRAWINGS, THE MORE STRINGENT SHALL PREVAIL.
3. THE CONTRACTOR SHALL COORDINATE ALL NEW WORK WITH THE EXISTING CONDITION AND SHALL REPORT ANY DISCREPANCIES TO THE ENGINEER AND OWNER.
4. OBTAIN APPROVAL FROM THE ENGINEER PRIOR TO ALL STRUCTURAL CHANGES.
5. CONTRACTOR IS RESPONSIBLE FOR ALL CONSTRUCTION PRACTICES, INCLUDING TECHNIQUES, PROCEDURES, SHORING AND THE SEQUENCE OF CONSTRUCTION. CONTRACTOR SHOULD NOTIFY ENGINEER IF A CONFLICT ARISES DUE TO VARIATIONS OR OTHER PROBLEMS WITH THE CONSTRUCTION DOCUMENTS.
6. SURVEY AND WETLAND INFORMATION IS PROVIDED TO ENGINEER AND IS PORTRAYED FOR CONCEPTUAL LOCATION ONLY. DISPLAY DOES NOT CONSTITUTE REVIEW ACCEPTANCE OR ENDORSEMENT OF INFORMATION CONTAINED THEREIN. (BASED ON PROPERTY SURVEY BY OTHERS)

TIMBER

DESIGN IN ACCORDANCE WITH THE NATIONAL DESIGN SPECIFICATION FOR WOOD CONSTRUCTION, WITH LOADING IN ACCORDANCE WITH THE FLORIDA BUILDING CODE. ALL GRADED STRUCTURAL LUMBER SHALL BE PRESSURE TREATED AND MEET THE FOLLOWING MINIMUM REQUIREMENTS:

MINIMUM BENDING STRESS = 1250 PSI (NO. 1 DENSE SOUTHERN PINE)
 YOUNG MODULUS = 1600 ksi
 MAXIMUM OF 15% MOISTURE CONTENT
 CONTRACTOR MAY USE SOUTHERN YELLOW PINE OR U.O.N.

LUMBER SIZES SHOWN ARE NOMINAL SIZES. LUMBER SHALL BE FURNISHED IN FINISHED SIZES MEETING THE REQUIREMENTS OF THE AMERICAN SOFTWOOD LUMBER STANDARD.

MATERIALS

1. ALL STRUCTURAL LUMBER SHALL BE SOUTHERN YELLOW PINE NO. 2 OR BETTER AS NOTED
2. ALL LUMBER EXPOSED TO THE WEATHER OR GROUND SHALL BE PRESSURE TREATED.
3. ALL HURRICANE LOAD CONNECTORS SHALL BE AS NOTED ON PLANS
4. BOLTS: ALL BOLTS SHALL BE GALVANIZED BE ASTM A572, GRADE 50THREADED ROUND STOCK WITH A MINIMUM YIELD STRESS OF 50,000 PSI
5. SIMPSON STRAPS SHALL BE GALVANIZED

RAMPS

1. RAMP RUNS SHALL HAVE A RUNNING SLOPE NOT STEEPER THAN 1:12
2. CROSS SLOP OF RAMP RUNS SHALL NOT BE STEEPER THAN 1:48
3. THE RISE FOR ANY RAMP RUN SHALL BE 30 INCHES MAXIMUM
4. RAMPS SHALL HAVE 60" LANDINGS AT THE TOP AND THE BOTTOM OF EACH RAMP RUN



GENERAL NOTES
 TODD LUKE DOCK
 at
 3066 KINGFISHER POINT
 CHULUOTA, FL

ENGINEER:

JENNIFER L. TELIGA, P.E.
 P.E. # 64621
 2901 BLUESTEM LN.
 CLERMONT, FL 34714
 (321)662-7503

JOB: Todd Luke Dock

DATE: 1/25/2024

VERSION: 2

SCALE: N.T.S

DRAWN BY: R.A.H.

APPROVED BY:

SHEET NO.:
S-08

This item has been electronically signed and sealed by Jennifer L. Teliga, P.E. on the Time Stamp shown using digital signature. Printed copies of this document are not considered signed and sealed and the signature must be verified on any electronic copy.

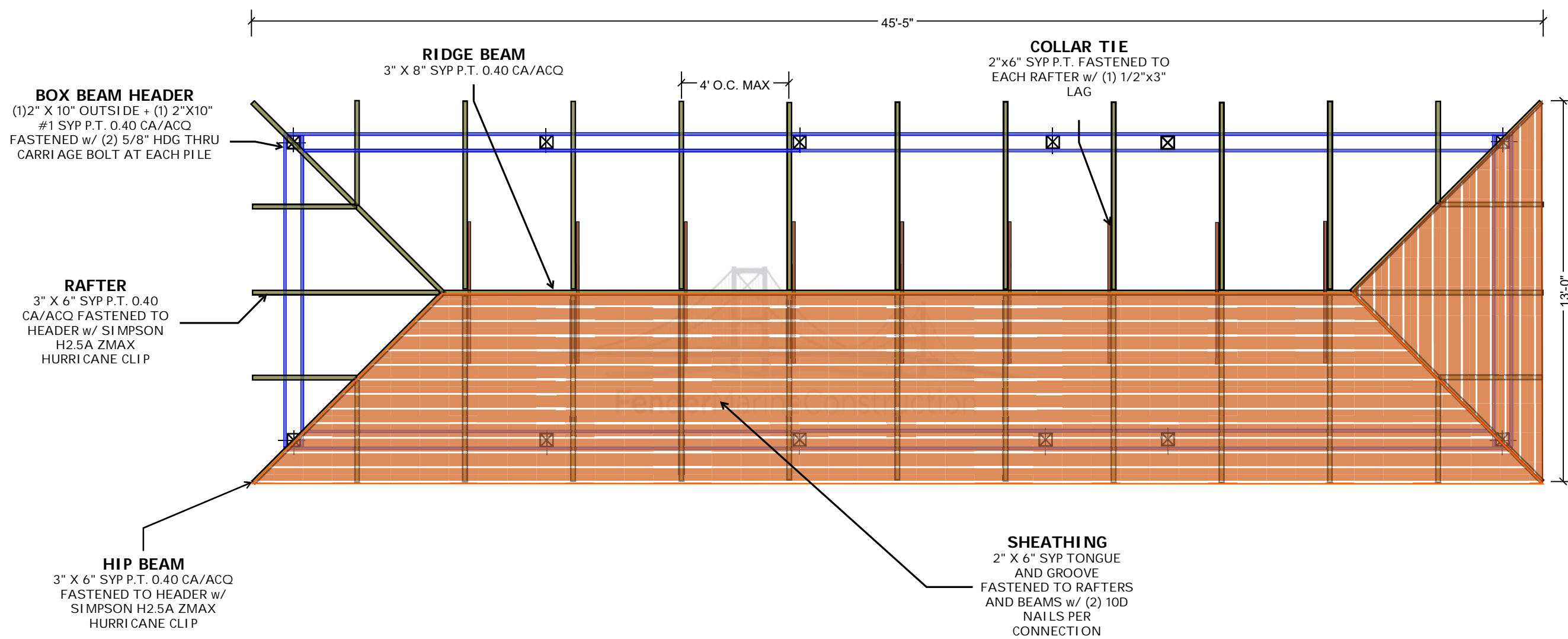
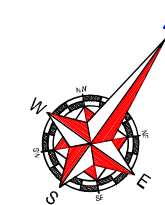

ROOF FRAME PLAN
 for
TODD LUKE DOCK
 at
3066 KINGFISHER POINT
CHULUOTA, FL

ENGINEER:

JENNIFER L. TELIGA, P.E.
 P.E. # 64621
 2901 BLUESTEM LN.
 CLERMONT, FL 34714
 (321)662-7503

JOB: *Todd Luke Dock*

DATE: *1/25/2024*

VERSION: *2*

SCALE: *1"=4'*

DRAWN BY: *R.A.H.*

APPROVED BY:

SHEET NO.:
 S-06

This item has been electronically signed and sealed by Jennifer L. Teliga, P.E. on the Time Stamp shown using digital signature. Printed copies of this document are not considered signed and sealed and the signature must be verified on any electronic copy.

LEGAL DESCRIPTION

LOT 15, MILLS COVE, ACCORDING TO THE PLAT THEREOF AS RECORDED IN PLAT BOOK 61, PAGES 42 THROUGH 48, PUBLIC RECORDS OF SEMINOLE COUNTY, FLORIDA.

PARCEL IDENTIFICATION NUMBER

22-21-32-5QQ-0000-0150

SECTION 27, TOWNSHIP 21 SOUTH, RANGE 32 EAST, SEMINOLE COUNTY, FL

ALL ELEVATIONS NAVD '88 DATUM

NOTE: THE WATERWARD END OF THE DOCK IS APPROX. 3460' FROM THE DUE WESTERN SHORELINE. (=APPROX 4.5% PROJECTION INTO WATERBODY)

This item has been electronically signed and sealed by Jennifer L. Teliga, P.E. on the Time Stamp shown using digital signature. Printed copies of this document are not considered signed and sealed and the signature must be verified on any electronic copy.

FenderMarineConstruction
 FENDERMARINE CONSTRUCTION
 8010 SUNPORT DR., UNIT 123
 ORLANDO, FL 32809
 (407)481-8383
 WWW.FENDERMARINE.COM
 CBC1267149

SITE PLAN
 for
 TODD LUKE DOCK
 at
 3066 KINGFISHER POINT
 CHULUOTA, FL

ENGINEER:

JENNIFER L. TELIGA, P.E.
 P.E. # 64621
 2901 BLUESTEM LN.
 CLERMONT, FL 34714
 (321)662-7503

JOB: Todd Luke Dock

DATE: 1/25/2024

VERSION: 2

SCALE: 1"=80'

DRAWN BY: R.A.H.

APPROVED BY:

SHEET NO.:
 C-01

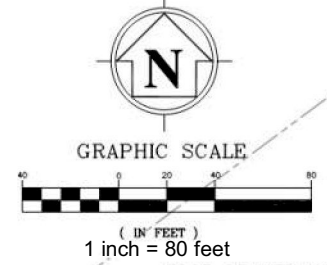
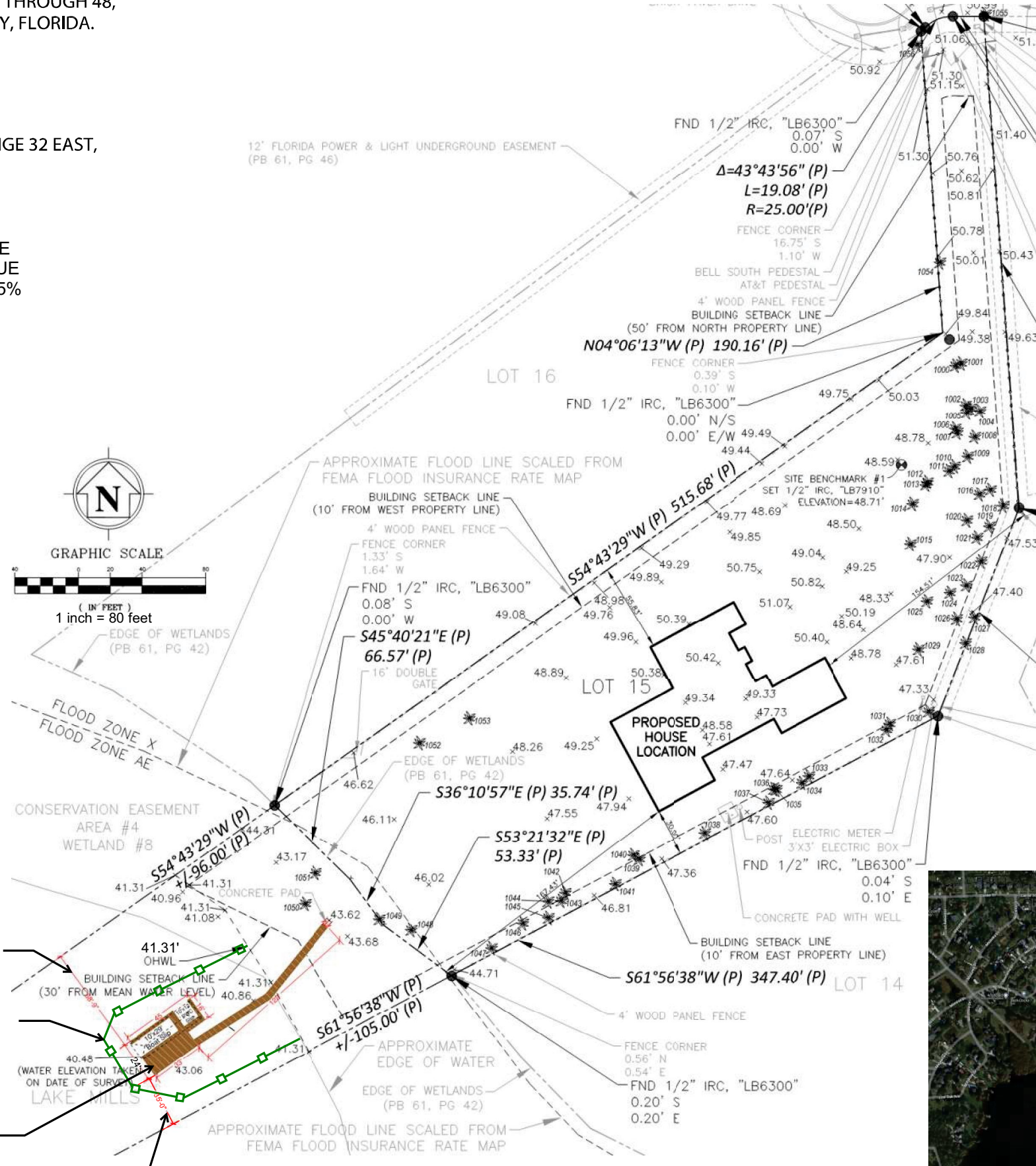





SIDE SETBACK = 68'-9"

TURBIDITY BARRIER

PROPOSED REPLACEMENT BOAT DOCK
 TERMINAL PLATFORM = 984 SF
 (45'x16' + 33'x8')

SIDE SETBACK = 35'-0"

LEGEND

-  = 6"x6" P.T. SYP 0.60 CCA PILE
-  = 2"x10" #2 P.T. SYP 0.40 ACQ OR 0.15 CA-C CROSS TIE
-  = 2"x8" #2 P.T. SYP 0.40 ACQ OR 0.15 CA-C JOIST
-  = 2"x6" #2 P.T. SYP 0.40 ACQ OR 0.15 CA-C KNEE BRACING
-  = 2"x6" #1 P.T. SYP .25 ACQ OR .10 CA-C DECK BOARDS

This item has been electronically signed and sealed by Jennifer L. Teliga, P.E. on the Time Stamp shown using digital signature. Printed copies of this document are not considered signed and sealed and the signature must be verified on any electronic copy.



FenderMarineConstruction
 8010 SUNPORT DR., UNIT 123
 ORLANDO, FL 32809
 (407)481-8383
 WWW.FENDERMARINE.COM
 CBC1267149

**TERMINAL PLATFORM WEST
 ELEVATION**
 for
TODD LUKE DOCK
 at
**3066 KINGFISHER POINT
 CHULUOTA, FL**

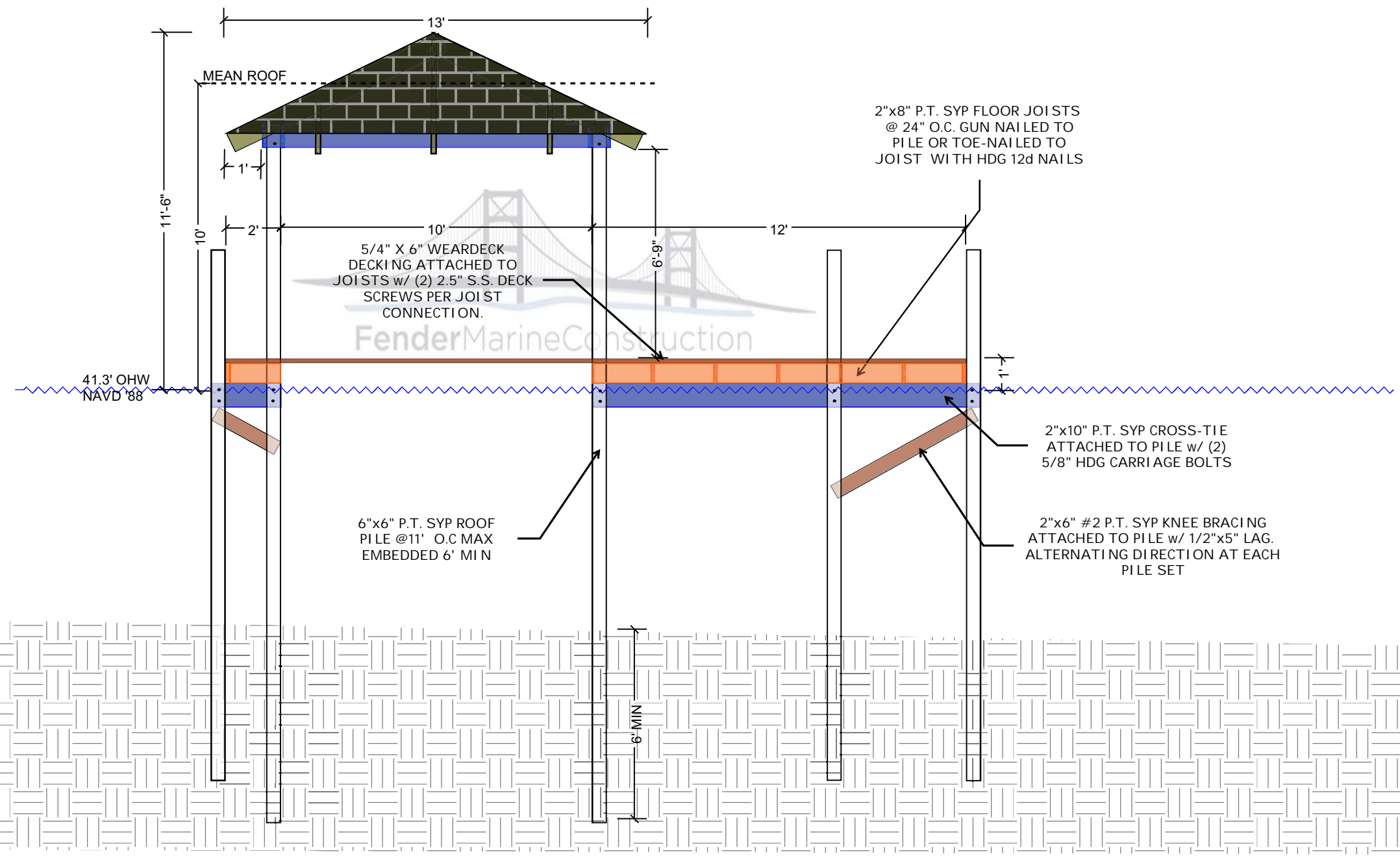

ENGINEER:

JENNIFER L. TELIGA, P.E.
 P.E. # 64621
 2901 BLUESTEM LN.
 CLERMONT, FL 34714
 (321)662-7503

JOB: *Todd Luke Dock*

DATE: 1/25/2024

VERSION: 2

SCALE: 1"=5'

DRAWN BY: *R.A.H.*

APPROVED BY:

SHEET NO.:
S-04

LEGAL DESCRIPTION

LOT 15, MILLS COVE, ACCORDING TO THE PLAT THEREOF AS RECORDED IN PLAT BOOK 61, PAGES 42 THROUGH 48, PUBLIC RECORDS OF SEMINOLE COUNTY, FLORIDA.

PARCEL IDENTIFICATION NUMBER

22-21-32-5QQ-0000-0150

SECTION 27, TOWNSHIP 21 SOUTH, RANGE 32 EAST, SEMINOLE COUNTY, FL

ALL ELEVATIONS NAVD '88 DATUM

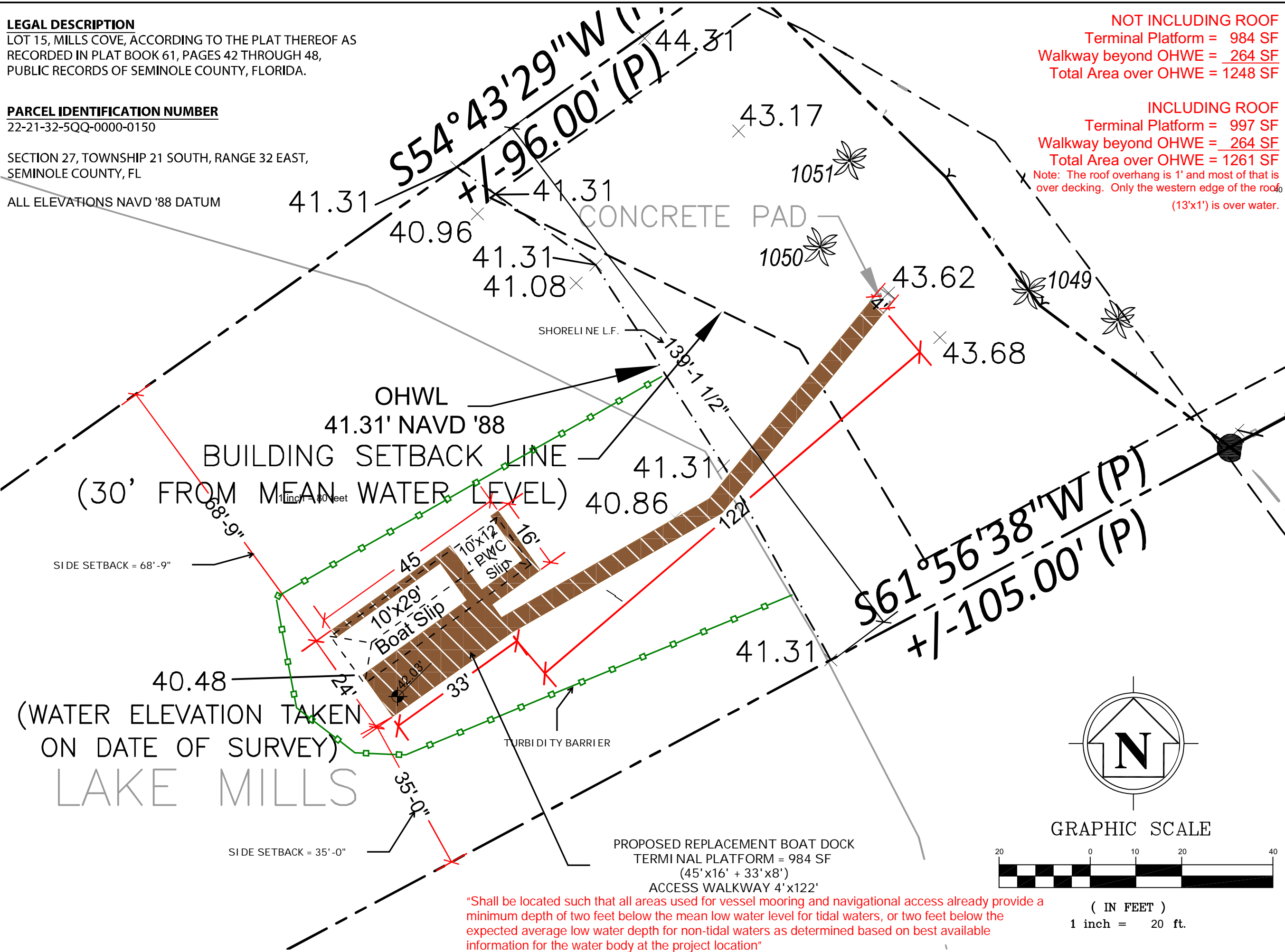

NOT INCLUDING ROOF
 Terminal Platform = 984 SF
 Walkway beyond OHWE = 264 SF
 Total Area over OHWE = 1248 SF

INCLUDING ROOF
 Terminal Platform = 997 SF
 Walkway beyond OHWE = 264 SF
 Total Area over OHWE = 1261 SF
 Note: The roof overhang is 1' and most of that is over decking. Only the western edge of the roof (13'x1') is over water.

Fender Marine Construction
 FENDER MARINE CONSTRUCTION
 8010 SUNPORT DR., UNIT 123
 ORLANDO, FL 32809
 (407)481-8383
 WWW.FENDERMARINE.COM
 CBC1267149

EXPLODED SITE PLAN
 for
 TODD LUKE DOCK
 at
 3066 KINGFISHER POINT
 CHULUOTA, FL

ENGINEER:
 JENNIFER L. TELIGA, P.E.
 P.E. # 64621
 2901 BLUESTEM LN.
 CLERMONT, FL 34714
 (321)662-7503

JOB: Todd Luke Dock
DATE: 3/6/2024
VERSION: 3

SCALE: 1"=20'
DRAWN BY: R.A.H.

APPROVED BY:

SHEET NO.:
 C-02

"Shall be located such that all areas used for vessel mooring and navigational access already provide a minimum depth of two feet below the mean low water level for tidal waters, or two feet below the expected average low water depth for non-tidal waters as determined based on best available information for the water body at the project location"