

Property Record Card



Parcel 03-20-29-5PG-FB00-0000

Property Address 600 SHADOWMOSS CIR LAKE MARY, FL 32746

Parcel Location

Site View

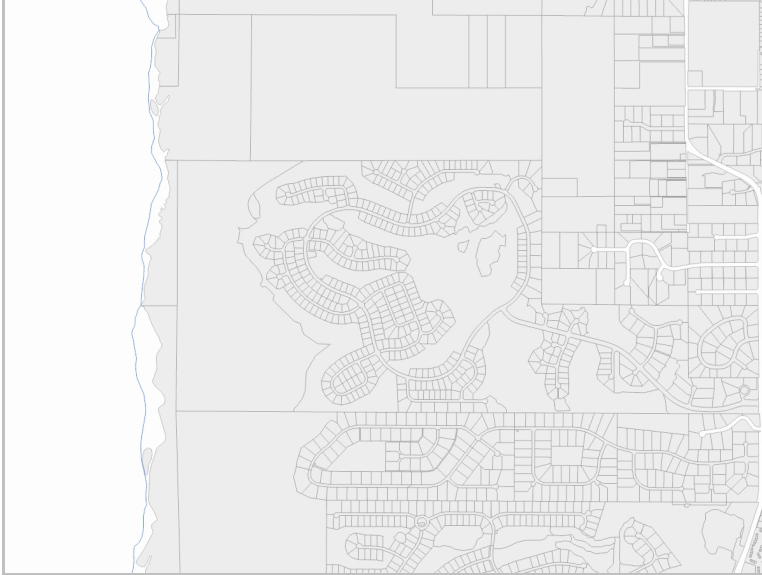

0320295PGFB000000 05/16/2023

Parcel Information

Value Summary

Parcel	03-20-29-5PG-FB00-0000		2024 Working Values	2023 Certified Values
Owner(s)	MAGNOLIA GOLF CLUB HOLDING LLC	Valuation Method	Cost/Market	Cost/Market
Property Address	600 SHADOWMOSS CIR LAKE MARY, FL 32746	Number of Buildings	4	4
Mailing	PO BOX 1263 LONGWOOD, FL 32752	Depreciated Bldg Value		
Subdivision Name	MAGNOLIA PLANTATION	Depreciated EXFT Value		
Tax District	01-COUNTY-TX DIST 1	Land Value (Market)	\$397,719	\$397,719
DOR Use Code	38-GOLF COURSE	Land Value Ag		
Exemptions	None	Just/Market Value	\$397,719	\$397,719
AG Classification	No	Portability Adj		
		Save Our Homes Adj	\$0	\$0
		Amendment 1 Adj	\$0	\$0
		P&G Adj	\$0	\$0
		Assessed Value	\$397,719	\$397,719

2023 Certified Tax Summary

2023 Tax Amount without Exemptions	\$5,292.84
2023 Tax Bill Amount	\$5,292.84

* Does NOT INCLUDE Non Ad Valorem Assessments

Legal Description

TRACT F-B & TRACTS G & H & J & K & F-A & F-C
MAGNOLIA PLANTATION
PB 55 PGS 73 THRU 93

ROAD DISTRICT	\$397,719	\$0	\$397,719
FIRE	\$397,719	\$0	\$397,719
Schools	\$397,719	\$0	\$397,719

Land

Method	Frontage	Depth	Units	Units Price	Land Value
ACREAGE			189.39	\$7,000.00	\$397,719

Building Information

#	Description	Year Built Actual/Effective	Stories	Total SF	Ext Wall	Adj Value	Repl Value	Appendages				
1	WOOD BEAM/COLUMN	2000	1	5618.00	WOOD SIDING WITH WOOD OR METAL STUDS			<table border="1"> <thead> <tr> <th>Description</th> <th>Area</th> </tr> </thead> <tbody> <tr> <td></td> <td></td> </tr> </tbody> </table>	Description	Area		
Description	Area											

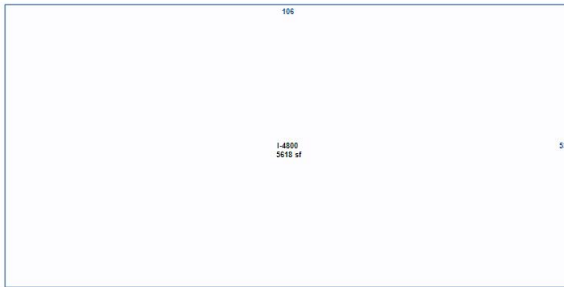

Building 1 - Page 1

#	Description	Year Built Actual/Effective	Stories	Total SF	Ext Wall	Adj Value	Repl Value	Appendages				
2	STEEL/PRE ENGINEERED.	2001	1	4850.00	METAL PREFINISHED - INSULATED	\$0	\$0	<table border="1"> <thead> <tr> <th>Description</th> <th>Area</th> </tr> </thead> <tbody> <tr> <td>CARPORT FINISHED</td> <td>950.00</td> </tr> </tbody> </table>	Description	Area	CARPORT FINISHED	950.00
Description	Area											
CARPORT FINISHED	950.00											

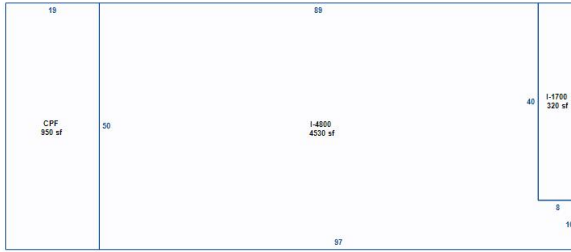

Building 2 - Page 1

#	Description	Year Built Actual/Effective	Stories	Total SF	Ext Wall	Adj Value	Repl Value	Appendages
3	WOOD BEAM/COLUMN	2001	1	5370.00	WOOD SIDING WITH WOOD OR METAL STUDS	\$0	\$0	

Description	Area
OPEN PORCH FINISHED	959.00
OPEN PORCH FINISHED	1553.00

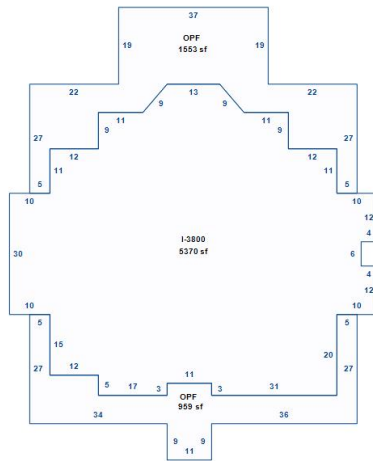

Building 3 - Page 1

#	Description	Year Built Actual/Effective	Stories	Total SF	Ext Wall	Adj Value	Repl Value	Appendages
4	MASONRY PILASTER .	2012	1	4692.00	SELECT LAP SIDING	\$0	\$0	

Description	Area
UTILITY FINISHED	90.00

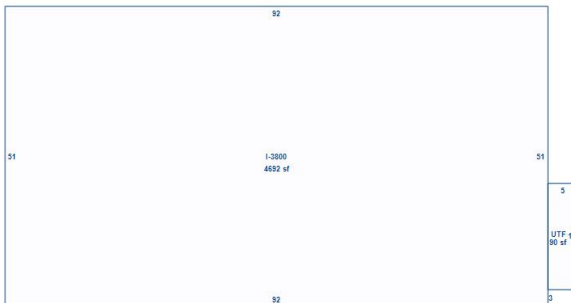

Building 4 - Page 1

Permits

Permit #	Description	Agency	Amount	CO Date	Permit Date
01410	PLUMBING PAD PER PERMIT 600 SHADOWMOSS CIR	County	\$2,400		2/1/2001
10584	RANGE HOOD; PAD PER PERMIT 600 SHADOWMOSS CIR	County	\$4,000		11/1/2000
00758	ELECTRIC WIRING; PAD PER PERMIT 906 SWEETGUM VALLEY PL; CONTRACTOR - DIRECT ELECTRIC, INC	County	\$900		1/1/2001
03065	MISC ELECTRIC WIRING; PAD PER PERMIT 1718 SHADOWMOSS CIR	County	\$0		4/1/2000
02462	CART SHED; PAD PER PERMIT 610 SHADOWMOSS CIR	County	\$175,584	11/28/2000	3/24/2000
02463	MAINT, EQUIP STORAGE BLDG; PAD PER PERMIT 720 SHADOWMOSS AVE	County	\$179,800	11/17/2001	3/24/2000
04036	ELECTRIC WIRING; PAD PER PERMIT 1718 SHADOWMOSS CIR; GOLF COURSE	County	\$0		5/2/2000
03068	MISC ELECTRIC WIRING; GOLF COURSE; PAD PER PERMIT 610 SHADOWMOSS CIR	County	\$0		4/1/2000
11367	PAD PER PERMIT;600 SHADOWMOSS CIR RANGEHOOD SUPPRESSION SYSTEM	County	\$460		12/1/2000
08366	ELECTRIC WIRING; GOLF COURSE; PAD PER PERMIT 1028 SHADOWMOSS CIR	County	\$0		9/11/2000
14168	GROUND SIGNS; PAD PER PERMIT 612 SHADOWMOSS CIR	County	\$0		12/19/2003
03069	MISC ELECTRIC WIRING; GOLF COURSE; PAD PER PERMIT 598 SHADOWMOSS CIR	County	\$0		4/1/2000
04325	MECHANICAL & CONDENSOR	County	\$2,200		6/1/2010
08666	INSTALL PUMPER CONNECTION, FILL LINE, WATER LEVEL GAUGE, & VENT TO EXISTING TANK - 580 SHADOWMOSS CIR	County	\$4,400		11/20/2012
03877	MIKE BENDER GOLF ACADEMY - TRAINING FACILITY - 580 SHADOWMOSS CIR	County	\$498,741	12/31/2012	5/23/2012
00284	MECHANICAL&CONDENSOR	County	\$1,800		1/1/2001
02460	COMFORT STATION; PAD PER PERMIT 1251 SHADOWMOSS CIR; CONTRACTOR - M H WILLIAMS CONSTRUCTION INC	County	\$24,000	12/11/2000	3/24/2000
02446	AMUSEMENT - SOCIAL & RECREATION; PAD PER PERMIT 600 SHADOWMOSS AVE; GOLF COURSE	County	\$756,000	3/6/2001	3/24/2000
04038	ELECTRIC WIRING; GOLF COURSE; PAD PER PERMIT 1808 REDWOOD GROVE TER	County	\$0		5/2/2000
09323	ELECTRICAL	County	\$7,750		5/25/2018
08367	ELECTRIC WIRING; GOLF COURSE; PAD PER PERMIT 1050 SHADOWMOSS CIR	County	\$0		9/11/2000
08852	580 SHADOWMOSS CIR: ELECTRICAL - COMMERCIAL [MAGNOLIA PLANTATION]	County	\$1,800		5/17/2018

Extra Features

Description	Year Built	Units	Value	New Cost
BLOCK WALL	02/01/2000	705	\$0	
6' CHAIN LINK FENCE	02/01/2000	600	\$0	
COMMERCIAL ASPHALT DR 2 IN	02/01/2000	79,020	\$0	
WALKS CONC COMM	02/01/2012	7,074	\$0	
COMMERCIAL CONCRETE DR 4 IN	02/01/2012	3,008	\$0	
WALKS CONC COMM	02/01/2000	21,744	\$0	
BLOCK WALL	02/01/2000	252	\$0	

Zoning

Zoning	Zoning Description	Future Land Use	Future Land Use Description
PD	Planned Development	PD	Planned Development

Utility Information

Fire Station	Power	Phone(Analog)	Water Provider	Sewer Provider	Garbage Pickup	Recycle	Yard Waste	Hauler
36.00	FPL	AT&T	SEMINOLE COUNTY UTILITIES	SEMINOLE COUNTY UTILITIES	NA	NA	NA	NA

Political Representation

Commissioner	US Congress	State House	State Senate	Voting Precinct
Dist 5 - Andria Herr	Dist 7 - Cory Mills	Dist 39 - DOUG BANKSON	Dist 10 - Jason Brodeur	30

School Information

Elementary School District	Middle School District	High School District
Heathrow	Markham Woods	Seminole

Copyright 2023 © Seminole County Property Appraiser