

The Historic Oviedo Colored School Museum is not documented as a Rosenwald school, but the design follows the general design of Plan No. 1-A, created in the 1920s by The Tuskegee Institute Division of Architecture.

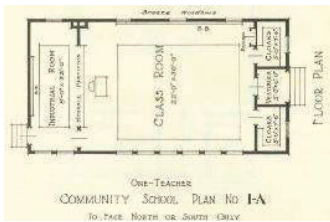

- 22' x 30' overall dimensions
- Main entry on one of the 22' wide walls
- Plan 1-A features tall proportioned windows on one long wall (as shown in the rendering) which roughly corresponds to the size of the three windows in the photograph
- Wood frame on piers with wood siding, similar roof pitch, exposed rafter tails and short wood steps.

For 2170 James Drive, there is a lack of project records, extensive unpermitted alterations, and no photographs except for one which may have been taken after completion but before any further alterations.



Due to these restrictions, restoration to a specific timeframe is not possible. We therefore propose to restore it in a "blended" manner to the period of the late 1940s.

The original structure will have restored wood lap siding, and wood windows and doors retrofitted into the current openings.

The masonry addition from the late 1940s will be clad with lap siding sympathetic to the original lap siding, and will also be fitted with wood windows and doors in the current openings.

Rafters will be inserted into the roof system to restore the exposed rafter pattern.





The existing roof is flashed to an eave board. This is proposed to remain.

The crawl space is required to be screened to meet building code requirements (FBC F101). As the original structure was never screened, a screen will be added

to the interior face of the existing masonry piers to preserve the full face of the piers. This will meet the code while providing a building closure sympathetic to the original structure.

The existing vinyl siding, added in the late 1990s, conceals the condition of the original lap siding. Once this is removed the condition will need to be evaluated. Further, it conceals the surface of the masonry addition, and once it is removed it will be possible to determine whether the original masonry had a different finish, or any finish at all.

What follows is a timeline to support the exterior restoration approach.

| Time period |  1920s Plan 1-A - "One Teacher School" |  1930s Gabriella Colored School photo |  1940 – 1950? Speculative rendering based on available information |  2024 Proposed restoration to 1940-1950 period |
|-------------|---|--|--|---|
| Structure | 22' x 30' wood frame structure | 22' x 30' wood frame structure | 22' x 48' wood frame with masonry addition, fireplace addition. Front door relocation possibly from this era. | 22' x 48' wood frame with masonry addition, fireplace addition. New outdoor deck will only minimally contact the existing structure. |
| Foundation | Open | Open with exposed piers | Open with exposed piers | Open with code-required screening behind piers sympathetic to the original design. |
| Exterior | Wood lap siding | Wood lap siding | Wood lap siding Masonry with unknown finish | Restore the wood lap siding At masonry, add lap siding over masonry sympathetic to the wood lap siding. |
| Windows | Double hung wood frame | Double hung wood frame | Double hung aluminum frame in the masonry addition Unknown – possibly awning-jalousie style aluminum frame in the original structure | Double hung wood frame sympathetic to the original wood windows. Use the window proportions that exist today. |
| Doors | Wood panel door | Wood panel door | Fiberglass door | Exterior grade wood panel door sympathetic to the original door. |
| Roof eave | Exposed rafters at 16" on center, exposed rafter tails | Exposed rafters at 16" on center; exposed rafter tails | Unknown | Exposed rafters at 16" on center with eave board. |
| Roof | Shingle | Diamond-pattern shingle | Unknown | Standing seam metal to remain |

| | | | | |
|--|----------------------------|------------------------------------|---|--|
| Heating, ventilating, and air conditioning | None (natural ventilation) | None recorded | Furnace and chimney added | Chimney will remain. A new mini-split HVAC system will be added. The exterior compressor will be wall-mounted on the north wall of the masonry addition (so as to be not visible when viewing the original structure from SR426). Interior cassettes will be mounted on the walls. Refrigerant piping on the exterior walls will be concealed with a PVC shroud. |
| Plumbing | none | None recorded | Two 1-fixture bathrooms in the masonry addition | Two 1-fixture bathrooms will remain. One will be upgraded to meet ADA requirements. |
| Electrical | None | None recorded | Appears to have been electrified when the masonry addition was built. | Will remain. Exterior devices will be removed from the original wood frame structure as much as practical. |
| Lighting | None | None recorded | Lighting appears to have been added with the masonry addition. | Replace exterior lights with new LED fixtures sympathetic to the proposed restoration period. Replace interior lighting with new LED fixtures of more contemporary design to mark the current restoration milestone. |
| Signage | Not specified | None found | None found | Street number as required by county ordinance will be on the masonry addition facing James Drive. |
| FF&E | Not specified | Wood benches appear to be original | Upholstered church pews | Wood benches will be restored and used as FFE for the interior. |

Richard T. Reep
 Architect