

NOTES:

- 1. Each party will be responsible for all portions of any roadway feature that begins within the limits of their responsibility.
- 2. Each party will be responsible for all ground-mounted signs within the limits of their responsibility, regardless of message, unless installed under separate permit or agreement.
- 3. Each party shall provide the other with 48-hour advance notification prior to performing any works only upon the other party's approval of the request, which approval must not be unreasonably withheld.
- 4. Seminole County shall maintain all portions of the signalization system, including SR 426 (Aloma Avenue), Red Bug Lake Road and SR 434.
- 5. All portions of the FTE ITS system located within L.A. R/W are to be maintained by FTE.
- 6. FTE will be responsible for the SR 417 bridge median piers, and all associated pier protection, including guardrail end treatments, protecting the piers within Red Bug Lake Road median.
- 7. All noise walls constructed within the FTE L.A. R/W limits will be maintained by FTE.
- 8. Sidewalks and associated pedestrian signals within SR 417/Red Bug Lake interchange will be maintained by Seminole County.

LIGHTING RESPONSIBILITIES:

- 1. All portions of the Cross Seminole Trail lighting system, including any bridge underdeck or wall mounted lighting, will be maintained by Seminole County.
- 2. Each party will be responsible for lighting associated with their roadways connected to load centers located within their R/W.
- 3. Underdeck lighting connected to SR 417 roadway lighting will be the responsibility of FTE.

REVISIONS				H.W. LOCHNER, INC. 4350 W. CYPRESS STREET - SUITE 800 TAMPA, FL 33607	STATE OF FLORIDA DEPARTMENT OF TRANSPORTATION			MAINTENANCE NOTES SEMINOLE COUNTY	SHEET NO.
DATE	DESCRIPTION	DATE	DESCRIPTION		ROAD NO.	COUNTY	FINANCIAL PROJECT ID		1
					417	SEMINOLE	417545-1-52-01		

1/2/2024 3:04:30 PM FREH
c:\pw_working\lochner-pw-01\00126746\PLAN\MM01.dgn

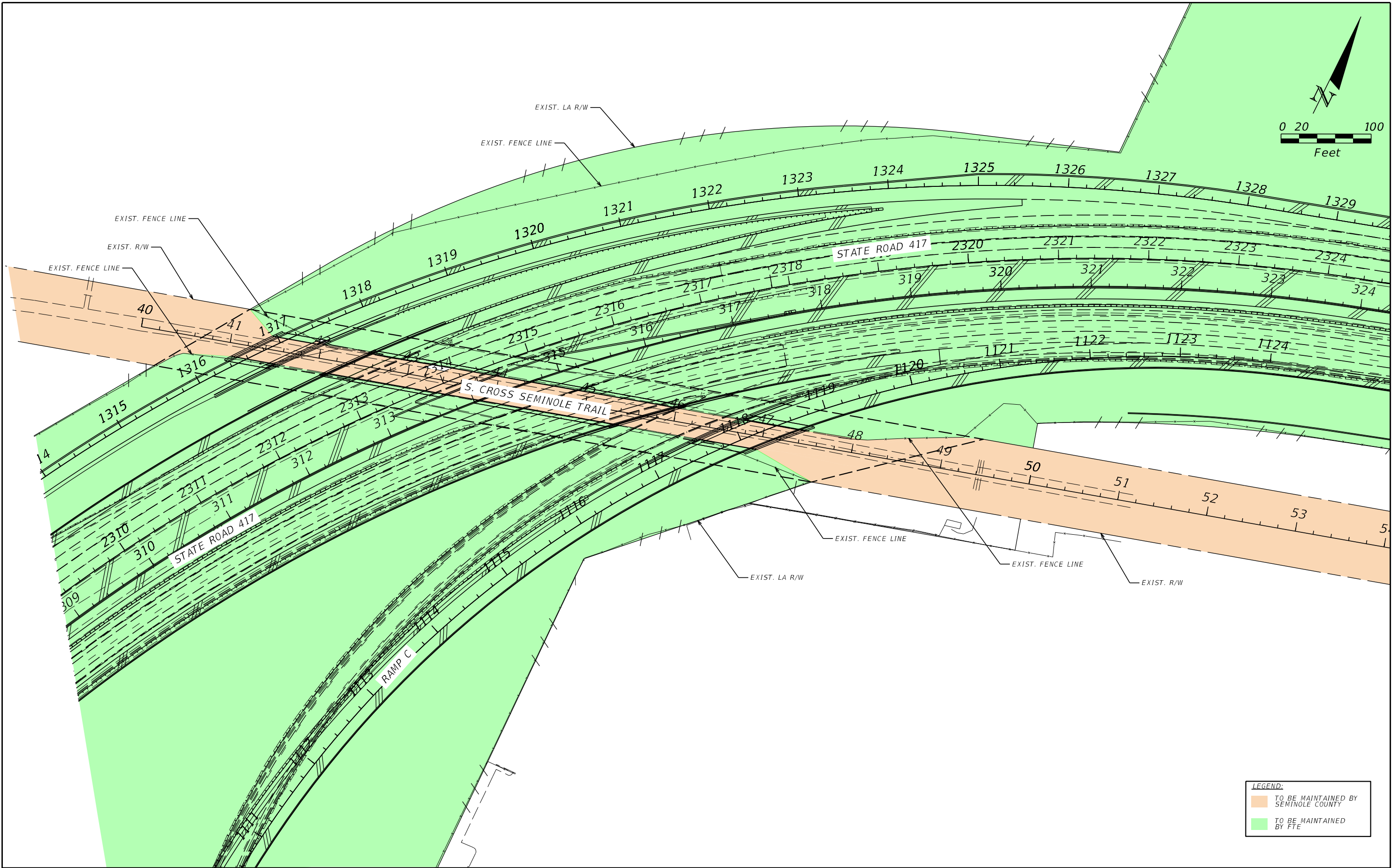

REVISIONS			
DATE	DESCRIPTION	DATE	DESCRIPTION

H.W. LOCHNER, INC.
4350 W. CYPRESS STREET - SUITE 800
TAMPA, FL 33607

STATE OF FLORIDA DEPARTMENT OF TRANSPORTATION		
ROAD NO.	COUNTY	FINANCIAL PROJECT ID
417	SEMINOLE	417545-1-52-01

S. CROSS SEMINOLE TRAIL &
SR 417 INTERCHANGE
SEMINOLE COUNTY
MAINTENANCE EXHIBIT

SHEET NO.
2

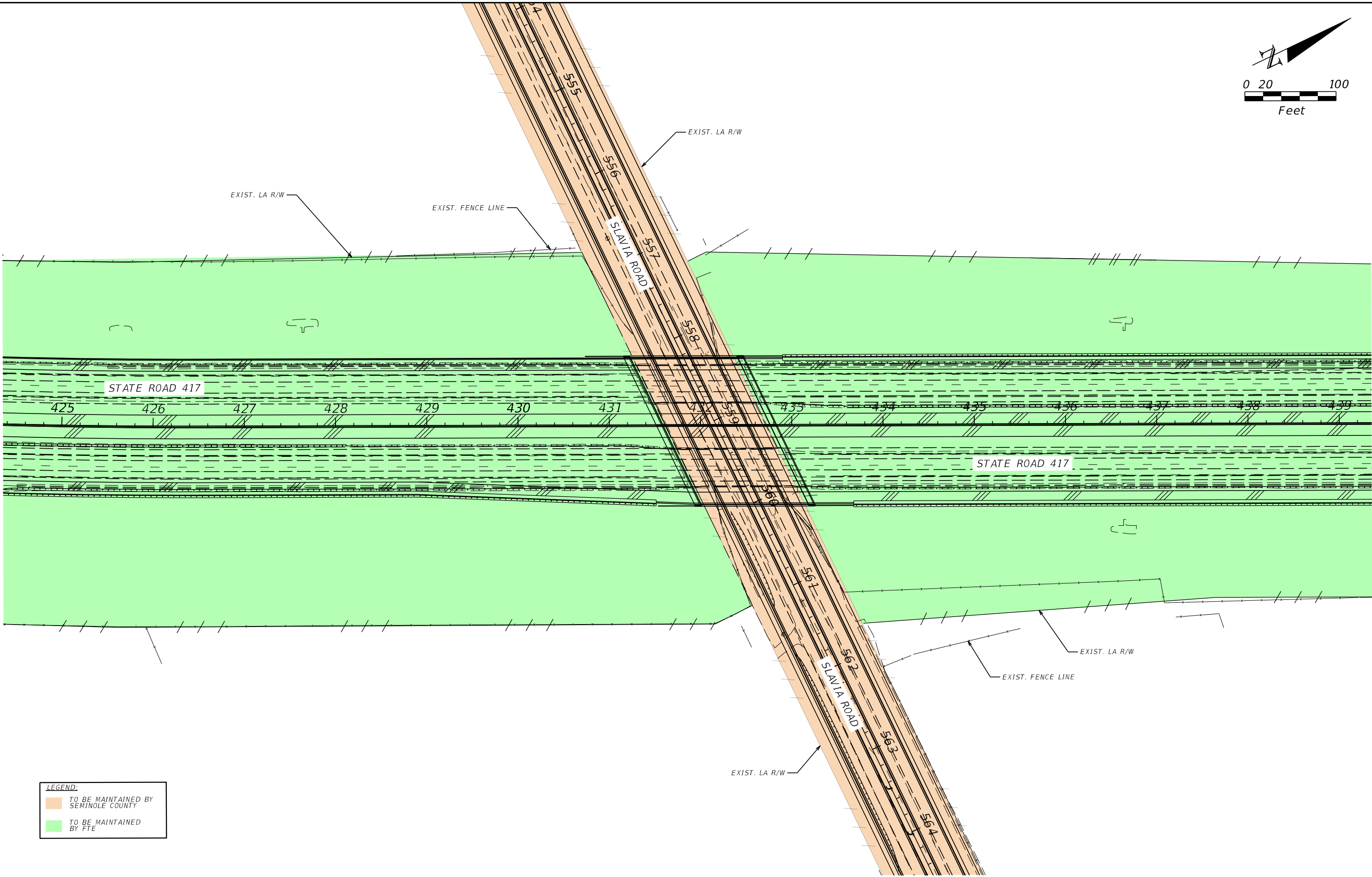
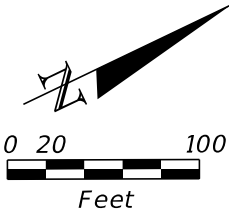

LEGEND:

	TO BE MAINTAINED BY SEMINOLE COUNTY
	TO BE MAINTAINED BY FTE

REVISIONS			
DATE	DESCRIPTION	DATE	DESCRIPTION

H.W. LOCHNER, INC.
4350 W. CYPRESS STREET - SUITE 800
TAMPA, FL 33607

STATE OF FLORIDA DEPARTMENT OF TRANSPORTATION		
ROAD NO.	COUNTY	FINANCIAL PROJECT ID
417	SEMINOLE	417545-1-52-01

SLAVIA ROAD &
SR 417 INTERCHANGE
SEMINOLE COUNTY
MAINTENANCE EXHIBIT

SHEET NO.
3

1/2/2024 3:04:31 PM FREH
c:\pw_working\lochner-pw-01\00126746\PLAN\MH01.dgn

1/2/2024 3:04:32 PM FREH
c:\pw_working\lochner-pw-01\00126746\PLAN\MM01.dgn

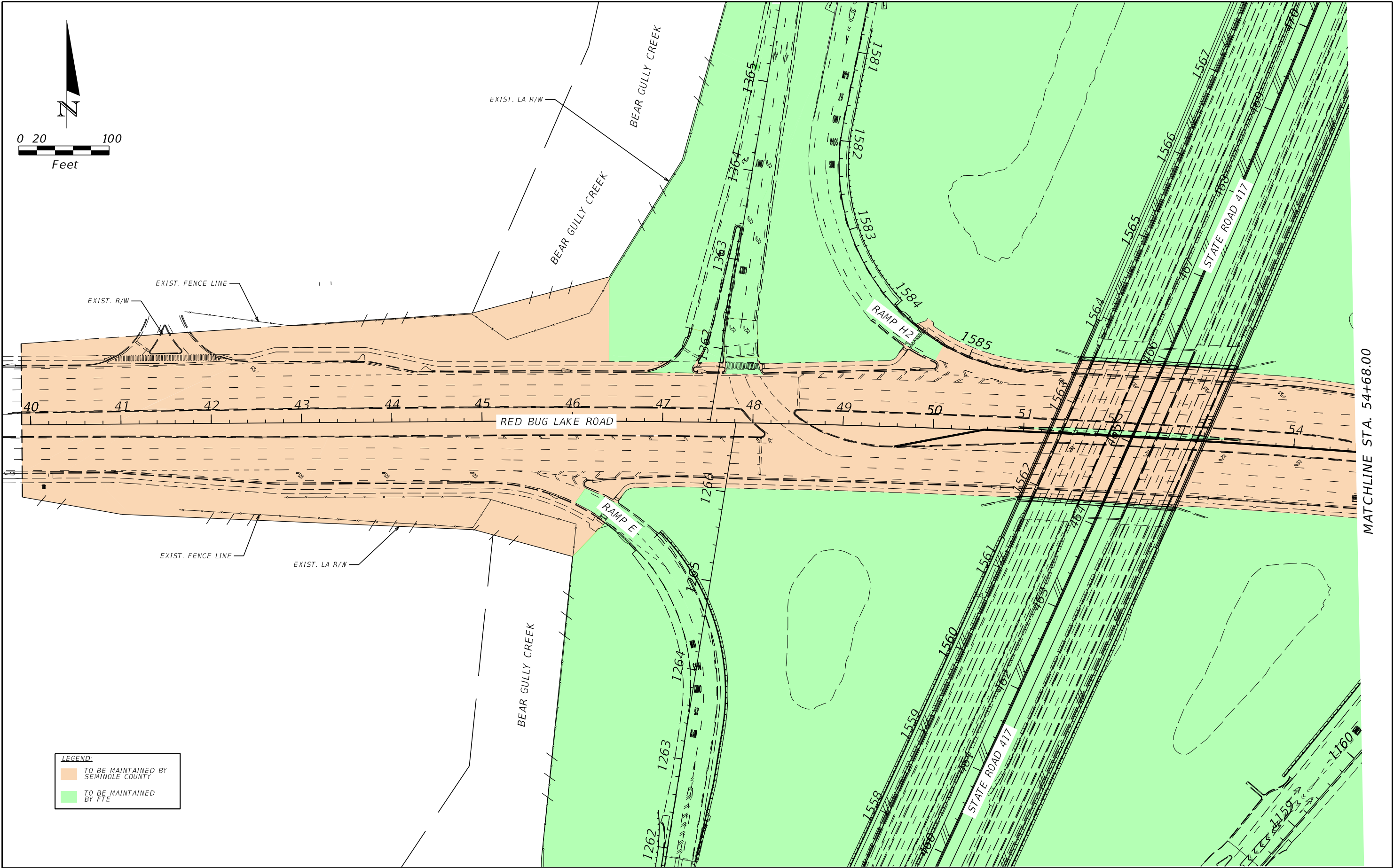

REVISIONS				H.W. LOCHNER, INC. 4350 W. CYPRESS STREET - SUITE 800 TAMPA, FL 33607	STATE OF FLORIDA DEPARTMENT OF TRANSPORTATION			RED BUG LAKE ROAD & SR 417 INTERCHANGE SEMINOLE COUNTY MAINTENANCE EXHIBIT	SHEET NO. 4
DATE	DESCRIPTION	DATE	DESCRIPTION		ROAD NO.	COUNTY	FINANCIAL PROJECT ID		
					417	SEMINOLE	417545-1-52-01		

1/2/2024 3:04:33 PM FREH
c:\pw_working\lochner-pw-01\00126746\PLAN\MM01.dgn

MATCHLINE STA. 54+68.00

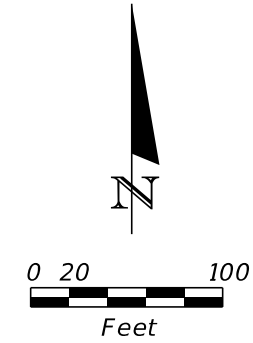
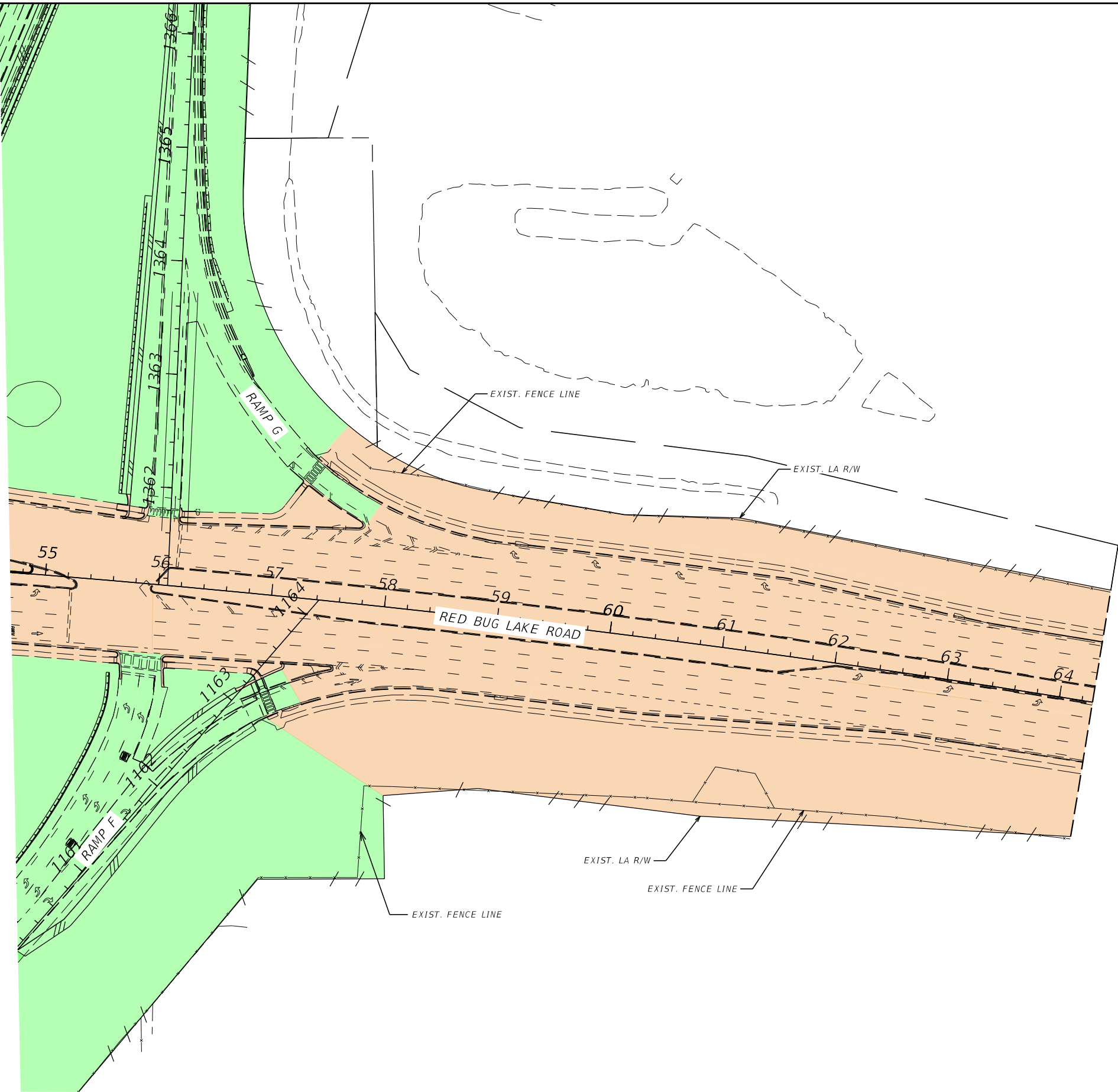

LEGEND:	
	TO BE MAINTAINED BY SEMINOLE COUNTY
	TO BE MAINTAINED BY FTE

REVISIONS				H.W. LOCHNER, INC. 4350 W. CYPRESS STREET - SUITE 800 TAMPA, FL 33607	STATE OF FLORIDA DEPARTMENT OF TRANSPORTATION			RED BUG LAKE ROAD & SR 417 INTERCHANGE SEMINOLE COUNTY MAINTENANCE EXHIBIT	SHEET NO.
DATE	DESCRIPTION	DATE	DESCRIPTION		ROAD NO.	COUNTY	FINANCIAL PROJECT ID		5
					417	SEMINOLE	417545-1-52-01		

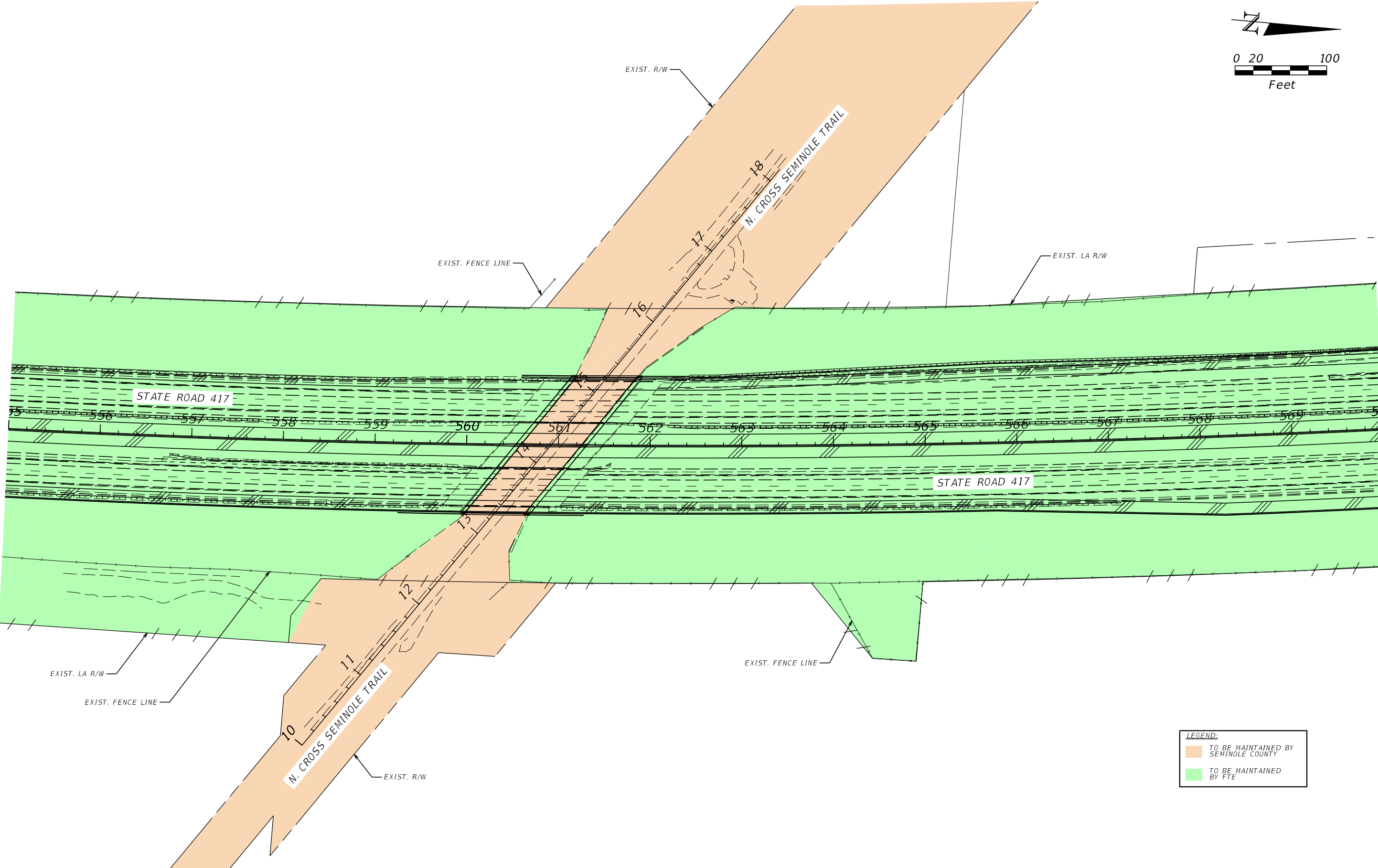
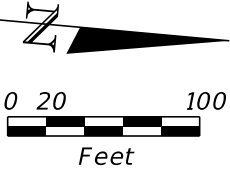

LEGEND:

TO BE MAINTAINED BY SEMINOLE COUNTY

TO BE MAINTAINED BY FTE

1/2/2024 3:04:35 PM FREH c:\pw_working\lochner-pw-01\00126746\PLAN\MM01.dgn

REVISIONS			
DATE	DESCRIPTION	DATE	DESCRIPTION

H.W. LOCHNER, INC.
4350 W. CYPRESS STREET - SUITE 800
TAMPA, FL 33607

STATE OF FLORIDA DEPARTMENT OF TRANSPORTATION		
ROAD NO.	COUNTY	FINANCIAL PROJECT ID
417	SEMINOLE	417545-1-52-01

N. CROSS SEMINOLE TRAIL &
SR 417 INTERCHANGE
SEMINOLE COUNTY
MAINTENANCE EXHIBIT

SHEET NO.
6