

THIS DOCUMENT, TOGETHER WITH THE CONCEPTS AND DESIGNS PRESENTED HEREIN, AS AN INSTRUMENT OF SERVICE, IS INTENDED ONLY FOR THE SPECIFIC PURPOSE AND CLIENT FOR WHICH IT WAS PREPARED. REUSE OF AND IMPROPER RELIANCE ON THIS DOCUMENT WITHOUT WRITTEN AUTHORIZATION AND ADAPTATION BY BOWMAN CONSULTING SHALL BE WITHOUT LIABILITY TO BOWMAN CONSULTING.

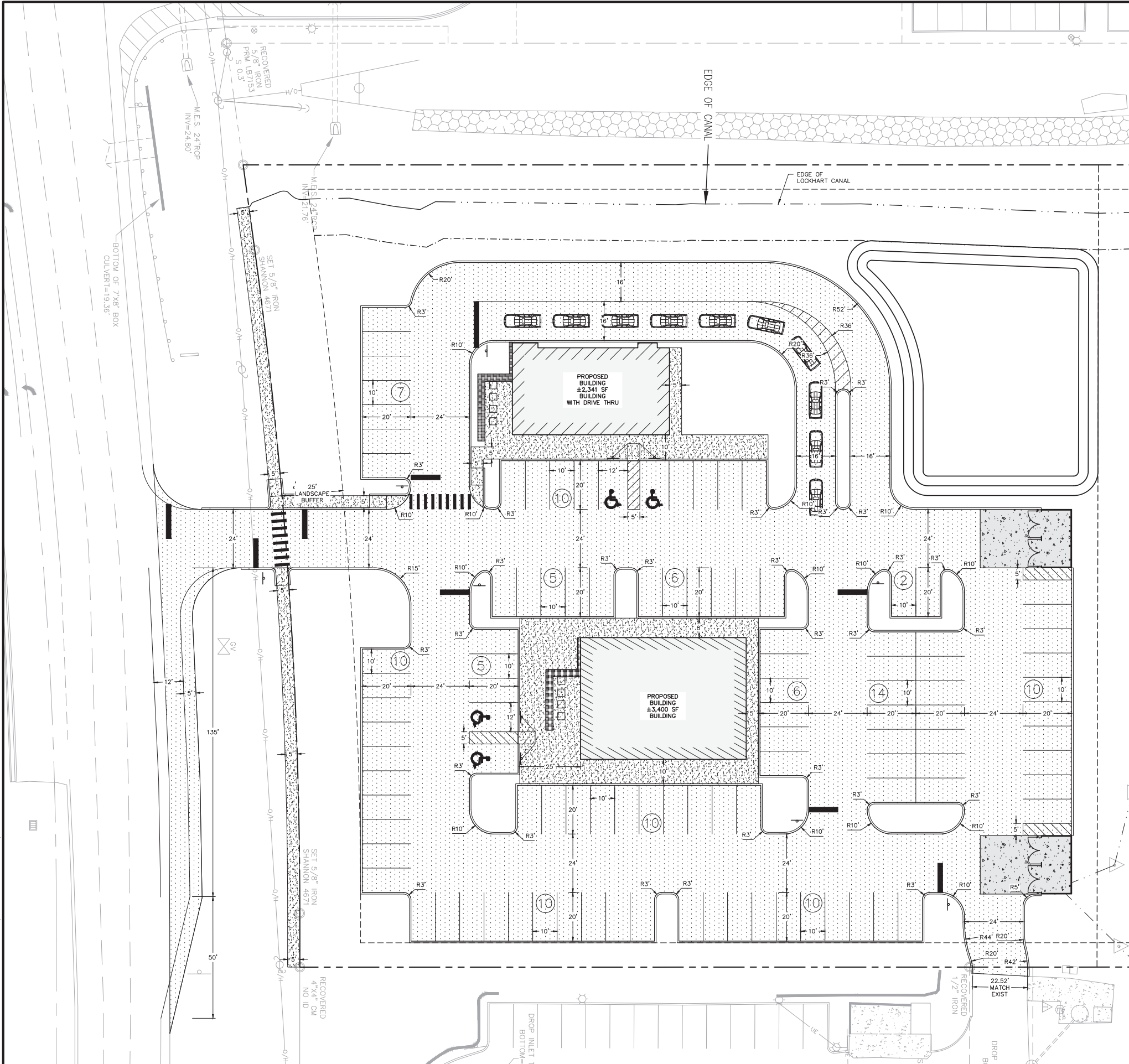

PROPOSED LEGEND

- PROPERTY LINE
- PROPOSED CURB
- STOP BAR
- SIGN
- PROPOSED PARKING SPACES
- ACCESSIBLE SPACES
- PARKING SPACE COUNT
- HEAVY DUTY CONCRETE PAVEMENT
- CONCRETE SIDEWALK
- STANDARD DUTY ASPHALT PAVEMENT

PROPOSED LEGEND

- PROPERTY LINE
- PROPOSED CURB
- STOP BAR
- SIGN
- PROPOSED PARKING SPACES
- ACCESSIBLE SPACES
- PARKING SPACE COUNT
- HEAVY DUTY CONCRETE PAVEMENT
- CONCRETE SIDEWALK
- STANDARD DUTY ASPHALT PAVEMENT

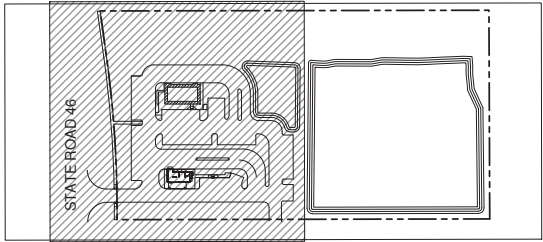

KEY MAP

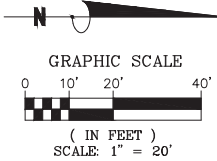

Andrew J. Petersen
This form has been digitally
signed & sealed by Andrew J.
Petersen, P.E. on the date
05/02/2024. The digital signature
is a cryptographic hash value
created by a computer program
using a unique key. It is not
possible to alter the document
without the signature being
invalid. For more information,
visit: www.call811sunshine.com
2024.05.02 08:42:42-0400

Bowman Consulting Group, Ltd.
4450 W. Eau Gallie Blvd
Suite 144
Melbourne, FL 32934
Phone: (321) 255-5494
Fax: (321) 255-7751
www.bowmanconsulting.com
© Bowman Consulting Group, Ltd.

SITE PLAN

SANFORD COMMERCIAL DEVELOPMENT - PD REZONE

NE C/O HICKMAN DRIVE AND S.R. 46

SANFORD, FL 32771

CITY OF SANFORD

SEMINOLE COUNTY

ANDREW J. PETERSEN
LICENSE NO. 75493
05/02/2024
PLAN STATUS

DATE	DESCRIPTION
ALW DESIGN	ELC DRAWN
SCALE	1" = 20'
JOB No.	011319-01-001
DATE	05/02/2024
011319-01-0-CP-001-07-C1.1-SITE.DWG	
SHEET	C1.1