

The presence of any wetlands and/or flood-prone areas is determined on a site-by-site basis. Boundary adjustments may be made based upon more definitive on-site information obtained during the development review process. Wetland information is based on SJRWMD's update of the National Wetland Inventory Maps, and 100-year flood-prone area information is based on Flood Insurance Rate Maps provided by FEMA.

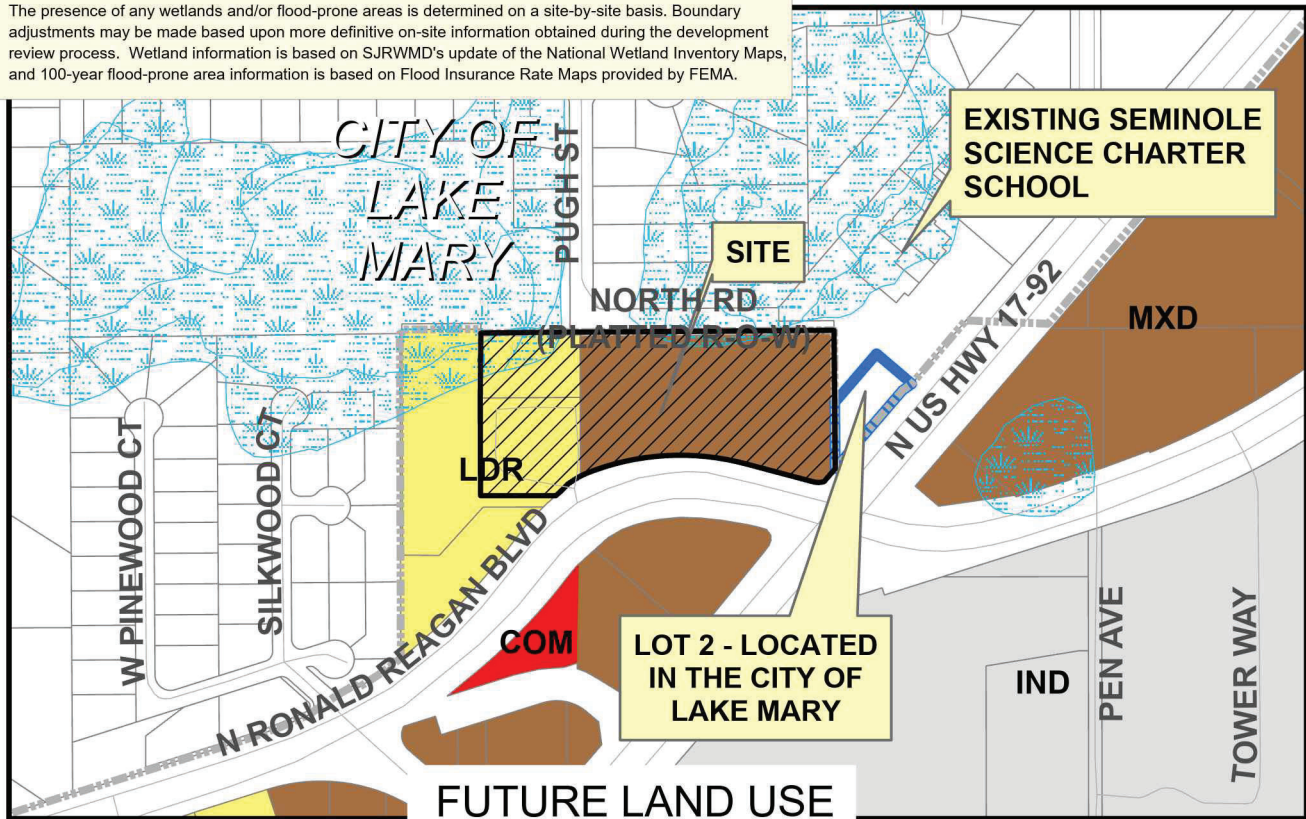

Site 
 CONS 
 Municipality 
 Lot 2 
 COM 
 IND 
 LDR 
 MXD

Applicant: Yalcin Akin, PhD  
 Physical STR: 22-20-30  
 Gross Acres: 7.8+/- BCC District: 4  
 Existing Use: vacant, single-family residential  
 Special Notes: Max. Net Density - 0.50 F.A.R.

	Amend/Rezone #	From	To
FLU	06.24SS.01	LDR/ MXD	PD
Zoning	Z2024-013	A-1/ C-2	PD

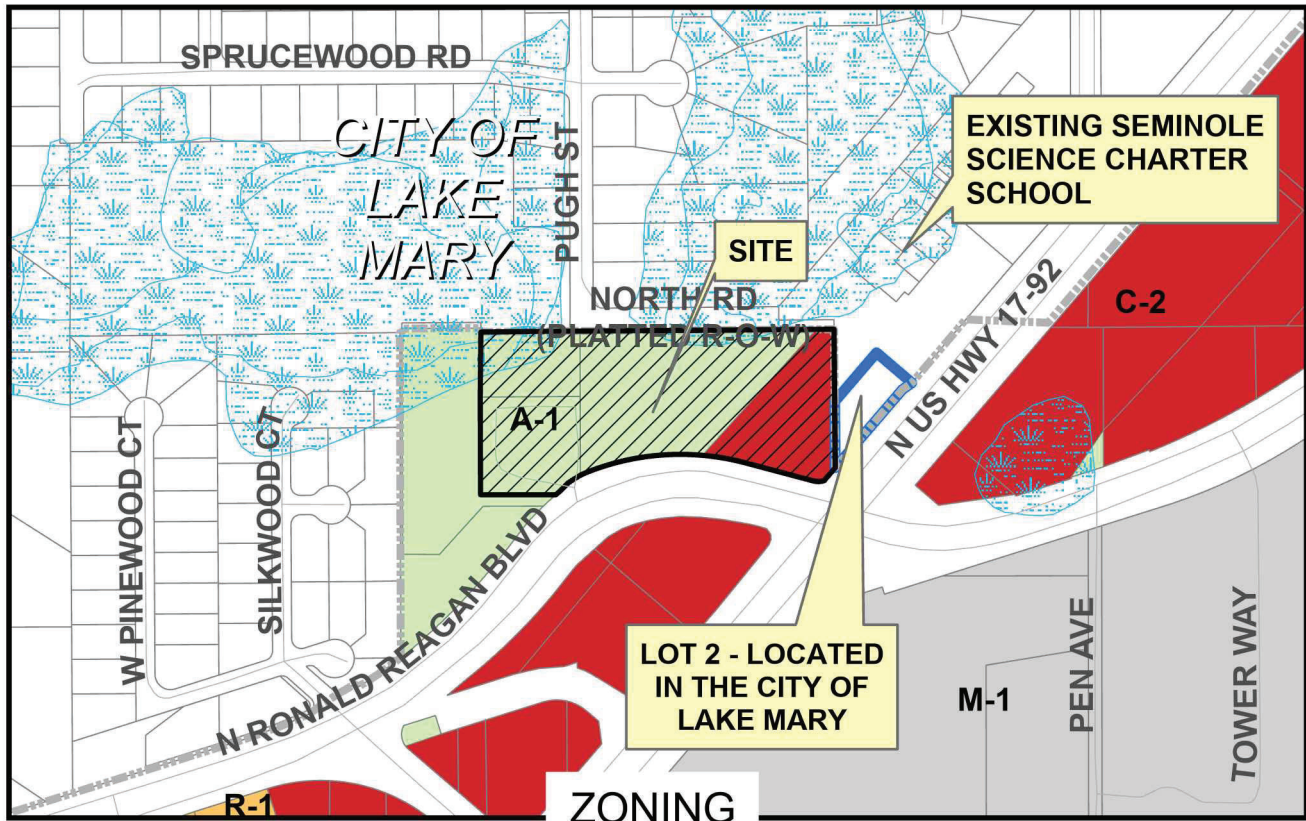

Date: 10/31/2024

Name Z2024-013

Site 
 CONS 
 Municipality 
 Lot 2 
 A-1 
 R-1 
 C-2 
 M-1