

**PURCHASE AGREEMENT
DRAINAGE EASEMENT**

STATE OF FLORIDA)
COUNTY OF SEMINOLE)

THIS AGREEMENT is made and entered into by and between RIVERSIDE RESERVE HOMEOWNERS ASSOCIATION, INC., whose address is 1000 Pine Hollow Point, Altamonte Springs, Florida 32714, in this Agreement referred to as “OWNER,” and SEMINOLE COUNTY, a charter county and political subdivision of the State of Florida, whose address is Seminole County Services Building, 1101 East 1st Street, Sanford, Florida 32771, in this Agreement referred to as “COUNTY.”

WITNESSETH:

WHEREAS, COUNTY requires the property described below for a drainage easement in Seminole County;

NOW, THEREFORE, for and in consideration of the mutual covenants and conditions contained in this Agreement, OWNER agrees to sell and COUNTY agrees to purchase a drainage easement on the following property upon the following terms and conditions:

I. LEGAL DESCRIPTION

See attached Exhibit A for legal description and sketch (the “Property”).

Parcel I. D. Number: 33-19-31-514-0C00-0000

II. CONVEYANCE AND PURCHASE PRICE

(a) OWNER shall sell and convey an easement on the Property for the above referenced project by Drainage Easement, free of liens and encumbrances, to COUNTY for the sum of ONE HUNDRED FORTY-TWO THOUSAND FIVE HUNDRED AND NO/100 DOLLARS (\$142,500.00). This amount includes all compensation due as a result of this acquisition to OWNER for any reason and for any account whatsoever, including all damages, compensation, attorney fees, expert fees, and other costs of any nature whatsoever, and for any other claim or account whatsoever that are due to OWNER as a result of this acquisition.

(b) COUNTY is responsible for the following closing costs: recording fee for Drainage Easement, title search fee, premium for the title insurance policy issued to COUNTY by a title insurance company of COUNTY’s choice and cost to prepare and all expenses to record instruments necessary to provide title unto COUNTY, free and clear of all liens and encumbrances.

(c) OWNER is responsible for OWNER's own attorney's fees and costs, if any, not included in Item II.(a) above and OWNER's share of the pro-rata property taxes outstanding, if any, up to and including the date of closing. COUNTY's closing agent will withhold these costs and pro-rata real estate taxes for which OWNER is responsible, if any, from the proceeds of this sale and pay them to the proper authority on behalf of OWNER.

(d) OWNER covenants that there are no real estate commissions due any licensed real estate broker for this conveyance. OWNER shall defend COUNTY against any claims for such commissions and pay any valid claims made by any such broker.

(e) OWNER and COUNTY stipulate this purchase is being made under the threat of condemnation and therefore the conveyance and Drainage Easement described in Item II.(a) above is not subject to documentary stamps taxes pursuant to Rules 12B-4.014(13) and 12B-4.013(4), Florida Administrative Code (2024).

III. CONDITIONS

(a) COUNTY shall pay to OWNER the sum as described in Item II.(a), above, upon the proper execution and delivery of all the instruments required to complete the above purchase and sale to the designated closing agent. COUNTY shall determine a closing date within a reasonable time after all pre-closing conditions under this Agreement have been completed. OWNER agrees to close within seven (7) days of notice by COUNTY or COUNTY's closing agent that a closing is ready to occur.



(b) Subject to Item III(c) below, OWNER shall vacate and surrender possession of the Property upon the date of delivery of the instruments and closing of this Agreement.

(c) Any and all encroachments existing upon the Property, other than those improvements included in the purchase price, must be removed by OWNER at the expense of OWNER prior to closing.

(d) OWNER warrants that there are no facts known to OWNER materially affecting the value of the Property that are not readily observable by COUNTY or that have not been disclosed to COUNTY.

(e) The instrument of conveyance to be utilized at closing must include the covenant of further assurances, in addition to containing all other common law covenants through the use of a drainage easement.

(f) If OWNER owns the Property to be conveyed in any representative capacity, OWNER shall fully comply with the disclosure and other requirements of Section 286.23, Florida Statutes (2024), as this statute provides on the effective date of this Agreement and to the extent this statute is applicable.

(g) Upon forty-eight (48) hours' notice to OWNER, COUNTY has the right, prior to closing: (1) to perform any and all environmental studies and tests to determine the existence of environmental or hazardous contamination on the Property, in its soil or in the underlying water table or (2) to enter upon the Property with COUNTY's employees, contractors and other personnel to inspect and conduct testing upon the Property. If COUNTY determines, either through these studies, testing or other means that the Property contains any hazardous waste or materials or environmental contamination, or has been used as a hazardous waste or chemical storage facility or dumpsite or as a garbage dump or landfill site, COUNTY may elect to cancel this Agreement and have all sums paid under it by COUNTY to OWNER, if any, returned to COUNTY.

(h) In the event that COUNTY subsequently abandons this project after execution of this Agreement, but before closing, this Agreement will be null and void.

(i) In the event that difficulties arise as to clearing title sufficient to complete a closing of this Purchase Agreement or difficulties occur in the issuance of a title insurance commitment that is acceptable to COUNTY, this Agreement will survive the filing of any eminent domain action by COUNTY and will serve as a joint stipulation regarding all issues of valuation, attorney fees (except for apportionment proceedings, if any), costs and expert fees in any condemnation proceeding initiated by COUNTY relating to the Property. In accordance with any request made by COUNTY, OWNER shall execute any and all instruments, pleadings, documents, and agreements upon litigation reflecting the full settlement as set forth in this Agreement. OWNER shall not oppose COUNTY's condemnation proceedings in any way. OWNER, however, may assert OWNER's rights against other claimants in apportionment proceedings.



(j) OWNER shall indemnify and save COUNTY harmless from and against all liability, claims for damages, and suits for any injury to any person or persons, or damages to any property of any kind whatsoever arising out of or in any way connected to OWNER's representations or performance under this Agreement or in any act or omission by OWNER in any manner related to this Agreement.

(k) COUNTY is solely responsible for all of COUNTY's activities conducted on the Property. OWNER is not to be considered an agent or employee of COUNTY for any reason whatsoever on account of this Agreement.

(l) OWNER states that OWNER has not engaged in any action that would create a conflict of interest in the performance of OWNER's obligations under this Agreement with COUNTY that would violate or cause others to violate the provisions of Part III, Chapter 112, Florida Statutes (2024), as this statute may be amended from time to time, relating to ethics in government.

(m) OWNER is responsible for ensuring this Agreement is properly approved according to OWNER's corporate structure as provided in OWNER's governing documents and Chapter 720, Florida Statutes (2024).

(n) This Agreement contains the entire agreement between OWNER and COUNTY and all other representations, negotiations, and agreements, written and oral, with respect to the

subject matter of this Agreement are superseded by this Agreement and are of no force and effect. This Agreement may be amended and modified only by an instrument in writing executed by all parties to this Agreement.

(o) This Agreement is not assignable.

(p) This Agreement will be construed by and controlled under the laws of the State of Florida. The sole venue for any legal action in connection with this Agreement is the Eighteenth Judicial Circuit Court in Seminole County.

(q) With respect to the Property and all areas immediately adjacent to the Property on the Property, COUNTY shall construct its improvements in substantial conformity with the Construction Plans for the Midway Drainage Improvement Project, a copy of which is attached to and incorporated in this Agreement by reference as Exhibit "B" (the "Plans"). If COUNTY changes the use of the Property to be in non-conformity with the Plans or if COUNTY otherwise does not substantially comply with the Plans, then OWNER will have the same remedies as would have been afforded to OWNER had the case been resolved by verdict with the Plans having been made a part of the record at trial. *Central & Southern Florida Flood Control District v. Wye River Farms, Inc.*, 297 So.2d 323 (Fla. 4th DCA 1974); cert. denied 310 So.2d 745 (Fla. 1975) (when plans and specification for construction of a public project are in evidence, the condemnor is bound by them and the issues as to damages are framed by them).

(r) The effective date of this Agreement will be the date when the last party has properly executed this Agreement as determined by the date set forth immediately below the respective signatures of the parties.

IN WITNESS WHEREOF, the parties have made and executed this Agreement for the purposes stated above.

WITNESSES:

John B. King
Signature
John B. King
Print Name
David Brown
Signature
David Brown
Print Name

RIVERSIDE RESERVE HOMEOWNERS
ASSOCIATION, INC.

By: Mariel Johnson
MARIEL JOHNSON
Its: President

11/7/24
Date

Road Project: Midway Drainage Improvement Project - Parcel 841
Parcel Address: Common Area
Owner Name: Riverside Reserve Homeowners Association, Inc.

BOARD OF COUNTY COMMISSIONERS
SEMINOLE COUNTY, FLORIDA

ATTEST:

GRANT MALOY
Clerk to the Board of
County Commissioners of
Seminole County, Florida.

By: _____
JAY ZEMBOWER, Chairman

Date: _____

For the use and reliance of
Seminole County only.

As authorized for execution by the Board of
County Commissioners at its _____,
20____, regular meeting.

Approved as to form and
legal sufficiency.

County Attorney

Attachment:
Exhibit A – Legal Description and Sketch
Exhibit B – Construction Plans



EXHIBIT "A"

Legal Description

That portion of Tract C of the Plat of Riverside Reserve as recorded in Plat Book 85, Pages 18-22 of the public Records of Seminole County, Florida all lying or being in Section 33, Township 19 South, Range 31 East, Florida further described as follows:

Beginning at the southwest corner of Tract C of the Plat of Riverside Reserve as recorded in Plat Book 85, Pages 18-22 of the Public Records of Seminole County, Florida, thence along the west line of said Tract C, $N00^{\circ}34'22''W.$, a distance of 25.00 feet; thence $N.89^{\circ}24'52''E$ to the west line of Tract E of said plat a distance of 9.98 feet; thence along said west line $S.00^{\circ}34'22''E.$, a distance of 15.08 feet to the north line of Tract C; thence along the north line of Tract C and its prolongation $N.89^{\circ}53'45''E.$, a distance of 1293.10 feet to the east line of said Tract C also being the west right of way of North Beardall Avenue; thence $S.00^{\circ}40'10''E.$, a distance of 10.00 feet to the southeast corner of said Tract C; thence along the prolongation of the south line of Tract C $N.89^{\circ}53'45''E.$, a distance of 10.00 feet to the west maintained line of N. Beardall Avenue as recorded in map book 6 pages 188-190 of the public records of Seminole County, Florida; thence along said maintained line, $S.00^{\circ}21'17''E.$, a distance of 5.91 feet to the north right of way line of Lincoln Street per the Plat of the Town of Canaan as recorded in Plat book 1 page 103; thence along the said right of way line, $S.89^{\circ}53'45''W.$, a distance of 1295.11 to the prolongation of the east right of way line of Deepwater Avenue per the aforementioned Plat of the Town of Canaan; thence along said line $N.00^{\circ}06'23''W.$, a distance of 3.60 feet to the aforementioned south line of Tract C; thence along said south line, $S.89^{\circ}53'45''W.$, a distance of 17.94 feet to the Point of Beginning.

Said parcel contains 19,334.74 square feet more or less.

The parcel may be subject to easements, covenants, or restrictions of record if any.

SKETCH OF DESCRIPTION

Scale 1" = 50'

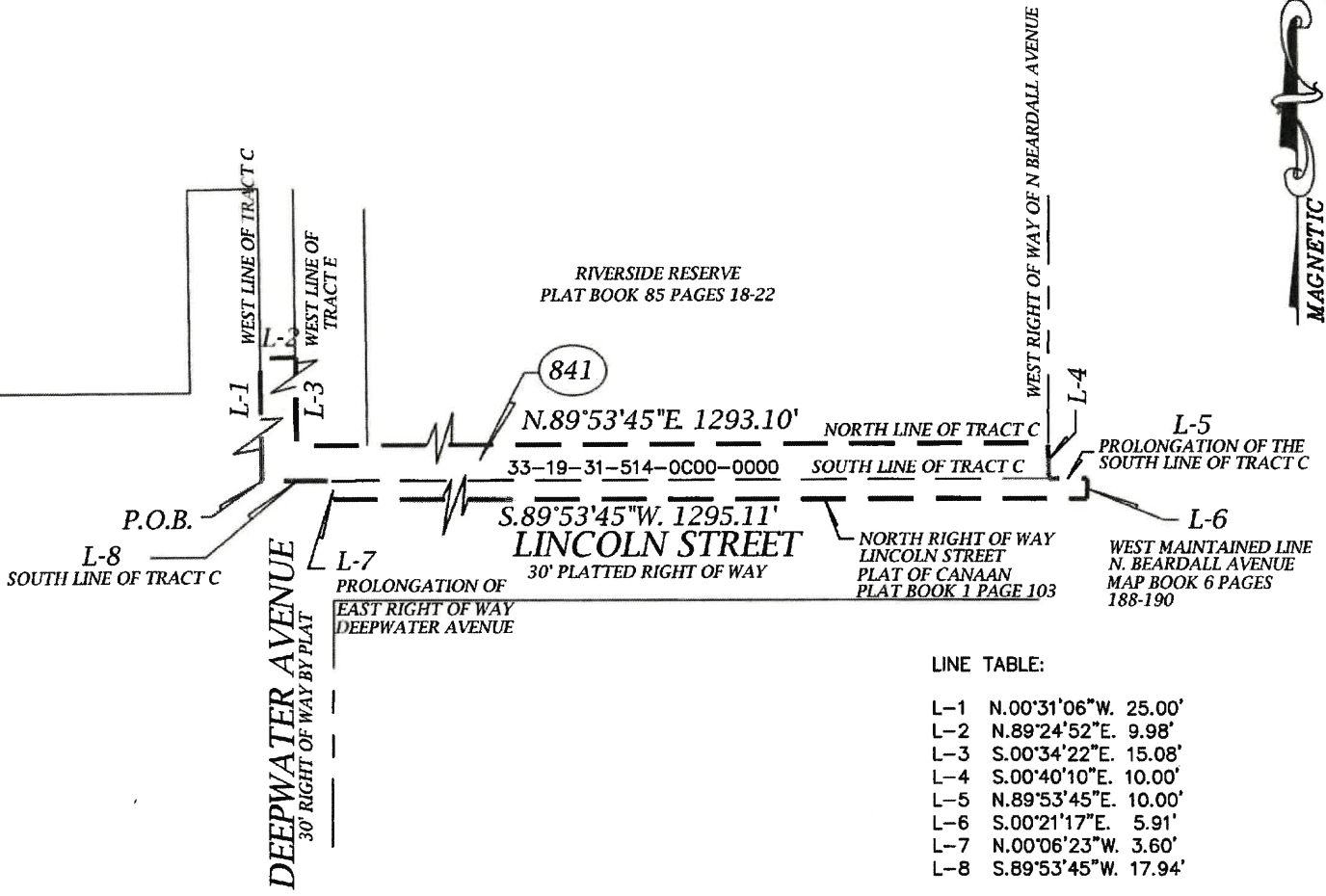

LINE TABLE:

L-1	N.00°31'06\"W. 25.00'
L-2	N.89°24'52\"E. 9.98'
L-3	S.00°34'22\"E. 15.08'
L-4	S.00°40'10\"E. 10.00'
L-5	N.89°53'45\"E. 10.00'
L-6	S.00°21'17\"E. 5.91'
L-7	N.00°06'23\"W. 3.60'
L-8	S.89°53'45\"W. 17.94'

LEGEND:

M.O.=MONUMENTED AND OCCUPIED
 ORB=OFFICIAL RECORDS BOOK
 P.O.B.=POINT OF BEGINNING
 P.O.C.=POINT OF COMMENCEMENT

T:\Survey\R Phillips\Midway Drainage\basebp2.dwg

SEMINOLE COUNTY

SURVEY SECTION OF ROADS-STORMWATER DIVISION
 PUBLIC WORKS DEPARTMENT
 149 BUSH LOOP BLVD. SANFORD, FLORIDA 32773
 407-665-5647

SURVEYOR'S NOTES

1. BEARINGS BASED ON THE NORTH RIGHT OF WAY LINE OF CELERY AVENUE WHICH IS ASSUMED TO BEAR S.89°35'37\"W.
 2. THIS IS NOT A SURVEY
 3. UNDERGROUND UTILITIES AND OR IMPROVEMENTS ARE NOT LOCATED.
- SURVEYOR HAS NOT ABSTRACTED THE LAND SHOWN HEREON, THE ABOVE REFERENCED PROPERTY MAY BE SUBJECT TO EASEMENTS AND RESRICTIONS OF RECORD IF ANY.

SHEET 2 OF 2

NOT VALID WITHOUT THE ORIGINAL SIGNATURE AND SEAL OF A FLORIDA LICENSED SURVEYOR AND MAPPER.

BY: 
 STATE OF FLORIDA
 RAYMOND F. PHILLIPS P.S.M. FL. LICENSE NUMBER 10701

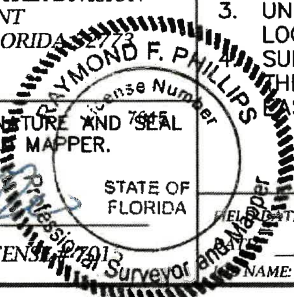

DATE: n/a
 04/20/2023
 NAME: MIDWAY DRAINAGE

SCALE: 1"=50'
 DRAWN BY: RFP
 CHECKED BY: RP

COMPONENTS OF CONTRACT PLANS SET
Roadway Plans
 A DETAILED INDEX APPEARS ON THE
 KEY SHEET OF EACH COMPONENT

Sheet Number	Sheet Title
1	KEY SHEET
2	SIGNATURE SHEET
3 - 4	SUMMARY OF PART ITEMS
5 - 10	SUMMARY OF QUANTITIES
11 - 16	SURFACE PLAN, DRAINAGE DATA
17 - 18	TYPICAL SECTIONS
19 - 22	SPECIAL DETAILS
23	SUMMARY OF DRAINAGE STRUCTURES
24 - 27	PROJECT LAYOUT
28	PROJECT CONTROL
29 - 30	GENERAL NOTES
31	PLAN & PROFILE
32 - 53	CONTROL POINT TABLES
54 - 56	DRAINAGE STRUCTURE SECTIONS
57 - 66	POND DETAIL SHEETS
67 - 72	DRAINAGE DETAILS
73 - 76	POND CROSS SECTIONS
77 - 87	DITCH CROSS SECTIONS
88 - 101	STORMWATER POLLUTION PREVENTION PLAN
102 - 104	EROSION CONTROL PLAN
105 - 130	TEMPORARY TRAFFIC CONTROL
131 - 138	UTILITY ADJUSTMENTS
139 - 161	SIGNING & PAVEMENT MARKINGS
162 - 171	ROADWAY SOIL SURVEY
172	REPORT OF AUGER BORINGS FOR PONDS
173 - 175	REPORT OF CORE BORINGS
176 - 179	DATA TABLES OF BOX CULVERT
ST-01	REINFORCING BAR LIST
ST-02 - ST-04	FAA AIRSPACE EXHIBIT
F-1 - F-2	RIGHT OF WAY MAP
1-14*	

*THESE SHEETS ARE INCLUDED IN THE ROADWAY PLANS ONLY TO INDICATE THAT THEY ARE PART OF THE ROADWAY PLANS THESE SHEETS ARE CONTAINED IN A SEPARATE DIGITALLY SIGNED AND SEALED DOCUMENT.

GOVERNING STANDARD PLANS
 Florida Department of Transportation, FY2023-24 Standard Plans for Road and Bridge Construction and associated Interim Revisions (Irs).
 Standard Plans for Road Construction and associated Irs are available at <https://www.dot.gov/design/standardplans.shtm>
 APPLICABLE IRS: IR536-00-01, IR321-001-01
 Standard Plans for Bridge Construction are included in the Structures Plans Component.
GOVERNING STANDARD SPECIFICATIONS:
 Florida Department of Transportation, FY 2023-24 Standard Specifications for Road and Bridge Construction at the following website:
<https://www.dot.gov/programmanagement/implemented/Specifications>

BOARD OF COUNTY COMMISSIONERS
 BOB DALLARI DISTRICT 1
 JAY ZEMBOWER DISTRICT 2
 LEE CONSTANTINE DISTRICT 3
 AMY LOCKHART DISTRICT 4 CHAIRMAN
 ANDRIA HERR DISTRICT 5 VICE-CHAIR
 DARRIN GRAY, COUNTY MANAGER

Exhibit "B"
SEMINOLE COUNTY
ENGINEERING DIVISION



CONTRACT PLANS

MIDWAY BASIN DRAINAGE IMPROVEMENTS
SEMINOLE COUNTY CIP No. 01907077
BID PACKAGE 2

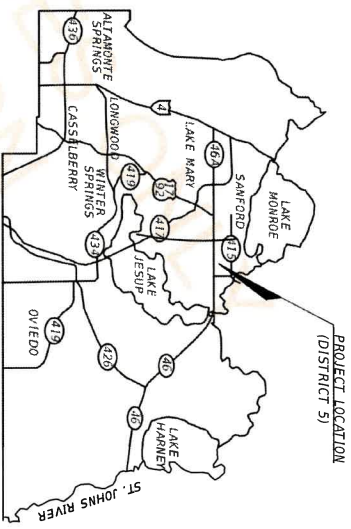
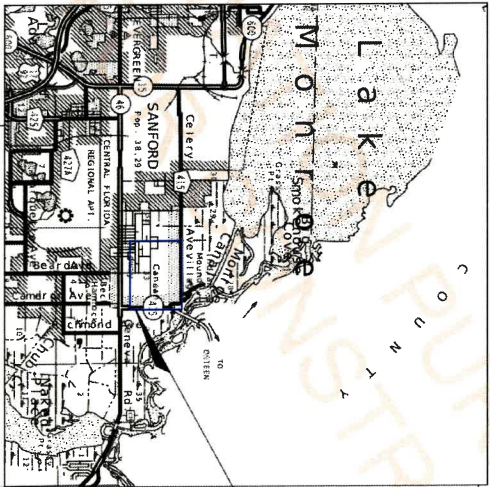

90% S SUBMITTAL
AUGUST 2025

PUBLIC WORKS DIRECTOR: JEAN JREIL, P.E.

ROADWAY PLANS
ENGINEER OF RECORD: CHRISTOPHER L. THOMPSON, PE
P.E. NO.: 62505
COUNTY PROJECT MANAGER: JEFF SLOMAN, PE

PLANS PREPARED BY:
ATKINS
 100 SOUTH KEELER ROAD
 ORLANDO, FLORIDA 32809
 (407) 653-7275

NOTE: THE SCALE OF THESE PLANS MAY
 HAVE CHANGED DUE TO REPRODUCTION

FISCAL YEAR	SHEET NO.
23	1

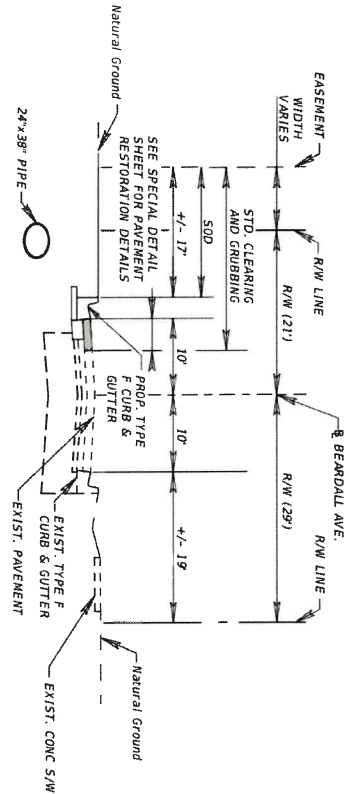

TYPICAL SECTION (1)
BEARDALL AVE.
STA. 408+78.90 TO STA. 413+27.60

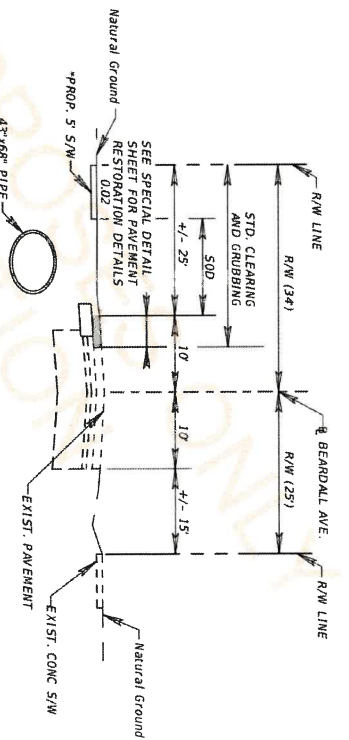

TYPICAL SECTION (2)
BEARDALL AVE.
STA. 419+50.00 TO STA. 426+05.70
*TO REPLACE S/W AT LOCATIONS IMPACTED BY PIPE CONSTRUCTION

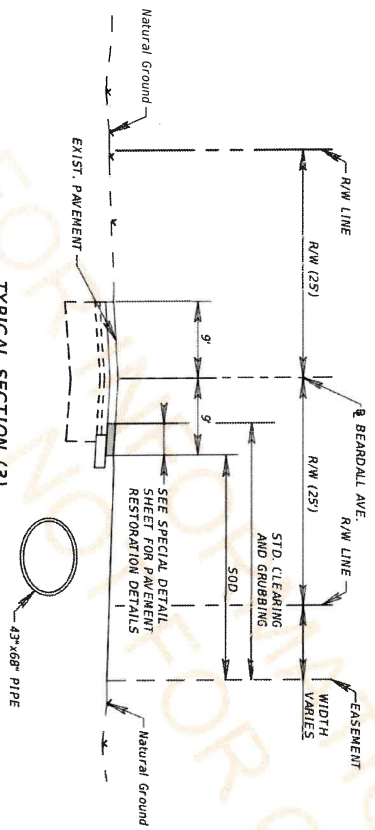

TYPICAL SECTION (3)
BEARDALL AVE.
STA. 438+69.80 TO STA. 442+61.70
STA. 446+08.00 TO STA. 452+81.40

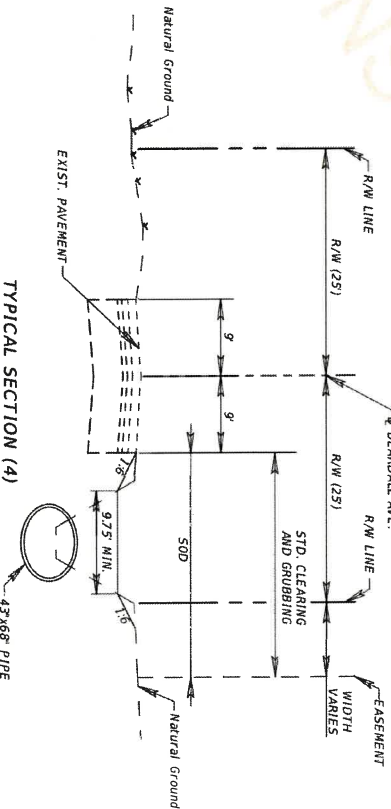

TYPICAL SECTION (4)
BEARDALL AVE.
STA. 442+61.70 TO STA. 446+08.00

NOTE:
SEE SPECIAL DETAILS FOR PAVEMENT RESTORATION AREAS NOT SHOWN IN THE TYPICAL SECTIONS.

DATE	DESCRIPTION	REVISIONS	DATE	DESCRIPTION

PROFESSIONAL OF RECORD: ANGEL M. RIVERA-LOPEZ, P.E. # 74275 482 SOUTH KELLER ROAD ORLANDO, FL 32810 CERTIFICATION OF AUTHORIZATION NO. 24 29/08/2023	SEMINOLE COUNTY ENGINEERING DIVISION ROAD MIDWAY BASIN DRAINAGE IMPROVEMENTS COUNTY CIP NO. 01907077	SHEET NO. 19
---	--	--------------

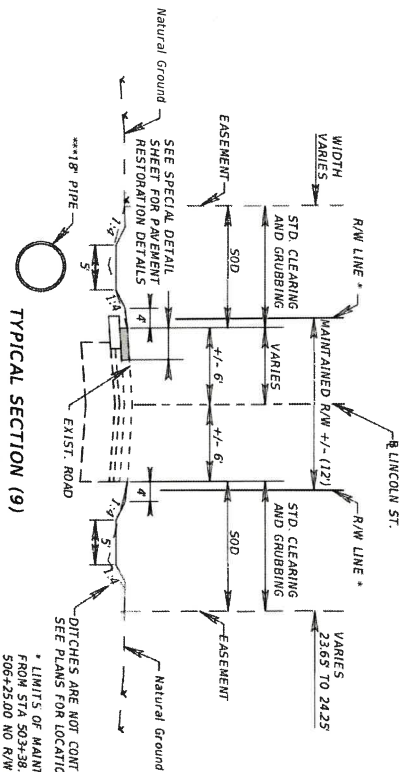

TYPICAL SECTION (9)
 LINCOLN ST.
 STA. 503+60.00 TO STA. 506+45.00 (DIRT)
 **STA. 506+45.00 TO STA. 513+40.00 (PAVEMENT)

* LIMITS OF MAINTAINED RW VAR. FROM STA. 503+60.00 TO STA. 506+45.00 PER PLAN, DEED OR MAP.
 ** PAVEMENT RESTORATION STARTS AT 506+66.00.
 *** PIPE LOCATION VARIES D/T/V/T

DITCHES ARE NOT CONTINUOUS
 SEE PLANS FOR LOCATIONS

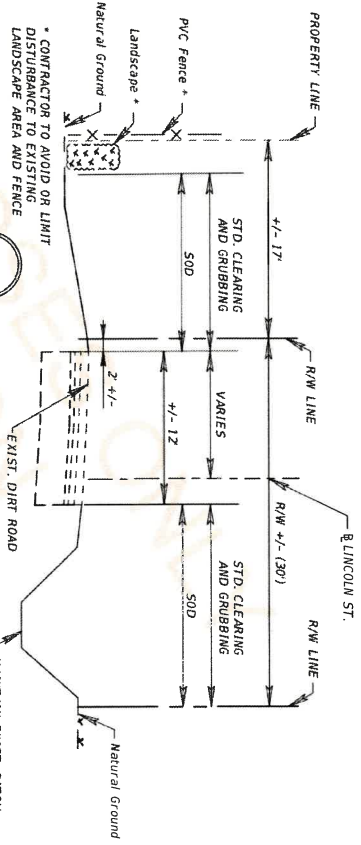

TYPICAL SECTION (10)
 LINCOLN ST.
 STA. 513+40.00 TO STA. 526+75.00

NOTE
 1. MOW AND REMOVE EXCESS VEGETATION AND SEDIMENT AND ANY TRASH AND DEBRIS FROM DITCH. AW ROOT SYSTEMS SHALL BE CUT FLUSH WITH THE DITCH. NO GRUBBING SHALL OCCUR. SOD BARE AREAS OF DITCH ONLY.

* CONTRACTOR TO AVOID OR LIMIT DISTURBANCE TO EXISTING LANDSCAPE AREA AND FENCE

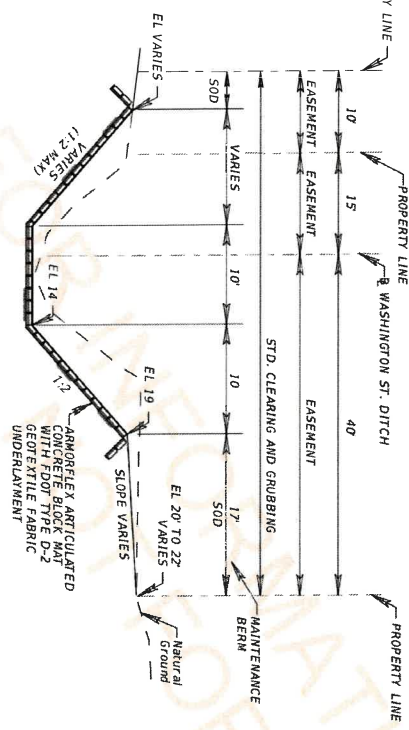

TYPICAL SECTION (11)
 WASHINGTON STREET DITCH
 STA. 600+20.00 TO STA. 614+82.00

- NOTES:
1. ARTICULATED CONCRETE BLOCK MAT (ACBM) SHALL BE ARMORFLEX CLASS 45M CLOSED CELL MAT (OR APPROVED EQUIVALENT)
 2. ACBM SHALL MEET FOOT SPECIFICATION SECTION 530
 3. FILTER FABRIC SHALL MEET FOOT SPECIFICATION SECTION 514
 4. FINISHED GRADES SHOWN IN THE PLANS REFER TO THE TOP OF ACBM BLOCK
 5. BLOCK SHALL BE EMBEDDED AT TOP OF BANK.
 6. ALL MAT TO MAT CONNECTION JOINTS SHALL BE FILLED WITH 4,000 PSI CONCRETE OR GROUT PER MANUFACTURER DETAILS
 7. OPEN SPACE BETWEEN BLOCKS SHALL BE FILLED WITH CLEAN AND WASHED NO. 57 STONE. SEE DRAINAGE DETAILS
 8. SLOPES OF 1.5:1 REQUIRE PLATYPUS ANCHORS FOR EARTH STABILIZATION AND SPECIAL GEOTEXTILE UNDERLAYMENT. SEE DRAINAGE DETAILS
 9. CONTRACTOR SHALL COORDINATE WITH CONTECH (OR OTHER APPROVED MANUFACTURER) FOR FINAL PLAN LAYOUT OF PROPOSED ACBM SYSTEM, INSTALLATION DETAILS, AND OTHER PERTINENT INFORMATION.
 10. MANUFACTURER CONTACT INFORMATION:
 Peter W. Gallo
 Area Manager Armoxflex - South
 Market Engineering Solutions LLC
 peter.gallo@marketingsolutions.com

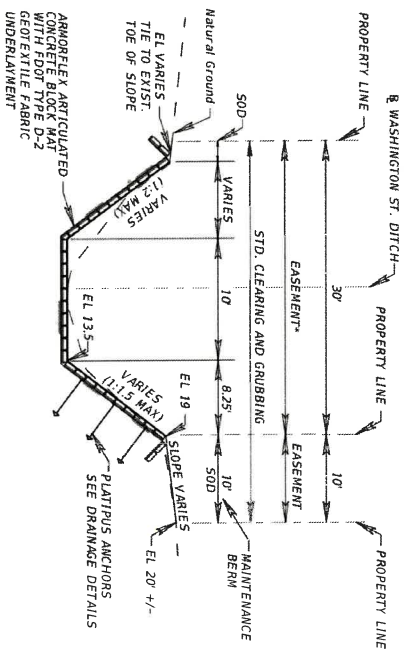

TYPICAL SECTION (12)
 WASHINGTON STREET DITCH
 STA. 615+64.00 TO STA. 619+64.00
 (SEE DRAINAGE DETAILS FOR ADDITIONAL INFORMATION)

DATE	DESCRIPTION	REVISIONS	DATE	DESCRIPTION

PROFESSIONAL OF RECORD:	ANGEL M. RIVERA-LOPEZ, P.E. # 74275
	482 SOUTH KELLER ROAD
	ORLANDO, FL 32810
CERTIFICATION OF AUTHORIZATION NO. 24	2970872023

SEMINOLE COUNTY	ENGINEERING DIVISION
ROAD	COUNTY CIP NO.
MIDWAY BASIN DRAINAGE IMPROVEMENTS	01907077

SHEET NO.	21
-----------	----

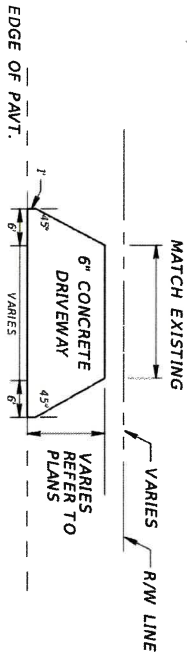

DETAIL (1)
TYPICAL CONCRETE DRIVEWAY

- DRIVEWAY NOTES:
1. THE CONTRACTOR SHALL SAW CUT AND REMOVE ANY EXISTING DRIVEWAY WITHIN THE PROJECT LIMITS. THE NEW CONCRETE DRIVEWAY DRIVEWAYS SHALL BE DONE TO FOLLOW THIS DETAIL ARE TO BE REPLACED BACK TO ORIGINAL GEOMETRY. THE CONTRACTOR SHALL SOD ANY AREA NOT COVERED BY CONCRETE.
 2. USE TURNOUT CONSTRUCTION WITH 3/4" TYPE SP 12.5 ASPHALTIC CONCRETE TYPE C.

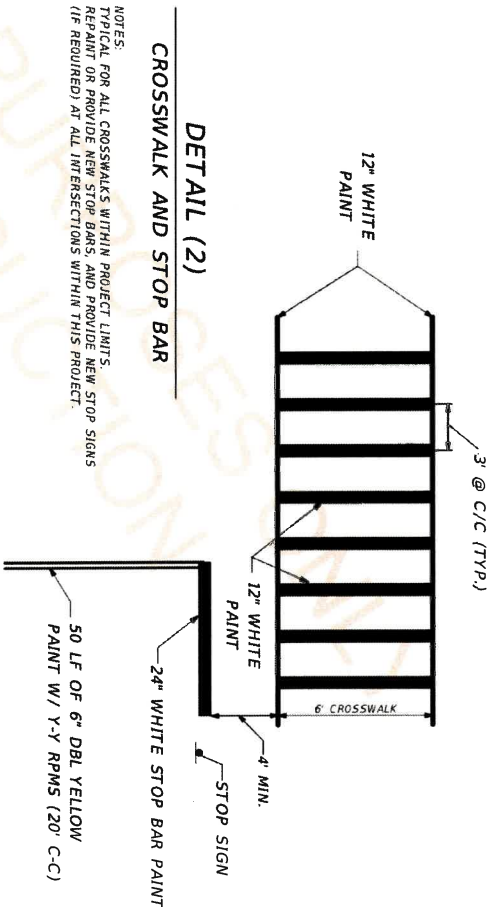

DETAIL (2)
CROSSWALK AND STOP BAR

- NOTES:
- TYPICAL FOR ALL CROSSWALKS WITHIN PROJECT LIMITS.
 - REPAIR OR PROVIDE NEW STOP BARS, AND PROVIDE NEW STOP SIGNS (IF REQUIRED) AT ALL INTERSECTIONS WITHIN THIS PROJECT.

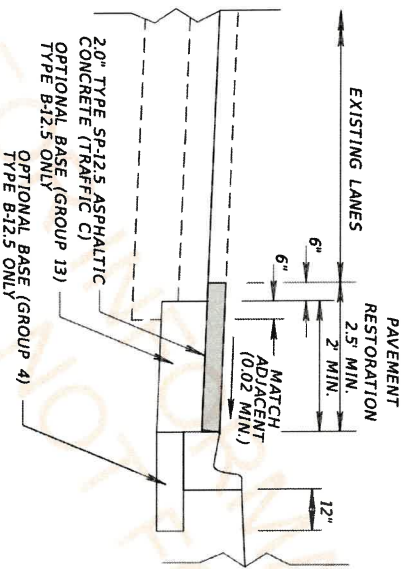

DETAIL (3)
PAVEMENT RESTORATION
WITH CURB & GUTTER

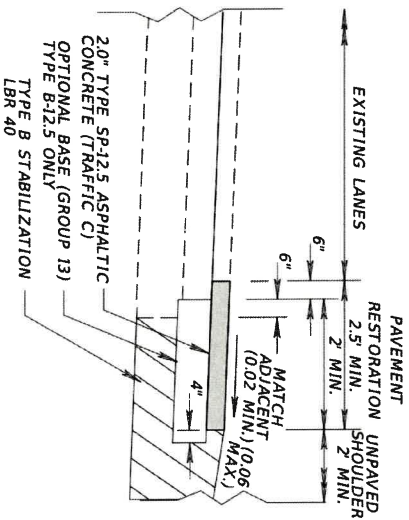

DETAIL (4)
PAVEMENT RESTORATION
WITHOUT CURB & GUTTER

DATE	DESCRIPTION	REVISIONS	DATE	DESCRIPTION

PROFESSIONAL OF RECORD:	SEMINOLE COUNTY	SHEET NO.	23
ATLAS ENGINEERING, P.C., P.E. # 74275	ENGINEERING DIVISION		
482 SOUTH KELLER ROAD	COUNTY CIP NO.		
ORLANDO, FL 32810	01907077		
CERTIFICATION OF AUTHORIZATION NO. 24			
18/08/2023			

GENERAL NOTES

- GRADES SHOWN ARE FINISHED GRADES.
- B.M. DATUM IS NORTH AMERICAN VERTICAL DATUM OF 1988. (NAVD88)
- EXISTING DAMAGE TO STRUCTURES WITHIN CONSTRUCTION LIMITS SHALL REMAIN UNLESS OTHERWISE NOTED.
- IT IS THE RESPONSIBILITY OF THE CONTRACTOR TO COMPLY WITH THE CURRENT STATE OF FLORIDA UNDERGROUND FACILITY DAMAGE PREVENTION AND SAFETY ACT AND/OR RELATED STATE LAW. THE FOLLOWING INFORMATION IS BEING PROVIDED BY SEMINOLE COUNTY IN AN EFFORT TO ASSIST THE CONTRACTOR BY LISTING UTILITIES THAT MAY PROVIDE SERVICE IN THE APPROXIMATE AREA OF PROPOSED CONSTRUCTION. THE CONTRACTOR SHOULD ASSUME OTHER UTILITIES THAT ARE NOT LISTED MAY PROVIDE SERVICE IN THE APPROXIMATE AREA OF PROPOSED CONSTRUCTION. UTILILITY OWNERS:

FLORIDA POWER & LIGHT ELECT. CO. 308-1911 BLENK CHRISTOPHER BLOOMANN (386) 254-2260 MEIER WISE	CITY OF SANFORD UTILITIES DEPARTMENT CARL FIBER, TELEPHONE (407) 562-2956 DEBORAH COLE, PE
MIDWAY CANAAN COMMUNITY WATER ASSOCIATION, INC. (904) 323-1714 COLINA BLAKE TECO PEOPLES G&S (407) 420-6663 SHAWN WINSON	AT&T DISTRIBUTION TELEPHONE (386) 386-4588 KIRBY SPENCER JEFF DAVIS MCI TELEPHONE (407) 830-3650 DINA DOMINGUEZ NATIONAL FIBER SECURITY DEPT.
- ALL SURVEY CORNERS INDICATED ON THE PLANS SHALL BE REFERENCED AND CERTIFIED BY A REGISTERED PROFESSIONAL SURVEYOR PRIOR TO COMMENCEMENT OF CONSTRUCTION. ALL CORNERS DESTROYED OR OBTAINED BY THE CONTRACTOR SHALL BE RE-established AND ALL CORNERS DESTROYED OR OBTAINED BY THE CONTRACTOR SHALL BE RE-established. CERTIFIED SKETCHES SHALL BE SUBMITTED TO SEMINOLE COUNTY ROADS-STORMWATER DIVISION, SURVEY SECTION
 RAYMOND PHILLIPS, PSM
 COUNTY SURVEYOR
 (407) 665-5647
 RPHILLIPS@SEMINOLECOUNTYFL.GOV
- FOLLOW THE DETAILS IN THIS PLAN SET WHEN CURB RAMP DESIGN DEVIATES FROM THE FOOT CURB RAMP TYPE CALLED OUT.
- ANY PUBLIC LAND CORNER WITHIN THE LIMITS OF CONSTRUCTION IS TO BE PROTECTED. IF A CORNER MOVEMENT IS IN DANGER OF BEING DESTROYED AND HAS NOT BEEN PROPERLY REFERENCED, THE CONTRACTOR SHOULD NOTIFY THE COUNTY LOCATION SURVEYOR WITHOUT DELAY BY TELEPHONE.
- ALL MATERIALS, CONSTRUCTION, INSPECTIONS AND TESTS SHALL AS A MINIMUM CONFORM TO 2007 STANDARD SPECIFICATIONS, AND SUPPLEMENTED THEREIN, AND TO SPECIAL PROVISIONS FOR THIS PROJECT.
- ALL SHOP DRAWINGS MUST BE APPROVED BY THE ENGINEER OF RECORD (EOR) PRIOR TO FABRICATION.
- PERMANENT TURNOUTS AND DRIVEWAY CONNECTIONS TO PRIVATE PROPERTY SHALL BE CONSTRUCTED IN ACCORDANCE WITH THE STANDARD SPECIFICATIONS. TURNOUT DETAILS AND STATE STANDARD SPECIFICATIONS REFERENCED ON THE KEY SHEET OF THESE PLANS, THE COUNTY OR THE COUNTY'S CONTRACTOR SHALL NOT ISOLATE ADJACENT AND/OR REMAINDER PROPERTY UNLESS ACCESS RIGHTS ARE ACQUIRED. ACCESS SHALL BE PROVIDED TO SUCH PROPERTY WHENEVER CONSTRUCTION INTERFERES WITH THE EXISTING MEANS OF ACCESS.
- ALL SURVEY INFORMATION WAS OBTAINED FROM A LICENSED FLORIDA PROFESSIONAL SURVEYOR AND WAS USED IN THE DESIGN OF THESE PLANS. THE PRODUCTION OF DESIGN PLANS AND FOR CONSTRUCTION OF SUBJECT PROJECT. THE PROFESSIONAL SURVEYOR AND MAPPER OF RECORD IS:
 SHERYL LEE MAJOR, P.S.M.
 FLORIDA PROFESSIONAL SURVEYOR AND MAPPER NO. 6961
 489 STATE ROAD 436, SUITE 117
 CASSELBERRY, FL 32707
 (407) 830-8936
 BUSINESS LICENSE NUMBER: LB7829

- ALL PRIVATE AND PUBLIC PROPERTY AFFECTED BY THE CONSTRUCTION WORK SHALL BE RESTORED TO A CONDITION EQUAL TO OR BETTER THAN THE EXISTING PRE-CONSTRUCTION CONDITION, UNLESS SPECIFICALLY EXEMPTED BY THE PLANS. COST TO BE INCIDENTAL TO OTHER CONSTRUCTION AND NO EXTRA COMPENSATION TO BE ALLOWED.
- CONSTRUCTION SHALL INCLUDE REPLACING WITH MATCHING MATERIALS ALL DRIVEWAYS, WALKS, CURBS, ETC. THAT ARE DAMAGED OR REMOVED DUE TO CONSTRUCTION AND WORK SHALL BE COORDINATED WITH PROPERTY OWNERS.
- ANY DAMAGE PROBLEMS, CREATED BY CONSTRUCTION OR EXISTING BEFORE CONSTRUCTION THAT ARE NOT ALLEVIATED SHOULD BE BROUGHT TO THE ATTENTION OF THE SEMINOLE COUNTY ENGINEERING DIVISION PROJECT MANAGER.
- ANY GASED AREA OUTSIDE THE IMMEDIATE CONSTRUCTION AREA DISTURBED BY THE CONTRACTOR WILL BE SOODED AT THE CONTRACTOR'S EXPENSE.
- ONE WEEK PRIOR TO CONSTRUCTION THE CONTRACTOR IS TO OBTAIN A RAIN UTILIZATION PERMIT FROM SEMINOLE COUNTY PUBLIC WORKS, ENGINEERING DIVISION, 100 E. 1ST STREET, SANFORD, FL 32771, TELEPHONE: 407-885-5674. PERMIT FEE WILL BE WAIVED.
- IRRIGATION LINES DAMAGED DURING CONSTRUCTION ARE TO BE CAPPED IMMEDIATELY AND REPORTED TO THE SEMINOLE COUNTY ENGINEERING INSPECTOR. DAMAGED IRRIGATION COMPONENTS TO BE RE-CONSTRUCTED IN ACCORDANCE WITH EXERCISE PRIOR TO COMPLETION OF THE PROJECT.
- NO VIBRATION OR CONSTRUCTION SHALL BE USED ON THE PROJECT, INCLUDING ON EARTHWORK, OR RECONSTRUCTION OUTSIDE THE ROADWAY SURFACE WORK LIMITS.
- CONSTRUCT CONCRETE SIDEWALKS WITH A CROSS SLOPE OF 2% ON FLATTER. THE MINIMUM GRADE SHALL NOT EXCEED 1:20 (5%), AND CURB RAMP SHALL NOT EXCEED 1:12 (8.33%).
- A MINIMUM OF TWO FEET ON BOTH SIDES OF THE SIDEWALK SHALL BE RESODED AND ALL DISTURBED AREAS WILL BE RESODED TO MATCH THE EXISTING TYPE OF 500, UNLESS OTHERWISE NOTED IN THE PLANS.
- UNLESS OTHERWISE NOTED, ALL PIPE SHALL BE RCP CLASS III. SPORE PIPE SHALL BE DUCTILE IRON PIPE WITH A MINIMUM OF 12" DIA. ALL OTHER PIPE SHALL BE DUCTILE IRON PIPE, FOLLOWING REVIEW AND APPROVAL BY THE COUNTY.
- CAUTION: OVERHEAD AND UNDERGROUND UTILITIES, INCLUDING GAS MAIN, IN AREAS OF CONSTRUCTION.
- PIPE LENGTHS SHOWN ON PLANS ARE MEASURED FROM CENTER TO CENTER.
- ANY MAILBOX CONFLICTING WITH THE CONSTRUCTION OF THE PROJECT IS TO BE REMOVED BY THE CONTRACTOR IN ACCORDANCE WITH FOOT STD. PLANS INDEX NO. 110-200. NEW LOCATIONS TO BE COORDINATED WITH LOCAL POST OFFICE. REPLACEMENTS OF MAILBOXES SHALL HAVE MINIMUM 3" HIGH NUMBERS REPLICATED ON BOTH SIDES OF THE MAILBOX. PER SEMINOLE COUNTY ORDINANCE 90.5 (6) PER US95 DO 41.24, IF THE BOX IS ON A DIFFERENT STREET FROM THE CUSTOMERS RESIDENCE, THE STREET NAME AND HOUSE NUMBER SHALL BE INSCRIBED.
- THE CONTRACTOR SHALL GIVE THE POSTMASTER OF THE DELIVERY ROUTE 14 WRITTEN NOTICE OF PROJECT CONSTRUCTION 14 DAYS TO THE BEGINNING OF WORK, WITH SATURDAYS, SUNDAYS, AND HOLIDAYS EXCLUDED.

CURB RAMP NOTES

- MAINTAIN A MINIMUM LONGITUDINAL GRADE OF 0.3% IN AREAS OF RECONSTRUCTED CURBING. EXISTING DRAINAGE PATTERNS TO BE MAINTAINED. COORDINATE WITH SEMINOLE COUNTY ENGINEERING INSPECTOR IF EXISTING CONDITIONS DO NOT ALLOW EXISTING PATTERNS TO BE MAINTAINED.
- ALL CONCRETE SIDEWALK AND CURB RAMP SHALL MEET ADA REQUIREMENTS. DETECTABLE WARNING SHALL BE PLACED ON ALL LOCATIONS WHERE PROPOSED RAMP OR SIDEWALK MEETS THE SIDE STREET PER FOOT STANDARD PLAN INDEX 522-002.

EROSION CONTROL NOTES

- IT IS THE RESPONSIBILITY OF THE CONTRACTOR TO CHECK ALL CONCRETE FORMS PRIOR TO CONCRETE BEING Poured AND CONFIRM THAT THE FINISHED SIDEWALK AND/OR CURB RAMP MEET ADA REQUIREMENTS AS INTENDED. FAILURE TO DO SO MAY RESULT IN THE REMOVAL AND REPLACEMENT OF THE CONCRETE AT THE CONTRACTOR'S EXPENSE.
- CONTRACTOR SHALL NOTIFY SEMINOLE COUNTY ENGINEERING INSPECTOR PRIOR TO PLACEMENT OF ANY CONCRETE.
- PROVIDE EROSION AND SEDIMENTATION CONTROL MEASURES CONSISTING OF STAKED SILT FENCES AND ADDITIONAL MEASURES AS NECESSARY, UTILIZING INDUSTRY STANDARD BEST MANAGEMENT PRACTICES AND FOLLOWING REQUIREMENTS BELOW, TO AVOID ADVERSE IMPACTS TO JURISDICTIONAL AREAS (WETLANDS, WATER BODIES, AND UPLAND BUFFERS) AND OFF-SITE LANDS AND WATER BODIES. MAINTAIN THESE MEASURES DAILY UNTIL CONSTRUCTION ACCEPTABLE BY SEMINOLE COUNTY AND THEN REMOVE AND LEGALLY DISPOSE OF SAID MEASURES.
- NO DISCHARGE OF CONTAMINANTS INTO ADJACENT WETLANDS, WATER BODIES, OR UPLAND BUFFERS WILL BE PERMITTED AT ANY TIME.
- DAMAGE TO WETLANDS AND/OR UPLAND BUFFERS ADJACENT TO CONSTRUCTION AREAS SHALL BE PREVENTED BY DELINEATING THE LIMITS OF CONSTRUCTION, AND INSTALLING SEDIMENT BARRIERS PRIOR TO THE COMMENCEMENT OF CONSTRUCTION ACTIVITIES. THEREBY RETAINING SEDIMENT WITHIN THE CONSTRUCTION AREA. CONTRACTOR WILL BE REQUIRED TO ADEQUATELY MAINTAIN THESE PROTECTION MEASURES AT ALL TIMES.
- EROSION CONTROL AND DUST CONTROL SHALL BE MAINTAINED WITHIN CONSTRUCTION LIMITS. DURING CONSTRUCTION, MEASURES TO PREVENT THE RELEASE OF SEDIMENT AND DUST SHALL BE ACCOMPLISHED USING GRASS COVER, TURBIDITY FENCES, PERIODIC WATERING, AND OTHER BEST MANAGEMENT PRACTICES WHICH ARE ACCEPTABLE TO THE SEMINOLE COUNTY ENGINEERING INSPECTOR AND REGULATORY AGENCIES.
- TURBIDITY BARRIERS SHALL BE USED TO PREVENT RELEASE OF SEDIMENT AND/OR TURBID WATER INTO SURROUNDING WATERS. THESE SEDIMENT AND TURBIDITY BARRIERS SHALL BE MAINTAINED THROUGHOUT THE CONSTRUCTION PERIOD.
- DURING CONSTRUCTION THE CONTRACTOR SHALL NOTIFY OR RELOCATE THE SILT FENCE WITHIN SEMINOLE COUNTY'S PRIOR APPROVAL TO ALLOW FOR ITS ACCESS AND TO COMPLETE CONSTRUCTION. IT IS THE CONTRACTOR'S RESPONSIBILITY TO MAINTAIN ADEQUATE EROSION CONTROL AT ALL TIMES.
- ALL EROSION PREVENTION AND CONTROL MEASURES MUST BE INSPECTED AND APPROVED BY THE COUNTY COMPLIANCE PERSONNEL, AS REQUIRED, PRIOR TO ANY CONSTRUCTION ACTIVITIES. REMOVAL OF THESE SAME EROSION CONTROLS AND PREVENTION MEASURES MAY BE DONE ONLY AFTER AUTHORIZATION BY COUNTY PERSONNEL IS OBTAINED.
- ALL SURFACE WATER DISCHARGE FROM SITE, INCLUDING DEWATERING DISCHARGE, SHALL MEET CURRENT STATE WATER QUALITY STANDARDS PRIOR TO REACHING ANY WATERS OF THE STATE INCLUDING WETLANDS.
- ALL STORM DRAINAGE INLETS AND SPES SHALL BE PROTECTED FROM SILT, SAND AND DEBRIS DURING CONSTRUCTION. ANY ACCUMULATION WITHIN THE STORM DRAINAGE PIPE SYSTEM SHALL BE REMOVED WITHOUT PUMPING OR FLUSHING. STORM DRAINAGE SYSTEM SHALL BE CLEANED AND FREE OF DEBRIS PRIOR TO ENGINEERS/INSPECTORS ACCEPTANCE.

CONTAMINATION NOTES

- COORDINATE NATIONAL POLLUTANT DISCHARGE ELIMINATION SYSTEMS (NPDES) DEWATERING ACTIVITIES WITHIN THE PROJECT AREA. THE CONTRACTOR SHALL BE RESPONSIBLE FOR OBTAINING NECESSARY PERMITS AND FOR OBTAINING NECESSARY TECHNICAL SUPPORT FROM THE SEMINOLE COUNTY ENGINEERING DIVISION. SEE CONTAMINATION SCREENING TECHNICAL MEMORANDUM.
- NPDES DEWATERING ACTIVITIES WITHIN FIVE HUNDRED FEET (500') OF ANY MEDIUM OR HIGH RATE CONTAMINATION SITE IDENTIFIED IN THE CONTAMINATION TECHNICAL MEMORANDUM, CANNOT UTILIZE THE NPDES GENERAL PERMIT, AND REQUIRE A SPECIAL DEWATERING PERMIT FOR CONTAMINATED SITES. SPECIAL DEWATERING PERMITS ARE OBTAINED FROM THE SEMINOLE COUNTY ENGINEERING DIVISION. THESE DEWATERING ACTIVITIES SHALL BE COORDINATED THROUGH THE PROJECT ENGINEER TO ENSURE COMPLIANCE WITH FDEP NPDES REGULATIONS.

DATE	DESCRIPTION	REVISIONS	DATE

PROFESSIONAL OF RECORD: CHRISTOPHER L. THOMPSON, P.E. # 62505 682 SOUTH KESHAN ROAD CASSELBERRY, FL 32709 CERTIFICATION OF AUTHORIZATION NO. 24	SEMINOLE COUNTY ENGINEERING DIVISION ROAD MIDWAY BASIN DRAINAGE MIDWAY IMPROVEMENTS COUNTY CIP NO. 01907077
---	---

USER: U0012393 28/08/2023 9:38:08 PM C:\Users\U0012393\Desktop\SMCT_EDR\K\001001024\midway Basin final Design\Project Files\B23\midway\GINT\FD-824.dwg	GENERAL NOTES SHEET NO. 31
---	--------------------------------------

NOTES:
 1) PAVEMENT RESTORATION IS SHOWN FOR QUANTITY ESTIMATION PURPOSES. AREAS CAN VARY DEPENDING ON CONTRACTORS MEANS AND METHODS OF CONSTRUCTION.
 2) SEE CONTROL POINT TABLE SHEETS FOR STATION AND OFFSET INFORMATION.

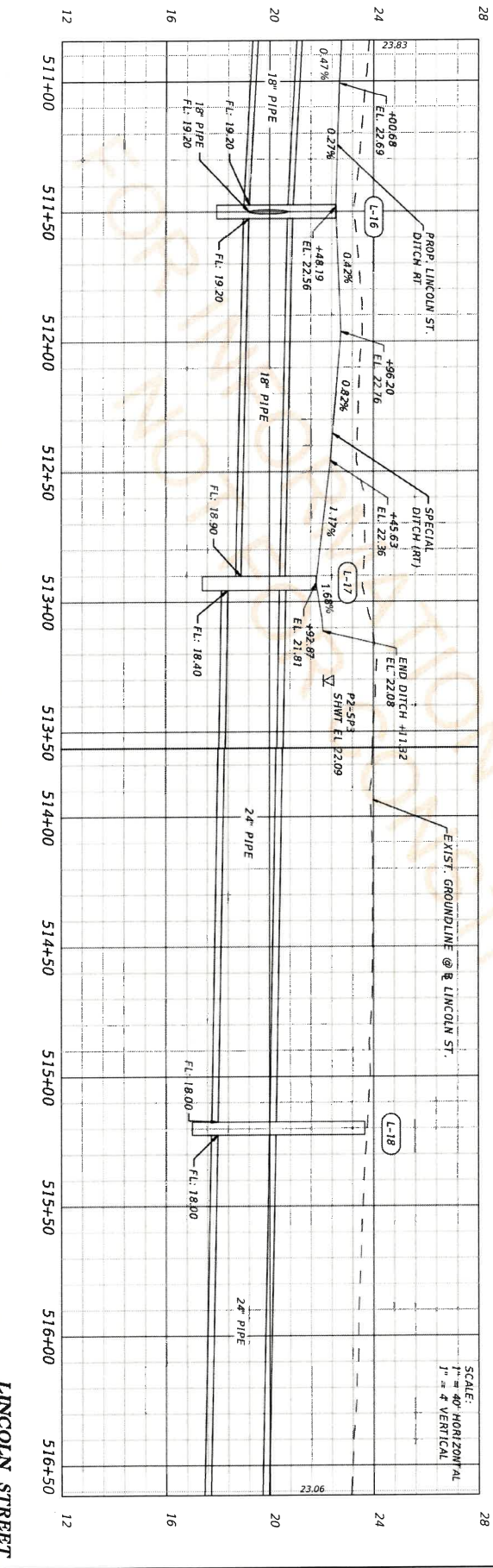
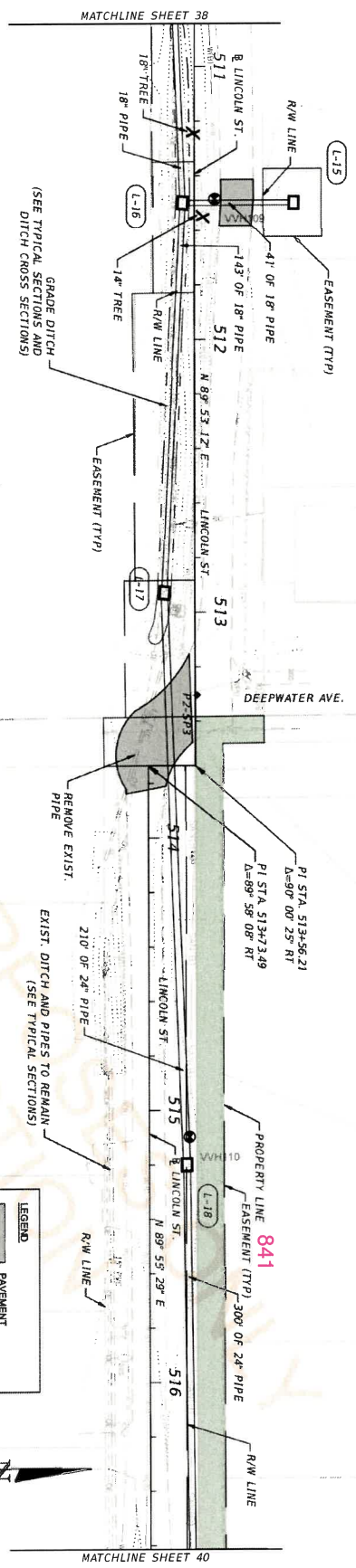
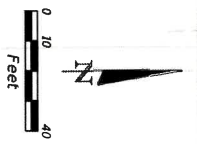
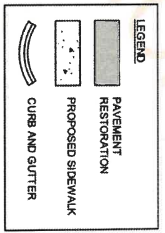

DATE	DESCRIPTION	REVISIONS	DATE	DESCRIPTION
08/08/2023				

PROFESSIONAL OF RECORD:	SEMINOLE COUNTY ENGINEERING DIVISION
ANGEL M. RIVERA-LOPEZ, P.E. # 74275	ROAD
ATKINS NORTH AMERICA, INC.	COUNTY CIP NO.
ORLANDO, FL 32810	01907077
CERTIFICATION OF AUTHORIZATION NO. 24	
28/08/2023	9:23:36 PM

PLAN & PROFILE 8
39

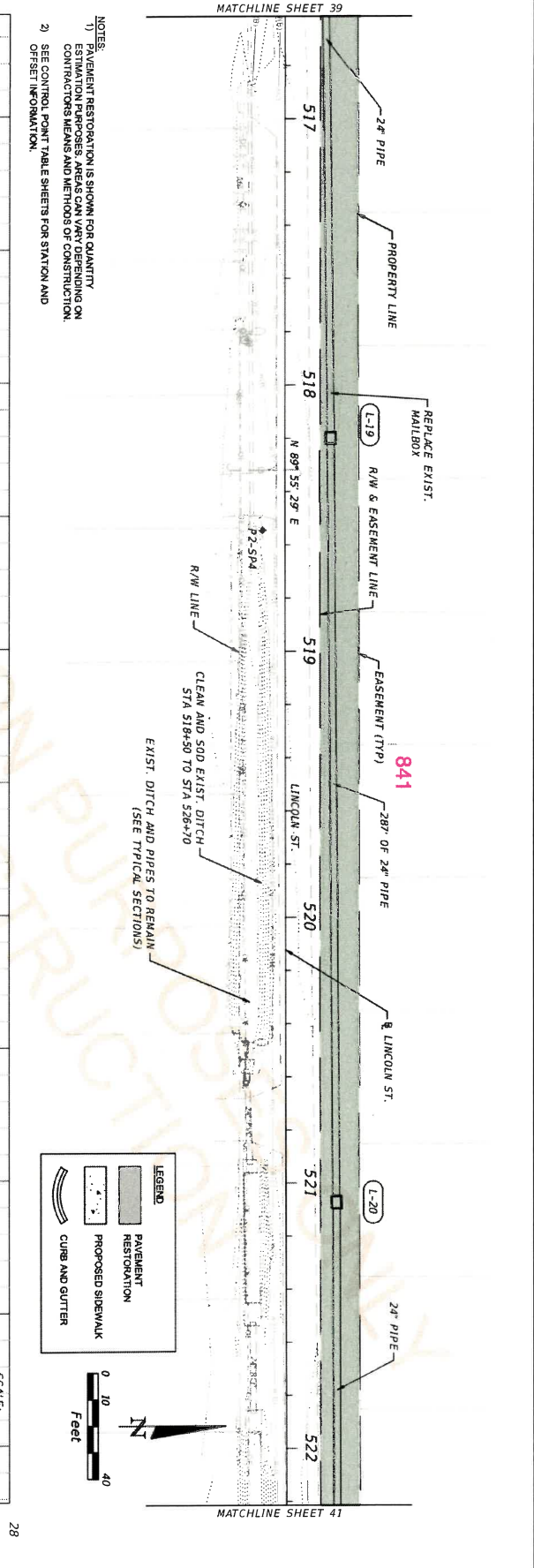

- NOTES:
- 1) PAVEMENT RESTORATION IS SHOWN FOR QUANTITY ESTIMATION PURPOSES. AREAS CAN VARY DEPENDING ON CONTRACTOR'S MEANS AND METHODS OF CONSTRUCTION. SEE CONTROL POINT TABLE SHEETS FOR STATION AND OFFSET INFORMATION.

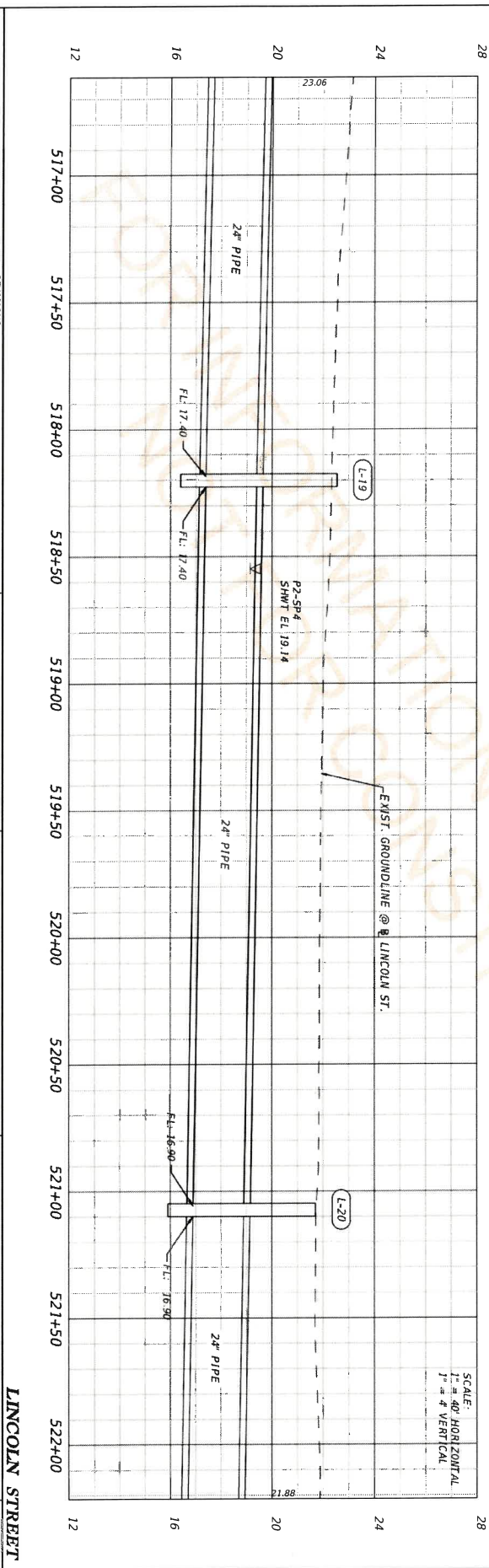

DATE	DESCRIPTION	REVISIONS	DATE	DESCRIPTION

PROFESSIONAL OF RECORD: ATKINS NORTH FLORIDA, INC. 482 SOUTH KELLER ROAD ORLANDO, FL 32810 CERTIFICATION OF AUTHORIZATION NO. 24 2870872023	SEMINOLE COUNTY ENGINEERING DIVISION COUNTY CIP NO. 01907077
--	--

ROAD MIDWAY BASIN DRAINAGE IMPROVEMENTS	PROJECT LINCOLN ST.
--	------------------------

SHEET NO. 40	PLAN & PROFILE 9
--------------	------------------

USER: UID02295

C:\Users\UID02295\Documents\EPN\0008064\Midway Basin Final Design\Project Files\B2\Vgas\map\PLAN08-23.dwg

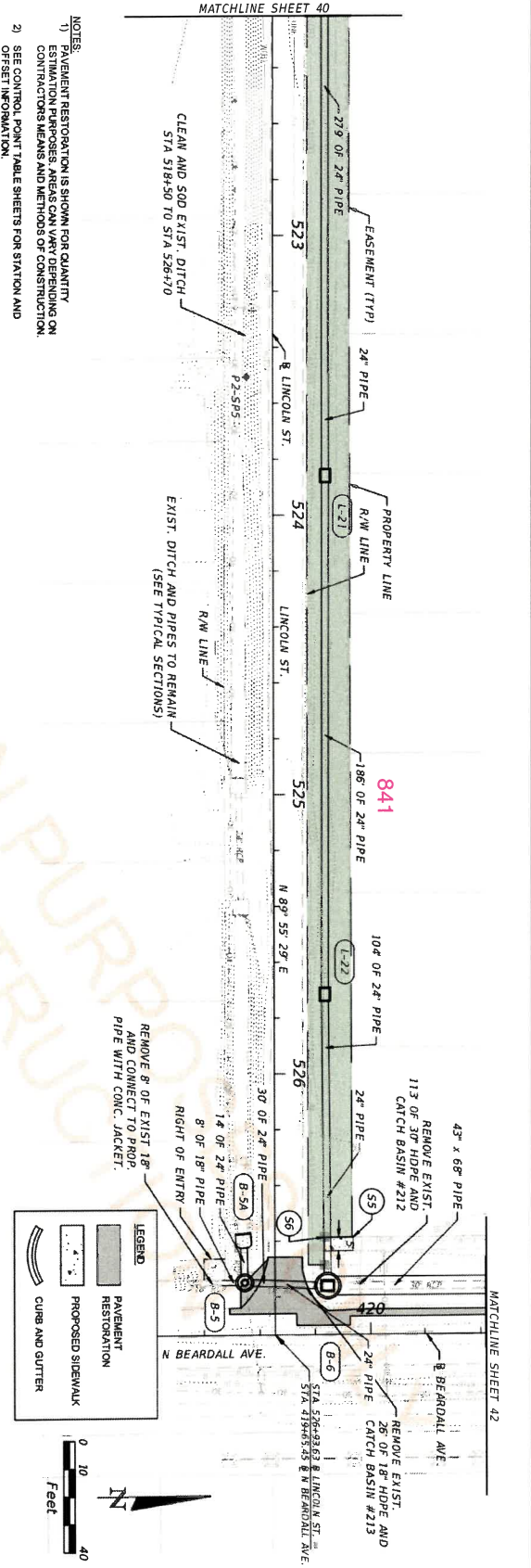

- NOTES:
- 1) PAVEMENT RESTORATION IS SHOWN FOR QUANTITY ESTIMATION PURPOSES. AREAS CAN VARY DEPENDING ON CONTRACTOR'S MEANS AND METHODS OF CONSTRUCTION.
 - 2) SEE CONTROL POINT TABLE SHEETS FOR STATION AND OFFSET INFORMATION.

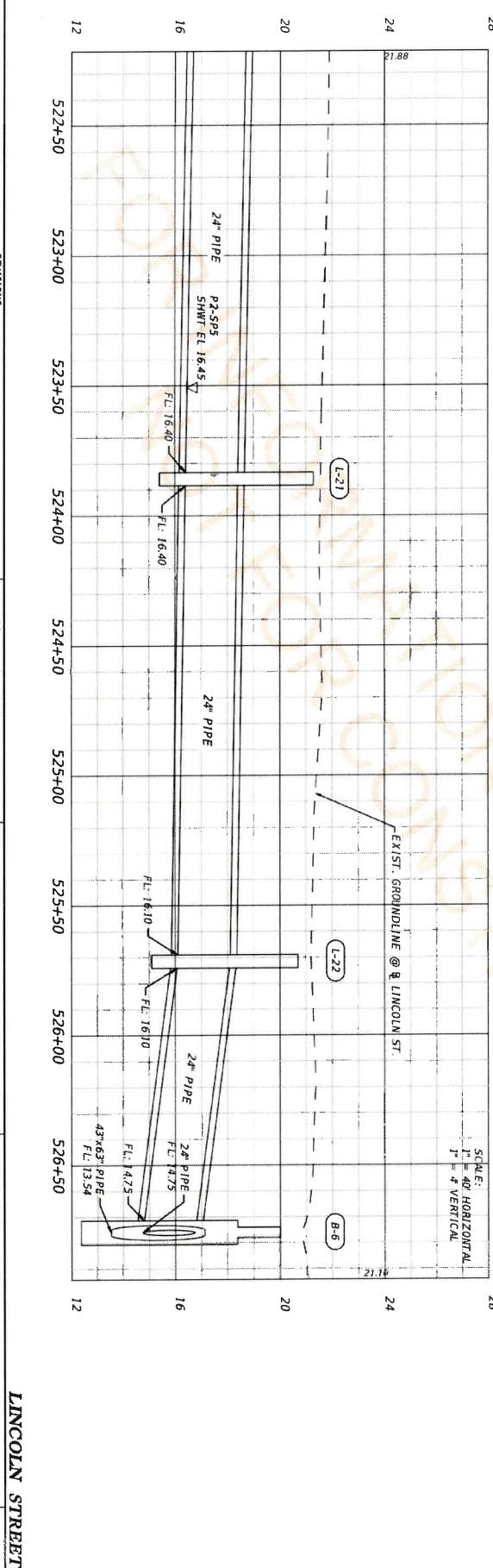
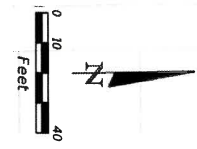
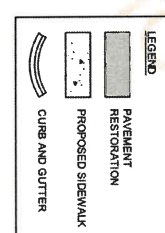

DATE	DESCRIPTION	REVISIONS	DATE	DESCRIPTION

PROFESSIONAL OF RECORD:	ANGEL M. RIVERA-LOPEZ, P.E. # 74275
	ATKINS NORTH AMERICA, INC.
	482 SOUTH KELLER ROAD
	ORLANDO, FL 32810
	CERTIFICATION OF AUTHORIZATION NO. 24
DATE:	23/08/2023

SEMINOLE COUNTY	ENGINEERING DIVISION
ROAD	COUNTY CIP NO.
MIDWAY BASIN DRAINAGE IMPROVEMENTS	01907077

PLAN & PROFILE 10	SHEET NO. 41
-------------------	--------------

- NOTES:
- 1) PAVEMENT RESTORATION IS SHOWN FOR QUANTITY ESTIMATION PURPOSES. AREAS CAN VARY DEPENDING ON CONTRACTORS MEANS AND METHODS OF CONSTRUCTION. OFFSET INFORMATION.
 - 2) SEE CONTROL POINT TABLE SHEETS FOR STATION AND OFFSET INFORMATION.

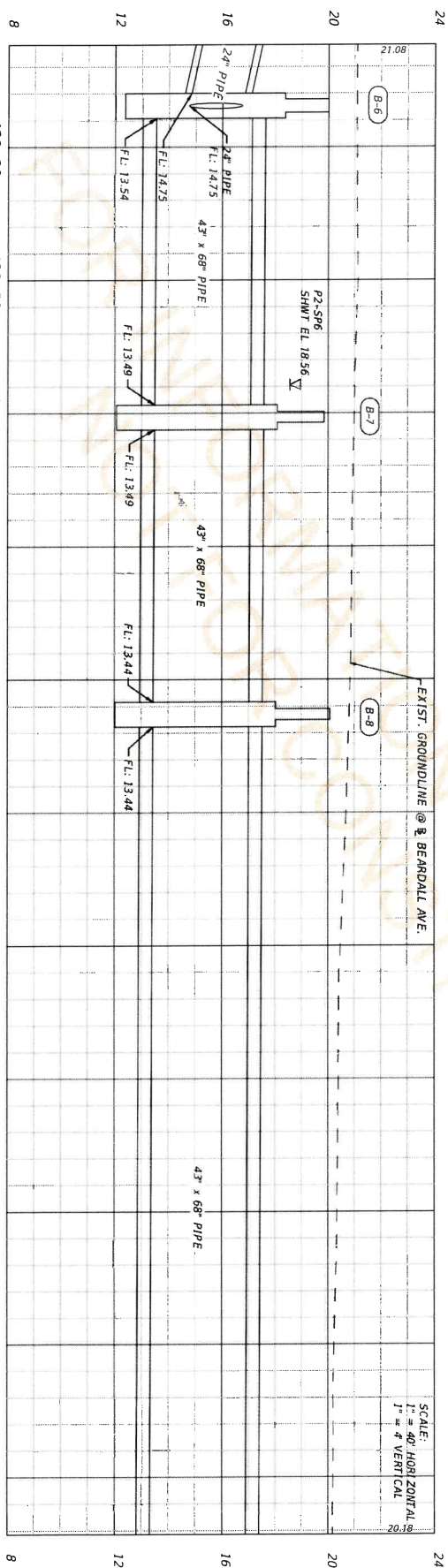
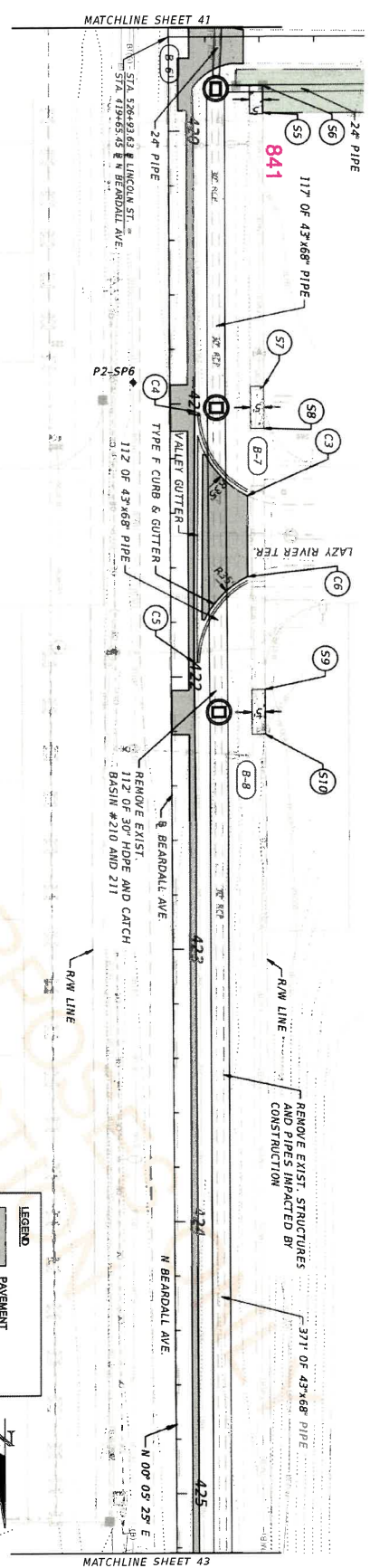
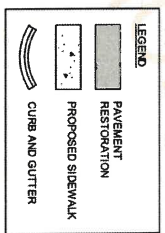

DATE	DESCRIPTION	REVISIONS	DATE	DESCRIPTION

PROFESSIONAL OF RECORD: ATKINS NORTH AMERICA, INC. 482 SOUTH KELLER ROAD ORLANDO, FL 32810 CERTIFICATION OF AUTHORIZATION NO. 24	SEMINOLE COUNTY ENGINEERING DIVISION ROAD COUNTY CIP NO. 0190707	MIDWAY BASIN DRAINAGE IMPROVEMENTS
--	--	---------------------------------------

USER: U0A295	28/08/2023	9:34:39 PM
--------------	------------	------------

NORTH BEARDALL AVENUE

PLAN & PROFILE II

SHEET NO. 42

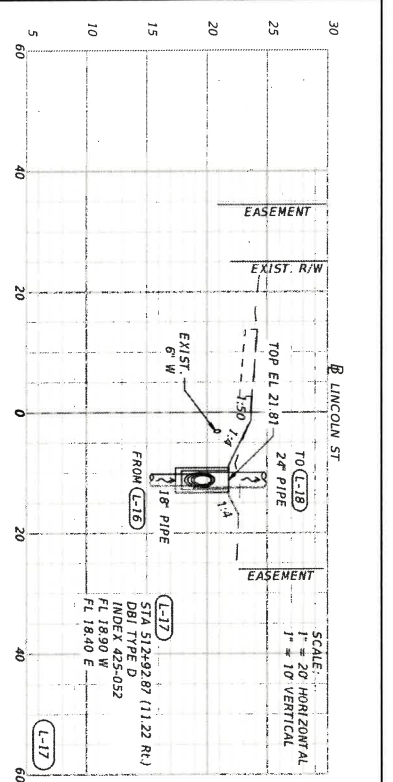

512+92.87

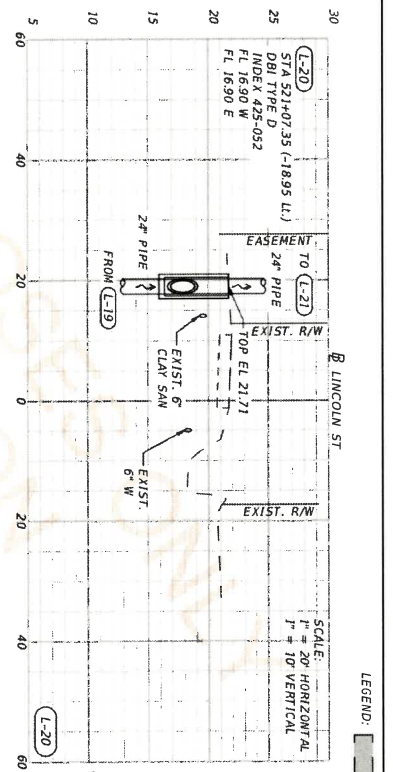

521+07.35

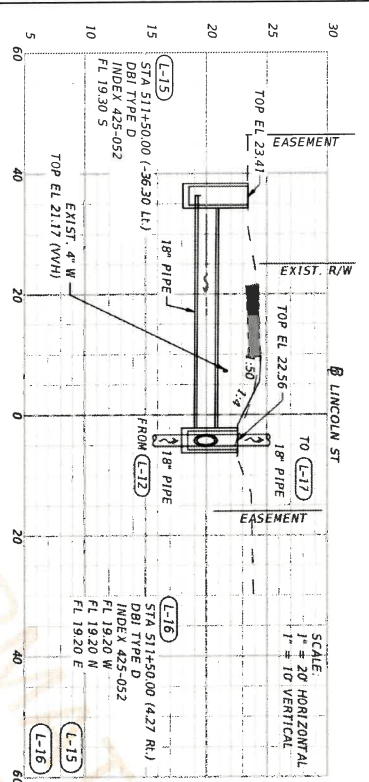

511+50.00

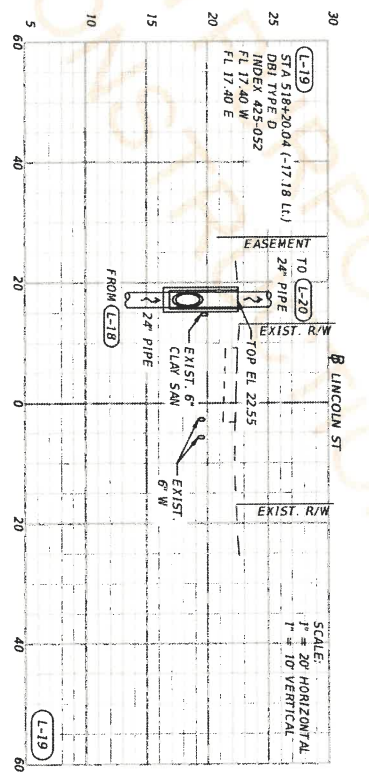

518+20.04

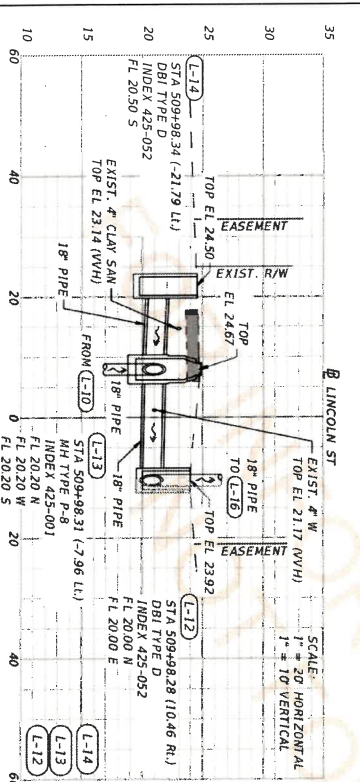

509+98.31

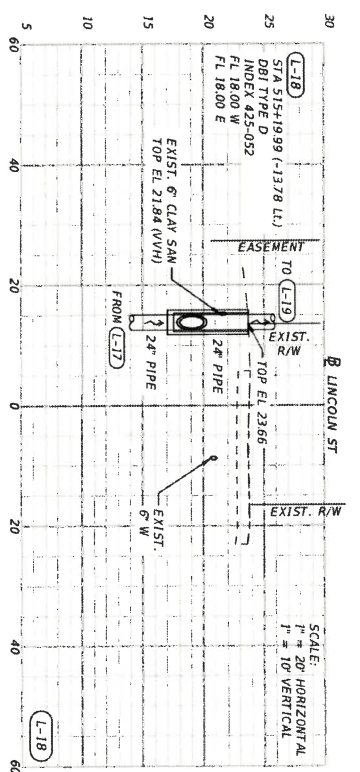

515+19.99

DATE	DESCRIPTION	REVISIONS	DATE	DESCRIPTION

PROFESSIONAL OF RECORD: CHRISTOPHER L. THOMPSON, P.E. # 62505 482 SOUTH KESLER ROAD MEMPHIS, TN 38105 CERTIFICATION OF AUTHORIZATION NO. 24 29/08/2023	SEMINOLE COUNTY ENGINEERING DIVISION ROAD COUNTY CIP NO. 01907077 MIDWAY BASIN DRAINAGE IMPROVEMENTS	DRAINAGE STRUCTURE SECTIONS - LINCOLN AVE. SHEET NO. 62
---	--	---

LEGEND:  RESTORATION

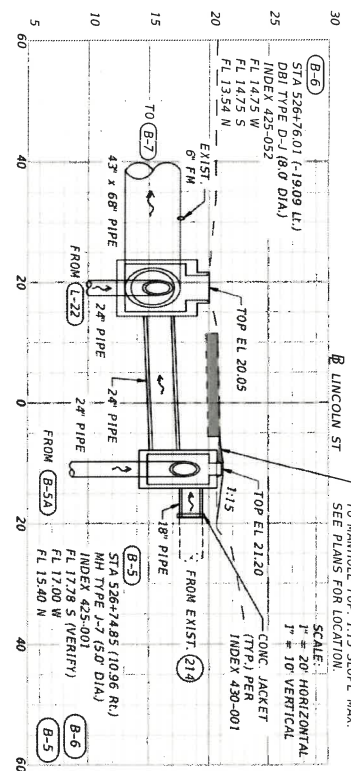

526+75.43

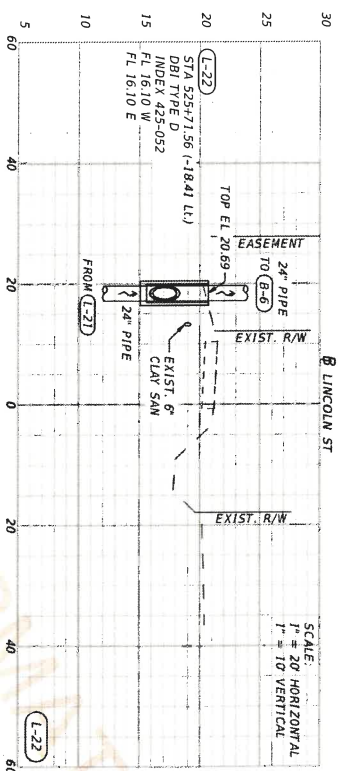

525+71.56

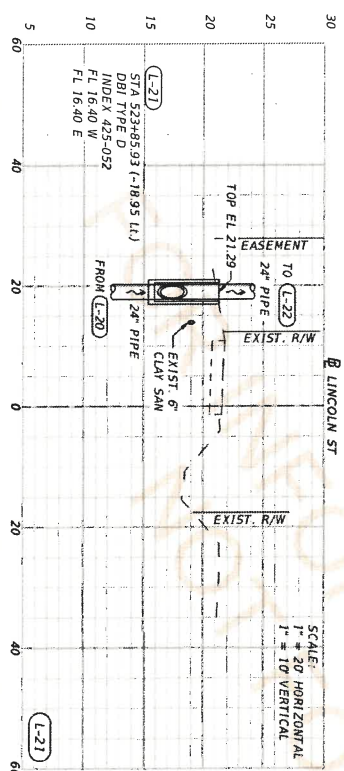

523+85.93

DATE	DESCRIPTION	REVISIONS	DATE	DESCRIPTION

PROFESSIONAL OF RECORD: CHRISTOPHER L. THOMPSON, P.E. # 62505 682 SOUTH KESLER ROAD HOOVER, ALABAMA 36030 CERTIFICATION OF AUTHORIZATION NO. 24	SEMINOLE COUNTY ENGINEERING DIVISION ROAD COUNTY CIP NO. 01907077	DRAINAGE STRUCTURE SECTIONS - LINCOLN AVE.	SHEET NO. 63
---	---	---	--------------

USER: CLAMB035 29/08/2023 10:09:41 AM C:\Users\UID3235\Documents\ENCL EPH\1008080164Midway Basin Final Design\Project Files\BFD\Drainage\DR3503-BFD-21.dwg

THE FOLLOWING NARRATIVE OF THE STORMWATER POLLUTION PREVENTION PLAN CONTAINS REFERENCES TO THE FDOT STANDARD SPECIFICATIONS FOR ROAD AND BRIDGE CONSTRUCTION, THE DESIGN STANDARDS, AND OTHER SHEETS OF THESE CONSTRUCTION PLANS. THE FIRST SHEET OF THE CONSTRUCTION PLANS (CALLED THE KEY SHEET) CONTAINS AN INDEX TO THE OTHER SHEETS. THE COMPLETE STORMWATER POLLUTION PREVENTION PLAN INCLUDES SEVERAL ITEMS. THIS NARRATIVE DESCRIPTION, THE DOCUMENTS REFERENCED IN THIS NARRATIVE, THE CONTRACTOR'S APPROVED EROSION CONTROL PLAN, THE CONSTRUCTION SECTION 104, AND REPORTS OF INSPECTIONS MADE DURING CONSTRUCTION.

10 SITE DESCRIPTION:

1A. NATURE OF CONSTRUCTION ACTIVITY:
THIS PROJECT INCLUDES DRAINAGE IMPROVEMENTS TO THE MIDWAY NEIGHBORHOOD. THIS INVOLVES CONSTRUCTION OF STORMSEWER INLETS, PIPES, DITCHES AND STORMWATER MANAGEMENT PONDS. IT ALSO INCLUDES PAVEMENT, SIDEWALK AND CURB RESTORATION. PROJECT LIMITS ARE DEPICTED ON THE PLAN SHEETS.

1B. SEQUENCE OF MAJOR SOIL DISTURBING ACTIVITIES:

IN THE SEDIMENT AND EROSION CONTROL PLAN, THE CONTRACTOR SHALL PROVIDE A DETAILED SEQUENCE OF CONSTRUCTION FOR ALL CONSTRUCTION ACTIVITIES. BELOW IS A SUGGESTED SEQUENCE OF MAJOR ACTIVITIES; HOWEVER, IT IS THE CONTRACTOR'S RESPONSIBILITY TO PROVIDE A SEQUENCE THAT IS EQUAL TO OR BETTER AT CONTROLLING EROSION AND TRAPPING SEDIMENT. THE PLAN SHALL BE APPROVED BY THE ENGINEER.

FOR EACH CONSTRUCTION PHASE, INSTALL PERIMETER CONTROLS AFTER CLEARING AND GRUBBING NECESSARY FOR THE CONSTRUCTION PHASE BUT BEFORE BEGINNING OTHER WORK. THE CONSTRUCTION PHASE SHALL BE PERIMETER CONTROLS ONLY AFTER ALL UPSTREAM AREAS ARE STABILIZED.

1. CLEARING AND GRUBBING, EARTHWORK, AND STORM DRAIN CONSTRUCTION FOR THE OUTFALL FROM THE PONDS.

2. CLEARING AND GRUBBING, EARTHWORK FOR POND CONSTRUCTION.

3. STORM DRAIN CONSTRUCTION. CONSTRUCT THE STORM DRAIN PIPE IN THE UPSTREAM DIRECTION.

4. EARTHWORK ASSOCIATED WITH THE CONSTRUCTION OF ROADWAY, CURB, SUBGRADE, BASE, PAVEMENT, AND SIDEWALK.

1C. AREA ESTIMATES:

TOTAL SITE AREA: 315 ACRES
TOTAL AREA TO BE DISTURBED: 315 ACRES

1D. RUNOFF DATA:

RUNOFF COEFFICIENTS:
BEFORE: 0.61
DURING: 0.61
AFTER: 0.61

SOILS DATA: THE RESULTS OF THE SOIL BORINGS ALONG THE ROADWAY ARE SHOWN IN THE ROADWAY SOIL SURVEY SHEETS. THE RESULTS OF SOIL BORINGS DONE IN THE PONDS ARE SHOWN ON THE POND DETAIL SHEETS. THE NUMBERS FOR THESE ARE IDENTIFIED ON THE KEY SHEET OF THESE CONSTRUCTION PLANS. IN GENERAL, THE SOILS ARE SILTY SANDS.

1E. OUTFALL INFORMATION:
THERE ARE 3 OUTFALLS.

DESCRIPTION: ROSSETTENS DITCH AT CELERY AVENUE
LOCATION: LATITUDE 28 48 06 N, LONGITUDE 81 13 30 W
EST. DRAINAGE AREA SIZE: 76.6 ACRES
RECEIVING WATER NAME: LAKE MOORBE

DESCRIPTION: HUGHEY ST. DITCH AT E LAKE MARY BLVD
LOCATION: LATITUDE 28 47 38 N, LONGITUDE 81 12 47 W
EST. DRAINAGE AREA SIZE: 189.8 ACRES
RECEIVING WATER NAME: ST. JOHNS RIVER

DESCRIPTION: WASHINGTON STREET DITCH (CAMERON CANAL) AT E LAKE MARY BLVD
LOCATION: LATITUDE 28 47 26 N, LONGITUDE 81 12 47 W
EST. DRAINAGE AREA SIZE: 139.8 ACRES
RECEIVING WATER NAME: ST. JOHNS RIVER

IF. SITE MAP:
THE CONSTRUCTION PLANS ARE BEING USED AS THE SITE MAP. THE LOCATION OF THE REQUIRED INFORMATION IS DESCRIBED BELOW. THE SHEET NUMBERS FOR THE PLAN SHEETS REFERENCED ARE IDENTIFIED ON THE KEY SHEET OF THESE CONSTRUCTION PLANS.

*DRAINAGE PATTERNS: THE DRAINAGE BASIN DIVIDES AND FLOW DIRECTIONS ARE SHOWN ON THE DRAINAGE MAPS.

*APPROXIMATE SLOPES: THE SLOPES OF THE SITE CAN BE SEEN IN THE CROSS SECTION SHEETS AND THE PLAN-PROFILE SHEETS. THERE ARE POND CROSS SECTIONS LOCATED WITH THE POND DETAIL SHEETS.

*AREAS OF SOIL DISTURBANCE: THE AREAS TO BE DISTURBED ARE INDICATED ON THE PLAN-PROFILE SHEETS. THE CROSS SECTION SHEETS, AND THE POND DETAIL SHEETS. ANY AREAS WHERE PERMANENT FEATURES ARE SHOWN TO BE CONSTRUCTED ABOVE OR BELOW GROUND WILL BE DISTURBED.

*AREAS NOT TO BE DISTURBED: ESSENTIALLY THE WHOLE PROJECT WILL BE DISTURBED DURING CONSTRUCTION.

*LOCATIONS OF TEMPORARY CONTROLS: THESE ARE SHOWN ON THE EROSION CONTROL SHEETS. TABLES PROVIDING SUMMARIES OF TEMPORARY EROSION AND SEDIMENT CONTROL ITEMS ARE PROVIDED IN THE SUMMARY OF QUANTITY SHEETS.

*LOCATIONS OF PERMANENT CONTROLS: THE STORMWATER PONDS ARE THE PRIMARY PERMANENT STORMWATER MANAGEMENT CONTROLS. THESE ARE SHOWN ON THE POND DETAIL SHEETS.

*AREAS TO BE STABILIZED: TEMPORARY STABILIZATION PRACTICES ARE SHOWN IN THE SAME LOCATION AS THE TEMPORARY CONTROLS MENTIONED ABOVE. PERMANENT STABILIZATION IS SHOWN ON THE TYPICAL SECTION SHEETS, THE PLAN-PROFILE SHEETS AND THE POND DETAIL SHEETS.

*SURFACE WATERS: INCLUDES THE HUGHEY ST. DITCH, WASHINGTON ST. DITCH, ROSSETTENS DITCH, POND 2-3, POND 2-5 AND FCP POND. THERE ARE ALSO WETLANDS ON THE SOUTHWEST CORNER OF POND 2-5 AND WITHIN POND 2-3 THAT WILL BE IMPACTED WITH THIS PROJECT.

*DISCHARGE TO SURFACE WATERS: DISCHARGES OCCUR AT CELERY ST. AND RIVERSIDE OAKS WAY, AT POND 2-3, 2-5 AND AT FCP POND.

1G. RECEIVING WATERS:
SEE ITEM 1E. FOR THE OUTFALL LOCATIONS AND RECEIVING WATER NAMES.

DATE	DESCRIPTION	REVISIONS	DATE	DESCRIPTION

PROFESSIONAL OF RECORD: CHRIS OPPER, C. THOMPSON, P. E. # 62505 482 SOUTH KELLER ROAD ORLANDO, FL 32810 CERTIFICATION OF AUTHORIZATION NO. 24 12/09/2023	SEMINOLE COUNTY ENGINEERING DIVISION COUNTY CIP NO. 01907077	MIDWAY BASIN DRAINAGE IMPROVEMENTS	9:43:00 PM
---	---	---------------------------------------	------------

STORMWATER POLLUTION PREVENTION PLAN (01)	SHEET NO. 102
--	---------------------

LEGEND	
	FLOATING TURBIDITY BARRIER
	INLET PROTECTION
	SEDIMENT BARRIER
	STAGED TURBIDITY BARRIER

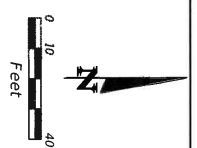
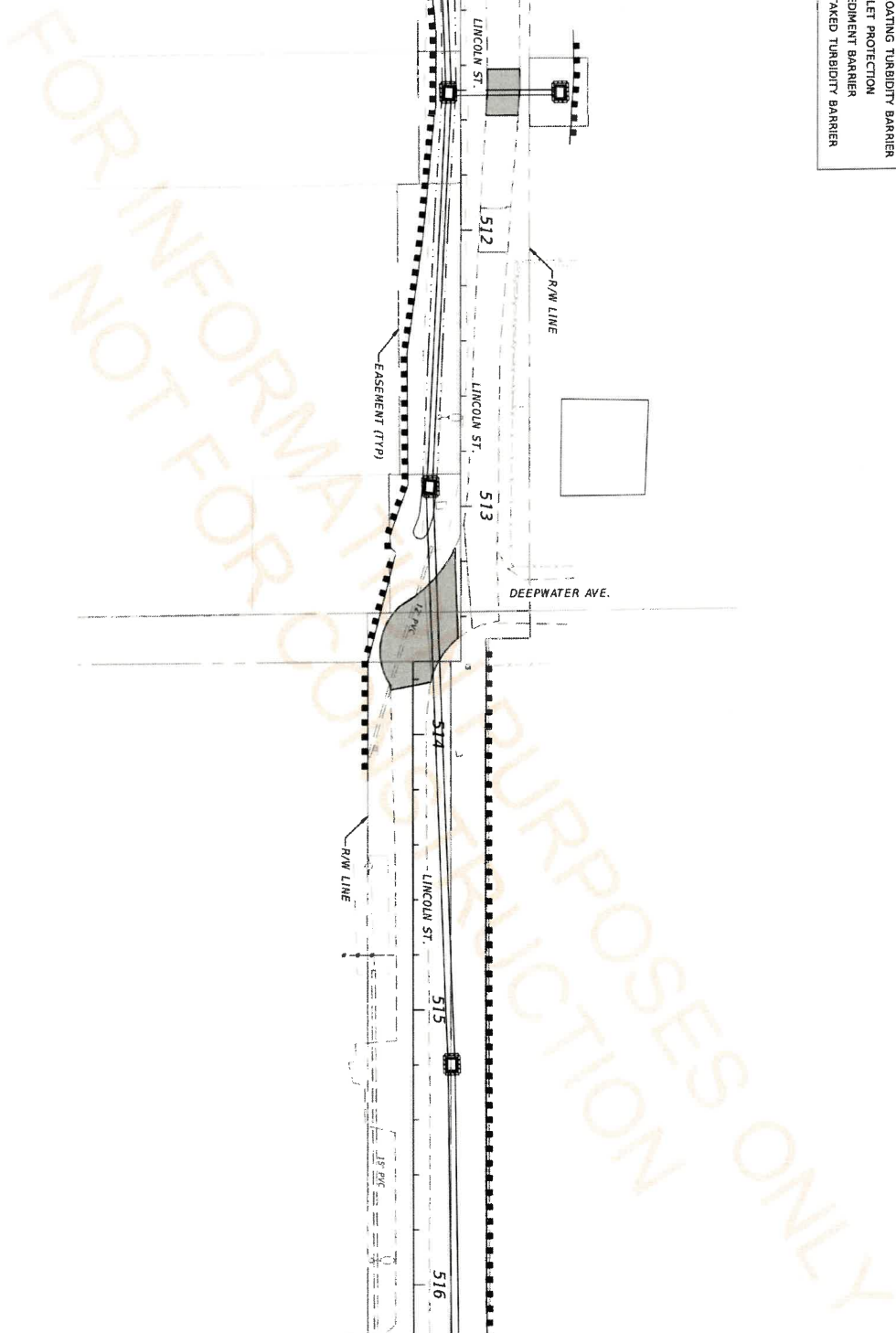

DATE	DESCRIPTION	REVISIONS	DATE	DESCRIPTION

PROFESSIONAL OF RECORD: CHRISTOPHER L. THOMPSON, P.E. # 62505 ATKINS NORTH AMERICA, INC. 482 SOUTH KELLER ROAD ORLANDO, FL 32810 CERTIFICATION OF AUTHORIZATION NO. 24 28/08/2023	SEMINOLE COUNTY ENGINEERING DIVISION ROAD COUNTY CIP NO. MIDWAY BASIN DRAINAGE IMPROVEMENTS 01907077	EROSION CONTROL PLAN (3)	SHEET NO. 108
---	--	---------------------------------	------------------

USER: JHARB201

LEGEND	
	FLOATING TURBIDITY BARRIER
	INLET PROTECTION
	SEDIMENT BARRIER
	STAKED TURBIDITY BARRIER

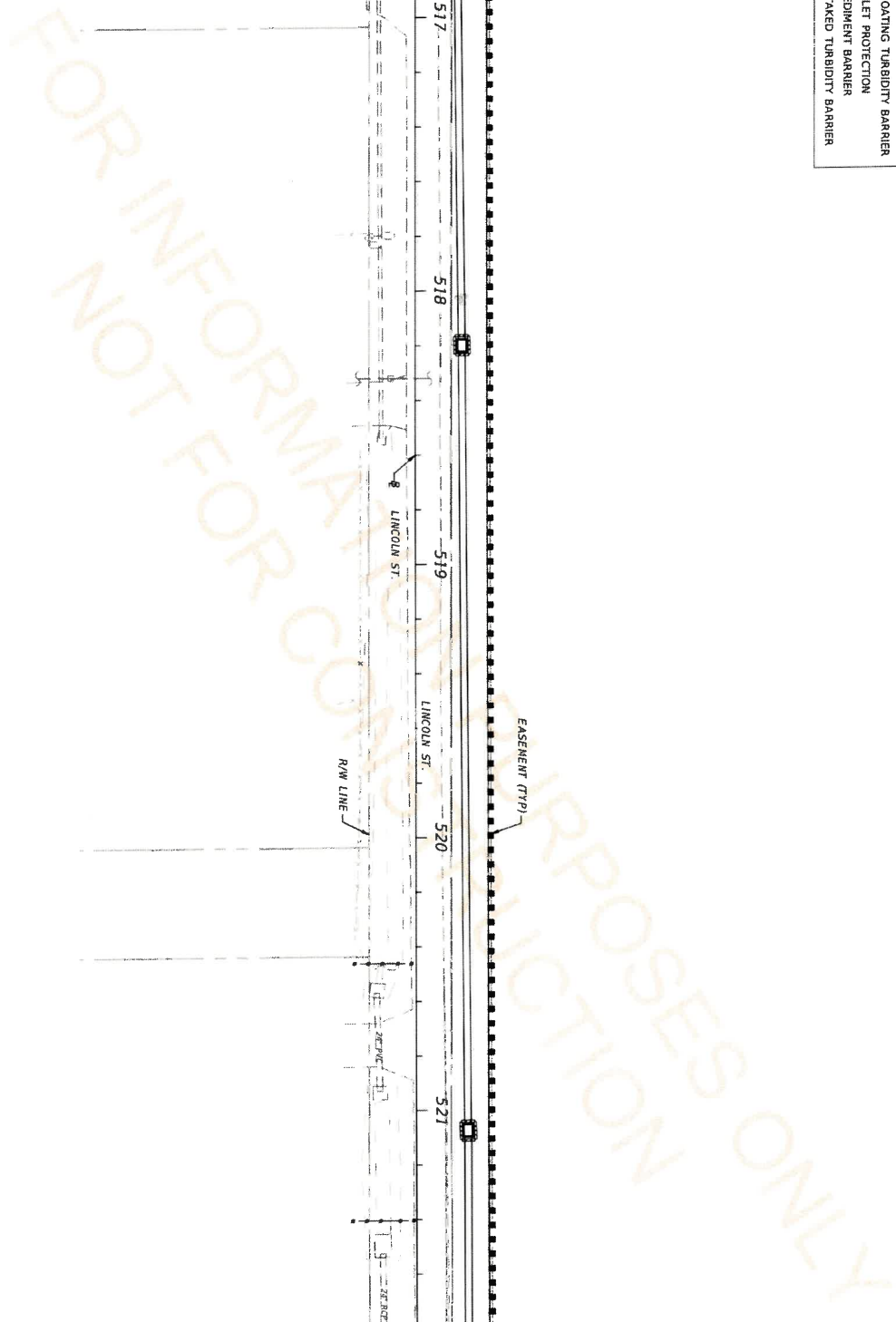

MATCHLINE SHEET 108

MATCHLINE SHEET 110

DATE	DESCRIPTION	REVISIONS	DATE	DESCRIPTION

PROFESSIONAL OF RECORD: CHRISTOPHER L. THOMPSON, P.E. # 62505 AKINS ENGINEERING, INC. 4005 MONTELEONE ROAD ORLANDO, FL 32830 CERTIFICATION OF AUTHORIZATION NO. 24 28/08/2023	SEMINOLE COUNTY ENGINEERING DIVISION ROAD MIDWAY BASIN DRAINAGE IMPROVEMENTS COUNTY CIP NO. 01907077	EROSION CONTROL PLAN (4) SHEET NO. 109
---	--	---

USER: HARB2011
 C:\Users\WJ23295\OneDrive\Documents\EROSION CONTROL\Midway Basin Final Design\Project Files\DWG\Drainage\SYNTHRO\B2322.dwg

LEGEND	
	FLOATING TURBIDITY BARRIER
	INLET PROTECTION
	SEDIMENT BARRIER
	STAKED TURBIDITY BARRIER

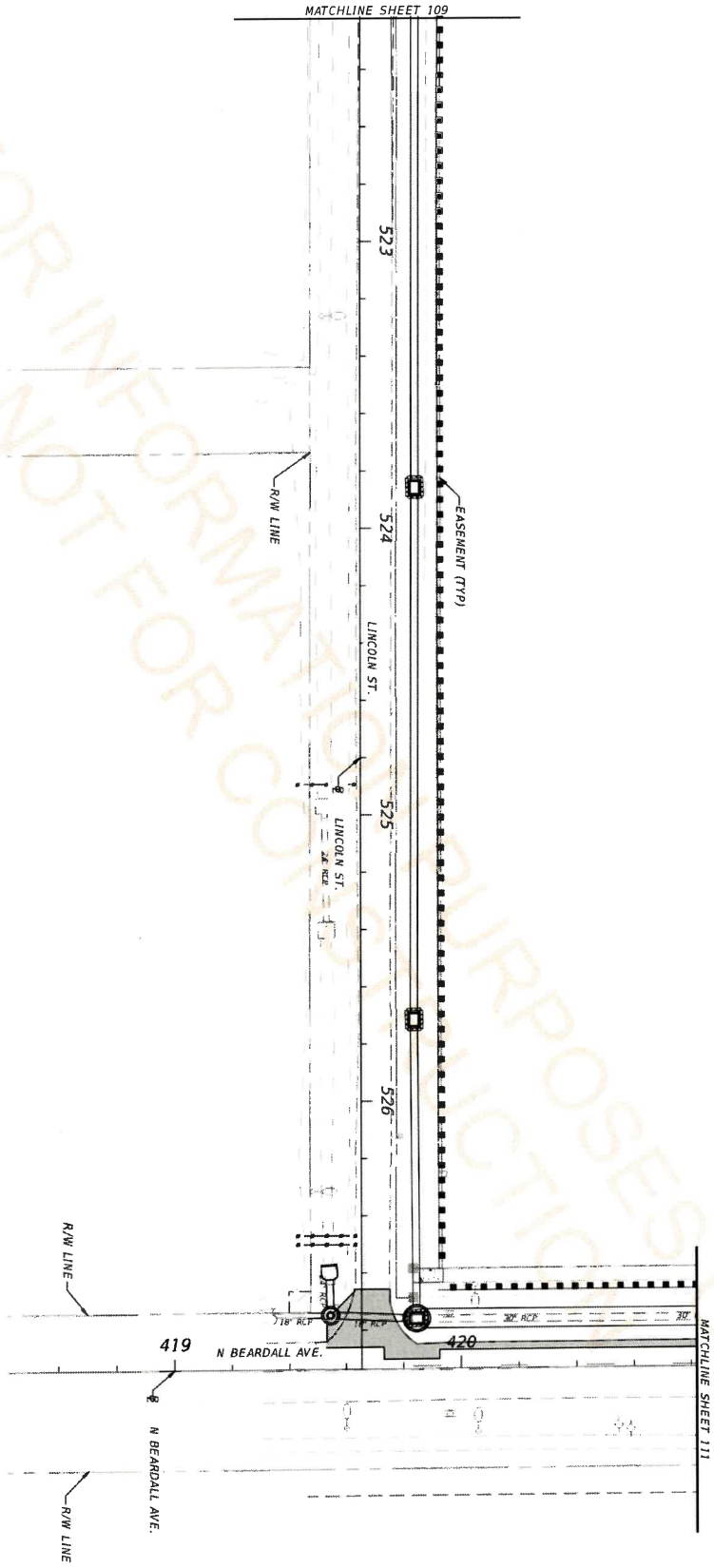

DATE	DESCRIPTION	REVISIONS	DATE	DESCRIPTION

PROFESSIONAL OF RECORD: CHRISTOPHER L. THOMPSON, P.E. # 62505 482 SOUTH KELLER ROAD ORLANDO, FL 32810 CERTIFICATION OF AUTHORIZATION NO. 24 28/08/2023	SEMINOLE COUNTY ENGINEERING DIVISION ROAD MIDWAY BASIN DRAINAGE IMPROVEMENTS	COUNTY CIP NO. 01907077	PROJECT FILE NAME EROSION CONTROL PLAN (5)	SHEET NO. 110
---	--	----------------------------	---	------------------

THE OFFICIAL RECORD OF THIS SHEET IS THE ELECTRONIC FILE DIGITALLY SIGNED AND SEALED UNDER RULE 61G15-23.004, F.A.C.

TRAFFIC CONTROL GENERAL NOTES

1. THE REGULATORY POSTED SPEED FOR EACH ROAD ARE NOTED BELOW
 BEADALL AVENUE 25 MPH
 APALACHICOLA LANE 15 MPH
 CAMERON AVENUE 25 MPH
 LINCOLN STREET 25 MPH
 CELERY AVENUE 45 MPH
2. VEHICULAR AND PEDESTRIAN TRAFFIC SHALL BE MAINTAINED IN ACCORDANCE WITH FOOT STANDARD PLANS, INDEX 102 SERIES, THE STANDARD SPECIFICATIONS FOR ROAD AND BRIDGE CONSTRUCTION AND THE MANUAL ON UNIFORM TRAFFIC CONTROL DEVICES (MUTCD) AS A MINIMUM.
3. LANE CLOSURES SHALL BE PERMITTED ONLY DURING ACTIVE WORK PERIODS.
4. LANE CLOSURES HOURS ARE TYPICALLY RESTRICTED TO 9AM TO 4PM.
5. IF LANE CLOSURES ARE CLOSE TO SIDE STREET INTERSECTIONS OR DRIVEWAYS, THEN INDEX 102-604 AND INDEX 102-606 ARE REQUIRED.
6. PORTABLE CHANGEABLE MESSAGE SIGNS (PCMS) SHALL BE PROVIDED DURING AND MAINTAINED THROUGHOUT LANE CLOSURES. MINIMUM SHALL BE PROVIDED FOR EACH LANE CLOSURE FROM SEVEN DAYS PRIOR TO CLOSURE THRU END OF CLOSURE.
7. SEMINOLE COUNTY IS ADMINISTERING THE CONSTRUCTION OF THIS PROJECT. IT IS THE COUNTY'S POLICY TO PLACE THE RESPONSIBILITY FOR MAINTENANCE OF TRAFFIC DURING CONSTRUCTION ON THE CONTRACTOR. THE CONTRACTOR WILL BE REQUIRED TO SUBMIT A TRAFFIC CONTROL PLAN SIGNED AND SEALED BY A STATE LICENSED PROFESSIONAL ENGINEER TO THE CONTRACTOR REVIEW AND APPROVAL PRIOR TO CONSTRUCTION. THE CONTRACTOR SHALL REFER TO THE REFERENCE OF SPECIFIC FOOT STANDARD PLANS INDICES IS ACCEPTABLE.
8. CONTRACTOR SHALL NOTIFY PROPERTY OWNERS ADJACENT TO ANY ROADS A MINIMUM OF SEVEN (7) DAYS BEFORE ROAD CLOSURE.
9. ESSENTIAL SERVICE AND RESIDENTIAL ACCESS MUST BE MAINTAINED THROUGHOUT THE PROJECT DURATION.

FOR INFORMATION PURPOSES ONLY
NOT FOR CONSTRUCTION PURPOSES ONLY

DATE	DESCRIPTION	REVISIONS	DATE	DESCRIPTION

PROFESSIONAL OF RECORD: ANGEL M. RIVERA-LOPEZ, P.E. # 74275 ATKINS NORTH AMERICA, INC. 102 SOUTH KESLER ROAD MOBILE, AL 36688 CERTIFICATION OF AUTHORIZATION NO. 24 29/08/2023	SEMINOLE COUNTY ENGINEERING DIVISION ROAD: MIDWAY BASIN DRAINAGE COUNTY CIP NO: 01907077
--	---

TEMP. TRAFFIC CONTROL	SHEET NO. 131
------------------------------	-------------------------

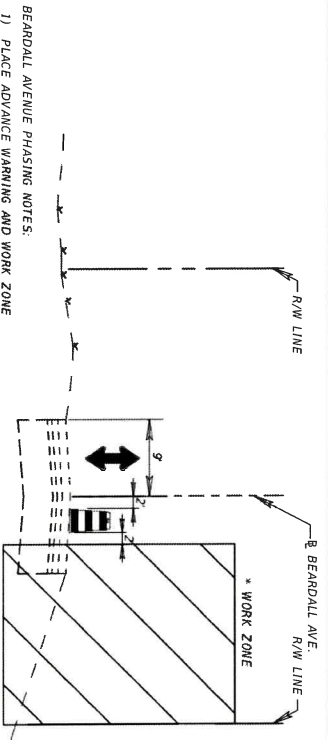

- BEARDSALL AVENUE PHASING NOTES:**
- 1) PLACE ADVANCE WARNING AND WORK ZONE SIGNS, AND CHANNELIZING DEVICES ACCORDING TO FOOT STANDARD PLANS INDEX 102-602, 102-603 AND 102-660
 - 2) INSTALL EROSION CONTROL DEVICES AS REQUIRED.
 - 3) USE DETOURS PROVIDED FOR TEMPORARY ROAD CLOSURES. MAINTAIN ACCESS TO SIDE STREETS, RESIDENTIAL AND COMMERCIAL DRIVEWAYS.
 - 4) CONSTRUCT DRAINAGE IMPROVEMENTS AND RESTORE SITE.
 - 5) OPEN ROAD TO TRAFFIC.

- TYPICAL SECTION (1)
BEARDSALL AVE.**
- * STA. 408+78.90 TO STA. 413+27.60
 - * STA. 419+50.00 TO STA. 426+05.70
 - * STA. 438+69.80 TO STA. 452+81.40

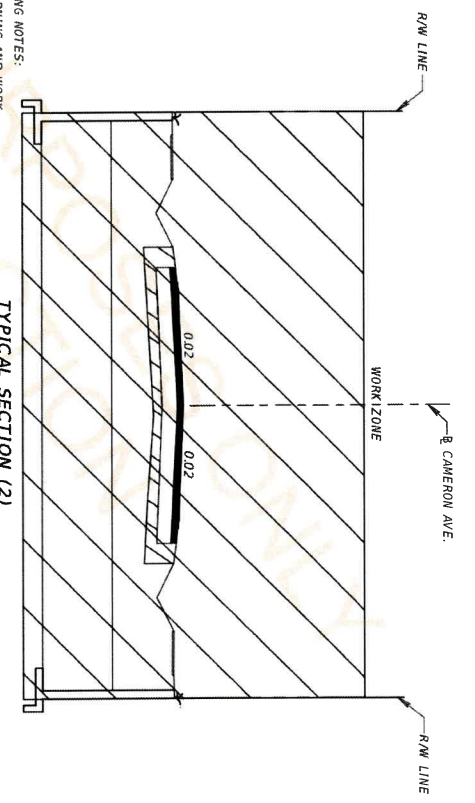

- CAMERON AVENUE PHASING NOTES:**
- 1) PLACE ADVANCE WARNING AND WORK ZONE SIGNS, AND CHANNELIZING DEVICES ACCORDING TO FOOT STANDARD PLANS INDEX 102-602, 102-603 AND 102-660
 - 2) INSTALL EROSION CONTROL DEVICES AS REQUIRED.
 - 3) USE DETOURS PROVIDED FOR TEMPORARY ROAD CLOSURES. MAINTAIN ACCESS TO SIDE STREETS, RESIDENTIAL AND COMMERCIAL DRIVEWAYS.
 - 4) CONSTRUCT DRAINAGE IMPROVEMENTS AND RESTORE SITE.
 - 5) OPEN ROAD TO TRAFFIC.

- TYPICAL SECTION (2)
CAMERON AVE.**
- (STATIONS ARE OFF OF BL WASHINGTON ST. DITCH)
- STA. 619+64.00 TO STA. 620+24.00

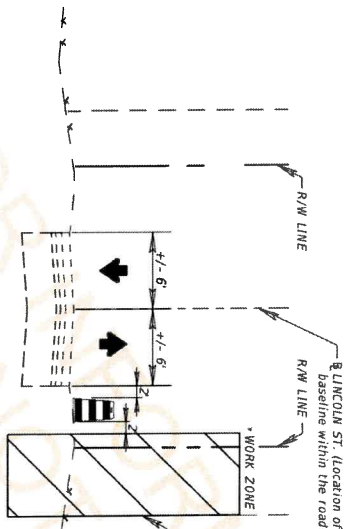

- TYPICAL SECTION (3)
LINCOLN ST.**
- * STA. 503+60.00 TO STA. 506+45.00
 - * STA. 513+40.00 TO STA. 526+75.00

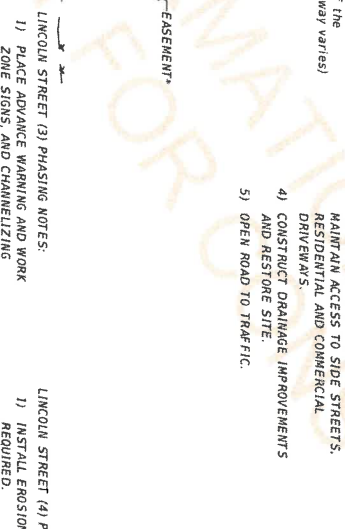

- TYPICAL SECTION (4)
LINCOLN ST.**
- * STA. 506+45.00 TO STA. 513+40.00

DATE	DESCRIPTION	REVISIONS	DATE	DESCRIPTION

PROFESSIONAL OF RECORD: ANGEL M. RIVERA-LOPEZ, P.E. # 74275 482 SOUTH KELLER ROAD ORLANDO, FL 32810	CERTIFICATION OF AUTHORIZATION NO. 24 232324 PM 23/08/2023
SEMINOLE COUNTY ENGINEERING DIVISION ROAD	COUNTY CIP NO. 01907077
TEMP. TRAFFIC CONTROL	
SHEET NO.	128

- LEGEND**
- ☒ TYPE III BARRICADE
 - ☐ WORK ZONE SIGN
 - ☐ PORTABLE CHANGEABLE (VARIABLE) MESSAGE SIGN
 - ➔ LANE IDENTIFICATION AND DIRECTION OF TRAFFIC
 - ▨ WORK ZONE

PCMS MESSAGES

- BEARDALL TO CLOSE (2 WEEKS PRIOR TO DETOUR)
- MM/DD TO MM/DD
- BEARDALL CLOSED (DURING DETOUR)
- FOLLOW DETOUR

DETOUR NOTES

1. THIS DETOUR IS DESIGNED FOR BEARDALL AVE. DRAINAGE PIPE INSTALLATION NEAR CELERY AVE.

- (A) CELERY AVE BEARDALL AVE DETOUR
- (B) BEARDALL AVE DETOUR
- (C) END DETOUR
- (D) ROAD CLOSED THRU TRAFFIC
- (E) CELERY AVE BEARDALL AVE DETOUR

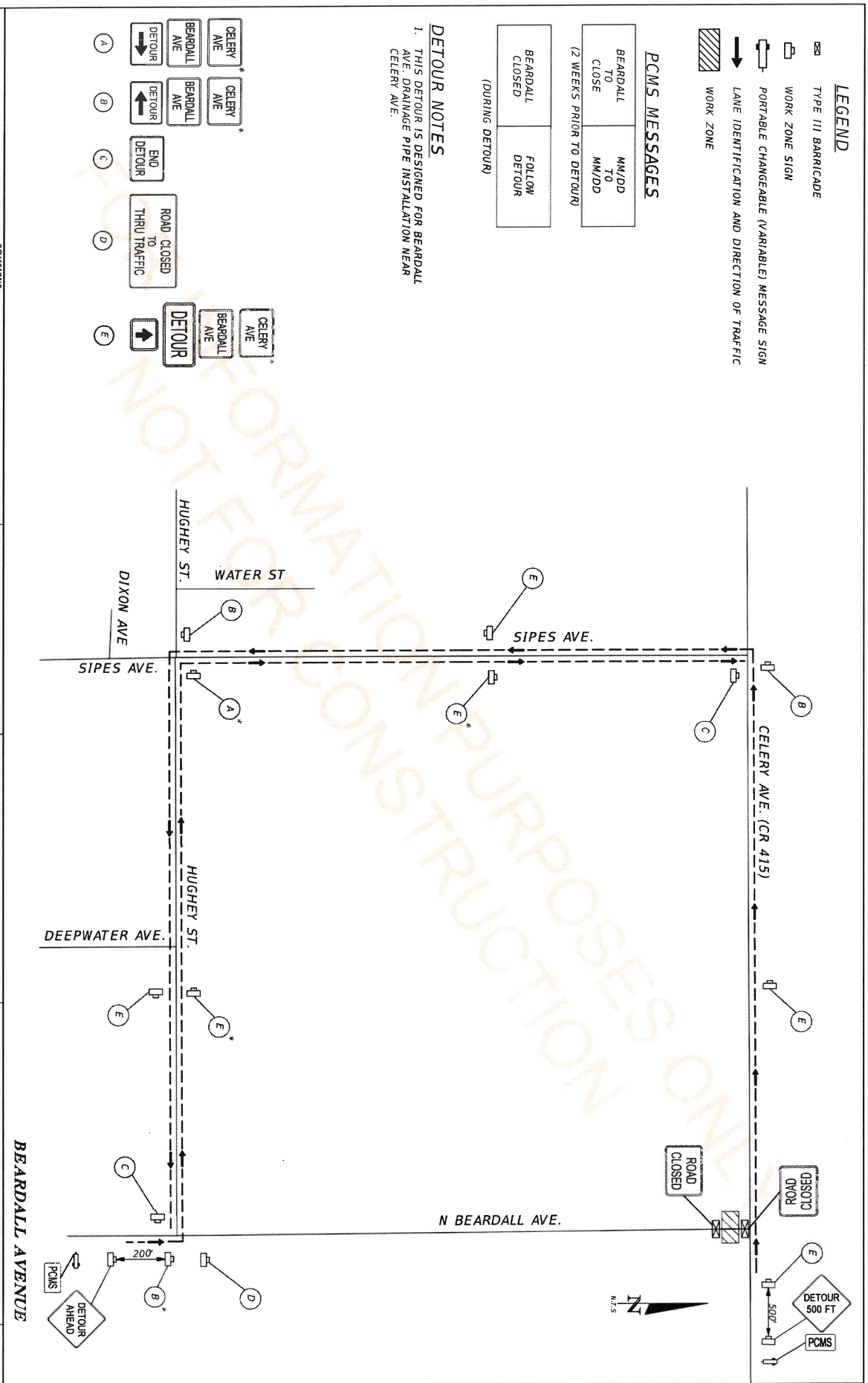

DATE	DESCRIPTION	REVISIONS	DATE	DESCRIPTION

PROFESSIONAL OF RECORD: ANGELO M. RIVERA-LOPEZ, P.E. # 74275 ATKINS NORTH AMERICA, INC. 482 SOUTH KELLER ROAD ORLANDO, FL 32810 CERTIFICATION OF AUTHORIZATION NO. 24	SEMINOLE COUNTY ENGINEERING DIVISION ROAD MIDWAY BASIN DRAINAGE IMPROVEMENTS	COUNTY CIP NO. 01907077
--	---	----------------------------

TEMP. TRAFFIC CONTROL	SHEET NO. 134
-----------------------	------------------

USER: T148B201

LEGEND

- ☒ TYPE III BARRICADE
- ☐ WORK ZONE SIGN
- ☐ PORTABLE CHANGEABLE (VARIABLE) MESSAGE SIGN
- ➔ LANE IDENTIFICATION AND DIRECTION OF TRAFFIC
- ▨ WORK ZONE

PCMS MESSAGES

BEARDALL TO CLOSE	MM/DD TO MM/DD
(2 WEEKS PRIOR TO DETOUR)	
BEARDALL CLOSED	FOLLOW DETOUR

(DURING DETOUR)

DETOUR NOTES

1. THIS DETOUR IS DESIGNED FOR BEARDALL AVENUE DRAINAGE PIPE INSTALLATION NEAR HUGHES STREET.

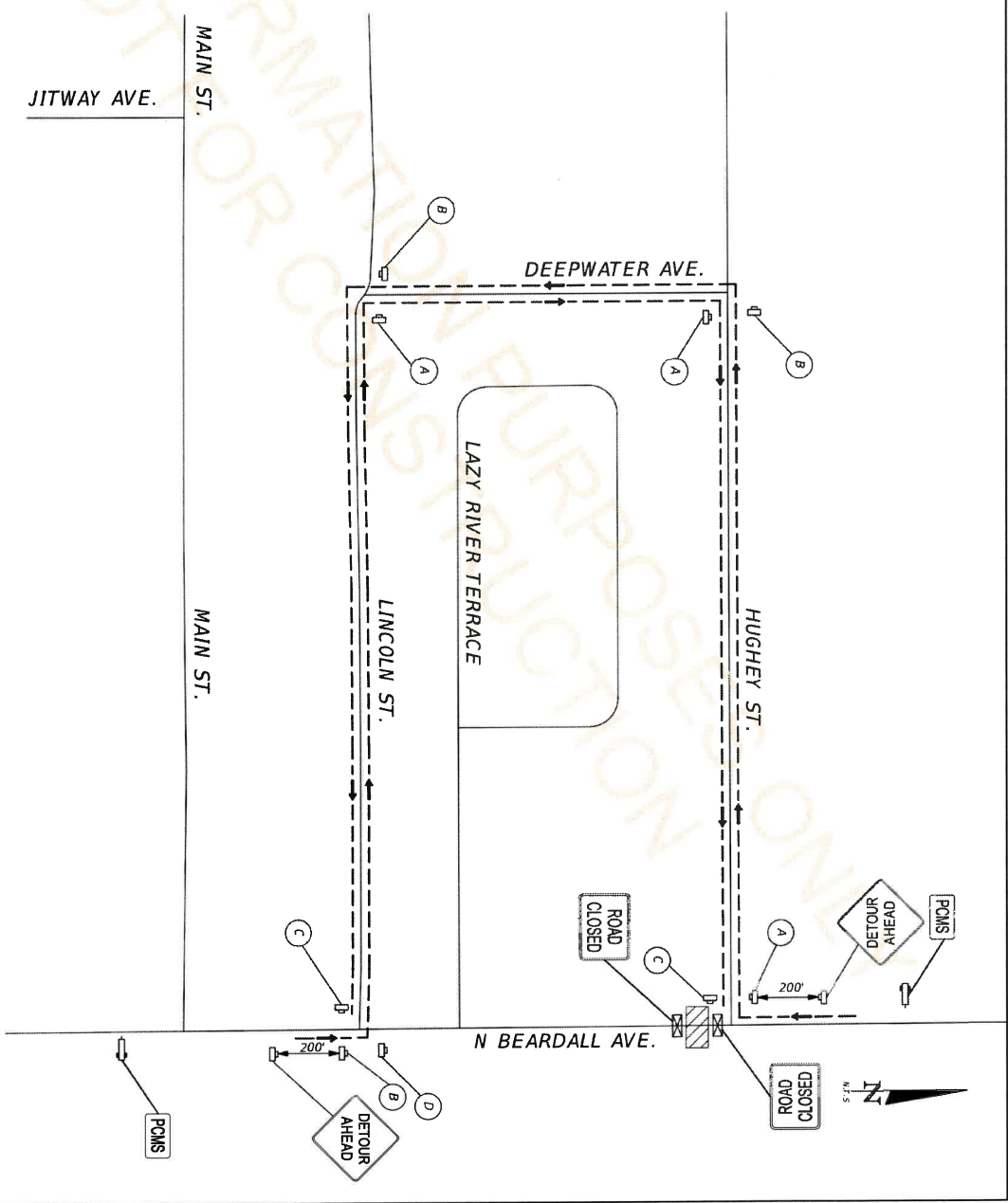
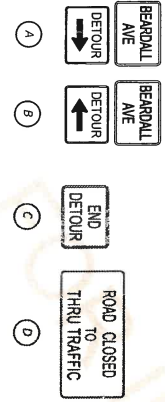

DATE	DESCRIPTION	REVISIONS	DATE	DESCRIPTION

PROFESSIONAL OF RECORD: ANGEL M. RIVERA-LOPEZ, P.E. # 74275 ATKINS NORTH AMERICA, INC. 904 AND F. 1385 N. ROAD CERTIFICATION OF AUTHORIZATION NO. 24 29/08/2023	SEMINOLE COUNTY ENGINEERING DIVISION ROAD MIDWAY BASIN DRAINAGE IMPROVEMENTS COUNTY CIP NO. 01907017	TEMP. TRAFFIC CONTROL SHEET NO. 135
--	--	---

LEGEND

- ☒ TYPE III BARRICADE
- ☐ WORK ZONE SIGN
- ☐ PORTABLE CHANGEABLE (VARIABLE) MESSAGE SIGN
- ➔ LANE IDENTIFICATION AND DIRECTION OF TRAFFIC
- ▨ WORK ZONE

PCMS MESSAGES

LINCOLN TO CLOSE	NW/DD TO NW/DD
(2 WEEKS PRIOR TO DETOUR)	
LINCOLN CLOSED	FOLLOW DETOUR
(DURING DETOUR)	

DETOUR NOTES

- THIS DETOUR IS DESIGNED FOR LINCOLN STREET DRAINAGE IMPROVEMENTS BETWEEN DIESEL LANE AND DEEPWATER AVENUE.

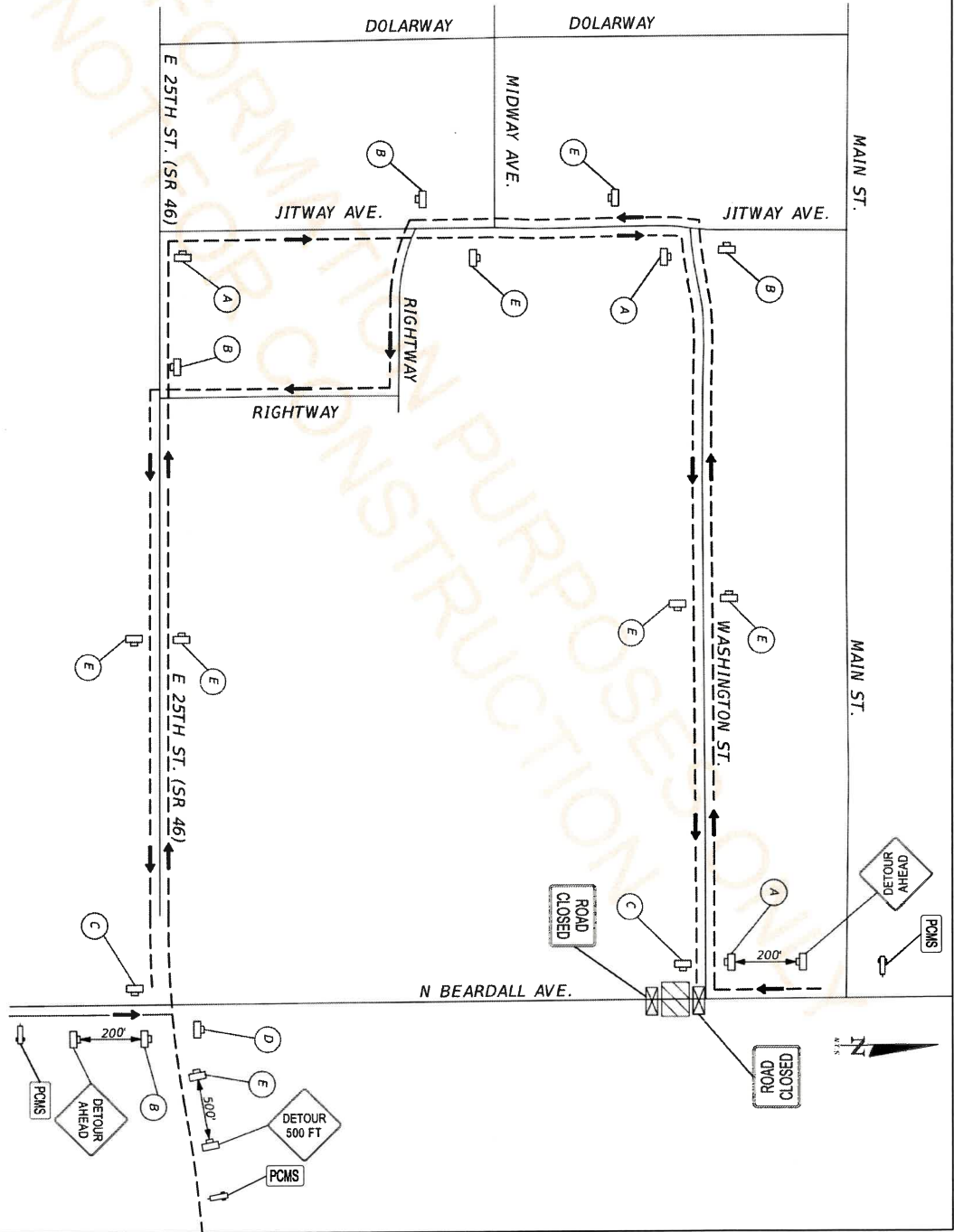
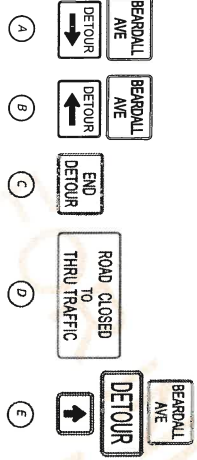

DATE	DESCRIPTION	REVISIONS	DATE	DESCRIPTION

PROFESSIONAL OF RECORD: ANGEL M. RIVERA-LOPEZ, P.E. # 74275 ATKINS NORTH AMERICA, INC. ORLANDO, FL 32810 CERTIFICATION OF AUTHORIZATION NO. 24	ROAD MIDWAY BASIN DRAINAGE IMPROVEMENTS	COUNTY CIP NO. 01907077	SHEET NO. 136
--	---	----------------------------	------------------

SEMINOLE COUNTY ENGINEERING DIVISION	TEMP. TRAFFIC CONTROL
---	-----------------------

USER: TLAB2301
 29/08/2023
 10:23:30 AM
 C:\Users\UDAB2305\OneDrive\Documents\EDBA\000808064\Midway Basin Final Design\Project Files\382\Workday\CP\382-382.dwg

LEGEND

- TYPE III BARRICADE
- WORK ZONE SIGN
- PORTABLE CHANGEABLE (VARIABLE) MESSAGE SIGN
- LANE IDENTIFICATION AND DIRECTION OF TRAFFIC
- WORK ZONE

PCMS MESSAGES

- CAMERON TO CLOSE (2 WEEKS PRIOR TO DETOUR)
- NW/DD TO MM/DD
- MM/DD TO NW/DD
- CAMERON CLOSED (DURING DETOUR)
- FOLLOW DETOUR

DETOUR NOTES

1. THIS DETOUR IS DESIGNED FOR CAMERON AVENUE DRAINAGE BOX CULVERT REPLACEMENT SOUTH OF THE ROUNDABOUT.

- A CAMERON AVE DETOUR
- B CAMERON AVE DETOUR
- C END DETOUR
- D ROAD CLOSED THRU TRAFFIC
- E CAMERON AVE DETOUR

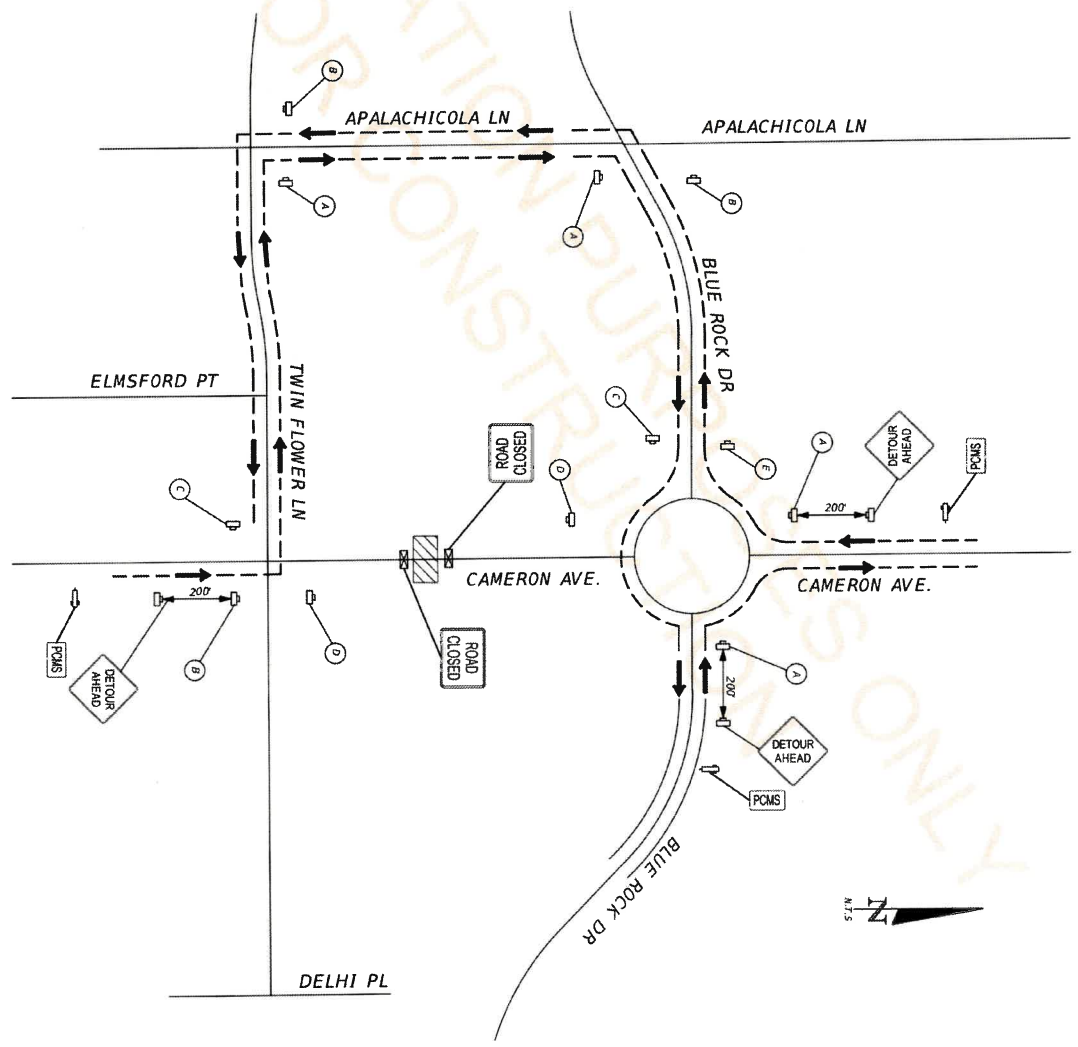

DATE	DESCRIPTION	REVISIONS	DATE	DESCRIPTION
05/28/2023				

PROFESSIONAL OF RECORD: ATLAS ENGINEERING, P.E. # 74275 482 SOUTH KELLER ROAD ORLANDO, FL 32810 CERTIFICATION OF AUTHORIZATION NO. 24 29/08/2023	SEMINOLE COUNTY ENGINEERING DIVISION ROAD COUNTY CIP NO. MIDWAY BASIN DRAINAGE IMPROVEMENTS 01907017	TEMP. TRAFFIC CONTROL	SHEET NO. 137
---	--	-----------------------	------------------

LEGEND

- TYPE III BARRICADE
- WORK ZONE SIGN
- PORTABLE CHANGEABLE (VARIABLE) MESSAGE SIGN
- LANE IDENTIFICATION AND DIRECTION OF TRAFFIC
- WORK ZONE

PCMS MESSAGES

- APALACHICOLA TO CLOSE MM/DD TO MM/DD (2 WEEKS PRIOR TO DETOUR)
- APALACHICOLA FOLLOW DETOUR (DURING DETOUR)

DETOUR NOTES

1. THIS DETOUR IS DESIGNED FOR APALACHICOLA LANE DRAINAGE BOX CULVERT REPLACEMENT SOUTH OF BLUE ROCK DR.

- (A) APALACHICOLA LN DETOUR
- (B) APALACHICOLA LN DETOUR
- (C) END DETOUR
- (D) ROAD CLOSED THRU TRAFFIC
- (E) APALACHICOLA LN DETOUR

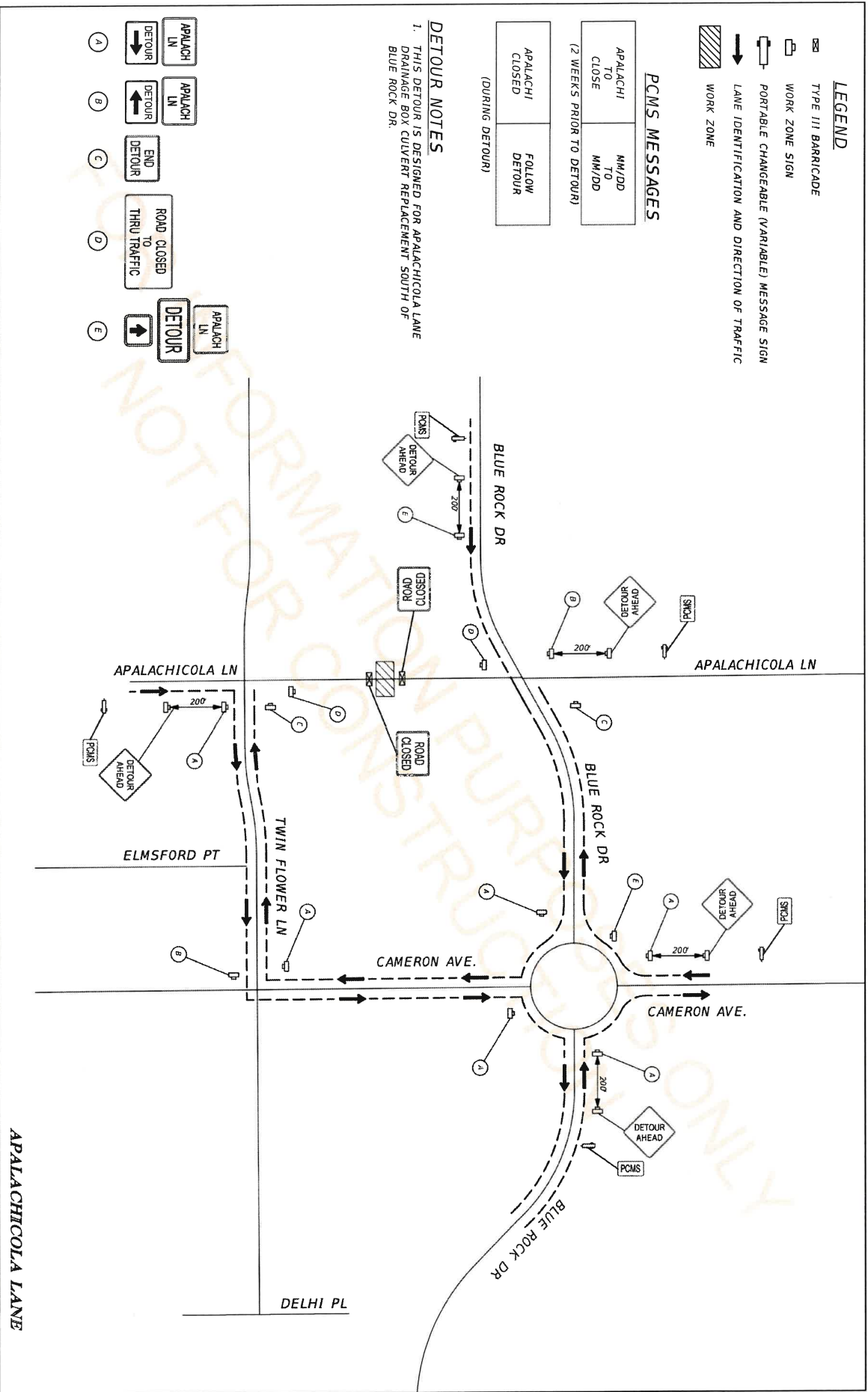

DATE	DESCRIPTION	REVISIONS	DATE	DESCRIPTION

PROFESSIONAL OF RECORD: ANGEL M. RIVERA-LOPEZ, P.E. # 74275 ATKINS NORTH AMERICA, INC. 482 SOUTH KELLER ROAD ORLANDO, FL 32810 CERTIFICATION OF AUTHORIZATION NO. 24 29/08/2023	SEMINOLE COUNTY ENGINEERING DIVISION ROAD MIDWAY BASIN DRAINAGE IMPROVEMENTS COUNTY CIP NO. 01907077	TEMP. TRAFFIC CONTROL SHEET NO. 138
---	--	---

DATE	DESCRIPTION	REVISIONS	DATE	DESCRIPTION

PROFESSIONAL OF RECORD: MATTHEW A. TAYLOR, P.E. # 56995 ATKINS NORTH AMERICA, INC. 482 SOUTH KELLER ROAD ORLANDO, FL 32810 CERTIFICATION OF AUTHORIZATION NO. 24 28/08/2023	SEMINOLE COUNTY ENGINEERING DIVISION COUNTY GIP NO. 01907077	MIDWAY BASIN DRAINAGE IMPROVEMENTS
---	---	---------------------------------------

USER: MAR201 28/08/2023 9:38:32 PM C:\Users\WD423293\OneDrive\My Documents\Projects\Lincoln\Lincoln\Utility\Drawings\Plan\UT-147-20.dwg	UTILITY ADJUSTMENTS SHEET NO. 147
--	---

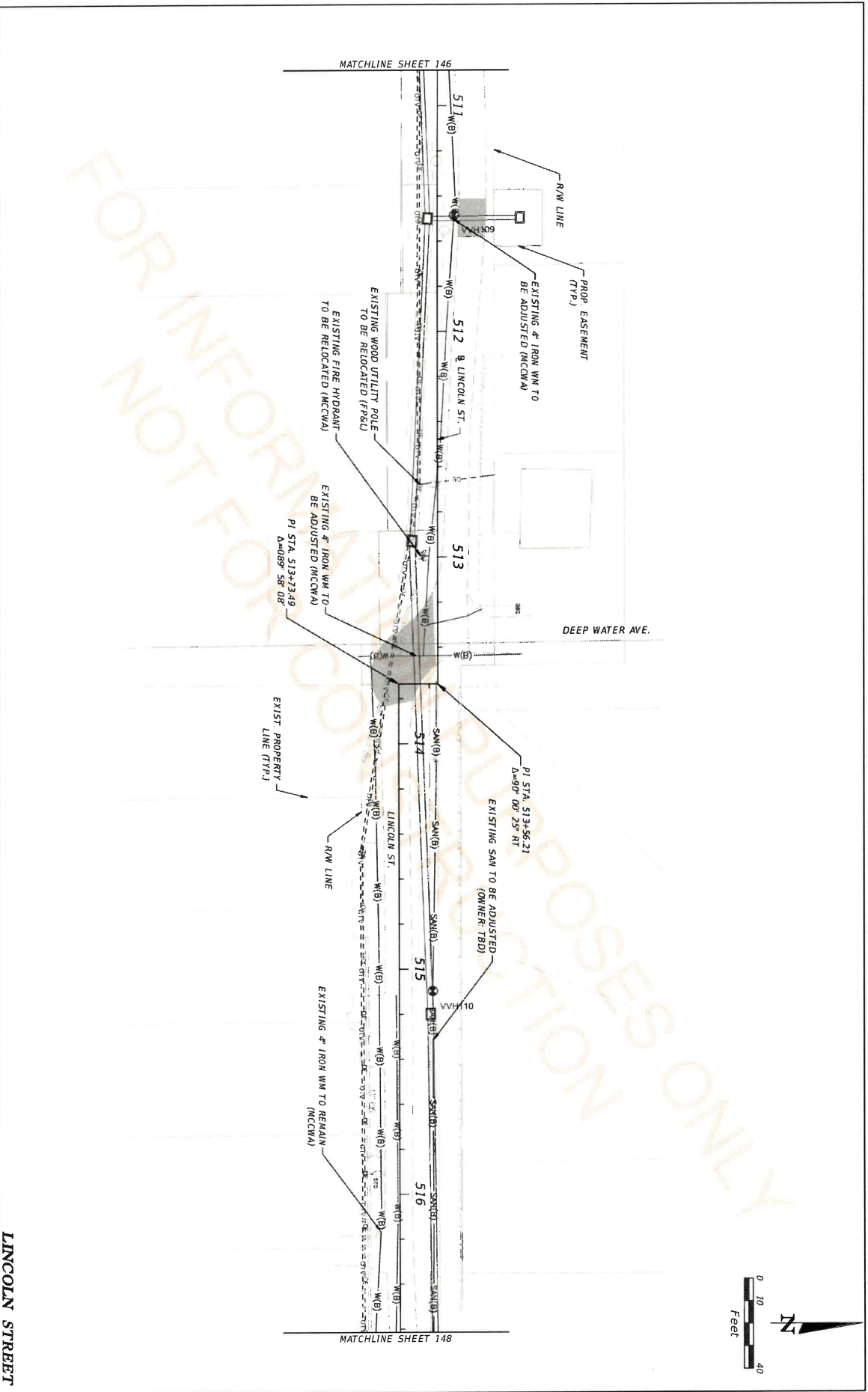

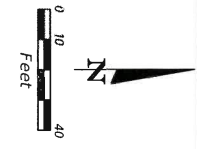
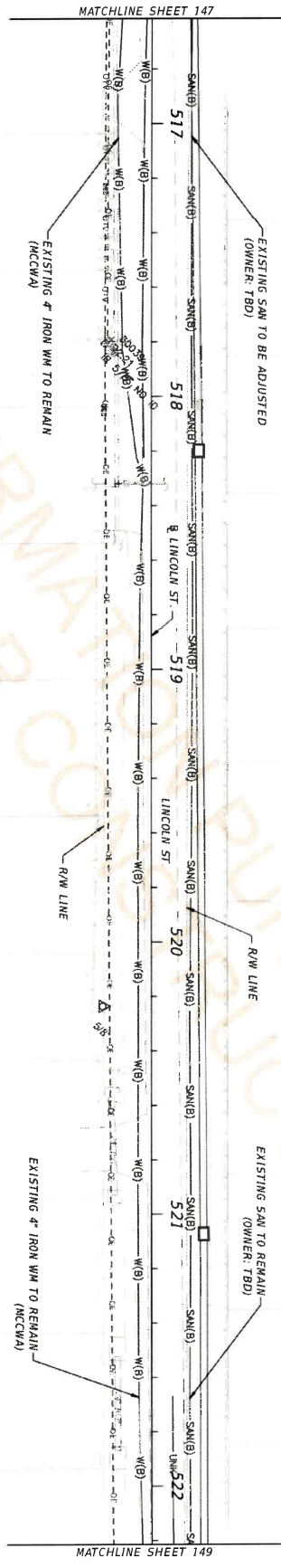

DATE		DESCRIPTION		REVISIONS	
DATE		DESCRIPTION		DATE	

PROFESSIONAL OF RECORD: MATTHEW TAYLOR P.E. # 56985 ATKINS NORTH AMERICA, INC. 482 SOUTH KELLER ROAD ORLANDO, FL 32810 CERTIFICATION OF AUTHORIZATION NO. 24 28/08/2023	9:48:37 AM
---	------------

SEMINOLE COUNTY ENGINEERING DIVISION ROAD COUNTY CIP NO. 01907077	MIDWAY BASIN DRAINAGE IMPROVEMENTS
---	---------------------------------------

UTILITY ADJUSTMENTS	SHEET NO. 148
---------------------	---------------

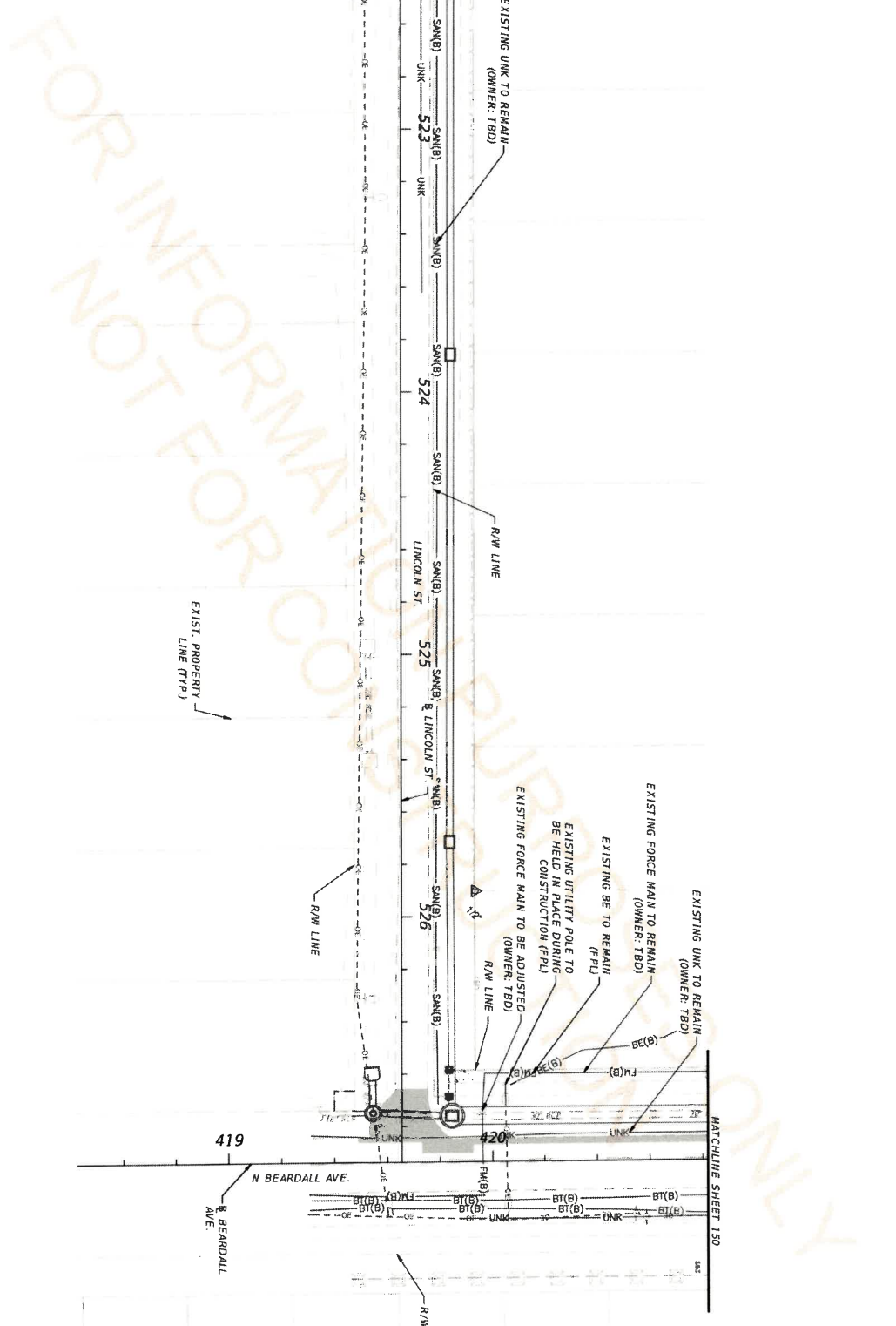

DATE	DESCRIPTION	REVISIONS	DATE	DESCRIPTION

PROFESSIONAL OF RECORD: MATTHEW A. TAYLOR, P.E. # 56985 MATINS NORTH AMERICA, INC. 682 AND F. 524th ROAD CERTIFICATION OF AUTHORIZATION NO. 24 28/08/2023	SEMINOLE COUNTY ENGINEERING DIVISION ROAD MIDWAY BASIN DRAINAGE IMPROVEMENTS COUNTY CIP NO. 01907077	UTILITY ADJUSTMENTS SHEET NO. 149
--	--	--

USER: HARB2011
 C:\Users\WDA2295\OneDrive\ENCL\EPH\0000808164\Midway Basin Final Design\Project Files\B2\Utilities\PLANUT-149-201.dwg

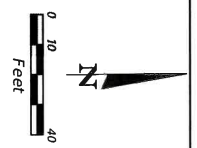
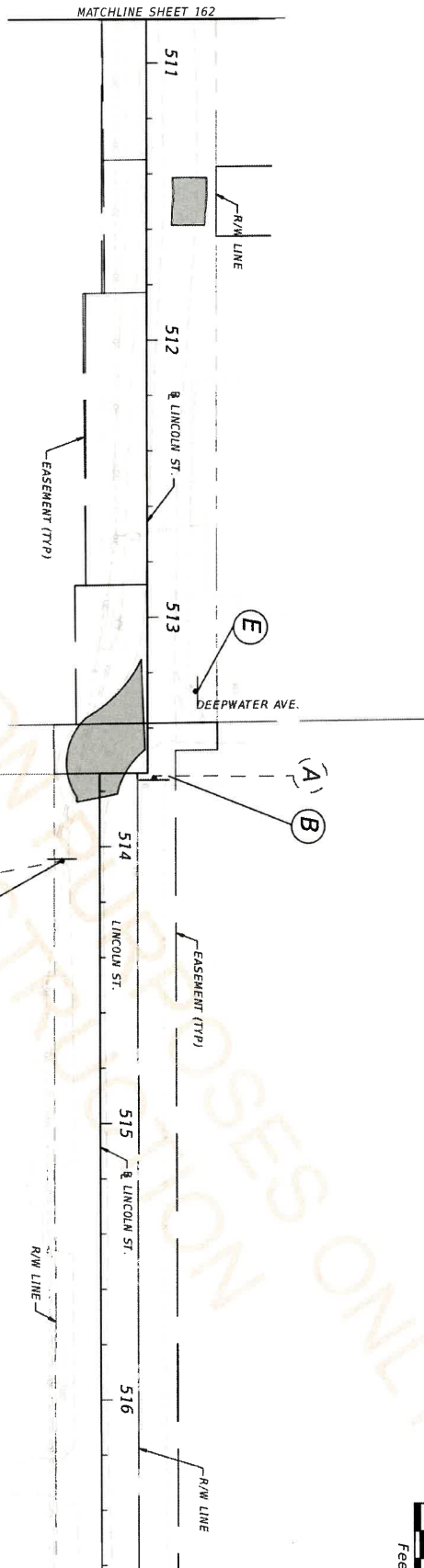

Notes:

- White HTP or better legend and border with Translucent Green 3M 1177 EC film background. Font is Highway Gothic (B) or (C) upper and lower case with a minimum of 6 inch upper/4.5 inch lower case letters. Border is .5 inch with 1 inch radius. Standard sizes of 24 in x 9 in / 30 in x 9 in / 36 in x 9 in and 42 in x 9 in. Any length over 42 inch is used only if necessary. Blades will be mounted to both sides of a twist bracket, which is then mounted inside the u-channel, behind stop sign. The Seminole County logo is used only at County maintained roads and is 5 inch x 3 inch, centered vertically and should be positioned to the left of the street name. Coordinate with Seminole County for latest logo template.

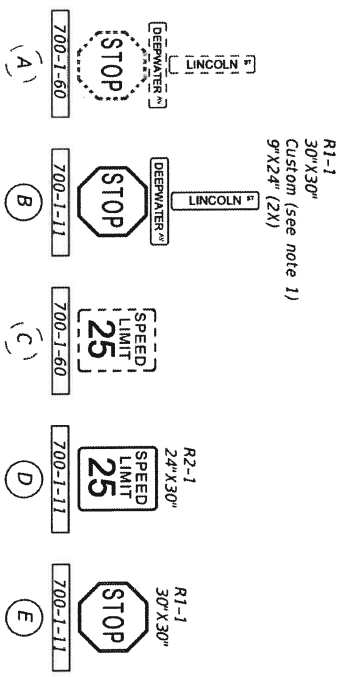

DATE	DESCRIPTION	REVISIONS	DATE	DESCRIPTION

PROFESSIONAL OF RECORD: NATHAN J. MOZELSKI, P.E. # 83308 482 SOUTH KELLER ROAD ORLANDO, FL 32810 CERTIFICATION OF AUTHORIZATION NO. 24 29/08/2023	SEMINOLE COUNTY ENGINEERING DIVISION COUNTY CIP NO. 01907077	MIDWAY BASIN DRAINAGE IMPROVEMENTS	103418 244
--	---	---------------------------------------	------------

PAVEMENT MARKINGS (2)	SHEET NO. 163
-----------------------	------------------

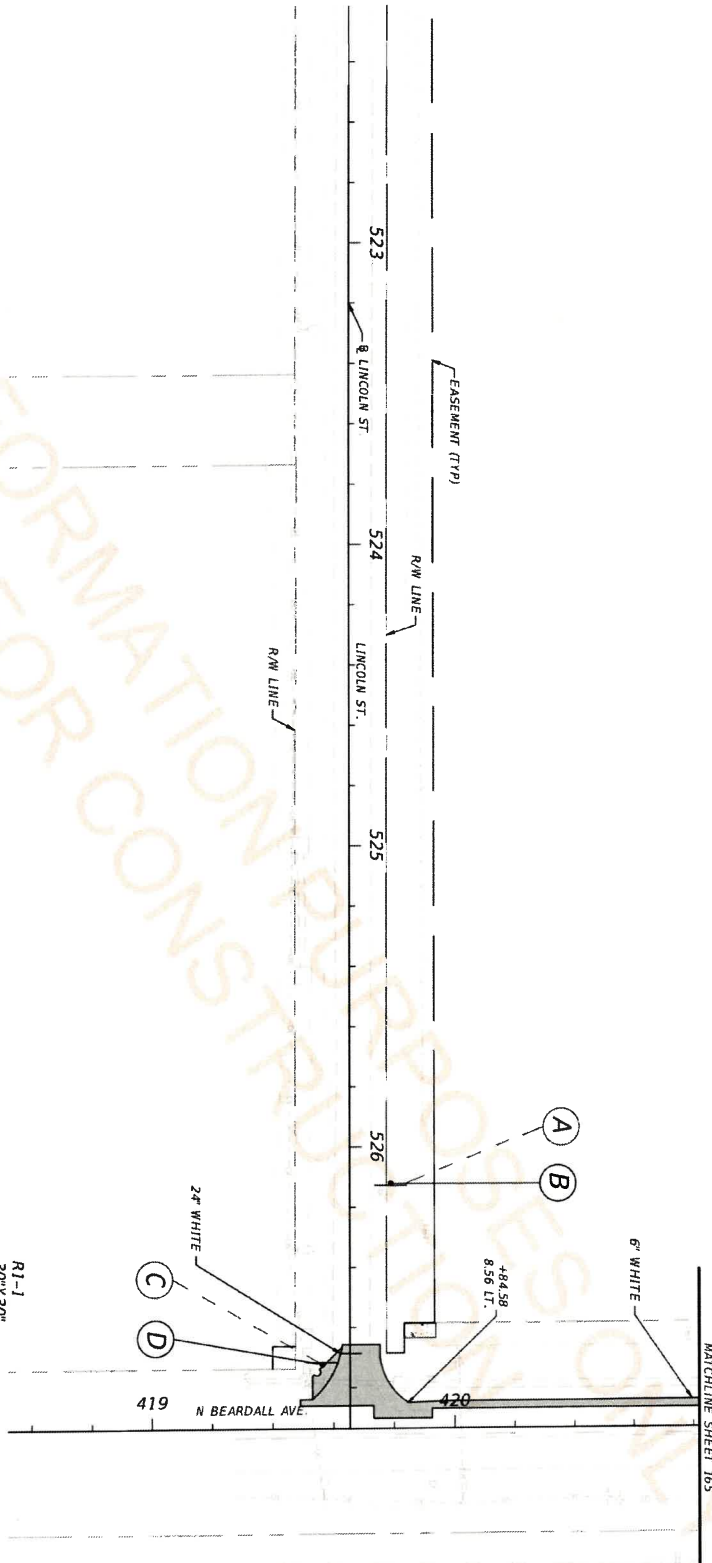

- Notes:
- White HIP or better legend and border with Translucent Green 3M 1177 EC film background. Font is Highway Gothic (B) or (C) upper and lower case with a minimum of 6 inch upper/4.5 inch lower case letters. Border is .5 inch with 1 inch radius. Standard sizes of 24 in x 9 in / 30 in x 9 in / 36 in x 9 in and 42 in x 9 in. Any length over 42 inch is used only if necessary. Blades will be mounted to both sides of a twist bracket, which is then mounted inside the u-channel, behind stop sign. The Seminole County logo is used only at County maintained roads and is 5 inch x 3 inch, centered vertically and should be positioned to the left of the street name. Coordinate vertically with Seminole County for latest logo template.

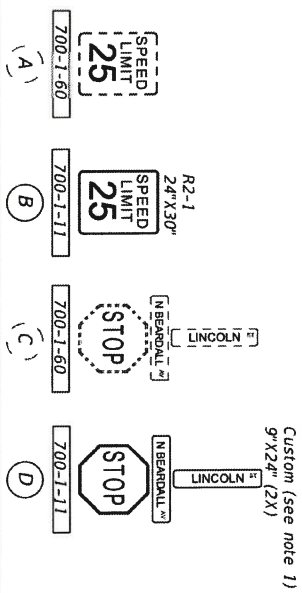

DATE	DESCRIPTION	REVISIONS	DATE	DESCRIPTION

PROFESSIONAL OF RECORD: MICHAEL S. P. # 83308 ATKINS NORTH AMERICA, INC. 482 SOUTH KELLER ROAD ORLANDO, FL 32810 CERTIFICATION OF AUTHORIZATION NO. 24 29/08/2023	SEMINOLE COUNTY ENGINEERING DIVISION COUNTY CIP NO. 01907077 MIDWAY BASIN DRAINAGE IMPROVEMENTS	SIGNING AND PAVEMENT MARKINGS (3)	SHEET NO. 164
---	---	---	---------------------