

# Property Record Card



**Parcel** 20-19-30-5VY-0000-0140

**Property Address** 1170 FRANKLIN TREE LN SANFORD, FL 32771

## Parcel Location



## Site View



## Parcel Information

<b>Parcel</b>	20-19-30-5VY-0000-0140
<b>Owner(s)</b>	THUMMALURU, RADHA - Tenancy by Entirety GAJJALA, VIKRAM R - Tenancy by Entirety
<b>Property Address</b>	1170 FRANKLIN TREE LN SANFORD, FL 32771
<b>Mailing</b>	1170 FRANKLIN TREE LN SANFORD, FL 32771-9163
<b>Subdivision Name</b>	BARTRAMS LANDING AT ST JOHNS
<b>Tax District</b>	01-COUNTY-TX DIST 1
<b>DOR Use Code</b>	01-SINGLE FAMILY
<b>Exemptions</b>	None
<b>AG Classification</b>	No

## Value Summary

	2024 Working Values	2023 Certified Values
<b>Valuation Method</b>	Cost/Market	Cost/Market
<b>Number of Buildings</b>	1	0
<b>Depreciated Bldg Value</b>	\$407,211	
<b>Depreciated EXFT Value</b>		
<b>Land Value (Market)</b>	\$122,000	\$105,000
<b>Land Value Ag</b>		
<b>Just/Market Value</b>	\$529,211	\$105,000
<b>Portability Adj</b>		
<b>Save Our Homes Adj</b>	\$0	\$0
<b>Amendment 1 Adj</b>	\$0	\$50,000
<b>P&amp;G Adj</b>	\$0	\$0
<b>Assessed Value</b>	\$529,211	\$55,000

## 2023 Certified Tax Summary

<b>2023 Tax Amount without Exemptions</b>	<b>\$1,397.34</b>	<b>2023 Tax Savings with Exemptions</b>	<b>\$396.50</b>
<b>2023 Tax Bill Amount</b>	<b>\$1,000.84</b>		

\* Does NOT INCLUDE Non Ad Valorem Assessments

## Legal Description

LOT 14 BARTRAMS LANDING AT ST JOHNS PLAT BOOK 88 PAGES 26-28

## Taxes

Taxing Authority	Assessment Value	Exempt Values	Taxable Value
ROAD DISTRICT	\$529,211	\$0	\$529,211
SJWM(Saint Johns Water Management)	\$529,211	\$0	\$529,211
FIRE	\$529,211	\$0	\$529,211
COUNTY GENERAL FUND	\$529,211	\$0	\$529,211
Schools	\$529,211	\$0	\$529,211

## Sales

Description	Date	Book	Page	Amount	Qualified	Vac/Imp
WARRANTY DEED	08/25/2023	10497	0142	\$680,400	Yes	Improved

## Land

Method	Frontage	Depth	Units	Units Price	Land Value
LOT			1	\$122,000.00	\$122,000

## Building Information

#	Description	Year Built**	Bed	Bath	Fixtures	Base Area	Total SF	Living SF	Ext Wall	Adj Value	Repl Value	Appendages	
1	SINGLE FAMILY	2023	5	4.0	13	2,189	3,468	2,890	CB/STUCCO FINISH	\$407,211	\$407,211	Description	Area
												GARAGE FINISHED	441.00
												OPEN PORCH FINISHED	42.00
												OPEN PORCH FINISHED	95.00
												UPPER STORY FINISHED	701.00

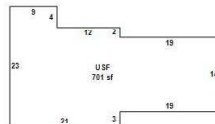
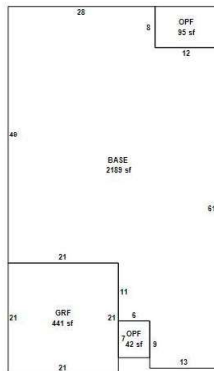

Building 1 - Page 1

**\*\* Year Built (Actual / Effective)**

## Permits

Permit #	Description	Agency	Amount	CO Date	Permit Date
15777	1170 FRANKLIN TREE LN: SINGLE FAMILY DETACHED-New SFR [BARTRAM'S LANDING AT ST J]	County	\$464,676	8/24/2023	10/12/2022

## Extra Features

Description	Year Built	Units	Value	New Cost
-------------	------------	-------	-------	----------

Zoning								
Zoning		Zoning Description		Future Land Use		Future Land Use Description		
PD		Planned Development		PD		Planned Development		
Utility Information								
Fire Station	Power	Phone(Analog)	Water Provider	Sewer Provider	Garbage Pickup	Recycle	Yard Waste	Hauler
34.00	FPL	AT&T	SEMINOLE COUNTY UTILITIES	SEMINOLE COUNTY UTILITIES	NA	NA	NA	NA
Political Representation								
Commissioner		US Congress		State House		State Senate		Voting Precinct
Dist 5 - Andria Herr		Dist 7 - Cory Mills		Dist 36 - RACHEL PLAKON		Dist 10 - Jason Brodeur		1
School Information								
Elementary School District			Middle School District			High School District		
Region 1			Sanford			Seminole		
Copyright 2023 © Seminole County Property Appraiser								