

Property Record Card



Parcel 11-21-29-502-0000-0540

Property Address 105 BAYBERRY RD ALTAMONTE SPRINGS, FL 32714

Parcel Location



Site View



Parcel Information

Parcel	11-21-29-502-0000-0540
Owner(s)	HOLMES, PAUL - Tenancy by Entirety HOLMES, MICHELE - Tenancy by Entirety
Property Address	105 BAYBERRY RD ALTAMONTE SPRINGS, FL 32714
Mailing	105 BAYBERRY RD ALTAMONTE SPG, FL 32714-2044
Subdivision Name	APPLE VALLEY UNIT 02
Tax District	01-COUNTY-TX DIST 1
DOR Use Code	01-SINGLE FAMILY
Exemptions	00-HOMESTEAD(2016)
AG Classification	No

Value Summary

	2023 Working Values	2022 Certified Values
Valuation Method	Cost/Market	Cost/Market
Number of Buildings	1	1
Depreciated Bldg Value	\$222,502	\$206,859
Depreciated EXFT Value	\$26,600	\$20,200
Land Value (Market)	\$75,000	\$75,000
Land Value Ag		
Just/Market Value	\$324,102	\$302,059
Portability Adj		
Save Our Homes Adj	\$87,331	\$72,184
Amendment 1 Adj	\$0	\$0
P&G Adj	\$0	\$0
Assessed Value	\$236,771	\$229,875

2022 Certified Tax Summary

2022 Tax Amount without Exemptions \$4,050.04 **2022 Tax Savings with Exemptions** \$1,501.76
2022 Tax Bill Amount \$2,548.28

* Does NOT INCLUDE Non Ad Valorem Assessments

Legal Description

LOT 54
APPLE VALLEY UNIT 2
PB 16 PG 35

Taxes

Taxing Authority	Assessment Value	Exempt Values	Taxable Value
ROAD DISTRICT	\$236,771	\$50,000	\$186,771
SJWM(Saint Johns Water Management)	\$236,771	\$50,000	\$186,771
FIRE	\$236,771	\$50,000	\$186,771
COUNTY GENERAL FUND	\$236,771	\$50,000	\$186,771
Schools	\$236,771	\$25,000	\$211,771

Sales

Description	Date	Book	Page	Amount	Qualified	Vac/Imp
SPECIAL WARRANTY DEED	09/01/2011	07639	1065	\$195,000	No	Improved
CERTIFICATE OF TITLE	07/01/2011	07607	0439	\$127,000	No	Improved
WARRANTY DEED	10/01/2005	06041	0982	\$450,000	Yes	Improved
WARRANTY DEED	04/01/2005	05696	1779	\$259,900	Yes	Improved
WARRANTY DEED	11/01/2004	05621	1906	\$186,000	Yes	Improved
WARRANTY DEED	06/01/1995	02932	0116	\$131,000	Yes	Improved
WARRANTY DEED	09/01/1989	02104	1723	\$116,000	Yes	Improved
WARRANTY DEED	04/01/1979	01217	1478	\$84,500	Yes	Improved

Land

Method	Frontage	Depth	Units	Units Price	Land Value
LOT			1	\$75,000.00	\$75,000

Building Information

#	Description	Year Built**	Bed	Bath	Fixtures	Base Area	Total SF	Living SF	Ext Wall	Adj Value	Repl Value	Appendages								
1	SINGLE FAMILY	1972	4	2.5	8	1,183	2,815	2,263	CB/STUCCO FINISH	\$222,502	\$317,860	<table border="1"> <thead> <tr> <th>Description</th> <th>Area</th> </tr> </thead> <tbody> <tr> <td>GARAGE FINISHED</td> <td>520.00</td> </tr> <tr> <td>OPEN PORCH FINISHED</td> <td>32.00</td> </tr> <tr> <td>UPPER STORY FINISHED</td> <td>1080.00</td> </tr> </tbody> </table>	Description	Area	GARAGE FINISHED	520.00	OPEN PORCH FINISHED	32.00	UPPER STORY FINISHED	1080.00
Description	Area																			
GARAGE FINISHED	520.00																			
OPEN PORCH FINISHED	32.00																			
UPPER STORY FINISHED	1080.00																			

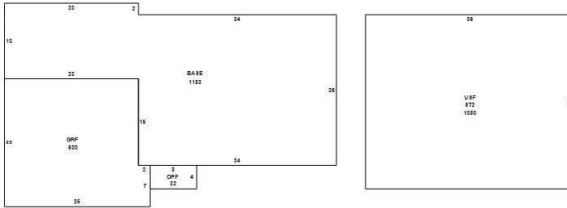

Building 1 - Page 1

** Year Built (Actual / Effective)

Permits

Permit #	Description	Agency	Amount	CO Date	Permit Date
10360	REROOF W/SHINGLES	County	\$5,270		5/24/2005
19335	105 BAYBERRY RD: EZ REROOF RESIDENTIAL- [APPLE VALLEY UNIT 02]	County	\$23,576		11/15/2022

Extra Features

Description	Year Built	Units	Value	New Cost
FIREPLACE 1	10/01/1972	1	\$1,200	\$3,000
POOL 1	10/01/1972	1	\$21,000	\$35,000
SCREEN ENCL 2	10/01/1990	1	\$3,400	\$8,500
COVERED PATIO 1	10/01/1990	1	\$1,000	\$2,500

Zoning

Zoning	Zoning Description	Future Land Use	Future Land Use Description
R-1AA	Low Density Residential	LDR	Single Family-11700

Utility Information

Fire Station	Power	Phone(Analog)	Water Provider	Sewer Provider	Garbage Pickup	Recycle	Yard Waste	Hauler
12.00	DUKE	CENTURY LINK	SEMINOLE COUNTY UTILITIES	SEMINOLE COUNTY UTILITIES	MON/THU	WED	WED	Advanced Disposal

Political Representation

Commissioner	US Congress	State House	State Senate	Voting Precinct
Dist 3 - Lee Constantine	Dist 7 - Stephanie Murphy	Dist 29 - Scott Plakon	Dist 9 - Jason Brodeur	40

School Information

Elementary School District	Middle School District	High School District
Spring Lake	Milwee	Lyman

Copyright 2022 © Seminole County Property Appraiser